

STATE OF ILLINOIS  
DEPARTMENT OF TRANSPORTATION

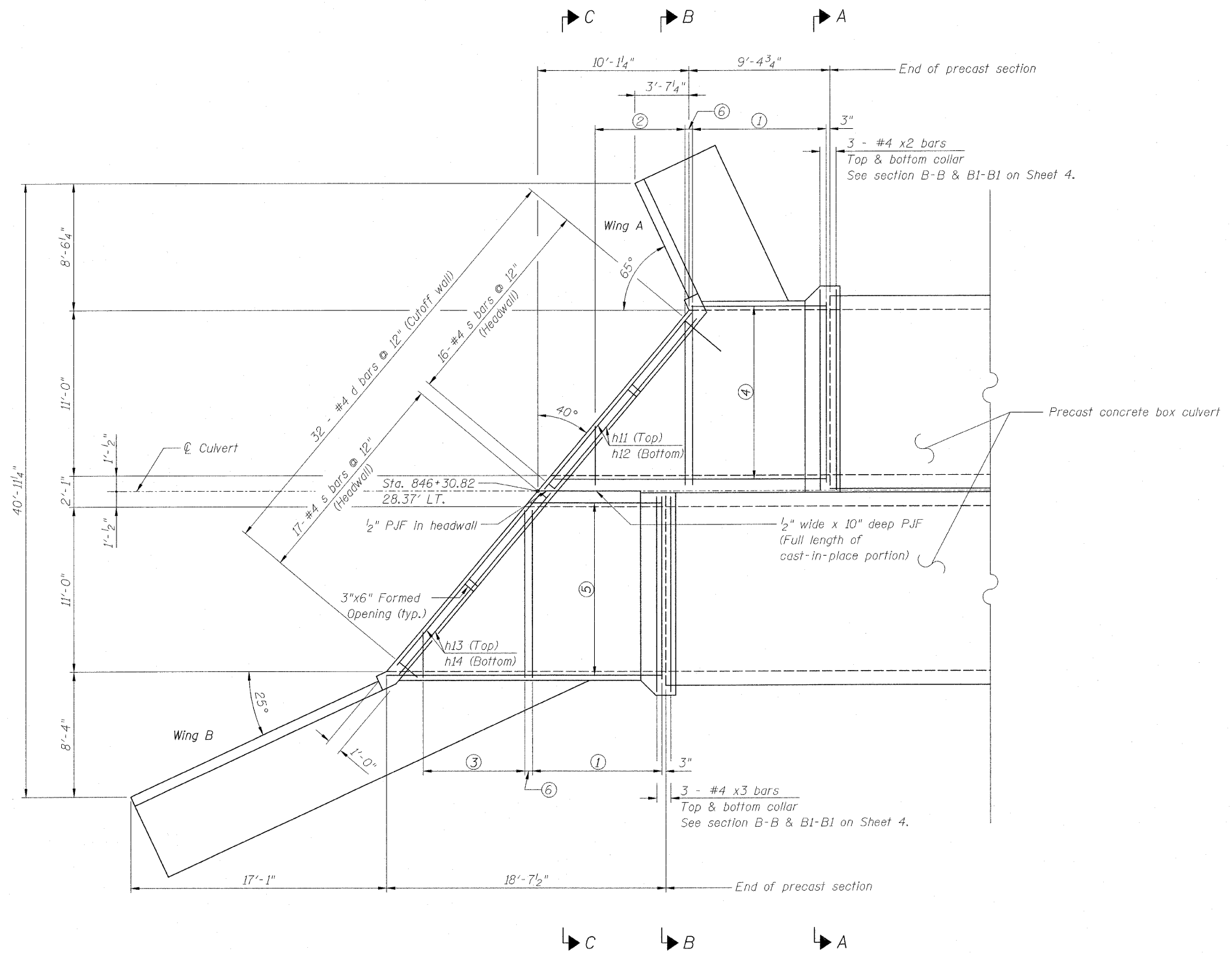

**LEGEND**  
T.T. = Top of top slab  
B.T. = Bottom of top slab  
T.B. = Top of bottom slab  
B.B. = Bottom of bottom slab

- NOTE:**
- ① 17 - #8 a bars @ 6" = 8'-0" (B.T. & T.B.)  
5 - #4 a3 bars @ 24" = 8'-0" (B.B.)  
6 - #5 a6 bars @ 18" = 7'-6" (T.T.)
  - ② 17 - #8 a1 bars @ 6" = 8'-0" (B.T. & T.B.)  
4 - #4 a4 bars @ 24" = 6'-0" (B.B.)  
6 - #5 a7 bars @ 18" = 7'-6" (T.T.)
  - ③ 17 - #8 a2 bars @ 6" = 8'-0" (B.T. & T.B.)  
4 - #4 a5 bars @ 24" = 6'-0" (B.B.)  
6 - #5 a8 bars @ 18" = 7'-6" (T.T.)
  - ④ 23 - #6 h bars @ 6" = 11'-0" (B.T.)  
12 - #5 h10 bars @ 12" = 11'-0" (B.B. & T.B.)  
12 - #4 h19 bars @ 12" = 11'-0" (T.T.)
  - ⑤ 23 - #6 h1 bars @ 6" = 11'-0" (B.T.)  
12 - #5 h10 bars @ 12" = 11'-0" (B.B. & T.B.)  
12 - #4 h19 bars @ 12" = 11'-0" (T.T.)
  - ⑥ 6" (a, a1, a2)  
24" (a3, a4, a5)  
18" (a6, a7, a8)

See Sheets 4 & 5 of 9 for Sections  
A-A, B-B and C-C

PLAN

NORTH END PLAN  
STRUCTURE NO. 101-1084

DESIGNED	BJM
CHECKED	MAS
DRAWN	TMF / JNH
CHECKED	BRT



Wight & Company  
2500 North Frontage Road Darien, IL 60561  
630.969.7000 630.969.7979 fax  
Design Firm Registration 184-000451

SHEET NO. 2	F.A.P. RTE.	SECTION	COUNTY	TOTAL SHEETS	SHEET NO.
	505	115RS-2	WINNEBAGO	120	44
9 SHEETS	STA. 791+50 TO STA. 796+00		CONTRACT NO. 64E89		
FED. ROAD DIST. NO.		ILLINOIS	FED. AID PROJECT		

7/14/2008 4:20:12 PM Default G:\ENCL\06-6790-13\_TASK 8.LL 75 Structural Plans\Civ\Str\1011084\_54E89\_002\_NorthEnd.dgn