

INDEX OF SHEETS

1. COVERSHEET
2. SUMMARY OF QUANTITIES
3. GENERAL NOTES
4. TRAFFIC CONTROL & STRIPING SCHEDULE

- STRUCTURES 081-0018 & 0019
5. GENERAL PLAN & ELEVATION
 6. SUPERSTRUCTURE 081-0018
 7. SUPERSTRUCTURE 081-0019

- STRUCTURES 081-0020 & 0021
8. GENERAL PLAN & ELEVATION
 9. SUPERSTRUCTURE 081-0020
 10. SUPERSTRUCTURE 081-0021

- STRUCTURES 081-0022 & 0023
11. GENERAL PLAN & ELEVATION
 12. SUPERSTRUCTURE 081-0022
 13. SUPERSTRUCTURE 081-0023

- STRUCTURES 081-0024 & 0025
14. GENERAL PLAN & ELEVATION
 15. SUPERSTRUCTURE 081-0024
 16. SUPERSTRUCTURE 081-0025

- STRUCTURES 081-0026 & 0027
17. GENERAL PLAN & ELEVATION
 18. SUPERSTRUCTURE 081-0026
 19. SUPERSTRUCTURE 081-0027

STANDARDS

- 635006-03
- 635011-02
- 70101-02
- 701400-04
- 701401-05
- 701402-07
- 701406-05
- 701411-06
- 701426-03
- 701501-05
- 701901-01
- 704001-06
- 720001-01
- 720006-02
- 728001-01
- 729001-01

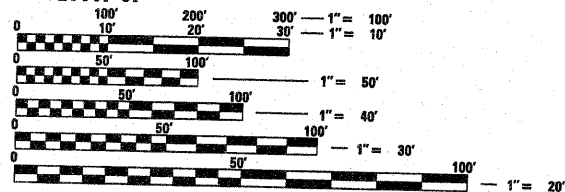

FULL SIZE PLANS HAVE BEEN PREPARED USING STANDARD ENGINEERING SCALES. REDUCED SIZED PLANS WILL NOT CONFORM TO STANDARD SCALES. IN MAKING MEASUREMENTS ON REDUCED PLANS, THE ABOVE SCALES MAY BE USED.

J.U.L.I.E.
JOINT UTILITY LOCATION INFORMATION FOR EXCAVATION
1-800-892-0123
OR 811

PROJECT ENGINEER: Mahmoud Etemadi 815/284-5393

CONTRACT NO. 64F92

STATE OF ILLINOIS
DEPARTMENT OF TRANSPORTATION
DIVISION OF HIGHWAYS

PROPOSED
HIGHWAY PLANS

FAI ROUTE 280 (I-280)
SECTION D2 BR WEAR SURF I-280

BRIDGE REPAIR
ROCK ISLAND COUNTY

C-92-048-10

Project Location =

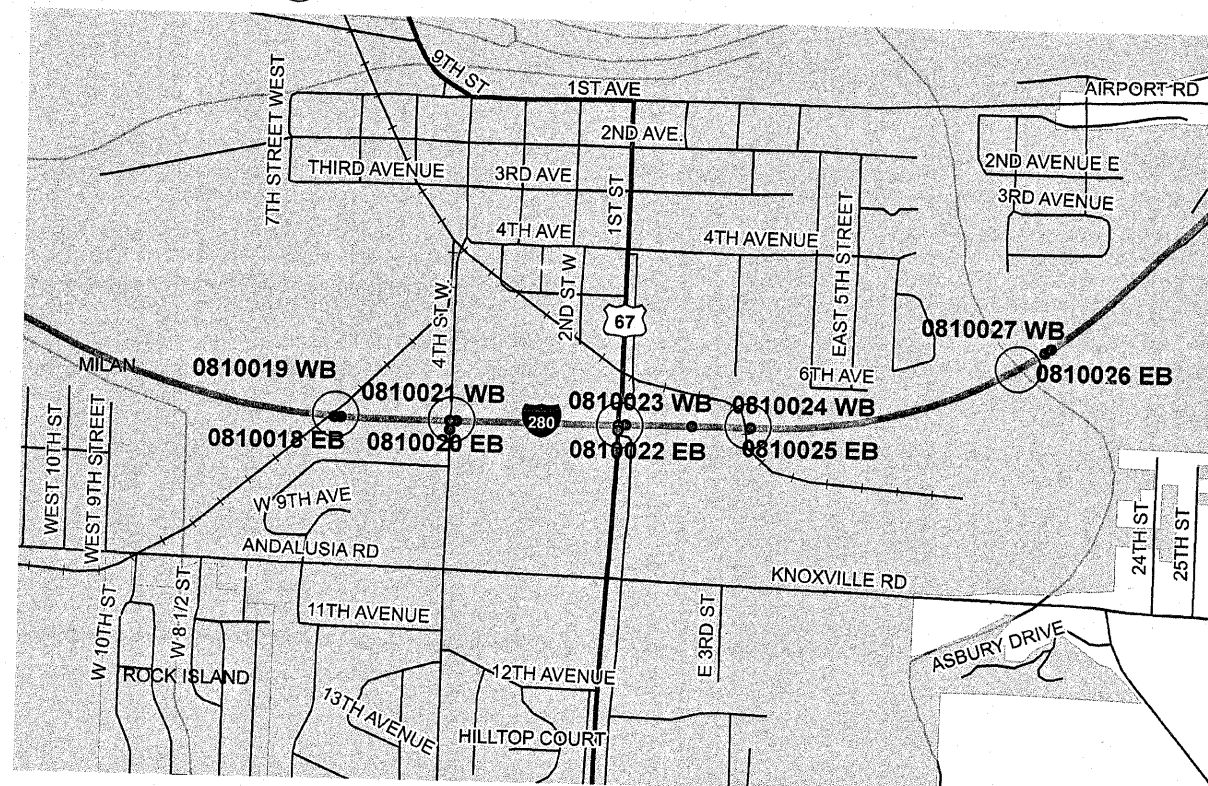

GROSS LENGTH = 1004.50 FT. = 0.190 MILE
NET LENGTH = 1004.50 FT. = 0.190 MILE

F.A.I. RTE.	SECTION	COUNTY	TOTAL SHEETS	SHEET NO.
280	D2 BR WEAR SURF I-280	ROCK ISLAND	19	1
		ILLINOIS	CONTRACT NO. 64F92	

D-92-031-10



LOCATION OF SECTION INDICATED THUS:

STATE OF ILLINOIS
DEPARTMENT OF TRANSPORTATION
DIVISION OF HIGHWAYS

SUBMITTED Nov. 5 2009

George F. Ryan
DEPUTY DIRECTOR OF HIGHWAYS, REGION ENGINEER

December 4, 2009
Charles G. Ingersoll
ENGINEER OF DESIGN AND ENVIRONMENT

December 4, 2009
Christine M. Reed
DIRECTOR OF HIGHWAYS, CHIEF ENGINEER

PRINTED BY THE AUTHORITY
OF THE STATE OF ILLINOIS

SUMMARY OF QUANTITIES

URBAN
SFTY-2A
100% STATE

paycode	description	units	quantity
50157300	PROTECTIVE SHIELD	SQ YD	742
67100100	MOBILIZATION	L SUM	1
70100420	TRAFFIC CONTROL AND PROTECTION, STANDARD 701411	EACH	2
70100700	TRAFFIC CONTROL AND PROTECTION, STANDARD 701406	L SUM	1
70100800	TRAFFIC CONTROL AND PROTECTION, STANDARD 701401	L SUM	1
70100805	TRAFFIC CONTROL AND PROTECTION, STANDARD 701402	L SUM	1
70102620	TRAFFIC CONTROL AND PROTECTION, STANDARD 701501	L SUM	1
70300100	SHORT-TERM PAVEMENT MARKING	FOOT	5,400
70300220	TEMPORARY PAVEMENT MARKING - LINE 4"	FOOT	15,000
70301000	WORK ZONE PAVEMENT MARKING REMOVAL	SQ FT	5,000
70400100	TEMPORARY CONCRETE BARRIER	FOOT	3,475
70400200	RELOCATE TEMPORARY CONCRETE BARRIER	FOOT	3,475
78200500	BARRIER WALL MARKERS	EACH	80
*78001110	PAINT PAVEMENT MARKING - LINE 4"	FOOT	9,648
*78001130	PAINT PAVEMENT MARKING - LINE 6"	FOOT	1,164
78300100	PAVEMENT MARKING REMOVAL	SQ FT	3,000
Z0016000	DECK SLAB REPAIR (FULL DEPTH)	SQ YD	404
Z0016200	DECK SLAB REPAIR (PARTIAL)	SQ YD	1,442
Z0030250	IMPACT ATTENUATORS, TEMPORARY (NON- REDIRECTIVE), TEST LEVEL 3	EACH	10
Z0030350	IMPACT ATTENUATORS, RELOCATE (NON- REDIRECTIVE), TEST LEVEL 3	EACH	10

* SPECIALTY ITEM

FILE NAME = D:\BR\CADD plans\Rock Island County\2019	USER NAME = lmkdj	DESIGNED - ---	REVISED - ---	STATE OF ILLINOIS DEPARTMENT OF TRANSPORTATION	SUMMARY OF QUANTITIES	F.A.I. RTE.	SECTION	COUNTY	TOTAL SHEETS	SHEET NO.
280 deck repair\PLANeng.dgn	DRAWN - ---	REVISED - ---	280			D2 BR WEAR SURF I-280	ROCK ISLAND	19	2	
PLOT SCALE = 50.0000' / IN.	CHECKED - ---	REVISED - ---	CONTRACT NO. 64F92							
PLOT DATE = Thu Nov 05 11:01:19 2009	DATE - ---	REVISED - ---	ILLINOIS FED. AID PROJECT							
SCALE: _____ SHEET NO. ___ OF ___ SHEETS STA. _____ TO STA. _____										

GENERAL NOTES

The final top 100 mm (four inches) of soil in any right-of-way area disturbed by the Contractor must be capable of supporting vegetation. The soil must be from the A horizon (zero to 2' deep) of soil profiles of local soils.

All Borrow/Waste/Use sites must be approved by the Department prior to removing any material from the project or initiating any earthmoving activities, including temporary stockpiling outside the limits of construction.

The Contractor shall seed all disturbed areas within the project limits. Seeding Class 4 or 2A shall be used, except in front of properties where the grass will be mowed, then use Seeding, Class 1. Class 2A shall be used on front slopes and ditch bottoms. Class 4 shall be used behind Type A gutter, on all backslopes and areas behind the backslope, and beyond the toe of front slope on fill sections without ditches. This work will be included in the contract unit price per Lump Sum for MOBILIZATION.

Fertilizer shall be applied to all disturbed areas and incorporated into the seedbed prior to seeding or placement of sod at the rate specified in Sections 250 and 252 of the Standard Specifications. This work shall be included in the cost of MOBILIZATION.

Mulch Method II shall be applied over all seeded areas. This shall be included in the cost of the MOBILIZATION.

Reflector Markers Type B shall be installed on the top of bridge parapet walls. The markers shall be according to Standard 635011 and the color and spacing according to Standard 635006, except their shall be 4 markers installed per parapet wall at equal spacing.

The Contractor shall be responsible for protecting utility property during construction operations as outlined in Article 107.31 of the Standard Specifications. A minimum of 48 hours advance notice is required for non-emergency work. The JULIE number is 800-892-0123.

The objective of this contract is to patch the concrete wearing surfaces of the bridge decks. Deck Slab Repair (Full Depth) is only included as a contingency item to be used should a full depth failure develop during this contract.

FILE NAME =	USER NAME = lmkdj	DESIGNED -	REVISED -	STATE OF ILLINOIS DEPARTMENT OF TRANSPORTATION	GENERAL NOTES	F.A.I. RTE.	SECTION	COUNTY	TOTAL SHEETS	SHEET NO.	
D:\BRV\CADD plans\Rock Island County\2019	288 deck repair\PLANeng.dgn	DRAWN -	REVISED -			280	D2 BR WEAR SURF I-280	ROCK ISLAND	19	3	
	PLOT SCALE = 50,0000' / IN.	CHECKED -	REVISED -			CONTRACT NO. 64F92					
	PLOT DATE = Thu Nov 05 11:01:27 2009	DATE -	REVISED -			ILLINOIS FED. AID PROJECT					
				SCALE: _____ SHEET NO. ___ OF ___ SHEETS STA. _____ TO STA. _____							

Temporary Concrete Barrier

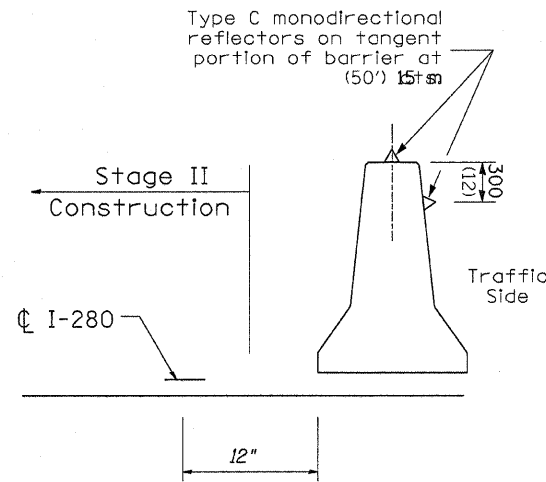
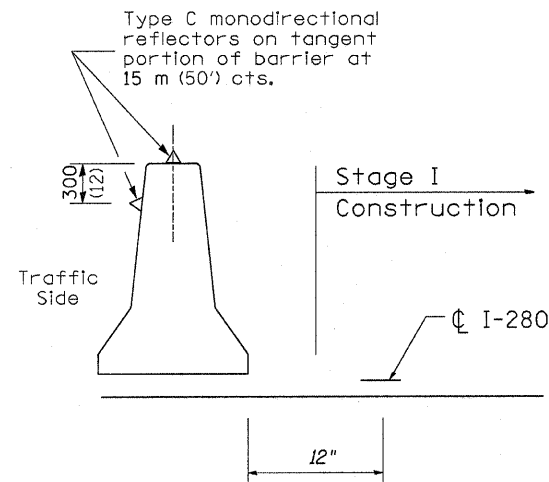

	Temporary Concrete Barrier	Relocate Temporary Concrete Barrier
SN 081-0018		
Tangent	212.5	212.5
Taper	137.5	137.5
SN 081-0019		
Tangent	212.5	212.5
Taper	137.5	137.5
SN 081-0020		
Tangent	162.5	162.5
Taper	137.5	137.5
SN 081-0021		
Tangent	162.5	162.5
Taper	137.5	137.5
SN 081-0022		
Tangent	175	175
Taper	137.5	137.5
SN 081-0023		
Tangent	175	175
Taper	137.5	137.5
SN 081-0024		
Tangent	275	275
Taper	137.5	137.5
SN 081-0025		
Tangent	275	275
Taper	137.5	137.5
SN 081-0026		
Tangent	225	225
Taper	137.5	137.5
SN 081-0027		
Tangent	225	225
Taper	137.5	137.5
Total	3475	3475

Striping Schedule

	4" Edgeline (yellow)	4" Edgeline (white)	6" Centerline
SN 081-0018			
West Approach	20'	20'	5'
Deck	199'	199'	50'
East Approach	20'	20'	5'
SN 081-0019			
West Approach	20'	20'	5'
Deck	199'	199'	50'
East Approach	20'	20'	5'
SN 081-0020			
West Approach	20'	20'	5'
Deck	157'	157'	40'
East Approach	20'	20'	5'
SN 081-0021			
West Approach	20'	20'	5'
Deck	157'	157'	40'
East Approach	20'	20'	5'
SN 081-0022			
West Approach	20'	20'	5'
Deck	163'	163'	41'
East Approach	20'	20'	5'
SN 081-0023			
West Approach	20'	20'	5'
Deck	163'	163'	41'
East Approach	20'	20'	5'
SN 081-0024			
West Approach	20'	20'	5'
Deck	273'	273'	69'
East Approach	20'	20'	5'
SN 081-0025			
West Approach	20'	20'	5'
Deck	273'	273'	69'
East Approach	20'	20'	5'
SN 081-0026			
West Approach	20'	20'	5'
Deck	214'	214'	41'
East Approach	20'	20'	5'
SN 081-0027			
West Approach	20'	20'	5'
Deck	214'	214'	41'
East Approach	20'	20'	5'
Subtotal	2412'	2412'	582'
x2 coats paint	x2	x2	x2
	=4824'	=4824'	=1164'

GENERAL NOTES

Plan dimensions and details relative to existing plans are subject to nominal construction variations. The Contractor shall field verify existing dimensions and details affecting new construction and make necessary approved adjustments prior to construction or ordering of materials. Such variations shall not be cause for additional compensation for a change in scope of the work, however, the Contractor will be paid for the quantity actually furnished at the unit price bid for the work

Existing reinforcement if exposed shall be cleaned and incorporated into the new construction. Cost included with Deck Slab Repair.

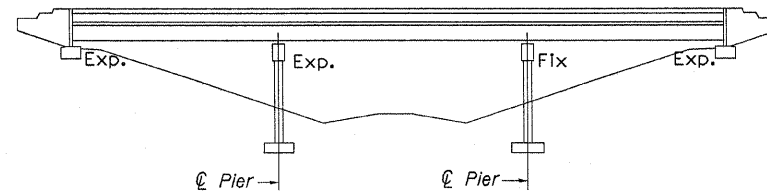

Elevation

Curve Data
 $\Delta = 29^\circ - 19' - 45''$
 $D = 1^\circ$
 $T = 1499.36'$
 $L = 2932.91'$
 $E = 192.93'$
 $R = 5729.65'$
 $S.E. = 0.010'$

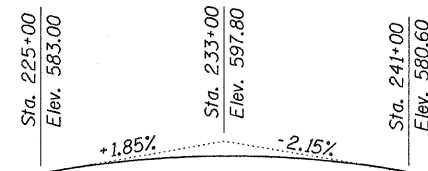

Profile Grade
 Along C Survey F.A.I. Route 280

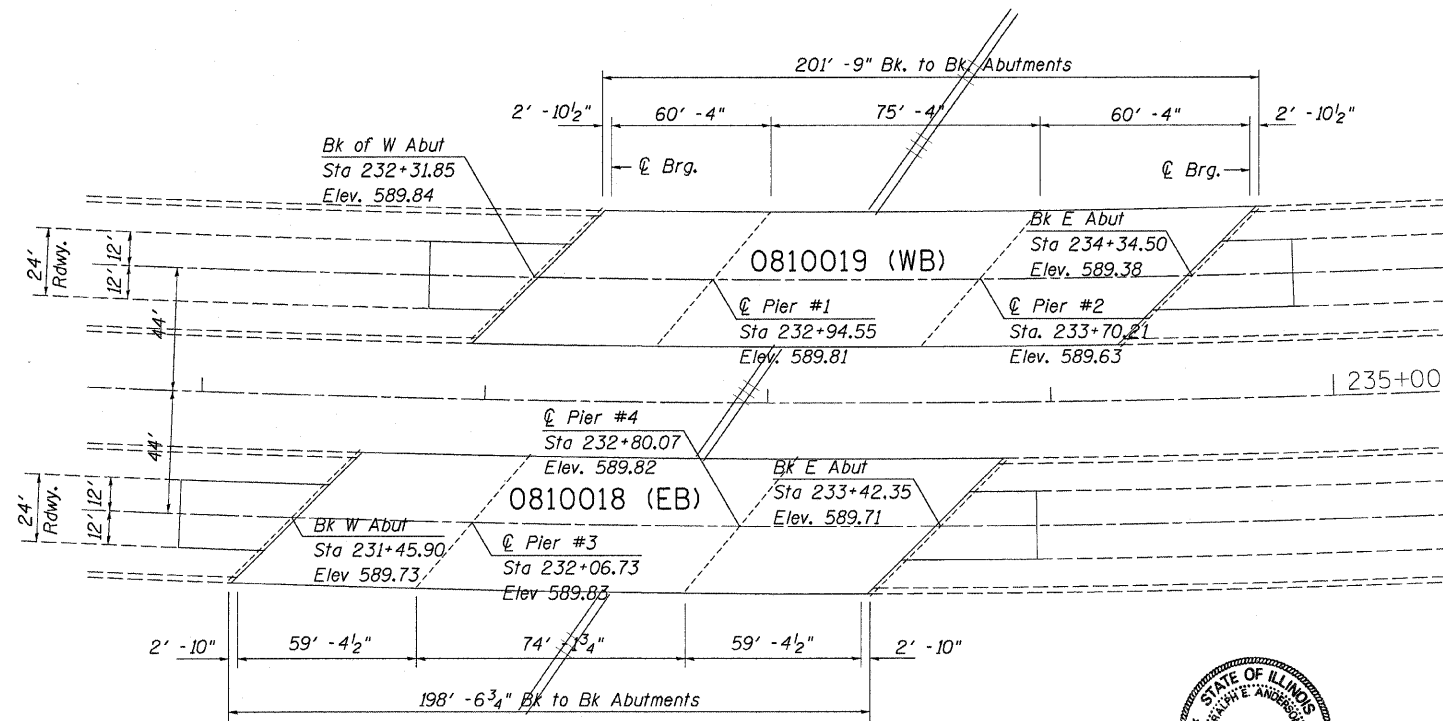

Plan

TOTAL BILL OF MATERIAL

DECK SLAB REPAIR (FULL DEPTH)	SQ YD	80
DECK SLAB REPAIR (PARTIAL)	SQ YD	238

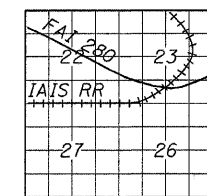

LOCATION SKETCH

GENERAL PLAN & ELEVATION
 I-280 OVER IOWA INTERSTATE RAILROAD
 FAI ROUTE 280 SECTION D2 BR WEAR SURF I-280
 STA. 232+86.50
 ROCK ISLAND COUNTY
 STRUCTURE NUMBER 081-0018 (E.B.)
 STRUCTURE NUMBER 081-0019 (W.B.)



Expires Nov. 30, 2010

FILE NAME =	USER NAME = lmkdj	DESIGNED -	REVISED -	STATE OF ILLINOIS DEPARTMENT OF TRANSPORTATION	GENERAL PLAN & ELEVATION 081-0018 & 081-0019		F.A.I. RTE. =	SECTION	COUNTY	TOTAL SHEETS	SHEET NO.
D:\BR\CADD plans\Rock Island County\2010	280 deck repair\PLANeng.dgn	DRAWN -	REVISED -				280	*	ROCK ISLAND	19	5
PLOT SCALE = 50.0000' / IN.	CHECKED -	REVISED -	REVISED -				CONTRACT NO. 64F92				
PLOT DATE = Thu Nov 05 11:01:43 2009	DATE -	REVISED -	REVISED -				ILLINOIS FED. AID PROJECT				

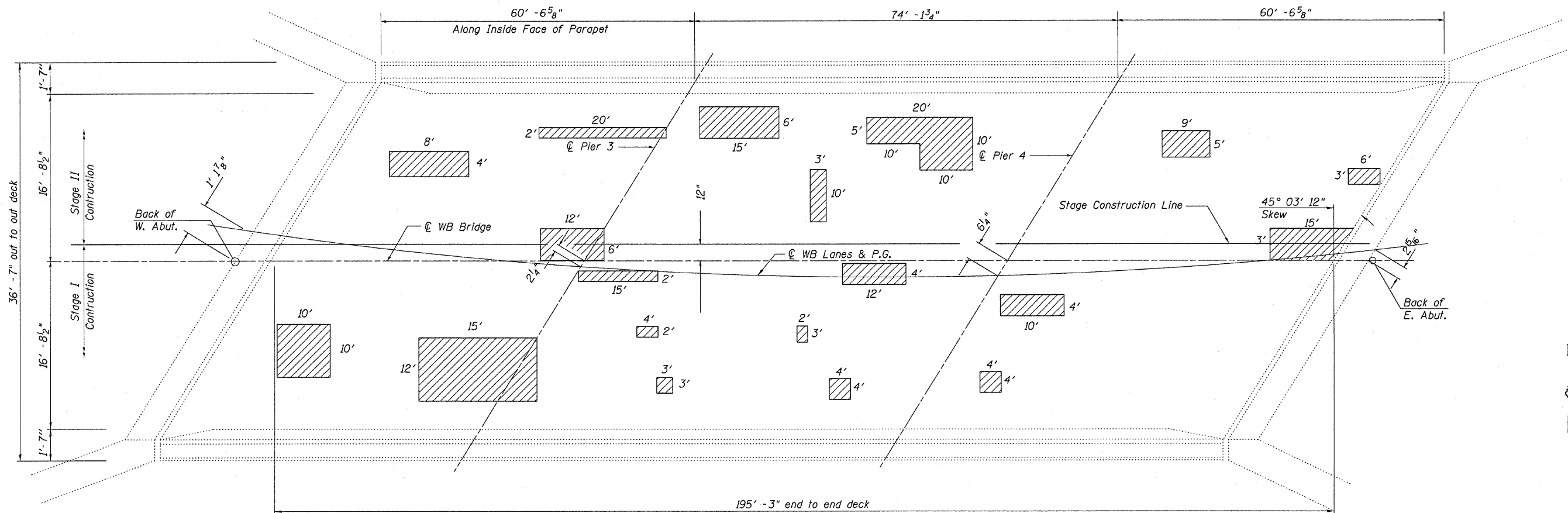

Legend
 Potential Deck Slab Repair (Partial)
 Date of Survey 10/2009

PLAN
 Areas shown for repair are potential areas of deck slab repair. Actual locations and quantities to be determined in the field. Resident Engineer to contact District Bridge Office for assistance with locating patches.

BILL OF MATERIAL
 Eastbound

DECK SLAB REPAIR (FULL DEPTH)	SQ YD	40
DECK SLAB REPAIR (PARTIAL)	SQ YD	110

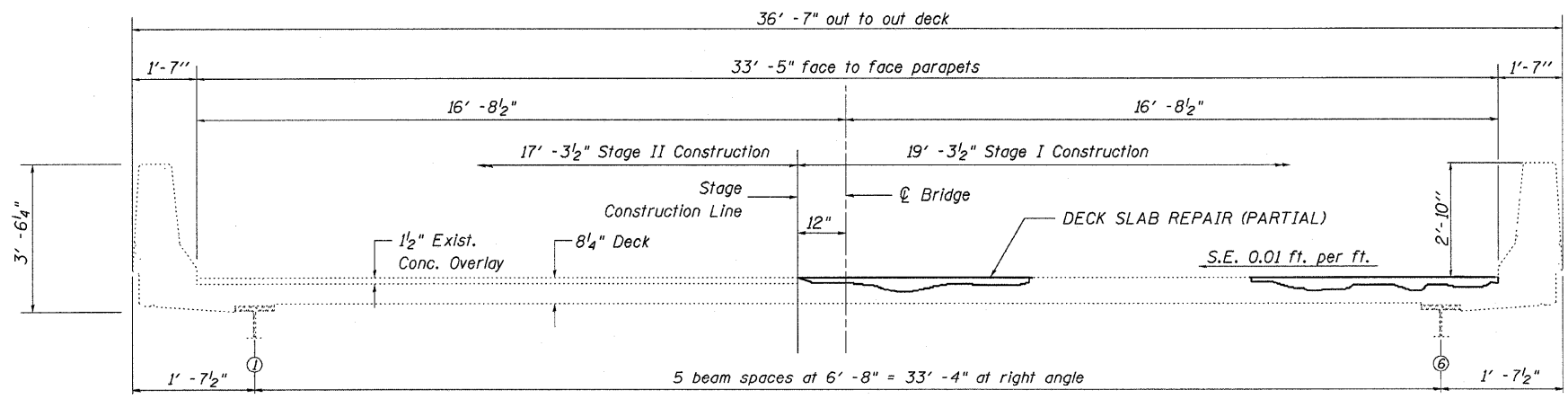

CROSS SECTION
 (Looking East)

SUPERSTRUCTURE
EAST BOUND LANES
STRUCTURE NO. 081-0018 (E.B.)
FAI ROUTE 280 Section D2 Br Wear Surf I-280
Rock Island County
Sta. 232+86.50

FILE NAME = G:\BRYCADD plans\Rock Island County\2010	USER NAME = inkdj	DESIGNED -	REVISED -	STATE OF ILLINOIS DEPARTMENT OF TRANSPORTATION	Superstructure 081-0018	F.A.I. RTE. 280	SECTION D2 BR WEAR SURF I-280	COUNTY Rock Island	TOTAL SHEETS 19	SHEET NO. 6		
280 deck repair\PLANeng.dgn	DRAWN -	REVISED -	SCALE: _____			SHEET NO. _____ OF _____ SHEETS	STA. _____ TO STA. _____	ILLINOIS FED. AID PROJECT				
PLOT SCALE = 58.0000' / IN.	CHECKED -	REVISED -										
PLOT DATE = Thu Nov 05 11:01:52 2009	DATE -	REVISED -										

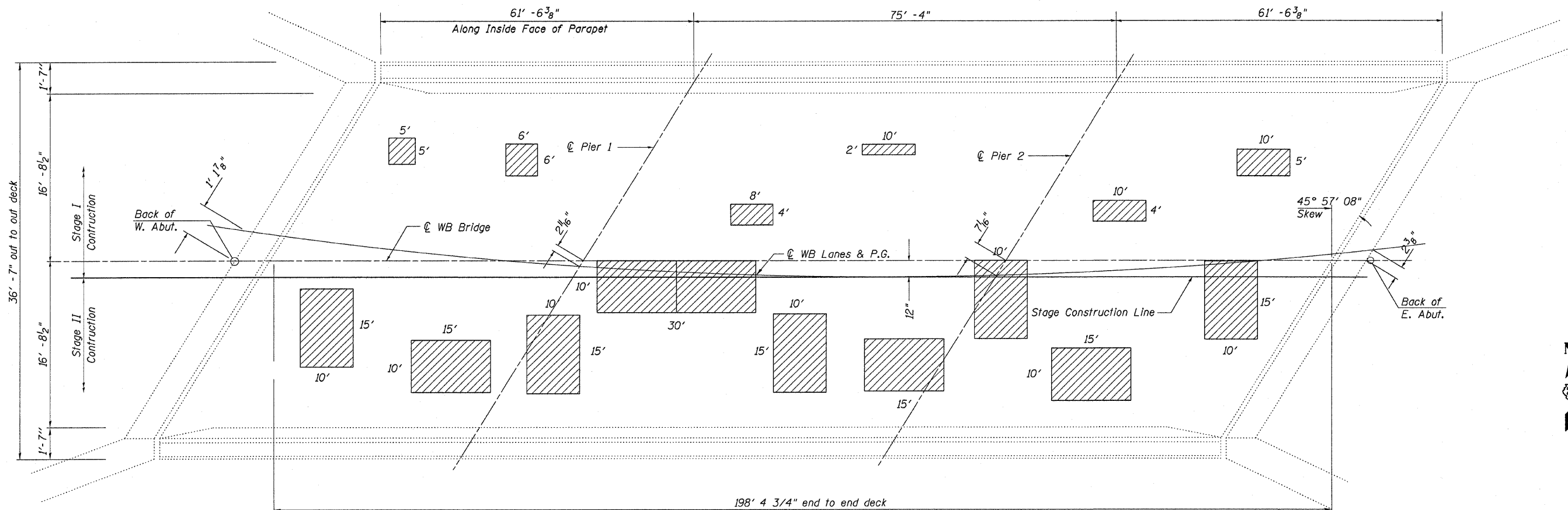

Legend
 Potential Deck Slab Repair (Partial)
 Date of Survey 10/2009

PLAN
 Areas shown for repair are potential areas of deck slab repair. Actual locations and quantities to be determined in the field. Resident Engineer to contact District Bridge Office for assistance with locating patches.

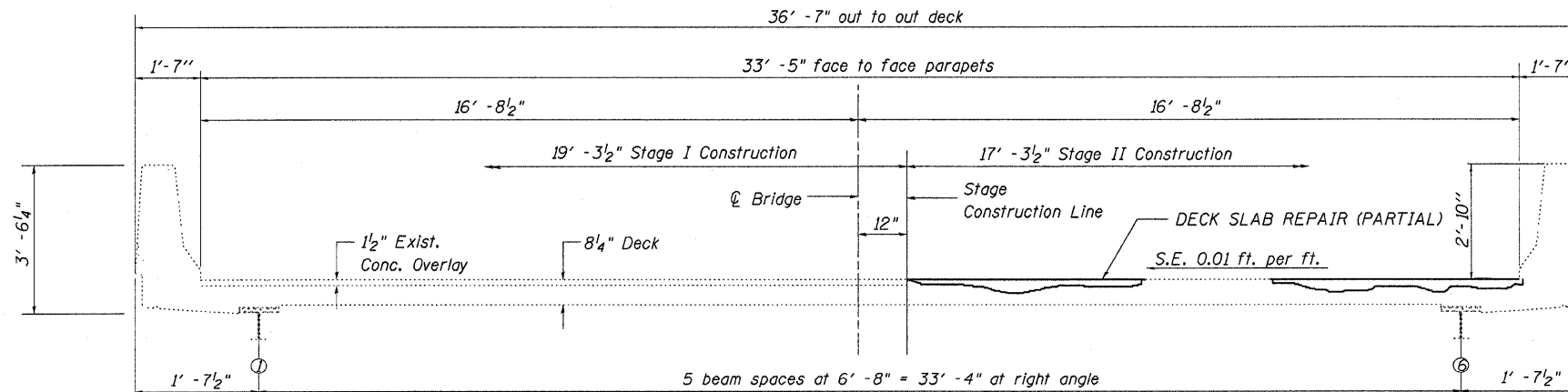

CROSS SECTION
 (Looking East)

BILL OF MATERIAL
 Westbound

Item	Unit	Quantity
DECK SLAB REPAIR (FULL DEPTH)	SQ YD	40
DECK SLAB REPAIR (PARTIAL)	SQ YD	128

SUPERSTRUCTURE
WEST BOUND LANES
 STRUCTURE NO. 081-0019 (W.B.)
 FAI ROUTE 280 Section D2 Br Wear Surf I-280
 Rock Island County
 Sta. 232+86.50

FILE NAME = G:\BR\CA00 plans\Rock Island County\2010	USER NAME = linkdj	DESIGNED -	REVISED -	STATE OF ILLINOIS DEPARTMENT OF TRANSPORTATION	SUPERSTRUCTURE 081-0019	F.A.I. RTE. 280	SECTION *	COUNTY ROCK ISLAND	TOTAL SHEETS 19	SHEET NO. 7	
280 deck repair\PLANeng.dgn	DRAWN -	REVISED -	SCALE: _____			SHEET NO. _____	OF _____ SHEETS	STA. _____	TO STA. _____	ILLINOIS FED. AID PROJECT	
PLOT SCALE = 50,000 / IN.	CHECKED -	REVISED -									
PLOT DATE = Thu Nov 05 11:01:57 2009	DATE -	REVISED -									

GENERAL NOTES

Plan dimensions and details relative to existing plans are subject to nominal construction variations. The Contractor shall field verify existing dimensions and details affecting new construction and make necessary approved adjustments prior to construction or ordering of materials. Such variations shall not be cause for additional compensation for a change in scope of the work, however, the Contractor will be paid for the quantity actually furnished at the unit price bid for the work

Existing reinforcement if exposed shall be cleaned and incorporated into the new construction. Cost included with Deck Slab Repair.

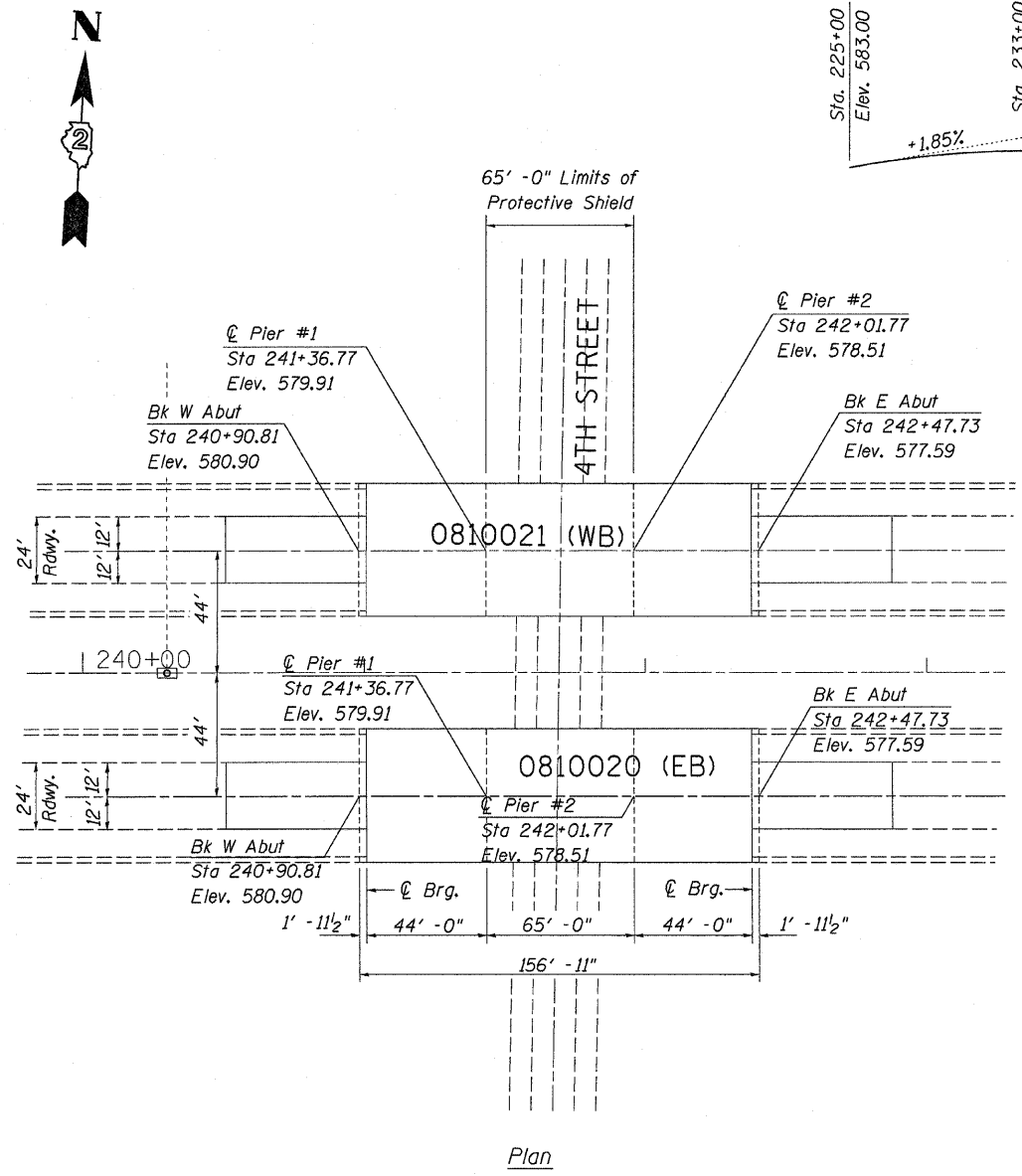
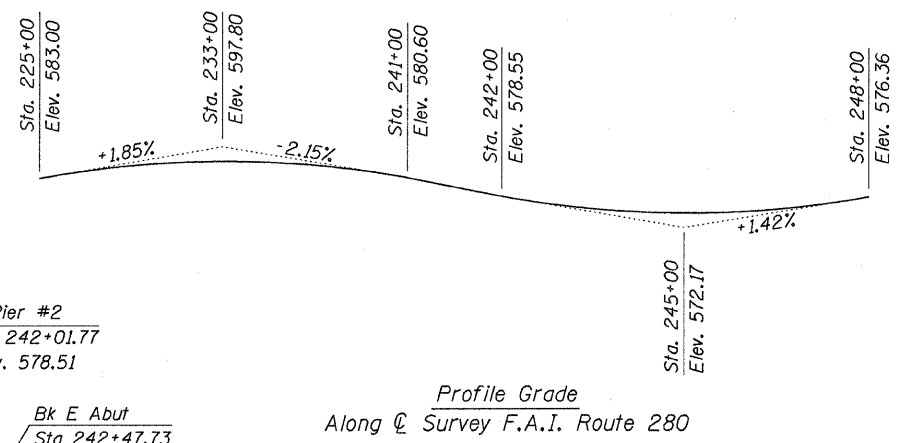
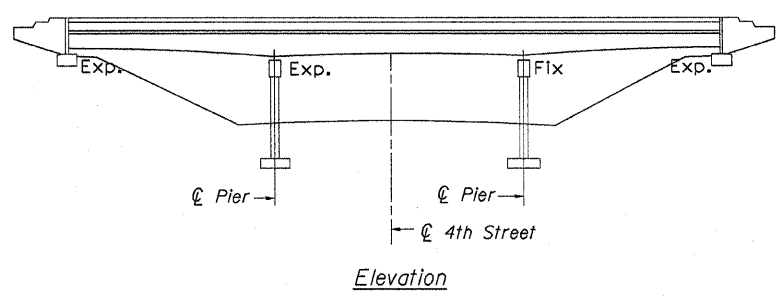

TOTAL BILL OF MATERIAL

PROTECTIVE SHIELD	SQ YD	356
DECK SLAB REPAIR (FULL DEPTH)	SQ YD	64
DECK SLAB REPAIR (PARTIAL)	SQ YD	287

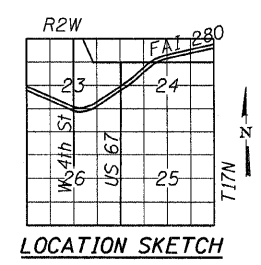

GENERAL PLAN & ELEVATION
 I-280 OVER WEST 4th STREET
 FAI ROUTE 280 SECTION D2 BR WEAR SURF I-280
 STA. 241+69.27
 ROCK ISLAND COUNTY
 STRUCTURE NUMBER 081-0020 (E.B.)
 STRUCTURE NUMBER 081-0021 (W.B.)

FILE NAME = G:\BR\CADD plans\Rock Island County\2010	USER NAME = lirkdj	DESIGNED -	REVISED -	STATE OF ILLINOIS DEPARTMENT OF TRANSPORTATION	GENERAL PLAN & ELEVATION 081-0020 & 081-0021	F.A.I. RTE. 280	SECTION *	COUNTY ROCK ISLAND	TOTAL SHEETS 19	SHEET NO. 8		
280 deck repair\PLANeng.dgn	DRAWN -	REVISED -	SCALE: _____			SHEET NO. ___ OF ___ SHEETS	STA. _____ TO STA. _____	ILLINOIS FED. AID PROJECT				
PLOT SCALE = 58.0000' / IN.	CHECKED -	REVISED -										
PLOT DATE = Thu Nov 05 11:02:04 2009	DATE -	REVISED -										

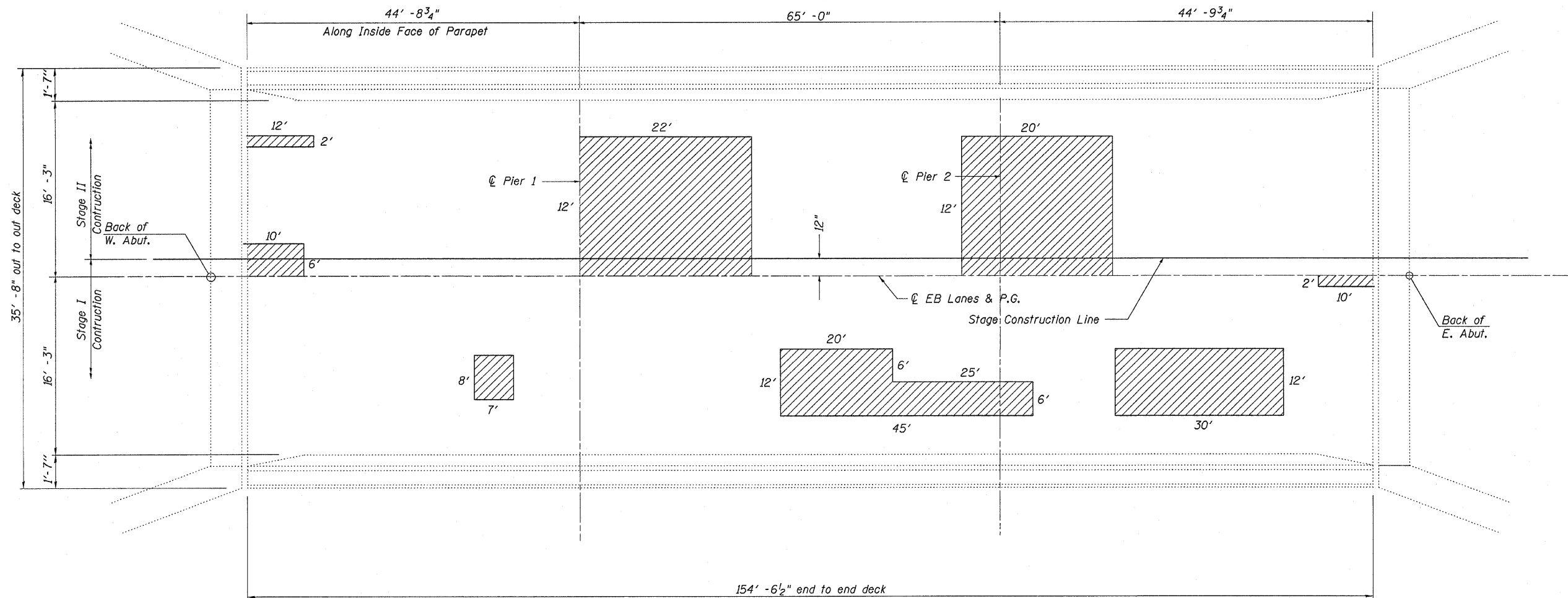

Legend

Potential Deck Slab Repair (Partial)

Date of Survey 10/2009

PLAN

Areas shown for repair are potential areas of deck slab repair. Actual locations and quantities to be determined in the field. Resident Engineer to contact District Bridge Office for assistance with locating patches.

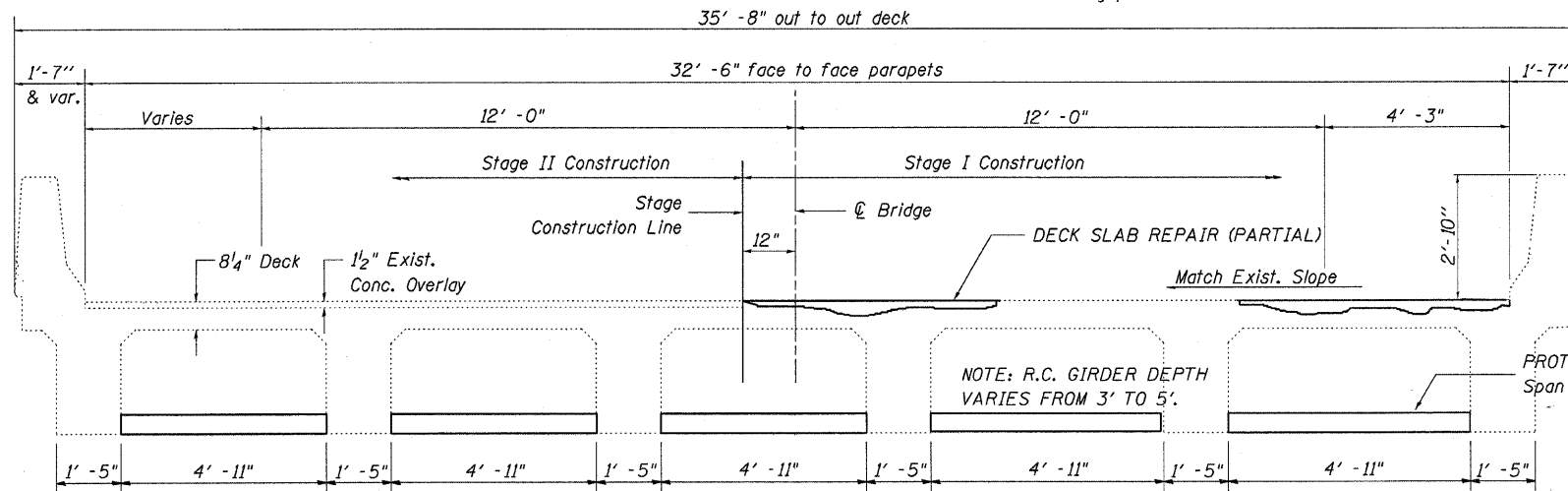

CROSS SECTION
(Looking East)

BILL OF MATERIAL
Eastbound

PROTECTIVE SHIELD	SQ YD	178
DECK SLAB REPAIR (FULL DEPTH)	SQ YD	32
DECK SLAB REPAIR (PARTIAL)	SQ YD	158

Contractor is not allowed to drill into the stems of the T-girders in order to anchor the required Protective Shield system.

SUPERSTRUCTURE
EAST BOUND LANES
STRUCTURE NO. 081-0020 (E.B.)
FAI ROUTE 280 Section D2 Br Wear Surf I-280
Rock Island County
Sta. 241+69.27

FILE NAME = G:\BRV\CADD plans\Rock Island County\2010	USER NAME = lmkdj	DESIGNED -	REVISED -	STATE OF ILLINOIS DEPARTMENT OF TRANSPORTATION	SUPERSTRUCTURE 081-0020	F.A.J. RTE. 280	SECTION *	COUNTY ROCK ISLAND	TOTAL SHEETS 19	SHEET NO. 9	
280 deck repair\PLANeng.dgn	DRAWN -	REVISED -	REVISED -			SCALE: _____	SHEET NO. ____ OF ____ SHEETS	ILLINOIS FED. AID PROJECT	CONTRACT NO. 64F92		
PLOT SCALE = 58,0000' / IN.	CHECKED -	REVISED -	REVISED -			STA. _____ TO STA. _____					
PLOT DATE = Thu Nov 05 11:02:10 2009	DATE -	REVISED -	REVISED -								

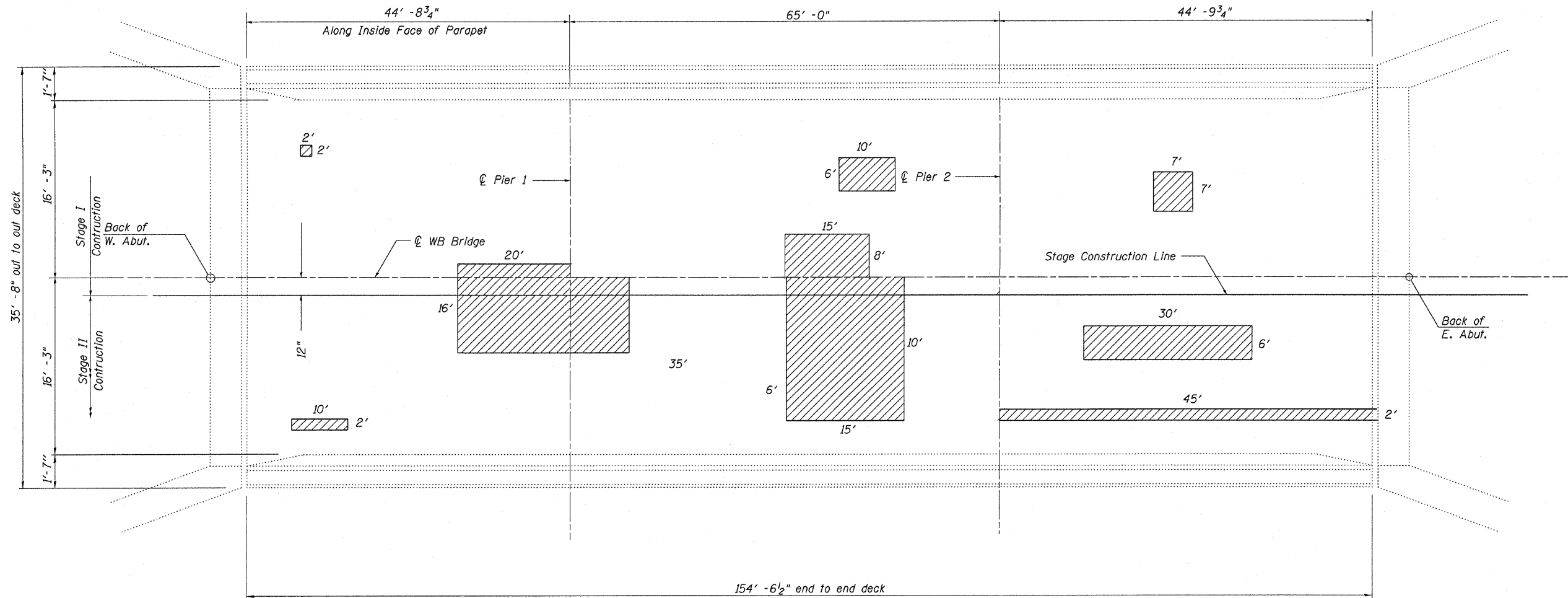

Legend
 Potential Deck Slab Repair (Partial)
 Date of Survey 10/2009

PLAN
 Areas shown for repair are potential areas of deck slab repair. Actual locations and quantities to be determined in the field. Resident Engineer to contact District Bridge Office for assistance with locating patches.

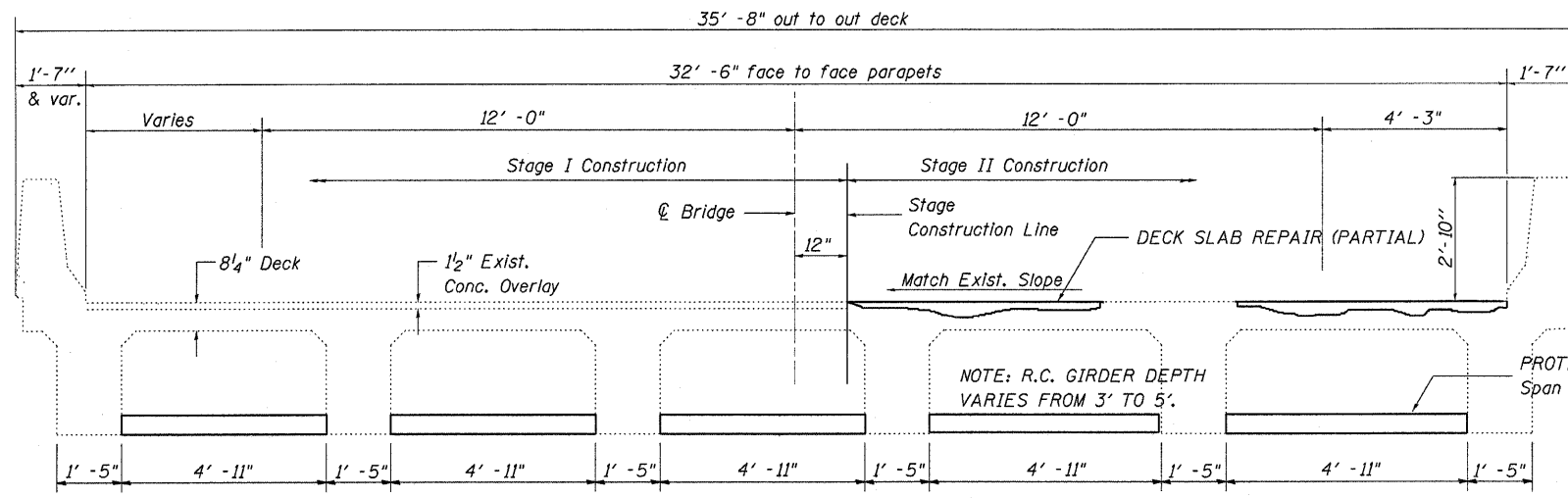

CROSS SECTION
 (Looking East)

Contractor is not allowed to drill into the stems of the T-girders in order to anchor the required Protective Shield system.

BILL OF MATERIAL
 Westbound

PROTECTIVE SHIELD	SQ YD	178
DECK SLAB REPAIR (FULL DEPTH)	SQ YD	32
DECK SLAB REPAIR (PARTIAL)	SQ YD	129

SUPERSTRUCTURE
WEST BOUND LANES
 STRUCTURE NO. 081-0021 (W.B.)
 FAI ROUTE 280 Section D2 Br Wear Surf I-280
 Rock Island County
 Sta. 241+69.27

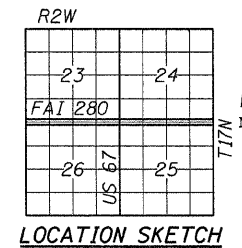
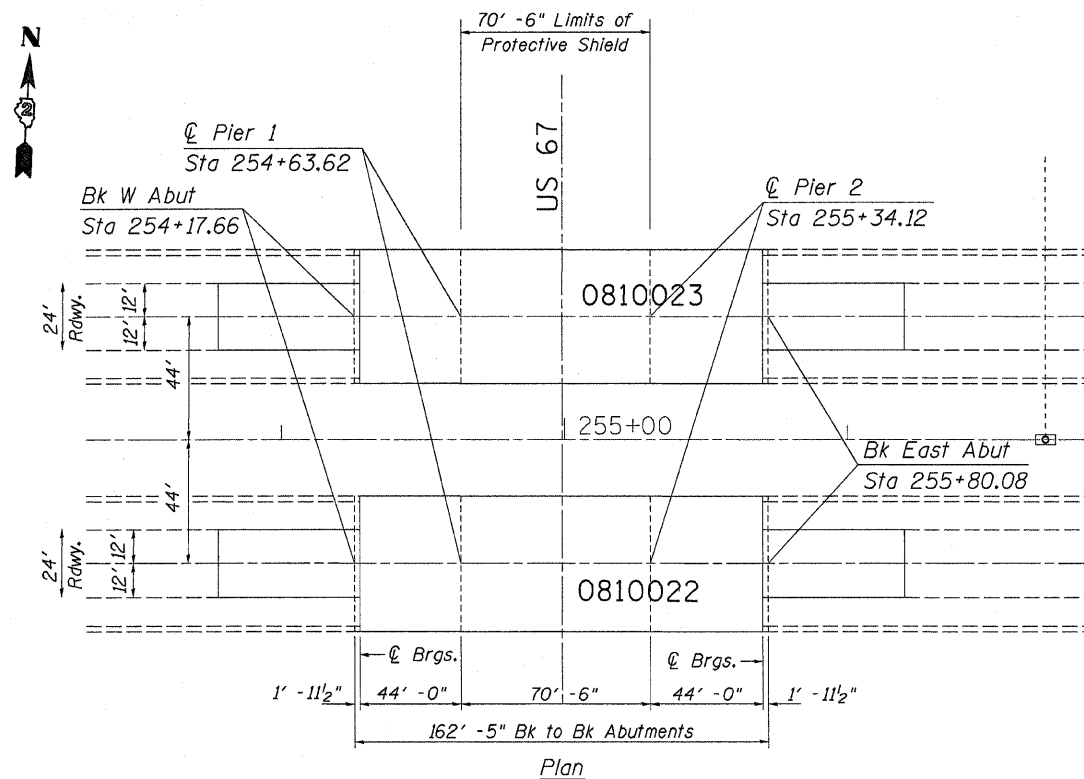
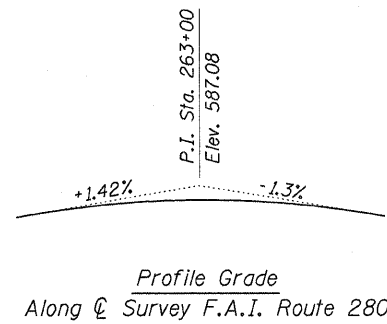
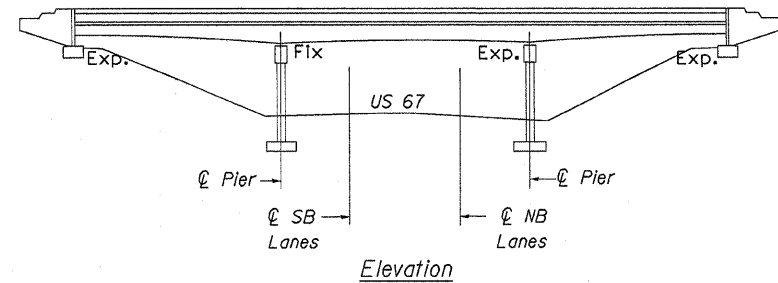

GENERAL NOTES

Plan dimensions and details relative to existing plans are subject to nominal construction variations. The Contractor shall field verify existing dimensions and details affecting new construction and make necessary approved adjustments prior to construction or ordering of materials. Such variations shall not be cause for additional compensation for a change in scope of the work, however, the Contractor will be paid for the quantity actually furnished at the unit price bid for the work

Existing reinforcement if exposed shall be cleaned and incorporated into the new construction. Cost included with Deck Slab Repair.

TOTAL BILL OF MATERIAL

ITEM	UNIT	QUANTITY
PROTECTIVE SHIELD	SQ YD	386
DECK SLAB REPAIR (FULL DEPTH)	SQ YD	66
DECK SLAB REPAIR (PARTIAL)	SQ YD	211



Expires Nov. 30, 2010

GENERAL PLAN & ELEVATION
I-280 OVER US ROUTE 67
FAI ROUTE 280 SECTION D2 BR WEAR SURF I-280
STA. 254+98.87
ROCK ISLAND COUNTY
STRUCTURE NUMBER 081-0022 (E.B.)
STRUCTURE NUMBER 081-0023 (W.B.)

FILE NAME = G:\BR\CAOD plans\Rock Island County\2010	USER NAME = linkdj	DESIGNED -	REVISED -	STATE OF ILLINOIS DEPARTMENT OF TRANSPORTATION	GENERAL PLAN & ELEVATION 081-0022 & 081-0023	F.A.I. RTE. 280	SECTION *	COUNTY ROCK ISLAND	TOTAL SHEETS 19	SHEET NO. 11	
280 deck repair\PLANeng.dgn	DRAWN -	REVISED -	SCALE: _____			SHEET NO. _____ OF _____ SHEETS	STA. _____ TO STA. _____	ILLINOIS FED. AID PROJECT		CONTRACT NO. 64F92	
PLOT SCALE = 50.0000' / IN.	CHECKED -	REVISED -									
PLOT DATE = Thu Nov 05 11:02:24 2009	DATE -	REVISED -									

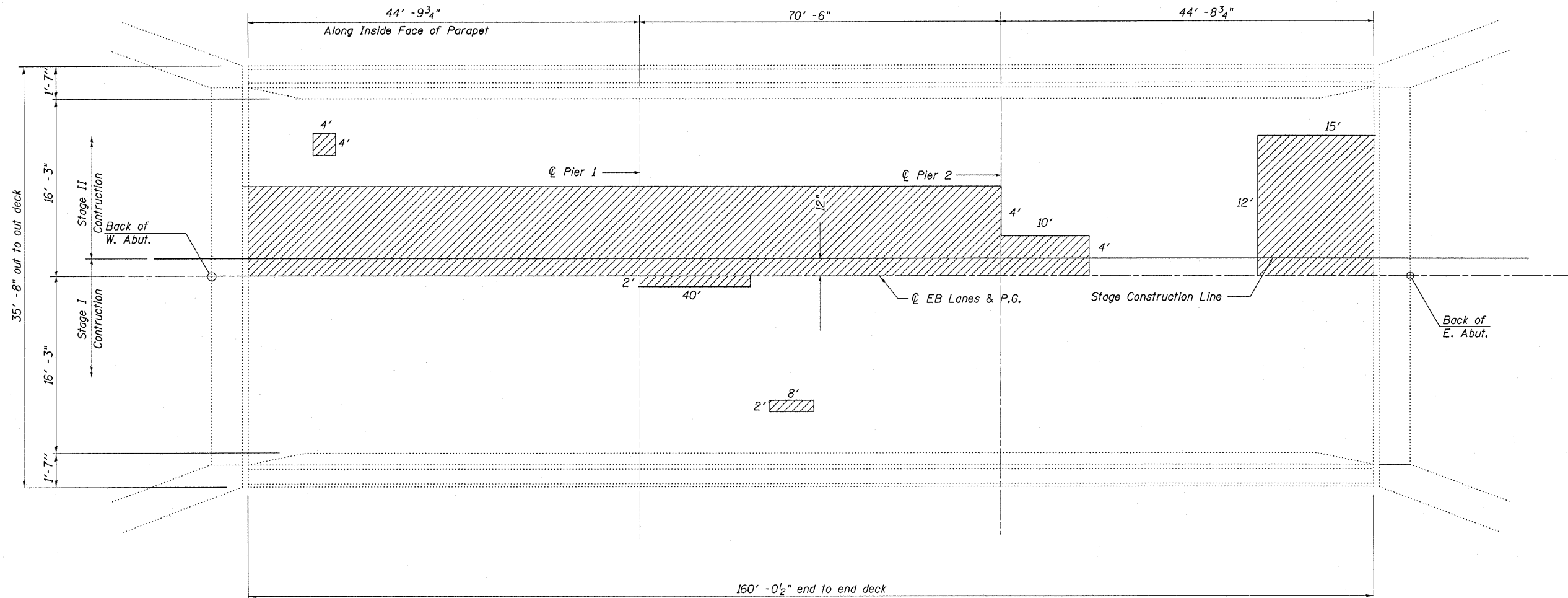

Legend

Potential Deck Slab Repair (Partial)

Date of Survey 10/2009

PLAN

Areas shown for repair are potential areas of deck slab repair. Actual locations and quantities to be determined in the field. Resident Engineer to contact District Bridge Office for assistance with locating patches.

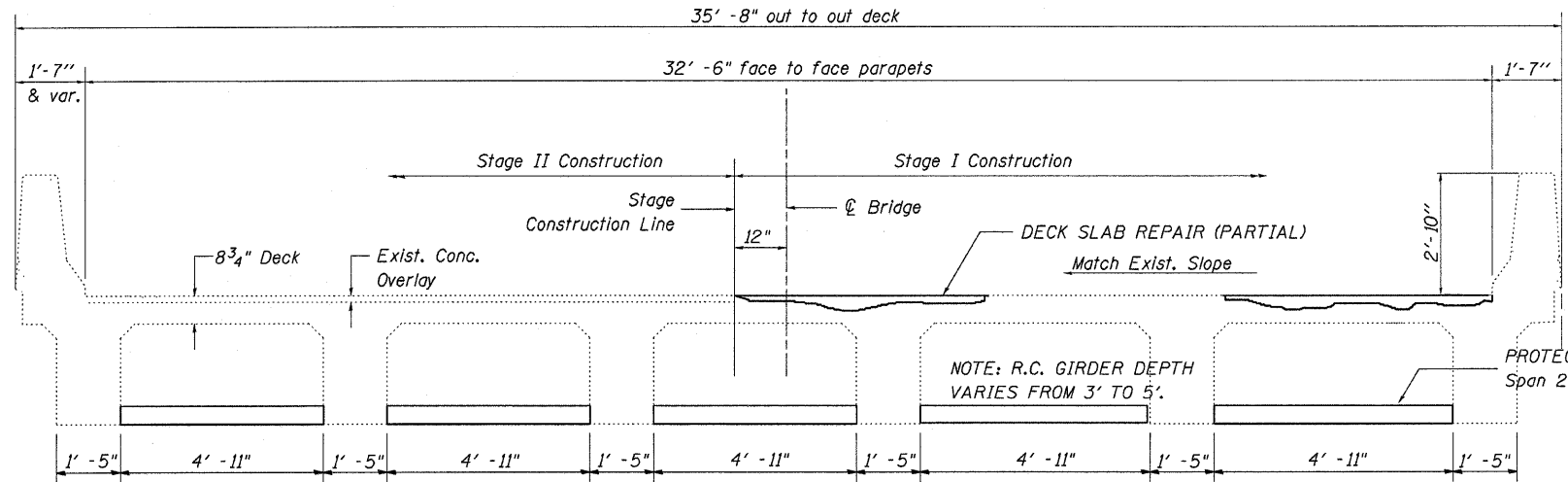

CROSS SECTION
(Looking East)

BILL OF MATERIAL
Eastbound

ITEM	UNIT	QUANTITY
PROTECTIVE SHIELD	SQ YD	193
DECK SLAB REPAIR (FULL DEPTH)	SQ YD	33
DECK SLAB REPAIR (PARTIAL)	SQ YD	101

Contractor is not allowed to drill into the stems of the T-girders in order to anchor the required Protective Shield system.

SUPERSTRUCTURE
EAST BOUND LANES
STRUCTURE NO. 081-0022 (E.B.)
FAI ROUTE 280 Section D2 Br Wear Surf I-280
Rock Island County
Sta. 254+98.87

FILE NAME = G:\BRY\CADD plans\Rock Island County\2010\280 deck repair\PLANeng.dgn	USER NAME = llnkdj	DESIGNED -	REVISED -	STATE OF ILLINOIS DEPARTMENT OF TRANSPORTATION	SUPERSTRUCTURE 081-0022	F.A.I. RTE. 280	SECTION *	COUNTY ROCK ISLAND	TOTAL SHEETS 19	SHEET NO. 12	
PLOT SCALE = 50,0000' / IN.	CHECKED -	REVISED -	SCALE: _____			SHEET NO. _____ OF _____ SHEETS	STA. _____ TO STA. _____	ILLINOIS FED. AID PROJECT			
PLOT DATE = Thu Nov 05 11:02:31 2009	DATE -	REVISED -	CONTRACT NO. 64F92								
							* D2 BR WEAR SURF I-280				

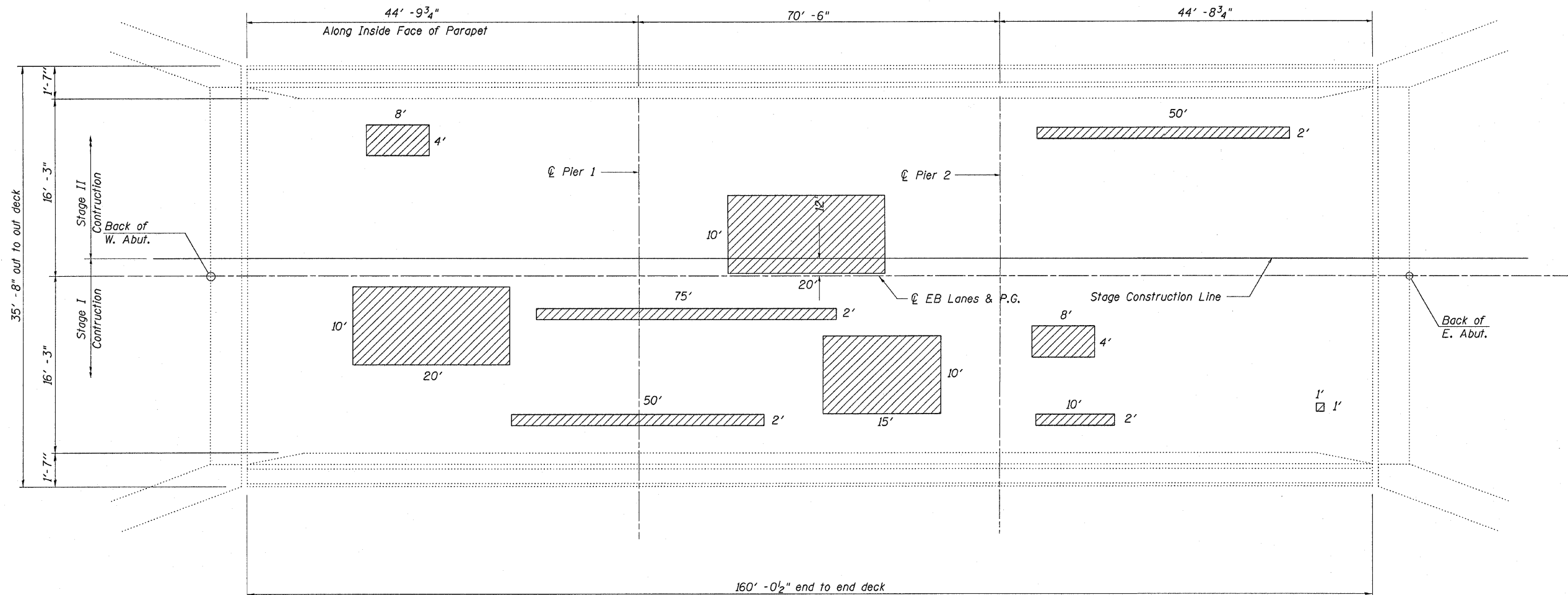

Legend

Potential Deck Slab Repair (Partial)

Date of Survey 10/2009

PLAN

Areas shown for repair are potential areas of deck slab repair. Actual locations and quantities to be determined in the field. Resident Engineer to contact District Bridge Office for assistance with locating patches.

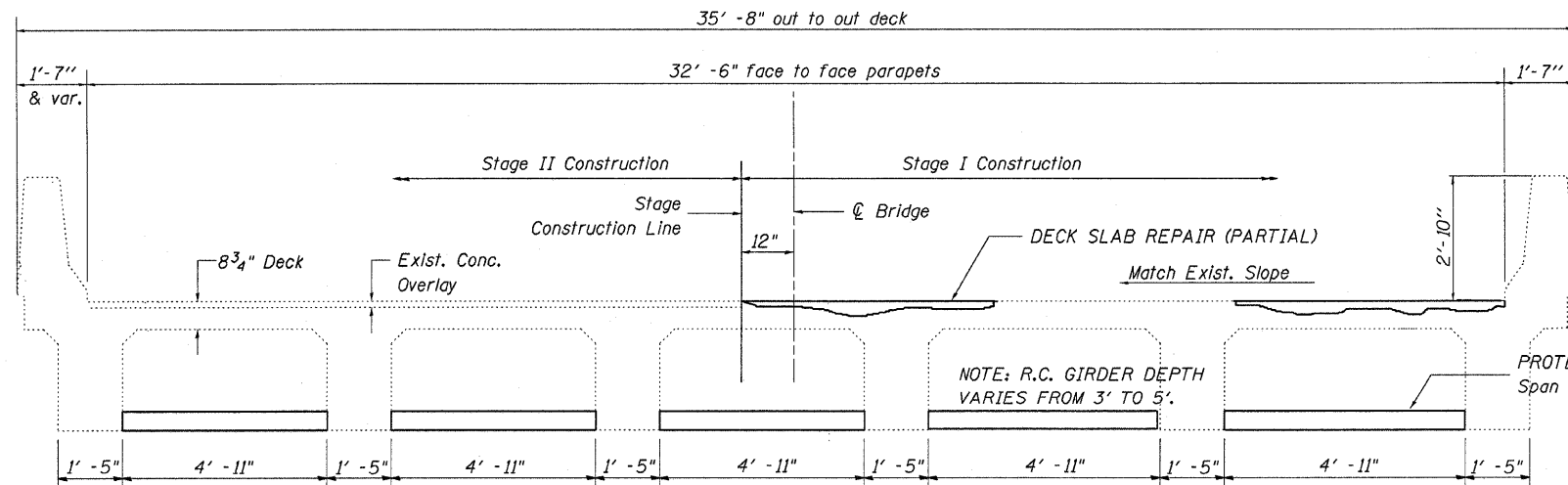

CROSS SECTION
(Looking West)

Contractor is not allowed to drill into the stems of the T-girders in order to anchor the required Protective Shield system.

BILL OF MATERIAL

Westbound

ITEM	UNIT	QUANTITY
PROTECTIVE SHIELD	SQ YD	193
DECK SLAB REPAIR (FULL DEPTH)	SQ YD	33
DECK SLAB REPAIR (PARTIAL)	SQ YD	110

SUPERSTRUCTURE
WEST BOUND LANES
STRUCTURE NO. 081-0023 (W.B.)
FAI ROUTE 280 Section D2 Br Wear Surf I-280
Rock Island County
Sta. 254+98.87

FILE NAME =	USER NAME = linkdj	DESIGNED -	REVISD -
D:\BRV\CADD plans\Rock Island County\2010	280 deck repair\PLANeng.dgn	DRAWN -	REVISD -
	PLOT SCALE = 58.0000' / IN.	CHECKED -	REVISD -
	PLOT DATE = Thu Nov 05 11:03:00 2009	DATE -	REVISD -

STATE OF ILLINOIS
DEPARTMENT OF TRANSPORTATION

SUPERSTRUCTURE
081-0023

SCALE: _____ SHEET NO. ____ OF ____ SHEETS STA. _____ TO STA. _____

F.A.I. RTE.	SECTION	COUNTY	TOTAL SHEETS	SHEET NO.
280	*	ROCK ISLAND	19	13
			CONTRACT NO. 64F92	
ILLINOIS FED. AID PROJECT				

• D2 BR WEAR SURF I-280

GENERAL NOTES

Plan dimensions and details relative to existing plans are subject to nominal construction variations. The Contractor shall field verify existing dimensions and details affecting new construction and make necessary approved adjustments prior to construction or ordering of materials. Such variations shall not be cause for additional compensation for a change in scope of the work, however, the Contractor will be paid for the quantity actually furnished at the unit price bid for the work

Existing reinforcement if exposed shall be cleaned and incorporated into the new construction. Cost included with Deck Slab Repair.

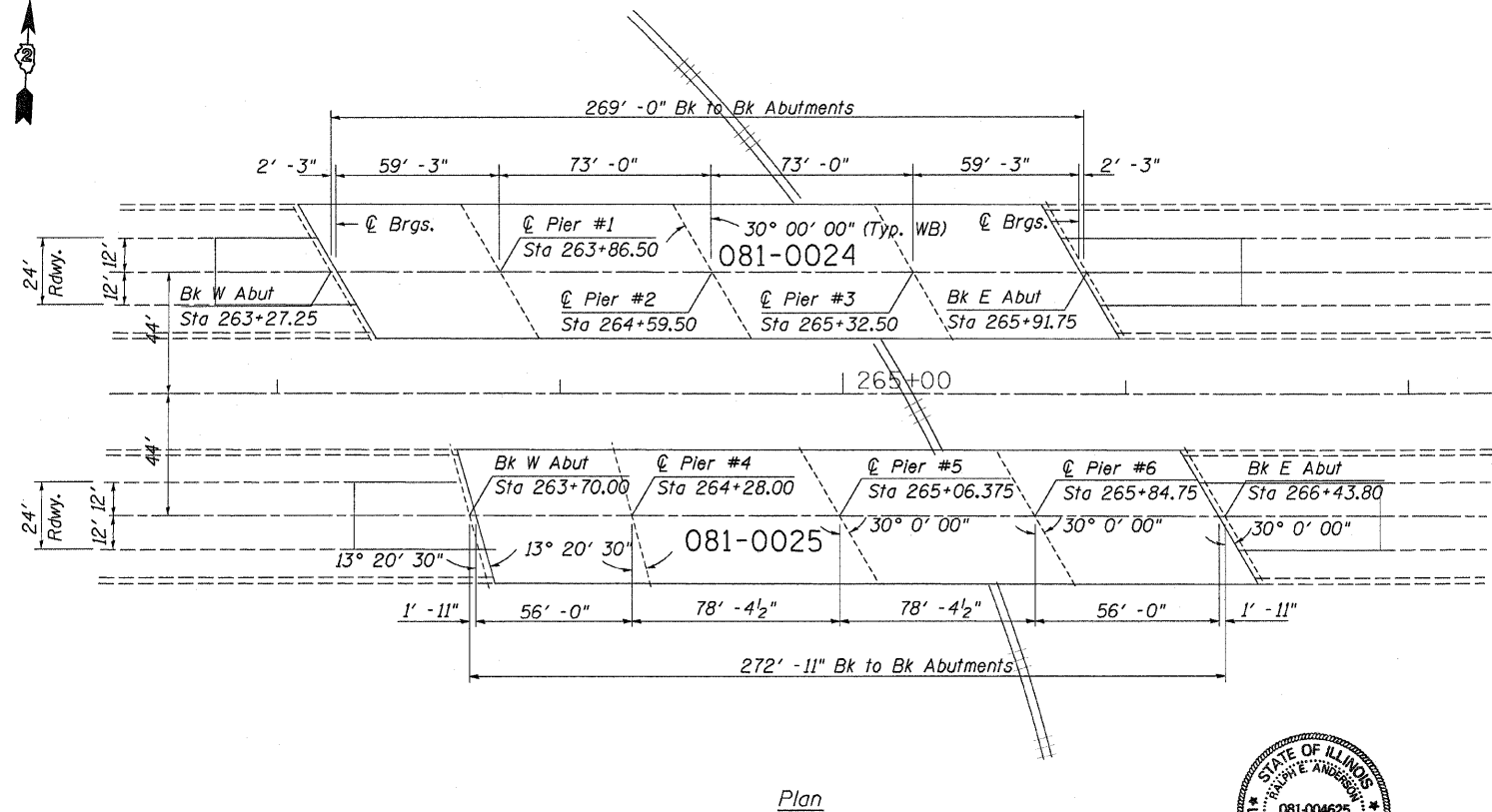
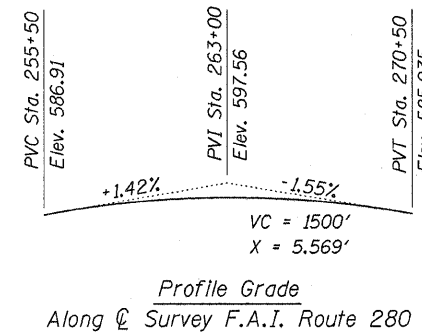
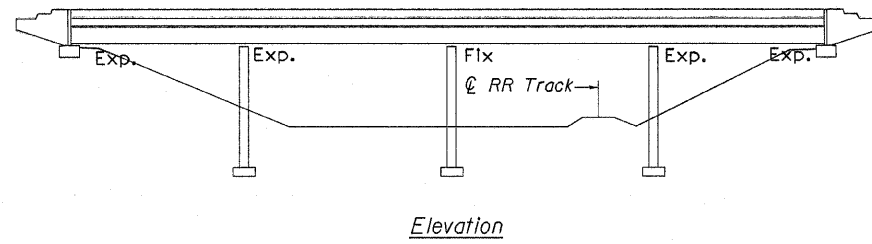

TOTAL BILL OF MATERIAL

DECK SLAB REPAIR (FULL DEPTH)	SQ YD	108
DECK SLAB REPAIR (PARTIAL)	SQ YD	329



Exp. 11/30/2010

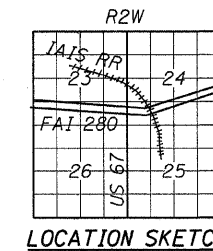

GENERAL PLAN & ELEVATION
 I-280 OVER IAIS RAILROAD
 FAI ROUTE 280 SECTION D2 BR WEAR SURF I-280
 STA. 264+83.02
 ROCK ISLAND COUNTY
 STRUCTURE NUMBER 081-0024 (W.B.)
 STRUCTURE NUMBER 081-0025 (E.B.)

FILE NAME =	USER NAME = linkdj	DESIGNED -	REVISED -	STATE OF ILLINOIS DEPARTMENT OF TRANSPORTATION	GENERAL PLAN & ELEVATION 081-0024 & 081-0025	F.A.I. RTE. =	SECTION	COUNTY	TOTAL SHEETS	SHEET NO.	
D:\BR\CAADD plans\Rock Island County\2010	280 deck repair\PLANeng.dgn	DRAWN -	REVISED -			280	*	ROCK ISLAND	19	14	
PLOT SCALE = 50.0000' / IN.	CHECKED -	REVISED -	REVISED -			CONTRACT NO. 64F92					
PLOT DATE = Thu Nov 05 11:03:07 2009	DATE -	REVISED -	REVISED -			ILLINOIS FED. AID PROJECT					

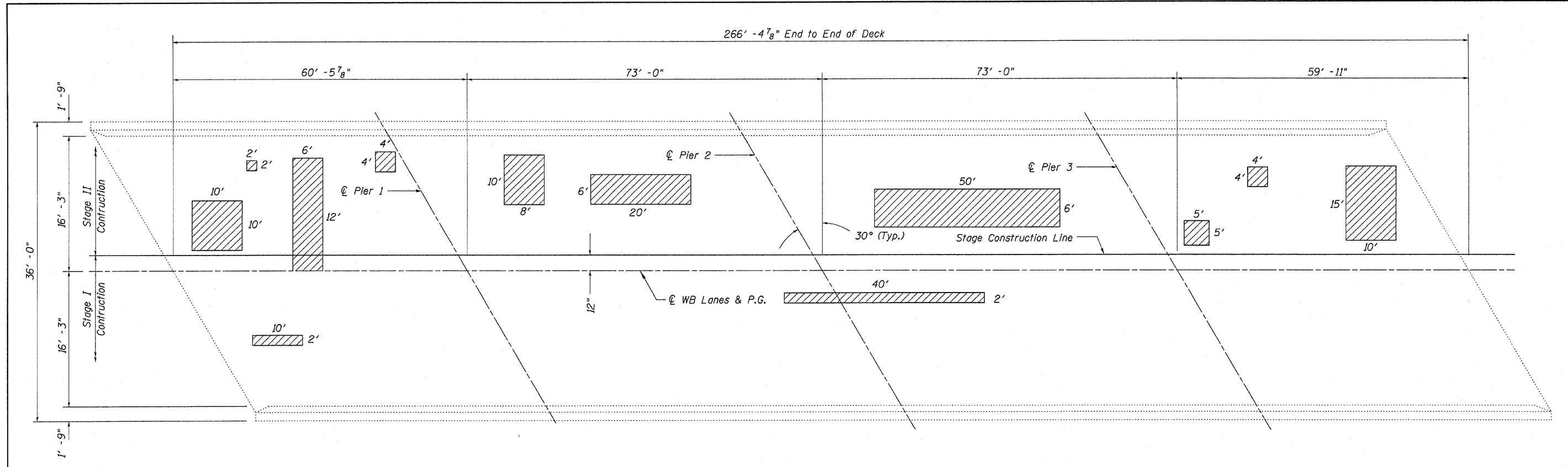

Legend
 Potential Deck Slab Repair (Partial)
 Date of Survey 10/2009

PLAN
 Areas shown for repair are potential areas of deck slab repair. Actual locations and quantities to be determined in the field. Resident Engineer to contact District Bridge Office for assistance with locating patches.

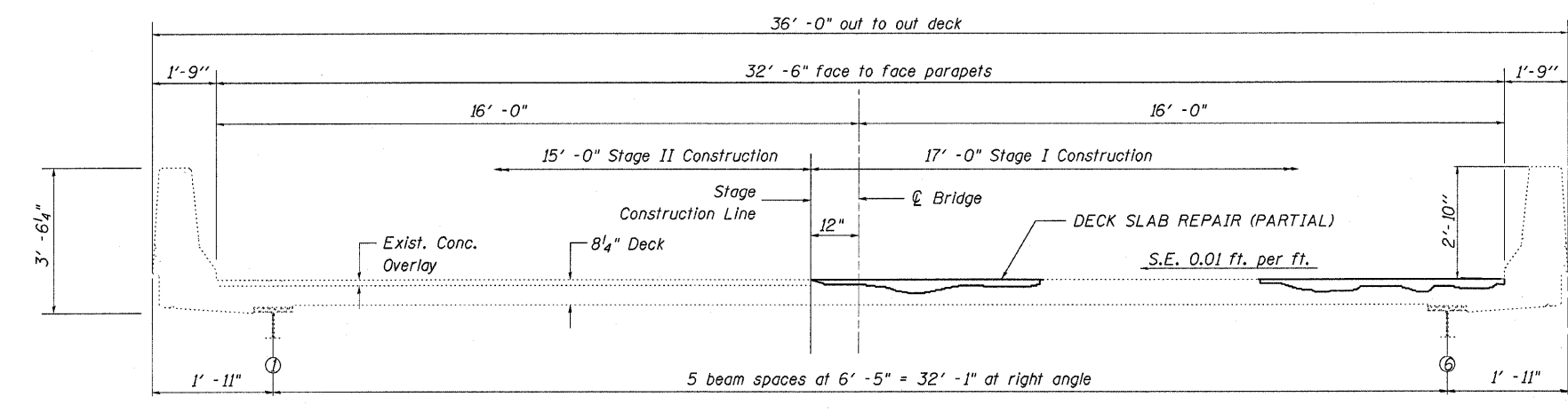

CROSS SECTION
 (Looking East)

BILL OF MATERIAL
 Westbound

DECK SLAB REPAIR (FULL DEPTH)	SQ YD	54
DECK SLAB REPAIR (PARTIAL)	SQ YD	110

SUPERSTRUCTURE
WEST BOUND LANES
 STRUCTURE NO. 081-0024 (W.B.)
 FAI ROUTE 280 Section D2 Br Wear Surf I-280
 Rock Island County
 Sta. 264+83.02

FILE NAME = G:\BRV\CADD plans\Rock Island County\2010\280 deck repair\PLANeng.dgn	USER NAME = lirkdj	DESIGNED -	REVISED -	STATE OF ILLINOIS DEPARTMENT OF TRANSPORTATION	SUPERSTRUCTURE 081-0024	F.A.I. RTE. 280	SECTION *	COUNTY ROCK ISLAND	TOTAL SHEETS 19	SHEET NO. 15		
PLOT SCALE = 58,0000' / IN.	CHECKED -	REVISED -	SCALE: _____			SHEET NO. ___ OF ___ SHEETS	STA. _____ TO STA. _____	ILLINOIS FED. AID PROJECT				
PLOT DATE = Thu Nov 05 11:03:14 2009	DATE -	REVISED -	* D2 BR WEAR SURF I-280									

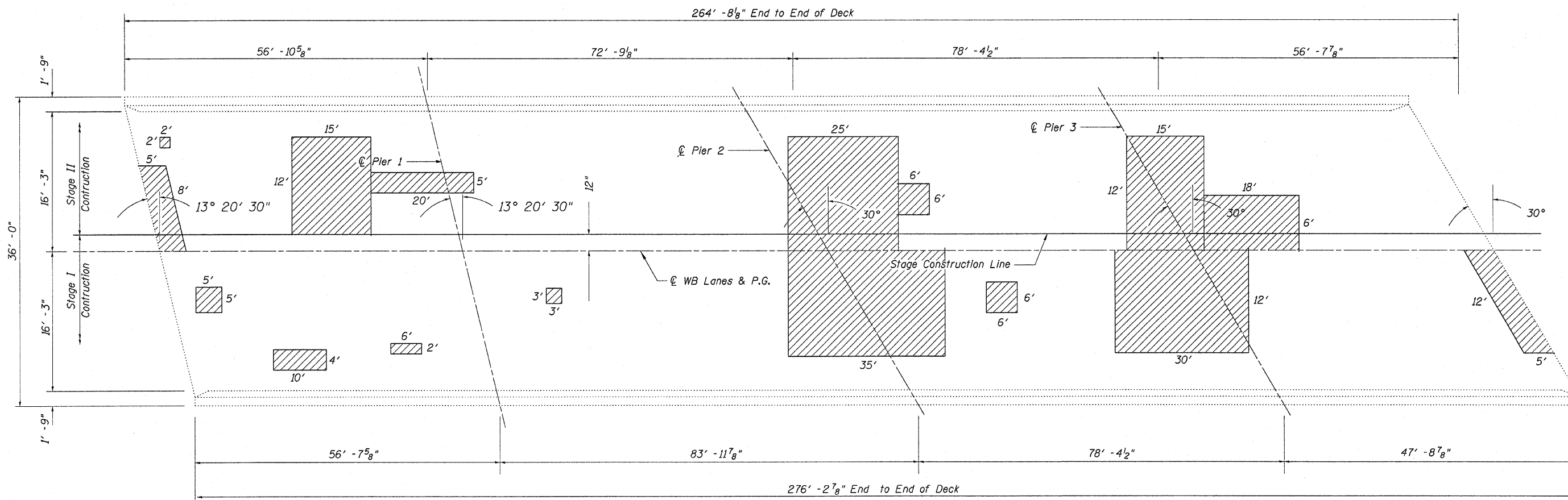

Legend

Potential Deck Slab Repair (Partial)

Date of Survey 10/2009

PLAN

Areas shown for repair are potential areas of deck slab repair. Actual locations and quantities to be determined in the field. Resident Engineer to contact District Bridge Office for assistance with locating patches.

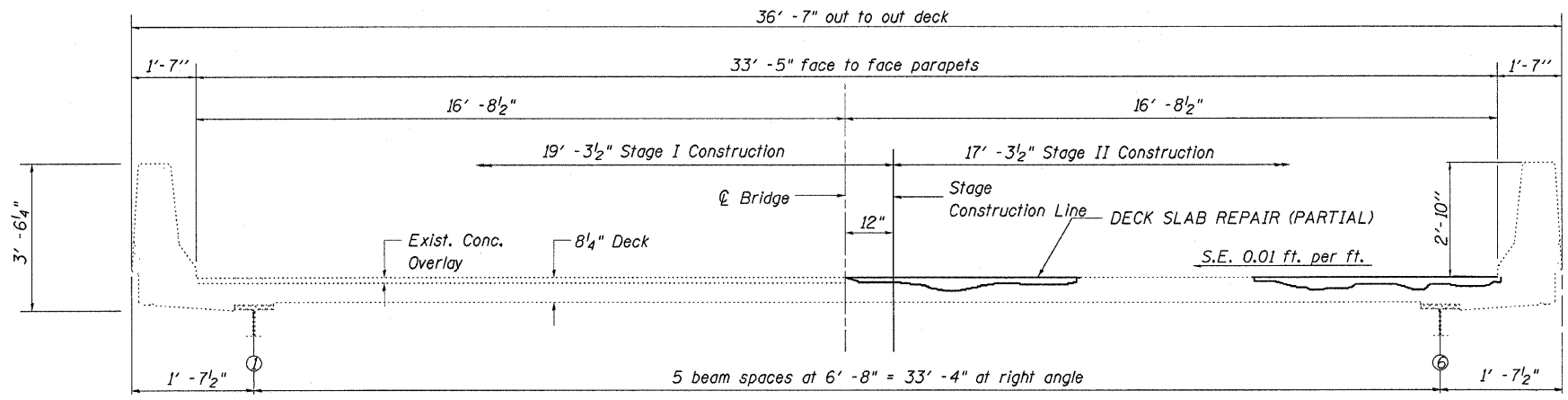

CROSS SECTION
(Looking East)

BILL OF MATERIAL
Eastbound

DECK SLAB REPAIR (FULL DEPTH)	SQ YD	54
DECK SLAB REPAIR (PARTIAL)	SQ YD	219

SUPERSTRUCTURE
EAST BOUND LANES
STRUCTURE NO. 081-0025 (E.B.)
FAI ROUTE 280 Section D2 Br Wear Surf I-280
Rock Island County
Sta. 264+83.02

FILE NAME = G:\BRV\CADD plans\Rock Island County\2010	USER NAME = lirkdj	DESIGNED -	REVISED -	STATE OF ILLINOIS DEPARTMENT OF TRANSPORTATION	SUPERSTRUCTURE 081-0025	F.A.I. RTE. 280	SECTION *	COUNTY ROCK ISLAND	TOTAL SHEETS 19	SHEET NO. 16	
280 deck repair\PLANeng.dgn	DRAWN -	REVISED -	SCALE: _____			SHEET NO. ____ OF ____ SHEETS	STA. _____ TO STA. _____	ILLINOIS FED. AID PROJECT			
PLOT SCALE = 50.0000' / IN.	CHECKED -	REVISED -									
PLOT DATE = Thu Nov 05 11:03:21 2009	DATE -	REVISED -									

GENERAL NOTES

Plan dimensions and details relative to existing plans are subject to nominal construction variations. The Contractor shall field verify existing dimensions and details affecting new construction and make necessary approved adjustments prior to construction or ordering of materials. Such variations shall not be cause for additional compensation for a change in scope of the work, however, the Contractor will be paid for the quantity actually furnished at the unit price bid for the work

Existing reinforcement if exposed shall be cleaned and incorporated into the new construction. Cost included with Deck Slab Repair.

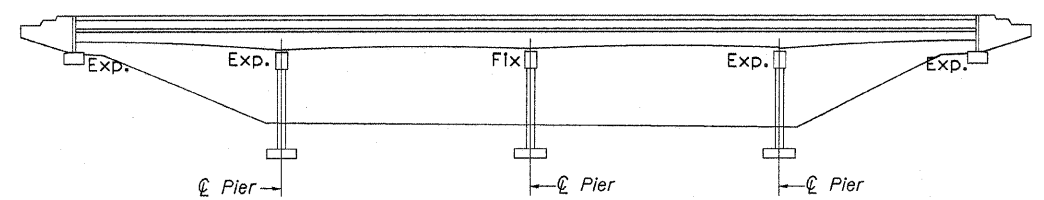

Elevation

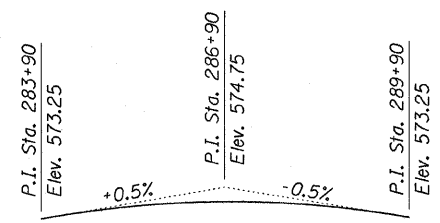

Profile Grade
Along ϕ Survey F.A.I. Route 280

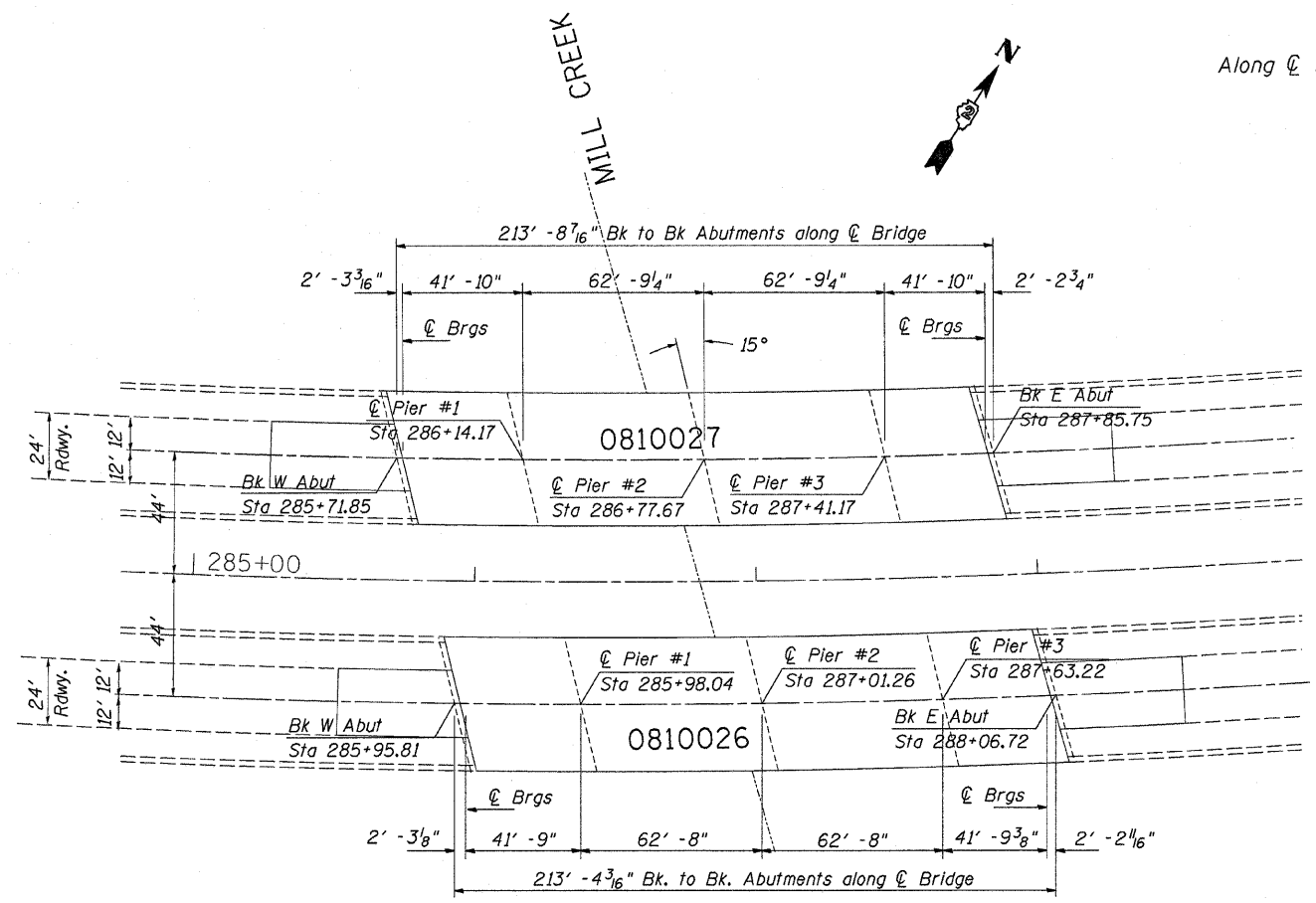

Plan

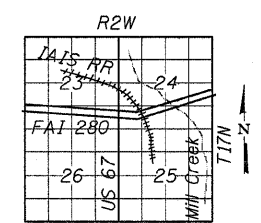

LOCATION SKETCH

TOTAL BILL OF MATERIAL

Item	Unit	Quantity
DECK SLAB REPAIR (FULL DEPTH)	SQ YD	86
DECK SLAB REPAIR (PARTIAL)	SQ YD	377

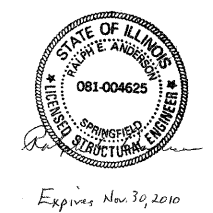

GENERAL PLAN & ELEVATION
I-280 OVER MILL CREEK
FAI ROUTE 280 SECTION D2 BR WEAR SURF I-280
STA. 286+90
ROCK ISLAND COUNTY
STRUCTURE NUMBER 081-0026 (E.B.)
STRUCTURE NUMBER 081-0027 (W.B.)

FILE NAME = G:\BRY\CADD\plans\Rock Island County\2010	USER NAME = linkdj	DESIGNED -	REVISED -	STATE OF ILLINOIS DEPARTMENT OF TRANSPORTATION	GENERAL PLAN & ELEVATION 081-0026 & 081-0027	F.A.I. RTE. = 280	SECTION = *	COUNTY = ROCK ISLAND	TOTAL SHEETS = 19	SHEET NO. = 17	
280 deck repair\PLANeng.dgn		DRAWN -	REVISED -			SCALE: _____	SHEET NO. _____ OF _____ SHEETS	STA. _____ TO STA. _____	ILLINOIS FED. AID PROJECT		
PLOT SCALE = 50,000' / IN.		CHECKED -	REVISED -								
PLOT DATE = Thu Nov 05 11:03:28 2009		DATE -	REVISED -			* D2 BR WEAR SURF I-280					

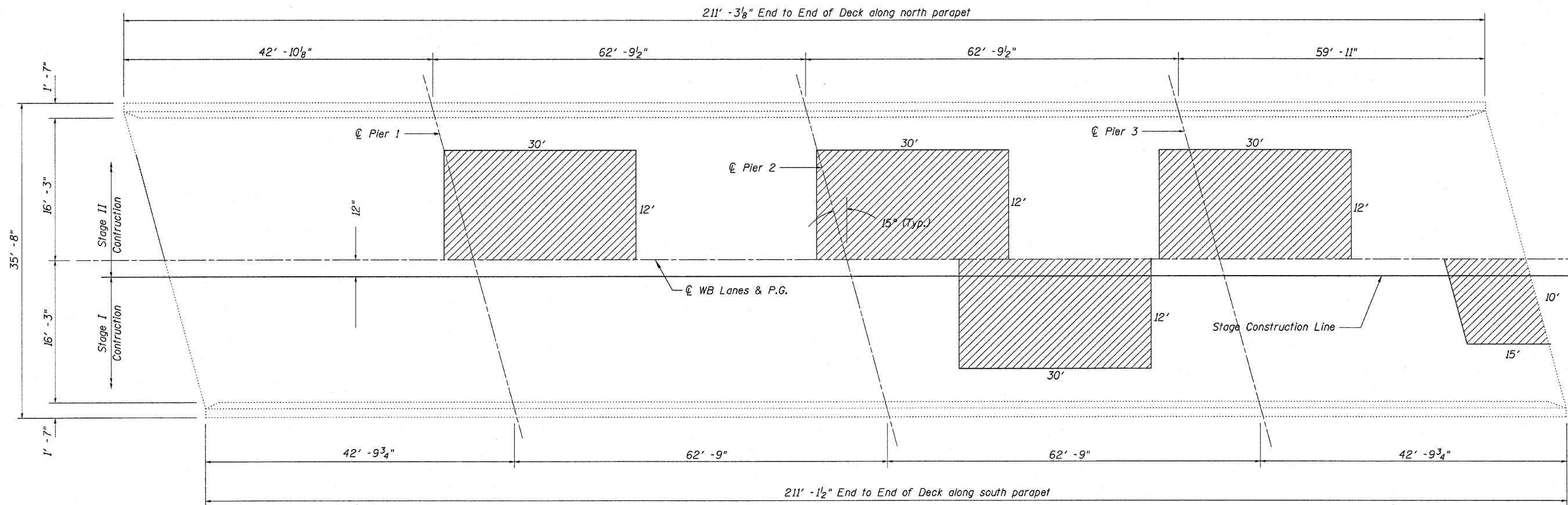

Legend

Potential Deck Slab Repair (Partial)

Date of Survey 10/2009

PLAN

Areas shown for repair are potential areas of deck slab repair. Actual locations and quantities to be determined in the field. Resident Engineer to contact District Bridge Office for assistance with locating patches.

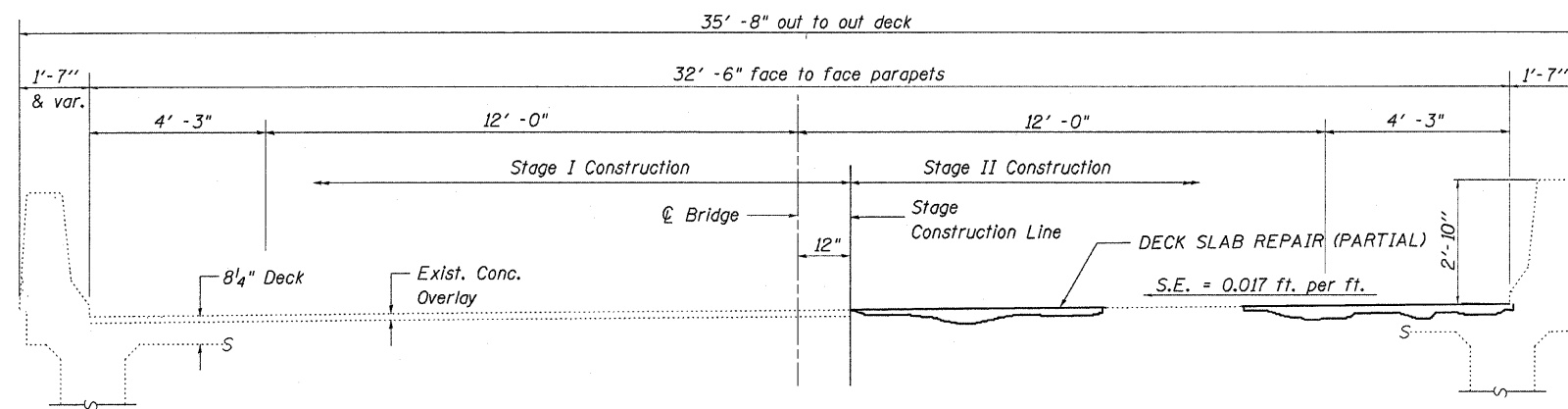

CROSS SECTION
(Looking East)

BILL OF MATERIAL
Eastbound

DECK SLAB REPAIR (FULL DEPTH)	SQ YD	43
DECK SLAB REPAIR (PARTIAL)	SQ YD	177

SUPERSTRUCTURE
EAST BOUND LANES
STRUCTURE NO. 081-0026 (E.B.)
FAI ROUTE 280 Section D2 Br Wear Surf I-280
Rock Island County
Sta. 286+90

FILE NAME = G:\BRV\CADD plans\Rock Island County\2010\280 deck repair\PLANeng.dgn	USER NAME = linkdj	DESIGNED -	REVISED -	STATE OF ILLINOIS DEPARTMENT OF TRANSPORTATION	SUPERSTRUCTURE 081-0026	F.A.I. RTE. 280	SECTION *	COUNTY ROCK ISLAND	TOTAL SHEETS 19	SHEET NO. 18		
PLOT SCALE = 50.0000' / IN.	CHECKED -	REVISED -	SCALE: _____			SHEET NO. _____ OF _____ SHEETS	STA. _____ TO STA. _____	ILLINOIS FED. AID PROJECT				
PLOT DATE = Thu Nov 05 11:03:36 2009	DATE -	REVISED -										
* D2 BR WEAR SURF I-280												

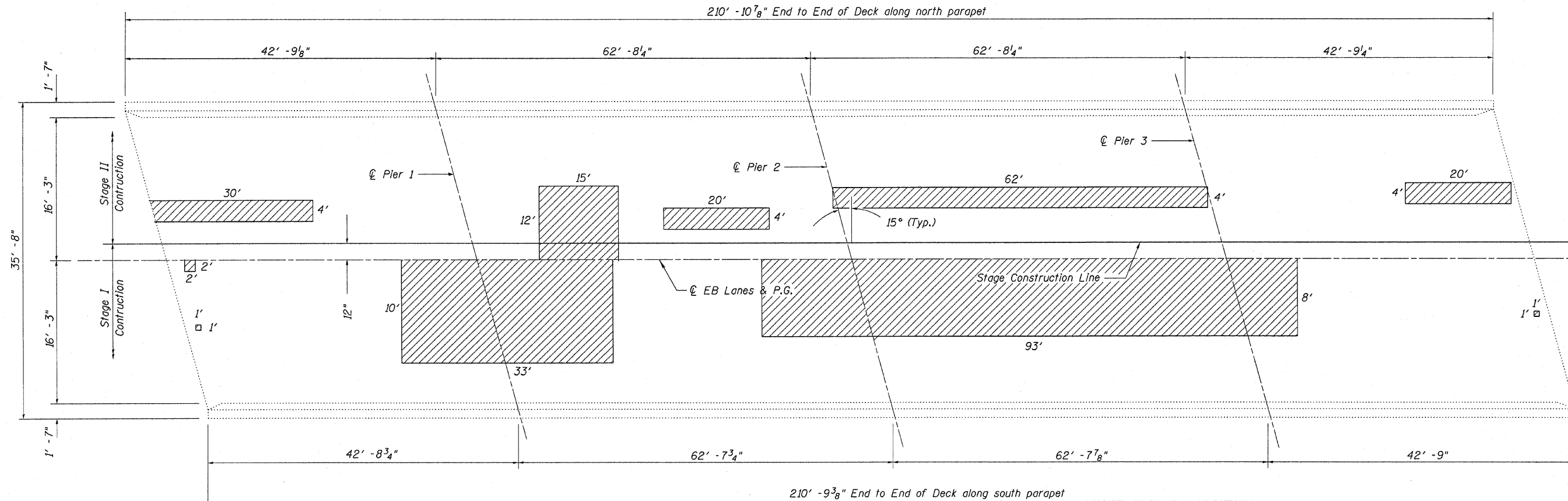

Legend
 Potential Deck Slab Repair (Partial)
 Date of Survey 10/2009

PLAN

Areas shown for repair are potential areas of deck slab repair. Actual locations and quantities to be determined in the field. Resident Engineer to contact District Bridge Office for assistance with locating patches.

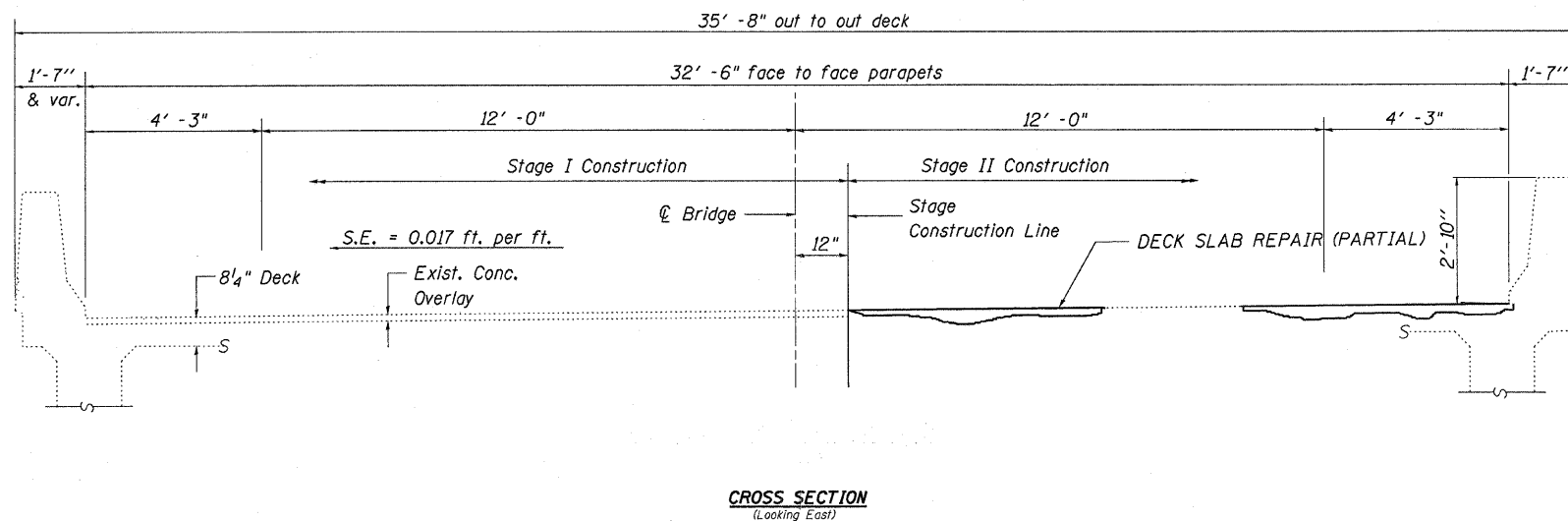

CROSS SECTION
(Looking East)

BILL OF MATERIAL
Westbound

Item	Unit	Quantity
DECK SLAB REPAIR (FULL DEPTH)	SQ YD	43
DECK SLAB REPAIR (PARTIAL)	SQ YD	200

SUPERSTRUCTURE
WEST BOUND LANES
 STRUCTURE NO. 081-0027 (W.B.)
 FAI ROUTE 280 Section D2 Br Wear Surf I-280
 Rock Island County
 Sta. 286+90

FILE NAME = G:\BRV\ADD plans\Rock Island County\2010\280 deck repair\PLANeng.dgn	USER NAME = linkdj	DESIGNED -	REVISED -	STATE OF ILLINOIS DEPARTMENT OF TRANSPORTATION	SUPERSTRUCTURE 081-0027	F.A.I. RTE. = 280	SECTION = *	COUNTY = ROCK ISLAND	TOTAL SHEETS = 19	SHEET NO. = 19	
PLOT SCALE = 58.0000' / IN.	CHECKED -	REVISED -	SCALE: _____			SHEET NO. _____ OF _____ SHEETS	STA. _____ TO STA. _____	CONTRACT NO. 64F92		ILLINOIS FED. AID PROJECT	
PLOT DATE = Thu Nov 05 11:03:44 2009	DATE -	REVISED -									
* 02 BR WEAR SURF I-280											