

STATE OF ILLINOIS
DEPARTMENT OF TRANSPORTATION

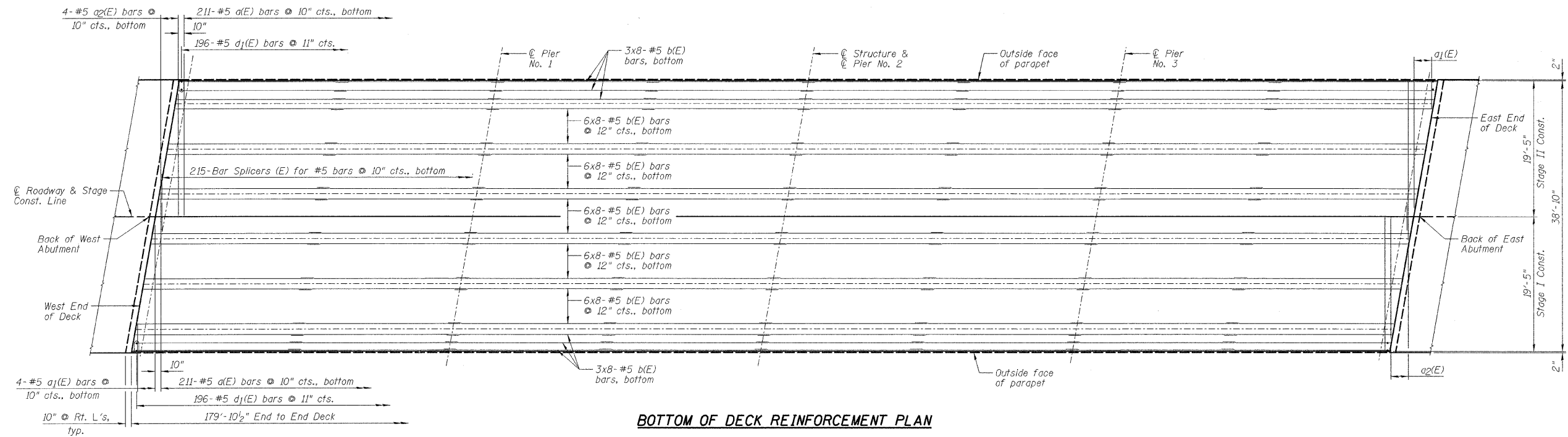

BOTTOM OF DECK REINFORCEMENT PLAN

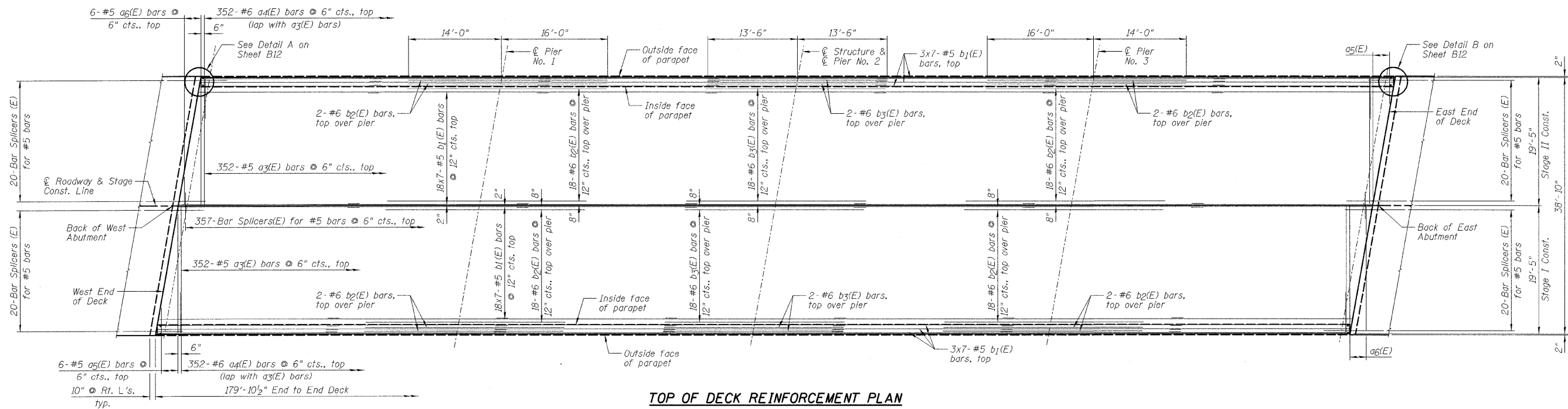

TOP OF DECK REINFORCEMENT PLAN

NOTES:

- 1.) See Sheet B11 for Deck Cross Section.
- 2.) See Sheet B12 for Superstructure Details and Bill of Material.
- 3.) Order a1(E), a2(E), a3(E) and a4(E) bars full length. Cut according to Bar Cutting Diagram on Sheet B12. Use remainder of bars on opposite corner of deck.
- 4.) Bars indicated thus 6x8-#5 etc. indicates 6 lines of bars with 8 lengths per line.
- 5.) See Sheet B33 for Bar Splicer Details.

BAR LAP
#5 - 1'-8"

DESIGNED	SDH
CHECKED	JML
DRAWN	JWK/DJM
CHECKED	MSW

DATE 10/07/09

FARNSWORTH GROUP, INC.

**SUPERSTRUCTURE DECK
STRUCTURE NO. 053-0150**

SHEET NO. B10	F.A.P. RTE.	SECTION	COUNTY	TOTAL SHEETS	SHEET NO.
	41	15BR-2	LIVINGSTON	64	26
34 SHEETS	CONTRACT NO. 66691				
FED. ROAD DIST. NO.		ILLINOIS	FED. AID PROJECT		