

STATE OF ILLINOIS  
DEPARTMENT OF TRANSPORTATION

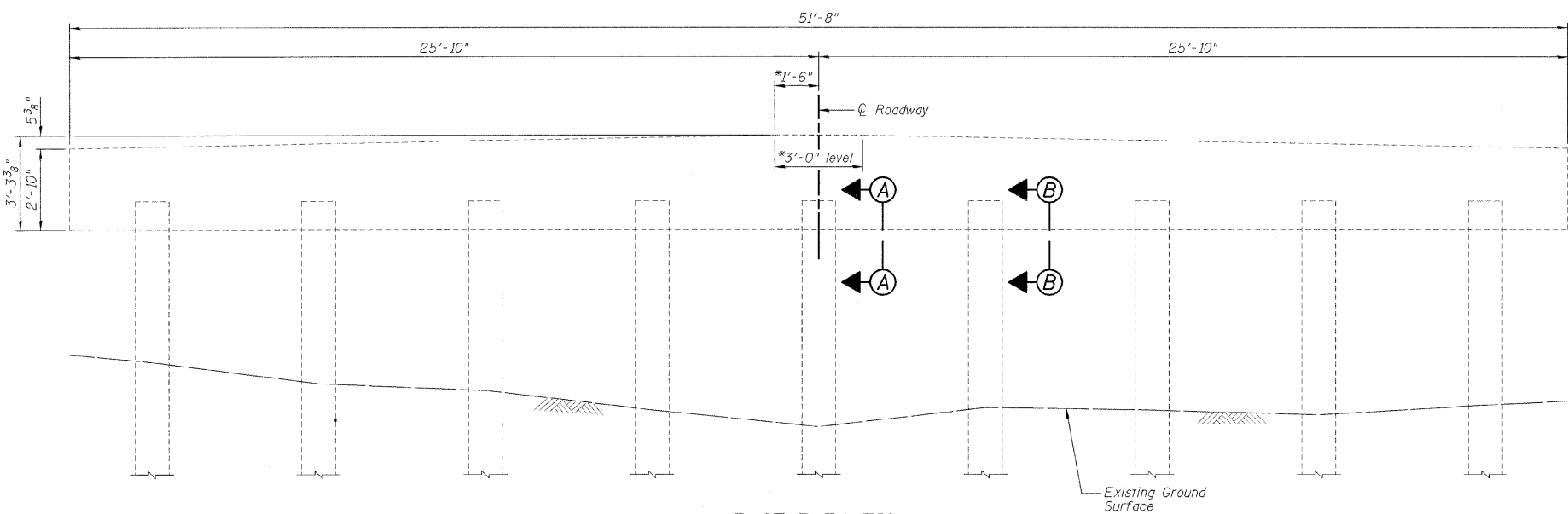

\*Dimensions @ Rt. L's to Roadway.

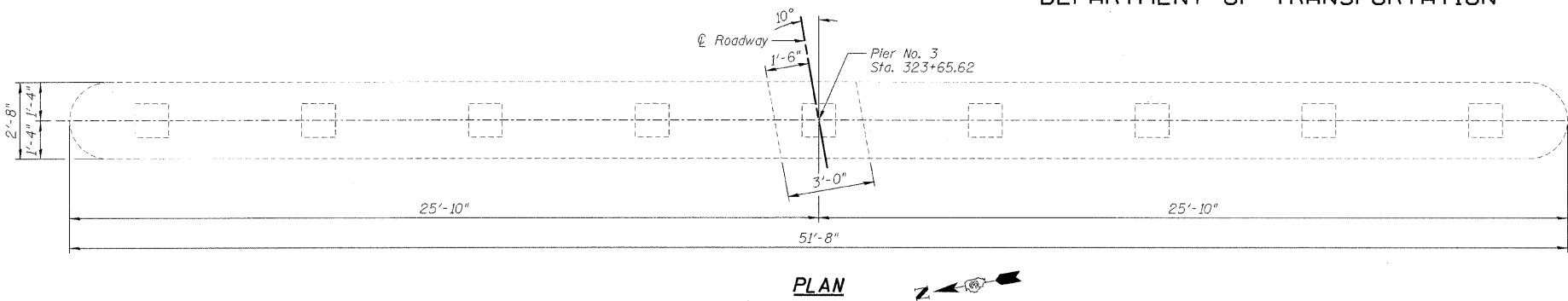
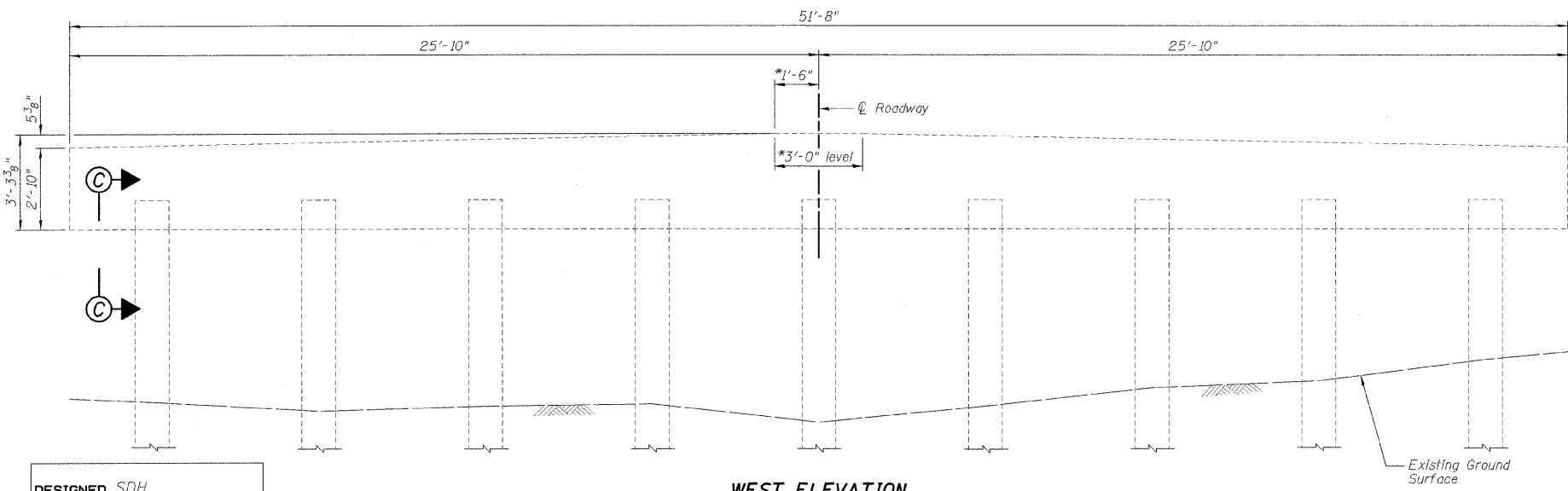

DESIGNED	SDH
CHECKED	JML
DRAWN	JWK/DJM
CHECKED	MSW

DATE 10/07/09

FARNSWORTH GROUP, INC.

CONSULTING ENGINEERS - 2709 MCGRAW DRIVE BLOOMINGTON, ILLINOIS 61704 (309) 663-8435 / (309) 663-1571 FAX

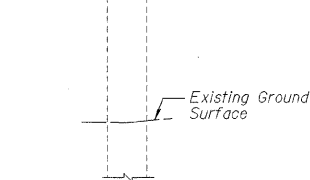
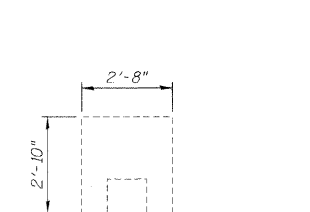

NORTH END VIEW  
(Looking South)

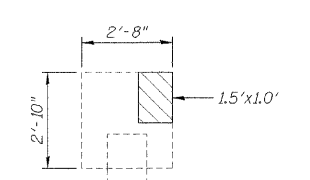

BILL OF MATERIAL

Item	Unit	Total
Structural Repair of Concrete (Depth Equal to or Less Than 5 Inches)	Sq. Ft.	3

LEGEND

Structural Repair of Concrete  
(Depth Equal to or Less Than 5 Inches)

PIER NO. 3 REPAIR  
STRUCTURE NO. 053-0150

SHEET NO. B31	F.A.P. RTE. 41	SECTION 15BR-2	COUNTY LIVINGSTON	TOTAL SHEETS 64	SHEET NO. 47
34 SHEETS	FED. ROAD DIST. NO.		ILLINOIS FED. AID PROJECT		CONTRACT NO. 66691