

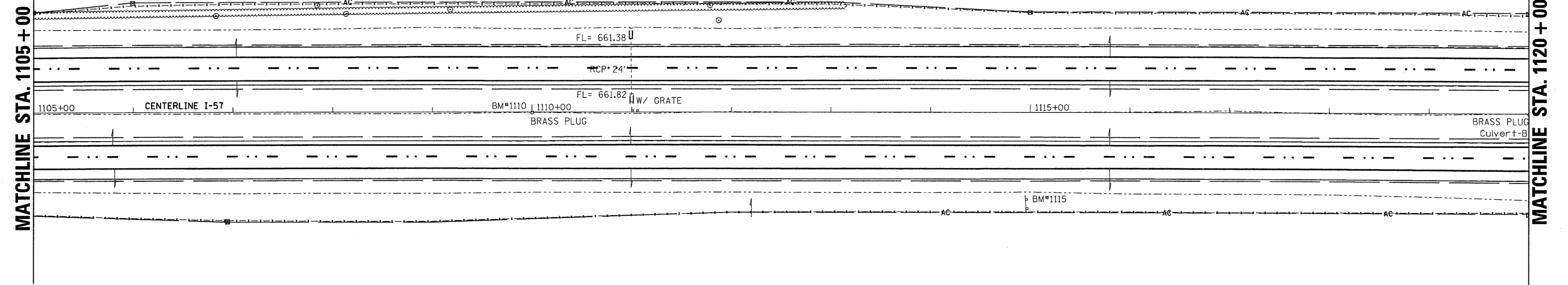

STA 1111+00 NB
24"x54" RCCP WITH
INLET BOX EACH END
CLEAN CULV AND INLET BOXES



BM 1110
P.O.T. PLUG @ I-57
STA. 1110+00
ELEV. = 663.28

BM 1115
CHISELED "□" EAST SIDE "FOOD-EXIT 293" SIGN
STA. 1115+00, 74' RT.
ELEV. = 662.62

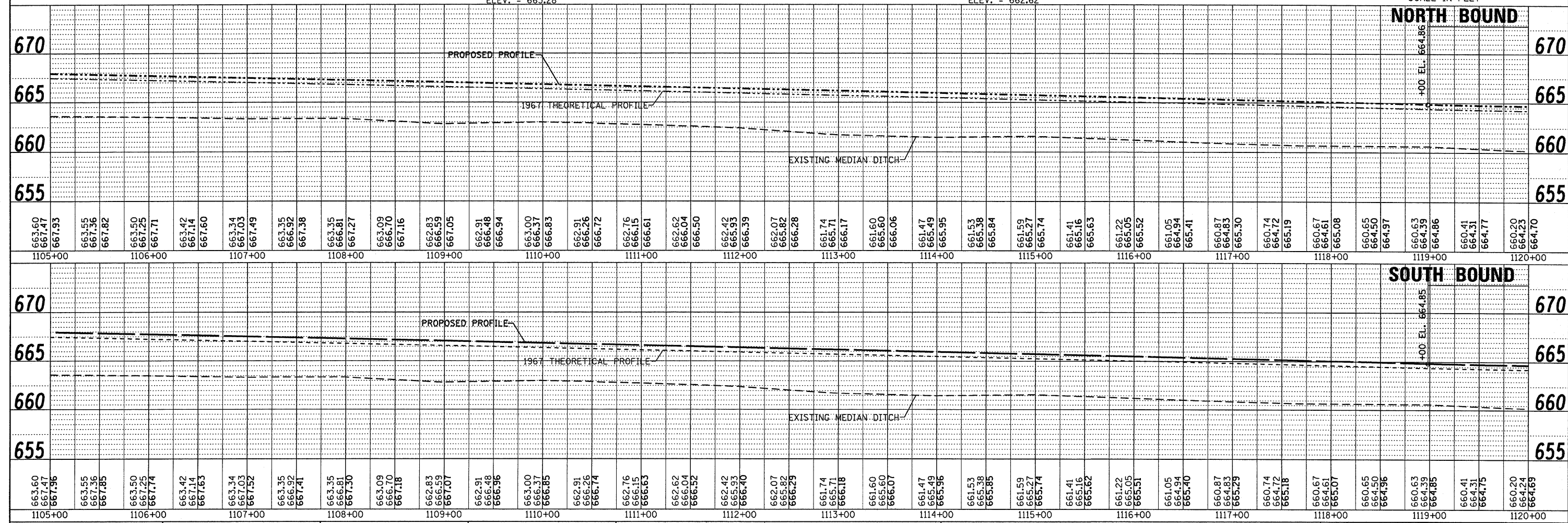
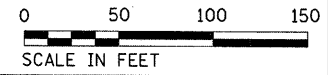

PLAN	REVISIONS	DATE
NO.	PLOTTED	
	ALIGNMENT CHECKED	
	GRADE CHECKED	
	STRUCTURE NOTATIONS OK'D	
	NOTE BOOK	
	BY	
	DATE	

PROFILE	REVISIONS	DATE
NO.	PLOTTED	
	ALIGNMENT CHECKED	
	GRADE CHECKED	
	STRUCTURE NOTATIONS OK'D	
	NOTE BOOK	
	BY	
	DATE	

FILE NAME =	USER NAME = duncanbd	DESIGNED -	REVISED -	<p align="center">STATE OF ILLINOIS DEPARTMENT OF TRANSPORTATION</p>	PLAN & PROFILE		F.A.I. RTE.	SECTION	COUNTY	TOTAL SHEETS	SHEET NO.	
c:\pwwork\p\WIDOT\DUNCANBD\dms38392\ep0505-5ht-plnprf-main.dgn	57-5ht-plnprf-main.dgn	CHECKED -	REVISED -		SCALE: 1=50	SHEET NO. 14 OF 18 SHEETS	STA. 1105+00 TO STA. 1120+00	57	(38-1,2)RS-2 & I	IROQUOIS	263	35
	PLOT SCALE = 58.0000' / IN.	DRAWN -	REVISED -									
	PLOT DATE = Oct 21, 2009 - 09:25:42 AM	CHECKED -	REVISED -									
											CONTRACT NO. 66981	
											ILLINOIS FED. AID PROJECT	