



STA 1142+00 NB
24"X54' RCCP WITH
INLET BOX EACH END
CLEAN NB INLET BOX

FENCE REPAIR - 20'
STA 1144±50 TO STA 1144±70

MATCHLINE STA. 1135 + 00

MATCHLINE STA. 1150 + 00

PLAN	DATE
BY	
NO.	
NO.	
NO.	
NO.	

PROFILE	DATE
BY	
NO.	
NO.	
NO.	
NO.	

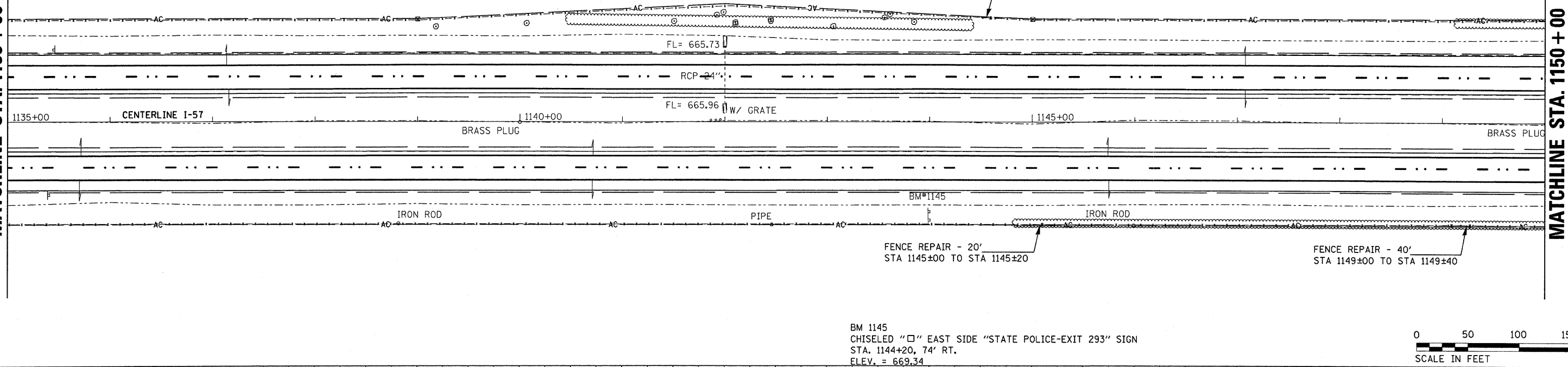

BM 1145
CHISELED "□" EAST SIDE "STATE POLICE-EXIT 293" SIGN
STA. 1144+20, 74' RT.
ELEV. = 669.34

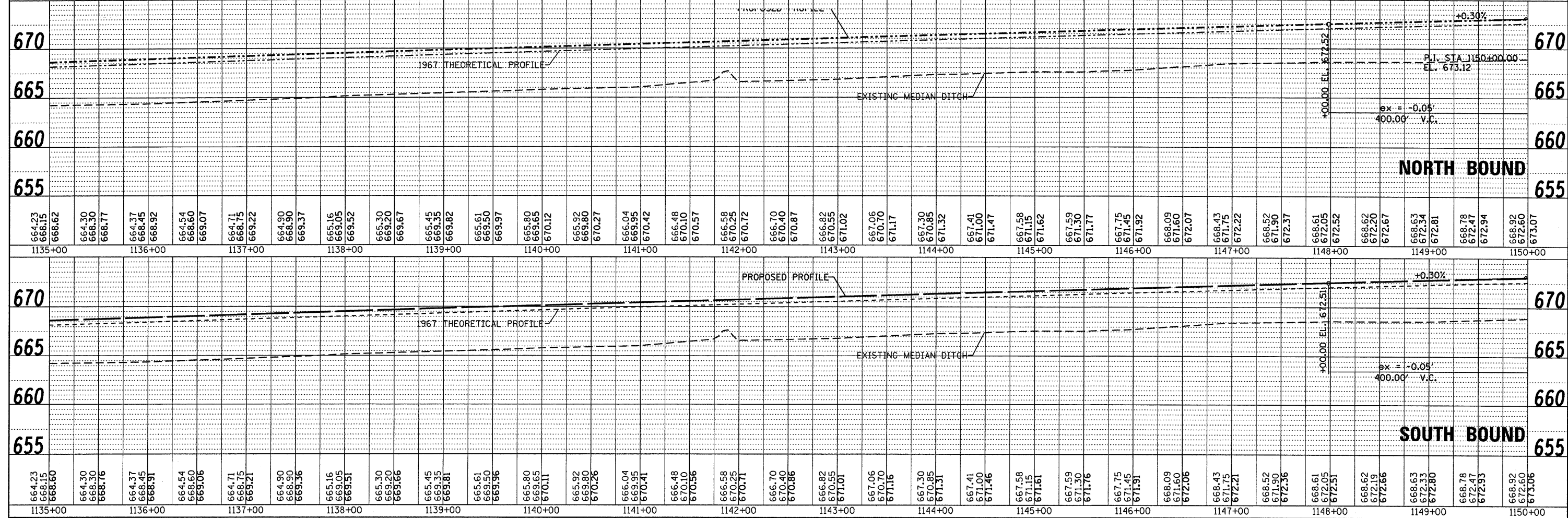
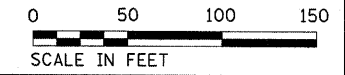

FILE NAME =	USER NAME = dunoanbd	DESIGNED -	REVISED -	STATE OF ILLINOIS DEPARTMENT OF TRANSPORTATION	PLAN & PROFILE		F.A.I. RTE.	SECTION	COUNTY	TOTAL SHEETS	SHEET NO.	
ca:\pwwork\PIWIDOT\DUNCANBD\dms38392\ep05105-shr-plnprf-main.dgn		CHECKED -	REVISED -		SCALE: 1=50	SHEET NO. 16 OF 18 SHEETS	STA. 1135+00 TO STA. 1150+00	57	(38-1,2)RS-2 & I	IROQUOIS	263	37
PLOT SCALE = 50.0000' / IN.		DRAWN -	REVISED -							CONTRACT NO. 66981		
PLOT DATE = Oct 21, 2009 - 09:25:22 AM		CHECKED -	REVISED -							ILLINOIS FED. AID PROJECT		