



STA 1152+00 NB  
24"x54" RCCP WITH  
INLET BOX EACH END  
CLEAN NB INLET BOX

FENCE REPAIR - 120'  
STA 1160±00 TO STA 1161±20

MATCHLINE STA. 1150+00

MATCHLINE STA. 1165+00

PLAN	SURVEYED	DATE
	BY	
	NOTED	
	NO.	
	FILE NAME	

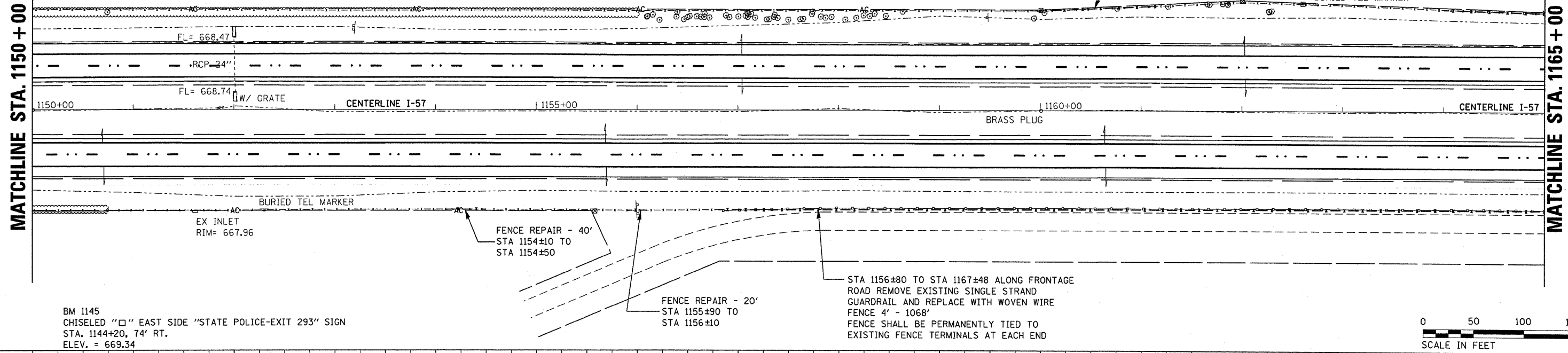

BM 1145  
CHISELED "□" EAST SIDE "STATE POLICE-EXIT 293" SIGN  
STA. 1144+20, 74' RT.  
ELEV. = 669.34

STA 1156±80 TO STA 1167±48 ALONG FRONTAGE  
ROAD REMOVE EXISTING SINGLE STRAND  
GUARDRAIL AND REPLACE WITH WOVEN WIRE  
FENCE 4' - 1068'  
FENCE SHALL BE PERMANENTLY TIED TO  
EXISTING FENCE TERMINALS AT EACH END

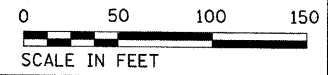

PROFILE	SURVEYED	DATE
	BY	
	NOTED	
	NO.	
	FILE NAME	

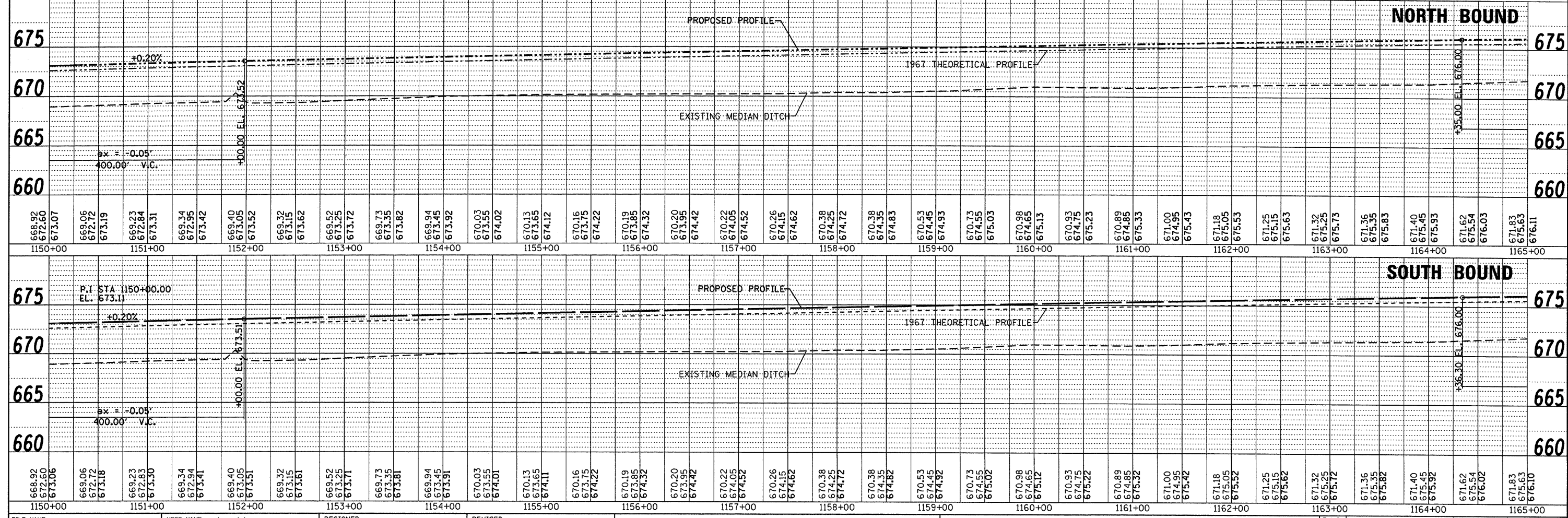

**NORTH BOUND**

**SOUTH BOUND**

FILE NAME =	USER NAME = duncanbd	DESIGNED -	REVISED -	<b>STATE OF ILLINOIS DEPARTMENT OF TRANSPORTATION</b>	<b>PLAN &amp; PROFILE</b>		F.A.I. RTE.	SECTION	COUNTY	TOTAL SHEETS	SHEET NO.	
c:\pwork\p\1001\001\001\duncanbd\ms30392\ep05	05-sht-plnprf-main.dgn	CHECKED -	REVISED -		SCALE: 1=50	SHEET NO. 17 OF 18 SHEETS	STA. 1150+00 TO STA. 1165+00	57	(38-1,2)RS-2 & I	IRROQUOIS	263	38
		DRAWN -	REVISED -									
		CHECKED -	REVISED -									
									CONTRACT NO. 66981			
							ILLINOIS FED. AID PROJECT					