

PROPOSED SCOPE

1. REPAIR DECK- PROTECTIVE SHIELD SHALL BE PLACED OVER TRAFFIC AREAS
2. EXTEND DECK DRAINS
3. PLUG DECK DRAINS WITHIN 10' OF SUBSTRUCTURE COMPONENTS
4. PLACE CONTROLLED LOW-STRENGTH MATERIAL AT AREA BETWEEN ABUTMENT FACE AND SLOPE WALL

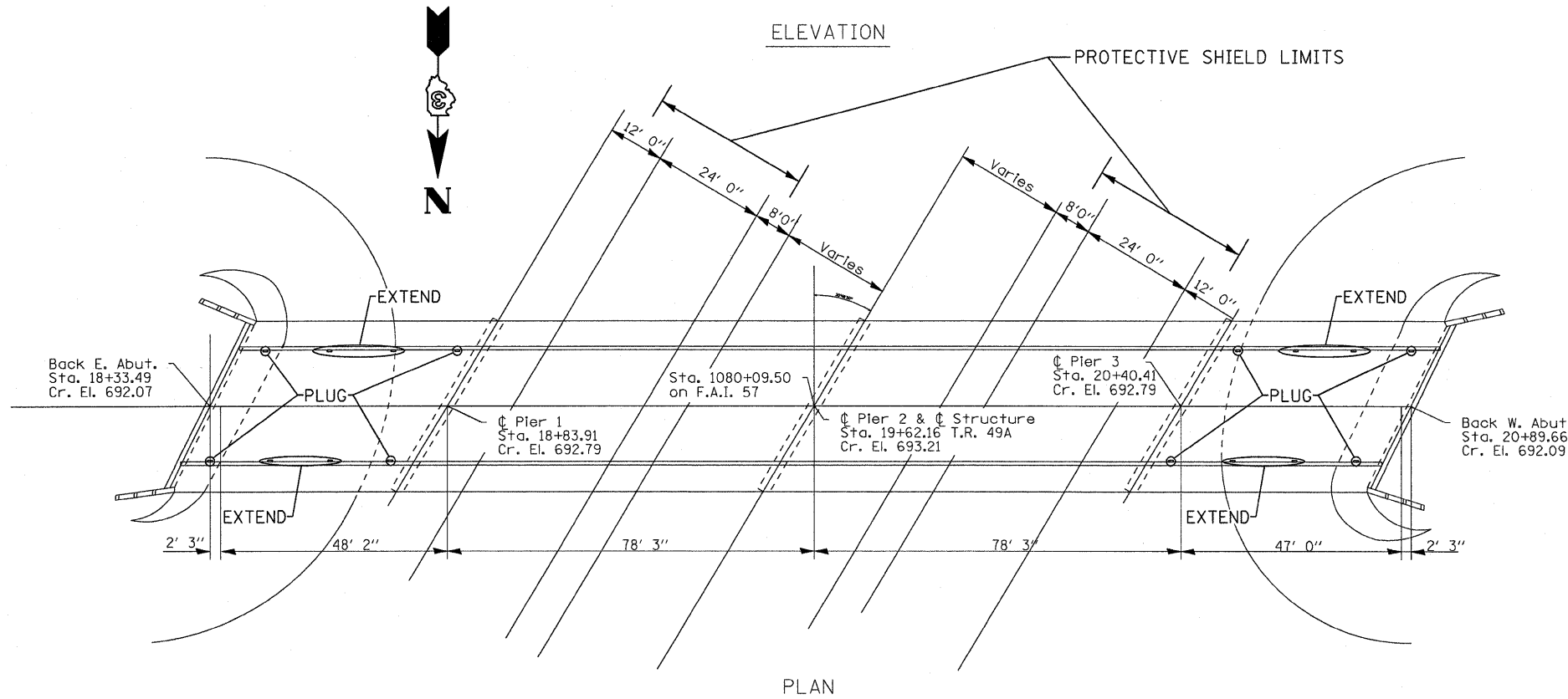

TOTAL BILL OF MATERIAL

ITEM	UNIT	SUPER	SUB	TOTAL
DECK SLAB REPAIR (PARTIAL)	SQ YD	3.2	-	3.2
CONTROLLED LOW-STRENGTH MAT.	CU YD	-	25	25
FLOOR DRAIN EXTENSION	EACH	8	-	8
PLUG EXISTING DECK DRAINS	EACH	8	-	8
PROTECTIVE SHIELD	SQ YD	294	-	294

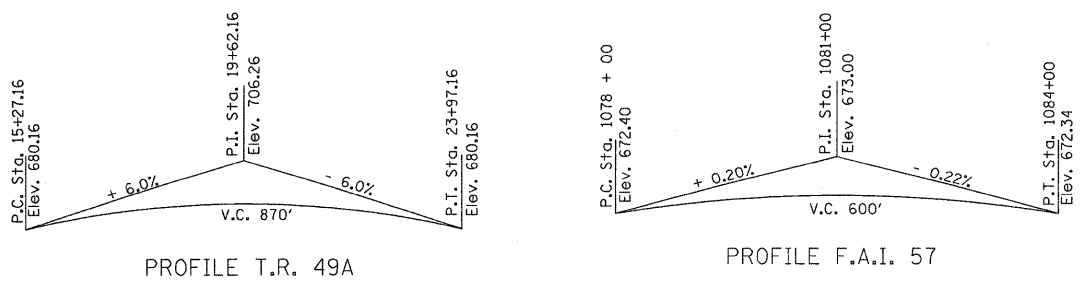

CURVE DATA (F.A.I.)
 (Chord Def.)
 P.I. = Sta. 1066+ 02.13
 Δ = 42° 19' 15"
 D = 1.00 (Chord)
 T = 2217.85'
 L = 4232.08'
 E = 5279.65'
 S.E. = 414.27'
 S.E. = 0.02%
 P.C. Sta. 1043+84.28
 P.T. 1086+1636

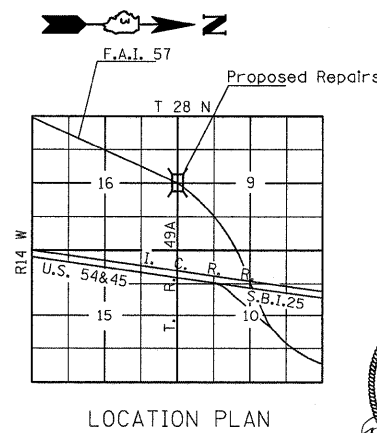

GENERAL PLAN & ELEVATION
 T.R. 49A OVER FAI 57
 STA. 1080+09.50
 FAI RT.57 PROJECT I-57-6(65) 296
 SECTION 38-2 HB-2 IROQUOIS COUNTY

Expires Nov. 30, 2010