

TEMPORARY BRIDGE TRAFFIC SIGNALS NOTES (STAGE 1, 2, AND 3)

- TWO PHASE SIGNAL OPERATION. THE ENGINEER OF TRAFFIC SHALL APPROVE ALL TIMING PARAMETERS.
- STOP BAR PLACEMENT, TEMPORARY CONCRETE BARRIER, AND SIGNAL PLACEMENT/ DETAILS SHALL BE AS SHOWN.
- ADVANCE WARNING SIGNS ARE REQUIRED AS SHOWN. THE CONTRACTOR SHALL INSTALL HIGH INTENSITY SOLAR POWERED YELLOW FLASHERS ON THE ADVANCE WARNING SIGN. THE CONTRACTOR SHALL RETURN THE FLASHERS TO THE TRAFFIC CONTROL SUPERVISOR UPON REMOVAL OF THE TEMPORARY BRIDGE SIGNALS.
- ALL TRAFFIC SIGNAL AND ADVANCE WARNING FLASHER SECTIONS SHALL HAVE 12" DIAMETER LENSES.
- THE TEMPORARY TRAFFIC SIGNAL HEADS SHALL BE PLACED AS INDICATED ON THE PLANS OR DIRECTED BY THE ENGINEER.
- THE TEMPORARY TRAFFIC SIGNAL INSTALLATION SHALL CONFORM TO ALL M.U.T.C.D. REQUIREMENTS.
- ALL LABOR AND MATERIALS REQUIRED TO COMPLY WITH THESE REQUIREMENTS AND PLAN SHEET DETAILS SHALL BE INCLUDED IN THE PRICE FOR THE TEMPORARY BRIDGE SIGNALS INSTALLATION, THERE WILL BE NO ADDITIONAL COMPENSATION.

STAGE 1 CONSTRUCTION
(Sequence of construction / Applications)

- Set up Traffic Control for Stage 1 Construction per Stage 1 Plans and Standard 701316.
- On the right, remove existing gutter, outlet and shoulder and construct pavement widening, 5-3/4" of the 8" HMA shoulder, and Type A Gutter from Sta. 557+20 to Sta. 563+03.25, pavement widening and 5-3/4" of the 8" HMA shoulder from Sta. 563+03.25 to Sta. 564+02.64, and temporary pavement from Sta. 564+02.64 to Sta. 564+50.50 (full depth shoulder shall be constructed from Sta. 563+03.25 to Sta. 564+02.64).
- On the right, remove existing shoulder and construct temporary pavement from Sta. 565+44.04 to Sta. 566+12.76 and 5-3/4" of the 8" HMA shoulder from Sta. 566+12.76 to Sta. 568+50 (full depth shoulder shall be constructed from Sta. 566+12.76 to Sta. 566+50). Ingress and egress shall be maintained for all entrances during construction.
- The existing guardrail shall remain in place until the proposed guardrail and guardrail erosion control aggregate is installed in Stage 3 and Stage 5.

NOTES:

- ALL SIGNS IN CONFLICT WITH THIS STAGE OF CONSTRUCTION SHALL BE COVERED.
- THE REMAINING 2-1/4" OF THE 8" HMA SHOULDER SHALL BE PLACED IN STAGE 4.
- ALL STRIPING IN CONFLICT WITH THIS STAGE OF CONSTRUCTION SHALL BE REMOVED.

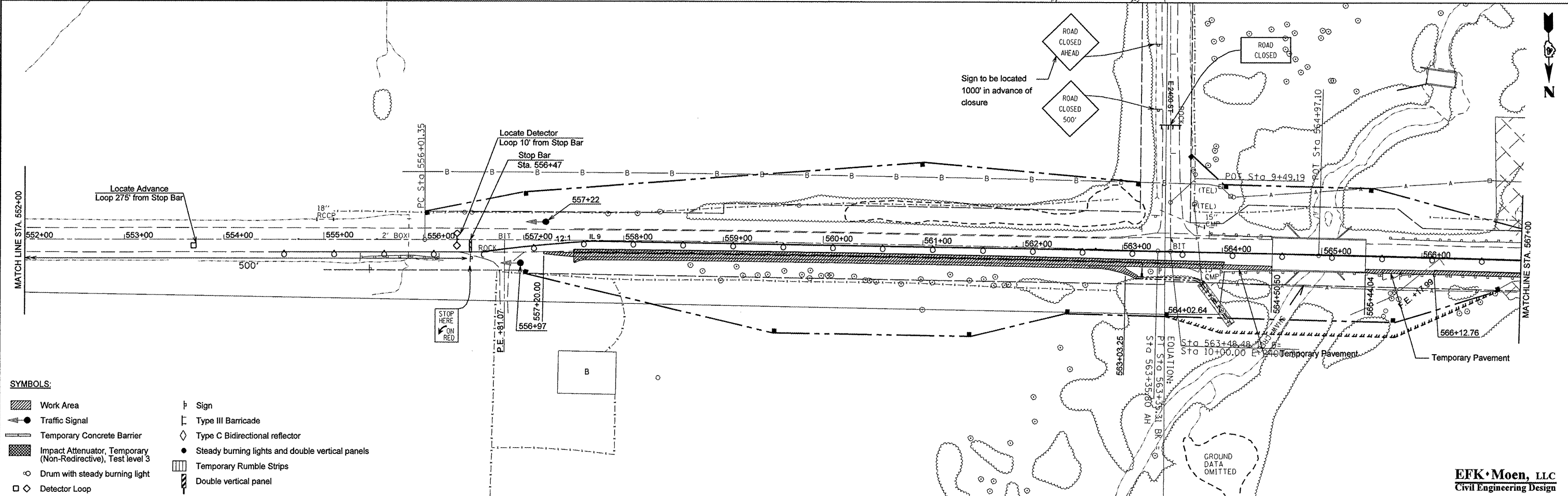
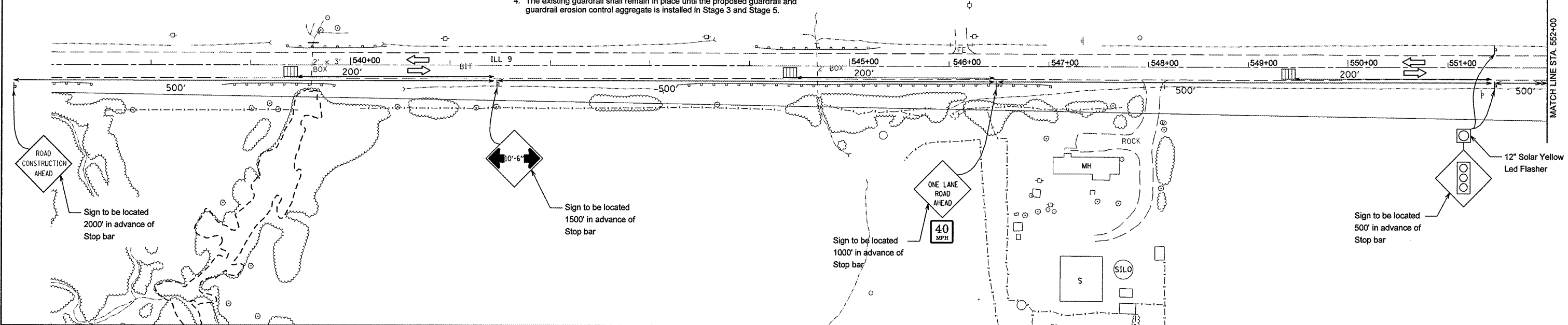

SYMBOLS:

Work Area	Sign
Traffic Signal	Type III Barricade
Temporary Concrete Barrier	Type C Bidirectional reflector
Impact Attenuator, Temporary (Non-Redirective), Test level 3	Steady burning lights and double vertical panels
Drum with steady burning light	Temporary Rumble Strips
Detector Loop	Double vertical panel

EFK·Moen, LLC
Civil Engineering Design

STATE OF ILLINOIS
DEPARTMENT OF TRANSPORTATION

STAGE 1 PLAN

FILE NAME = Z:\08056_Shaw_Creek\dgn\Design\Final\PL\sheet20-D468352-sht-staging1.dgn	USER NAME = jd	DESIGNED -	REVISED -	SCALE: 1" = 50'	SHEET NO. 3 OF 16 SHEETS STA. 540+00.00 TO STA. 567+00.00	F.A.P. RTE. 685	SECTION 378R-1	COUNTY MCDONOUGH/PULPITON	TOTAL SHEETS	SHEET NO.
PLOT SCALE = 100.0000 / IN.	CHECKED - SD	REVISED -	138						20	
PLOT DATE = 10/16/2009	DATE - 10/15/09	REVISED -	CONTRACT NO. 68352							
			FED. ROAD DIST. NO. [ILLINOIS] FED. AID PROJECT							