

TEMPORARY BRIDGE TRAFFIC SIGNALS NOTES (STAGE 1, 2, AND 3)

1. TWO PHASE SIGNAL OPERATION. THE ENGINEER OF TRAFFIC SHALL APPROVE ALL TIMING PARAMETERS.
2. STOP BAR PLACEMENT, TEMPORARY CONCRETE BARRIER, AND SIGNAL PLACEMENT/ DETAILS SHALL BE AS SHOWN.
3. ADVANCE WARNING SIGNS ARE REQUIRED AS SHOWN. THE CONTRACTOR SHALL INSTALL HIGH INTENSITY SOLAR POWERED YELLOW FLASHERS ON THE ADVANCE WARNING SIGN. THE CONTRACTOR SHALL RETURN THE FLASHERS TO THE TRAFFIC CONTROL SUPERVISOR UPON REMOVAL OF THE TEMPORARY BRIDGE SIGNALS.
4. ALL TRAFFIC SIGNAL AND ADVANCE WARNING FLASHER SECTIONS SHALL HAVE 12" DIAMETER LENSES.
5. THE TEMPORARY TRAFFIC SIGNAL HEADS SHALL BE PLACED AS INDICATED ON THE PLANS OR DIRECTED BY THE ENGINEER.
6. THE TEMPORARY TRAFFIC SIGNAL INSTALLATION SHALL CONFORM TO ALL M.U.T.C.D. REQUIREMENTS.
7. ALL LABOR AND MATERIALS REQUIRED TO COMPLY WITH THESE REQUIREMENTS AND PLAN SHEET DETAILS SHALL BE INCLUDED IN THE PRICE FOR THE TEMPORARY BRIDGE SIGNALS INSTALLATION, THERE WILL BE NO ADDITIONAL COMPENSATION.

STAGE 2 CONSTRUCTION
(Sequence of construction / Applications)

1. Set up Traffic Control for Stage 2 Construction per Stage 2 Plans and Standard 701321.
2. On the left, remove existing gutter, outlet and shoulder and construct all improvements, including pavement widening, pavement, 5-3/4" of the 8" HMA shoulders, and the left side of the bridge from Sta. 557+20 to Sta. 588+50 (full depth shoulders shall be constructed from Sta. 583+00 to Sta. 584+10.53 and Sta. 585+75.90 to Sta. 587+00). Construct storm sewer improvements under E 2400 St. and improvements to E 2400 St.
3. Install temporary ramps on either side of the bridge at a taper rate of 40:1 (H.V).
4. Install the guardrail east of the bridge, but the existing guardrail west of the bridge shall remain in place until the proposed guardrail and guardrail erosion control aggregate is installed in Stage 6.

NOTES:

- ALL SIGNS IN CONFLICT WITH THIS STAGE OF CONSTRUCTION SHALL BE COVERED.
- THE REMAINING 2-1/4" OF THE 8" HMA SHOULDER SHALL BE PLACED IN STAGE 4.
- ALL STRIPING IN CONFLICT WITH THIS STAGE OF CONSTRUCTION SHALL BE REMOVED.

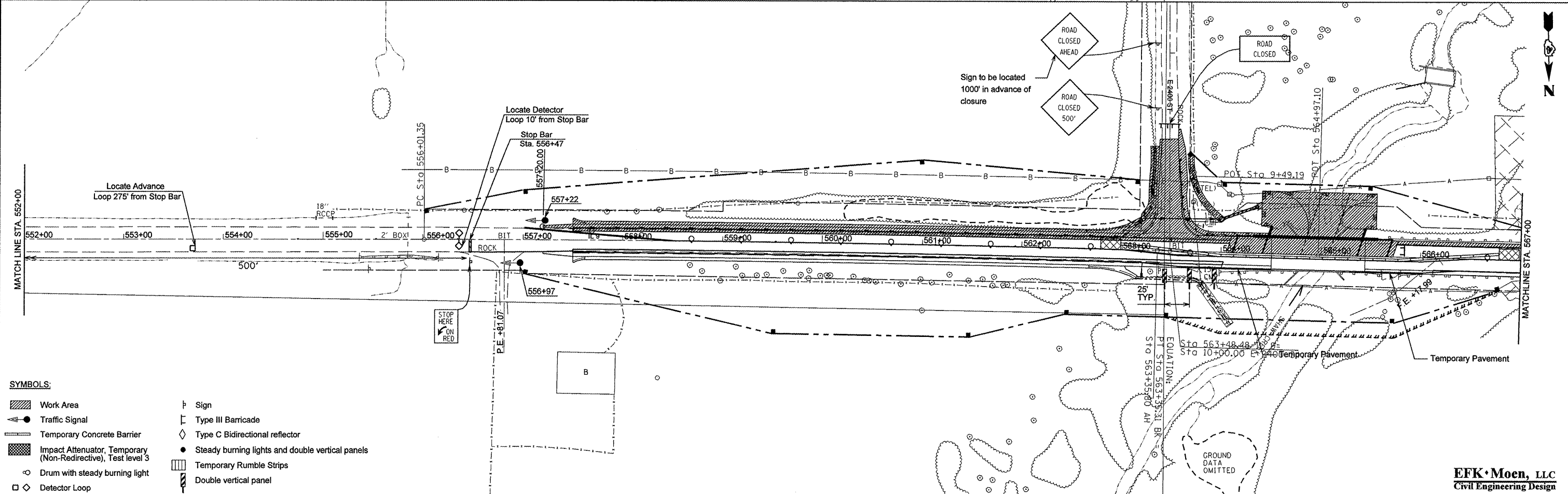
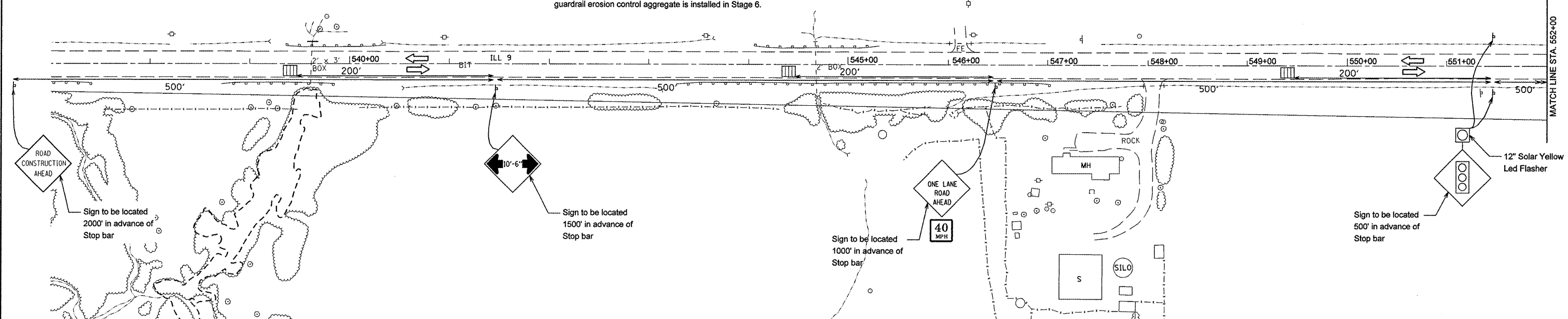

SYMBOLS:

Work Area	Sign
Traffic Signal	Type III Barricade
Temporary Concrete Barrier	Type C Bidirectional reflector
Impact Attenuator, Temporary (Non-Redirective), Test level 3	Steady burning lights and double vertical panels
Drum with steady burning light	Temporary Rumble Strips
Detector Loop	Double vertical panel

EFK Moen, LLC
Civil Engineering Design

STATE OF ILLINOIS
DEPARTMENT OF TRANSPORTATION

STAGE 2 PLAN

FILE NAME = Z:\08096.Show.Creek\dgn\Design\Final\11	USER NAME = jd	DESIGNED -	REVISED -	STA. 540+00.00 TO STA. 567+00.00 SCALE: 1" = 50' SHEET NO. 5 OF 16 SHEETS FED. ROAD DIST. NO. ILLINOIS FED. AID PROJECT
tsheets\22-0468352-sht-staging2.1.dgn	DRAWN - JD	REVISOR -	REVISED -	
PLOT SCALE = 100.0000 / IN.	CHECKED - SD	REVISOR -	REVISED -	
PLOT DATE = 10/16/2009	DATE - 10/15/09	REVISOR -	REVISED -	

F.A.P. RTE. 685	SECTION 37BR-1	COUNTY MCDONOUGH	TOTAL SHEETS 138	SHEET NO. 22
CONTRACT NO. 68352				