

TEMPORARY BRIDGE TRAFFIC SIGNALS NOTES (STAGE 1, 2, AND 3)

- TWO PHASE SIGNAL OPERATION. THE ENGINEER OF TRAFFIC SHALL APPROVE ALL TIMING PARAMETERS.
- STOP BAR PLACEMENT, TEMPORARY CONCRETE BARRIER, AND SIGNAL PLACEMENT/DETAILS SHALL BE AS SHOWN.
- ADVANCE WARNING SIGNS ARE REQUIRED AS SHOWN. THE CONTRACTOR SHALL INSTALL HIGH INTENSITY SOLAR POWERED YELLOW FLASHERS ON THE ADVANCE WARNING SIGN. THE CONTRACTOR SHALL RETURN THE FLASHERS TO THE TRAFFIC CONTROL SUPERVISOR UPON REMOVAL OF THE TEMPORARY BRIDGE SIGNALS.
- ALL TRAFFIC SIGNAL AND ADVANCE WARNING FLASHER SECTIONS SHALL HAVE 12" DIAMETER LENSES.
- THE TEMPORARY TRAFFIC SIGNAL HEADS SHALL BE PLACED AS INDICATED ON THE PLANS OR DIRECTED BY THE ENGINEER.
- THE TEMPORARY TRAFFIC SIGNAL INSTALLATION SHALL CONFORM TO ALL M.U.T.C.D. REQUIREMENTS.
- ALL LABOR AND MATERIALS REQUIRED TO COMPLY WITH THESE REQUIREMENTS AND PLAN SHEET DETAILS SHALL BE INCLUDED IN THE PRICE FOR THE TEMPORARY BRIDGE SIGNALS INSTALLATION, THERE WILL BE NO ADDITIONAL COMPENSATION.

STAGE 3 CONSTRUCTION
(Sequence of construction / Applications)

- Set up Traffic Control for Stage 3 Construction per Stage 3 Plans and Standard 701321.
- On the right, remove temporary pavement and construct the right side of the bridge, bridge approach pavement, 5-3/4" of the 8" HMA shoulders and the entrance at Sta. 566+17.99. Ingress and egress shall be maintained to all entrances during construction.
- Install temporary ramps on either side of the bridge at a taper rate of 40:1 (H:V).
- Install the guardrail on the northwest and northeast corners of the bridge.

NOTES:

- ALL SIGNS IN CONFLICT WITH THIS STAGE OF CONSTRUCTION SHALL BE COVERED.
- THE REMAINING 2-1/4" OF THE 8" HMA SHOULDER SHALL BE PLACED IN STAGE 4.
- ALL STRIPING IN CONFLICT WITH THIS STAGE OF CONSTRUCTION SHALL BE REMOVED.

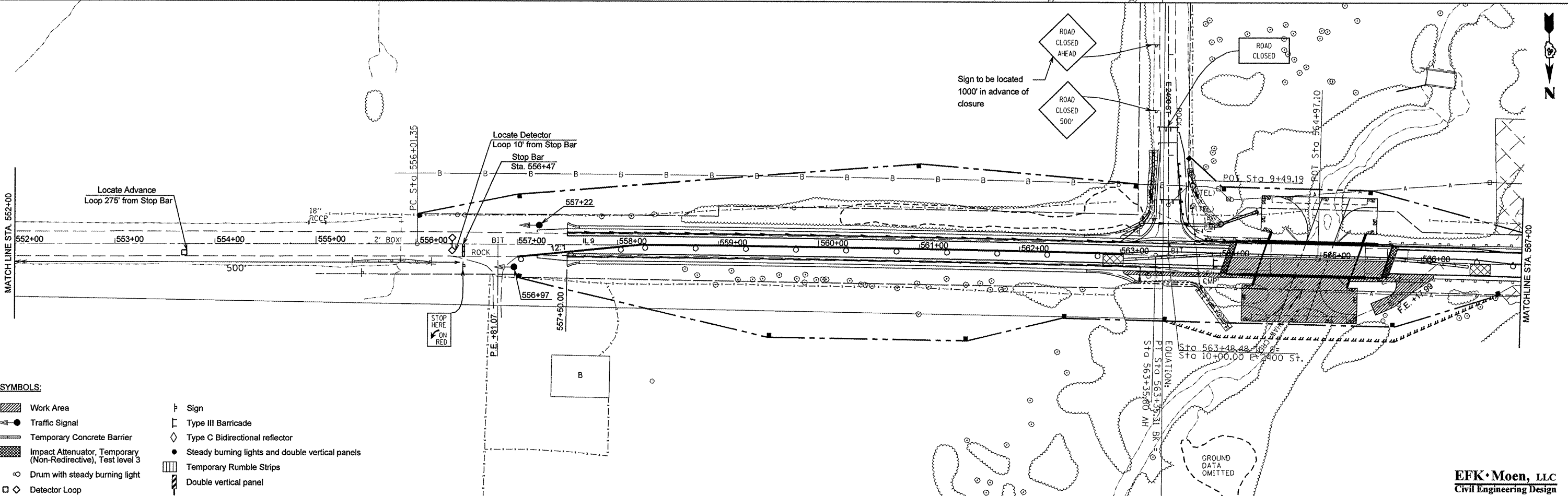
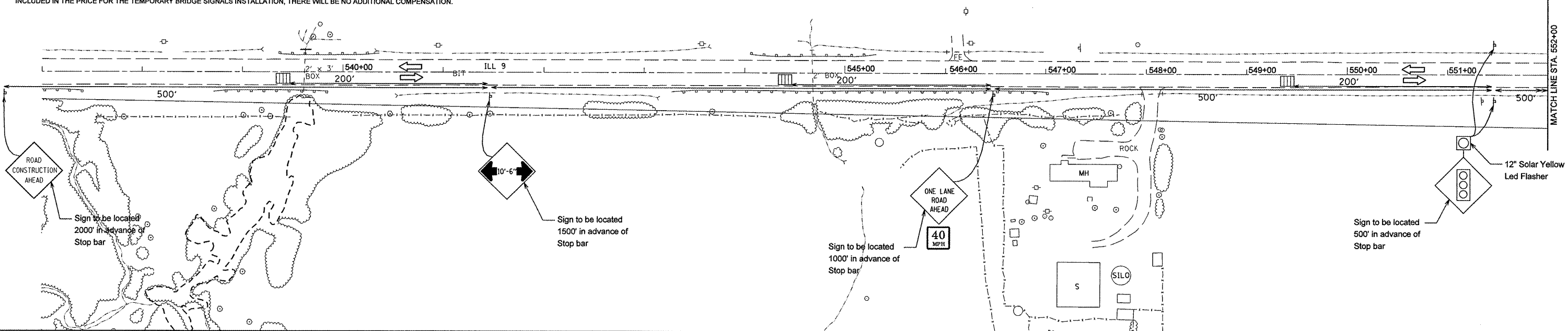

SYMBOLS:

Work Area	Sign
Traffic Signal	Type III Barricade
Temporary Concrete Barrier	Type C Bidirectional reflector
Impact Attenuator, Temporary (Non-Redirective), Test level 3	Steady burning lights and double vertical panels
Drum with steady burning light	Temporary Rumble Strips
Detector Loop	Double vertical panel

STATE OF ILLINOIS
DEPARTMENT OF TRANSPORTATION

STAGE 3 PLAN

SCALE: 1" = 50' SHEET NO. 7 OF 16 SHEETS STA. 540+00.00 TO STA. 567+00.00

F.A.P. RTE.	SECTION	COUNTY	TOTAL SHEETS	SHEET NO.
685	37BR-1	MCDONOUGH/ILLINOIS	138	24
CONTRACT NO. 68352				

EFK·Moen, LLC
Civil Engineering Design

FILE NAME *	USER NAME = jd	DESIGNED -	REVISED -
Z:\08056_Show_Creek\dgn\Design\Final\PL\ssheets\24-D468352-sht-staging3-1.dgn		DRAWN - JD	REVISED -
		CHECKED - SD	REVISED -
		DATE - 10/15/09	REVISED -

FED. ROAD DIST. NO. ILLINOIS FED. AID PROJECT