

STAGE 4 CONSTRUCTION
(Sequence of construction / Applications)

1. Set up Traffic Control for Stage 4 Construction per Stage 4 Plans and Standard 701306.
2. Wedge/level or mill/overlay pavement and place the remaining 2-1/4" of the 8" HMA shoulders from Sta. 556+47 to Sta. 568+50.
3. Temporary stripe pavement until final pavement striping is placed in Stage 7.
4. Reopen E 2400 St. to traffic.

NOTES:

ALL SIGNS IN CONFLICT WITH THIS STAGE OF CONSTRUCTION SHALL BE COVERED.
ALL STRIPING IN CONFLICT WITH THIS STAGE OF CONSTRUCTION SHALL BE REMOVED.

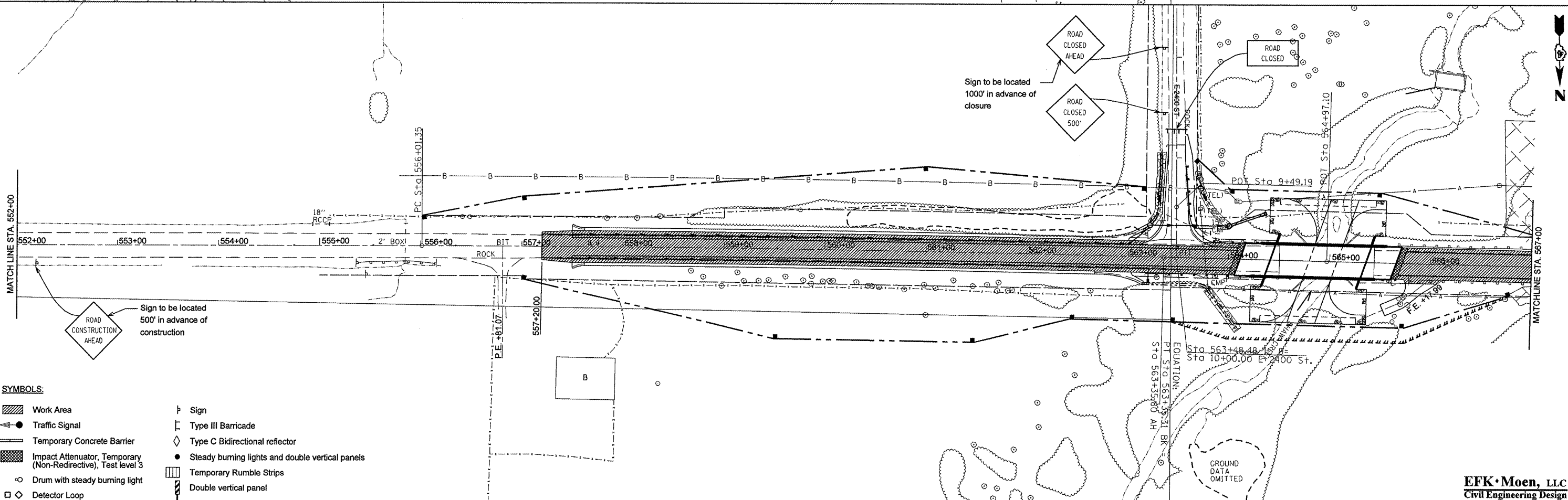
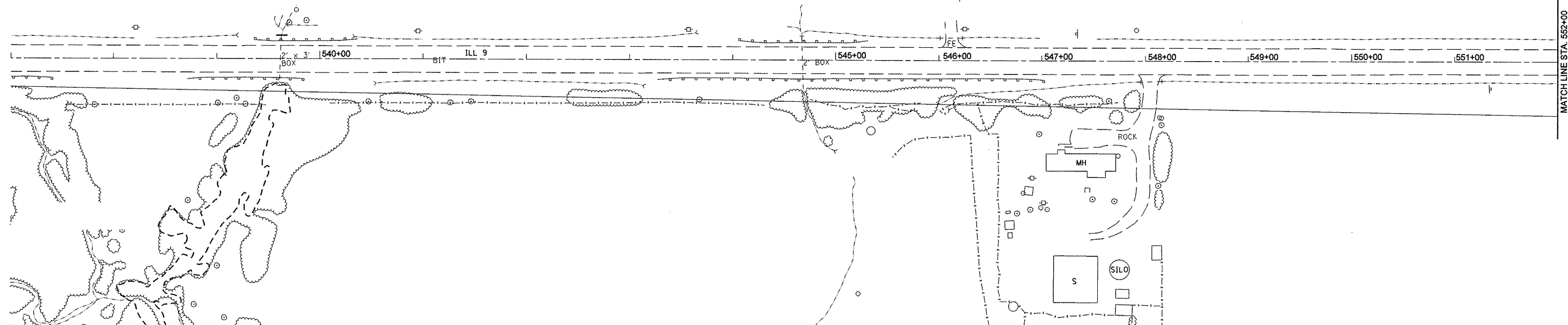

SYMBOLS:

- Work Area
- Traffic Signal
- Temporary Concrete Barrier
- Impact Attenuator, Temporary (Non-Redirective), Test level 3
- Drum with steady burning light
- Detector Loop
- Sign
- Type III Barricade
- Type C Bidirectional reflector
- Steady burning lights and double vertical panels
- Temporary Rumble Strips
- Double vertical panel

EFK•Moen, LLC
Civil Engineering Design

FILE NAME = Z:\08056_Show_Creek\dgn\Design\Final\Pl	USER NAME = jd	DESIGNED -	REVISED -
tsheets\26-0466352-sh1-staging4_1.dgn		DRAWN - JD	REVISED -
PLOT SCALE = 100.0000' / IN.		CHECKED - SD	REVISED -
PLOT DATE = 10/16/2009		DATE - 10/15/09	REVISED -

STATE OF ILLINOIS
DEPARTMENT OF TRANSPORTATION

STAGE 4 PLAN

SCALE: 1" = 50' SHEET NO. 9 OF 16 SHEETS STA. 540+00.00 TO STA. 567+00.00

F.A.P. RTE.	SECTION	COUNTY	TOTAL SHEETS	SHEET NO.
685	37BR-1	MCDONOUGH	138	26
CONTRACT NO. 68352				
FED. ROAD DIST. NO. ILLINOIS FED. AID PROJECT				