

**STAGE 6 CONSTRUCTION**  
(Sequence of construction / Applications)

1. Set up Traffic Control for Stage 6 Construction per Stage 6 Plans and Standard 701326. During non-working hours when the drop-off adjacent to the driving lane is greater than 2", regardless of the length or number of times the treatment must be applied, the contractor shall at no direct pay wedge Type A Aggregate (or similar) from the edge of pavement a 1:3 slope.
2. Pavement widening and earthwork along wetlands shall be constructed from the pavement. No equipment or disturbance will be allowed in the wetland.
3. On the left, remove existing gutter, outlet and shoulder and construct 5-3/4" of 8" HMA shoulder from Sta. 568+50 to Sta. 579+14, pavement widening, 5-3/4" of 8" HMA shoulder and gutter from Sta. 579+14 to Sta. 585+05.96, and 5-3/4" of 8" HMA shoulder from Sta. 585+05.96 to Sta. 588+70. Construct the entrances at Sta. 575+90.23 and Sta. 585+39.67. Ingress and egress shall be maintained for all entrances during construction.

4. Remove existing guardrail and install new guardrail on the left from the southwest corner of the bridge to Sta. 575+60.
5. Extend the end of the existing culverts on the left at Sta. 574+65.49 and Sta. 577+96.14 and install stone rip rap.

**NOTES:**

- ALL SIGNS IN CONFLICT WITH THIS STAGE OF CONSTRUCTION SHALL BE COVERED.
- THE REMAINING 2-1/4" OF THE 8" HMA SHOULDER SHALL BE PLACED IN STAGE 7.
- ALL STRIPING IN CONFLICT WITH THIS STAGE OF CONSTRUCTION SHALL BE REMOVED.

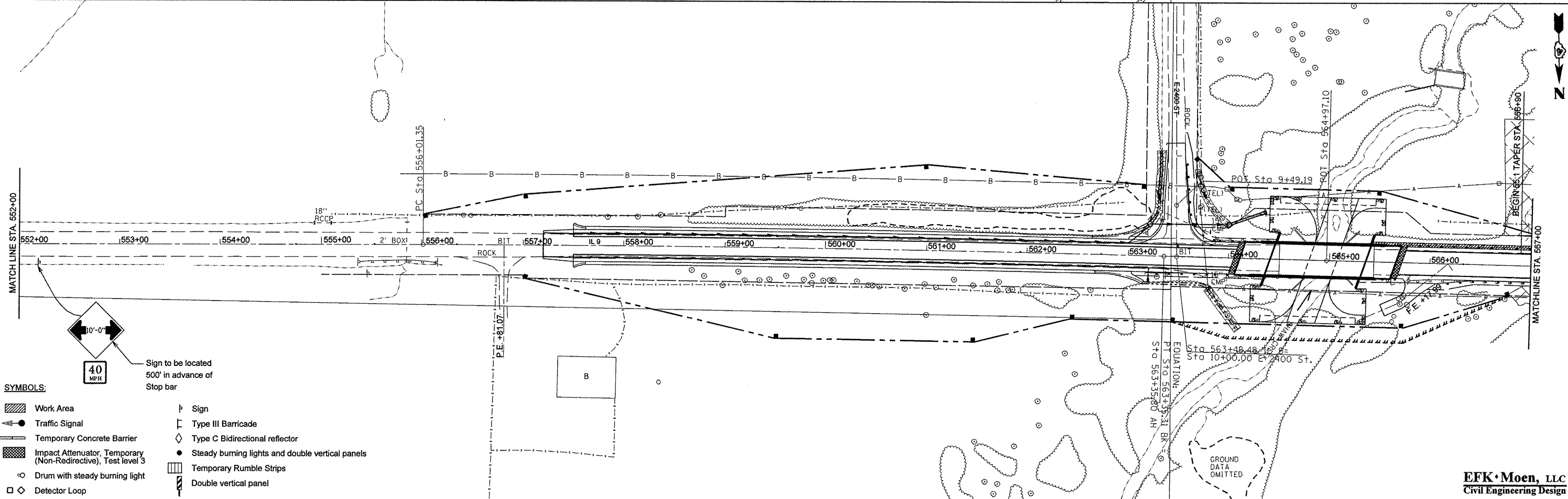
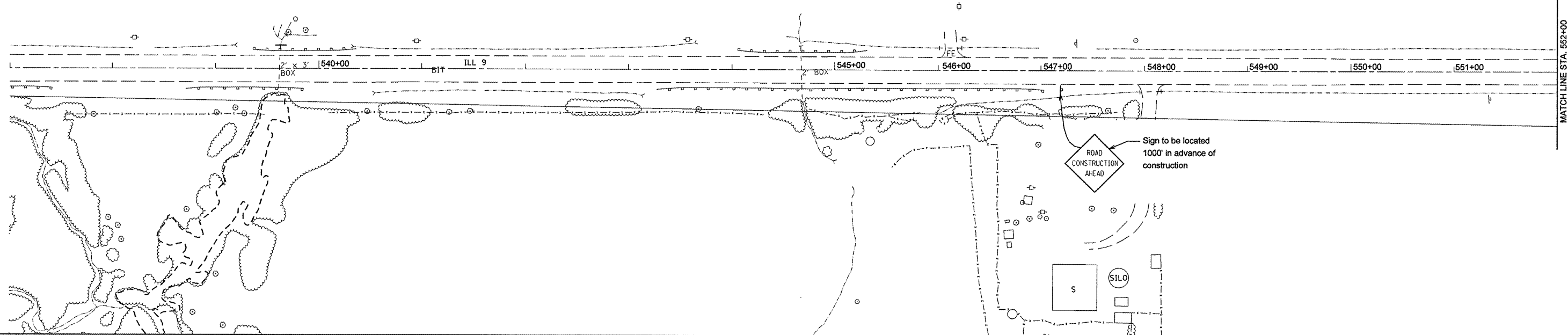

- SYMBOLS:**
- Work Area
  - Traffic Signal
  - Temporary Concrete Barrier
  - Impact Attenuator, Temporary (Non-Redirective), Test level 3
  - Drum with steady burning light
  - Detector Loop
  - Sign
  - Type III Barricade
  - Type C Bidirectional reflector
  - Steady burning lights and double vertical panels
  - Temporary Rumble Strips
  - Double vertical panel

**EFK·Moen, LLC**  
Civil Engineering Design

FILE NAME = Z:\08056_Show_Creek\dgn\Design\Final\PLC\sheet\30-0468352-sht-staging6_1.dgn	USER NAME = jd	DESIGNED -	REVISED -
PLOT SCALE = 100.0000 / IN.	CHECKED - SD	DRAWN - JD	REVISED -
PLOT DATE = 10/16/2009	DATE - 10/15/09		REVISED -

**STATE OF ILLINOIS**  
**DEPARTMENT OF TRANSPORTATION**

**STAGE 6 PLAN**  
SCALE: 1" = 50'  
SHEET NO. 13 OF 16 SHEETS  
STA. 540+00.00 TO STA. 567+00.00

F.A.P. RTE. 685	SECTION 37BR-1	COUNTY MCDONOUGH	TOTAL SHEETS 138	SHEET NO. 30
FED. ROAD DIST. NO. ILLINOIS		FED. AID PROJECT		