

MATCHLINE PR. STA. 381+00

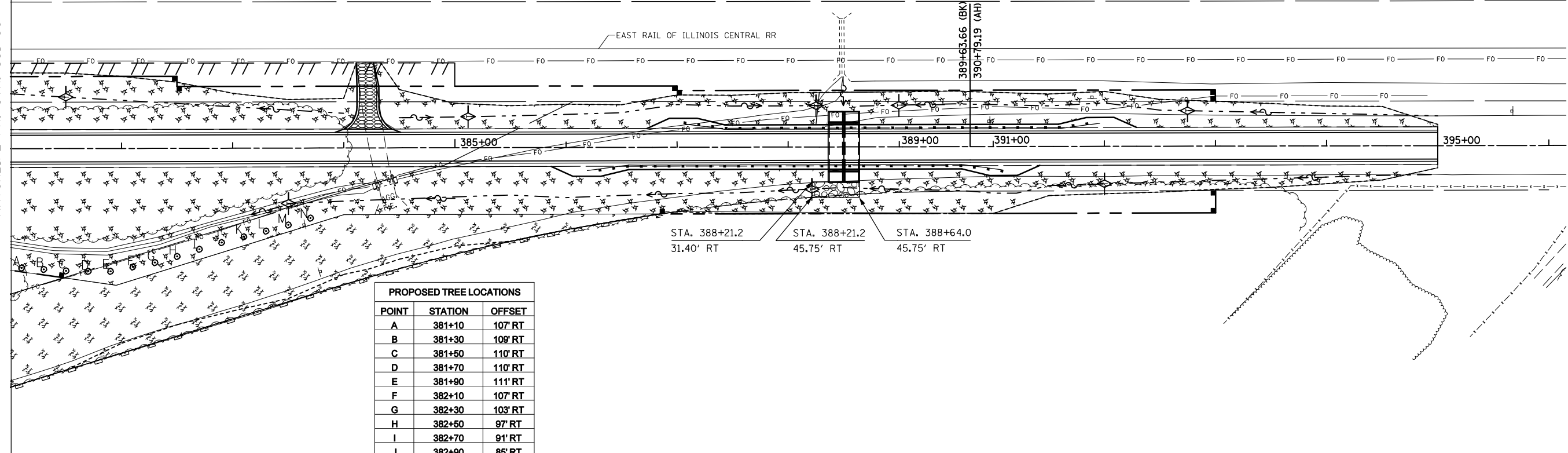

PROPOSED TREE LOCATIONS		
POINT	STATION	OFFSET
A	381+10	107' RT
B	381+30	109' RT
C	381+50	110' RT
D	381+70	110' RT
E	381+90	111' RT
F	382+10	107' RT
G	382+30	103' RT
H	382+50	97' RT
I	382+70	91' RT
J	382+90	85' RT
K	383+10	80' RT
L	383+30	75' RT
M	383+50	69' RT
N	383+70	63' RT

**NOTES:**

1. CLASS 7 SEEDING SHALL BE USED TO TEMPORARILY SEED AREAS DESIGNATED TO BE SEEDED PERMANENTLY WITH CLASS 2 AND CLASS 4 SEED
2. SEEDING CLASS 2 AREAS SHALL BE FERTILIZED. SEEDING CLASS 4 AREAS WILL NOT BE FERTILIZED PER ARTICLE 250.07 OF THE STANDARD SPECIFICATIONS.
3. SEE ARTICLE 250.07 OF THE STANDARD SPECIFICATIONS FOR PLANTING TIMES.

LEGEND	
	SEEDING, CLASS 2, EROSION CONTROL BLANKET
	SEEDING, CLASS 2, MULCH METHOD 2
	SEEDING, CLASS 4, MULCH METHOD 2
	RIPRAP, CLASS A4
	2" BALLED AND BURLAPPED TREE ON 20' CENTERS
	TEMPORARY DITCH CHECK
	PERIMETER EROSION BARRIER
	INLET AND PIPE PROTECTION

FILE NAME =	USER NAME = keysrb	DESIGNED -	REVISED -
ct:\pw\work\p\dot\keysrb\10101441\0570592-sht-erosion.dgn		DRAWN -	REVISED -
	PLOT SCALE = 100.0000' / IN.	CHECKED -	REVISED -
	PLOT DATE = 10/16/2009	DATE -	REVISED -

**STATE OF ILLINOIS  
DEPARTMENT OF TRANSPORTATION**

**EROSION, SEDIMENT CONTROL AND  
LANDSCAPING ITEMS**

SCALE: SHEET NO. OF SHEETS STA. 381+00 TO STA. 395+00

F.A.P. RTE.	SECTION	COUNTY	TOTAL SHEETS	SHEET NO.
71	121R	MCLEAN	87	25
CONTRACT NO. 70592				
ILLINOIS FED. AID PROJECT				