

PLAN	SURVEYED	BY	DATE
	PLOTTED		
	CHECKED		
	ALIGNED		
	CAD FILE NAME		
NOTE BOOK NO.			

PROFILE	SURVEYED	BY	DATE
	PLOTTED		
	CHECKED		
	STRUCTURE		
	NOTATION		
NOTE BOOK NO.			

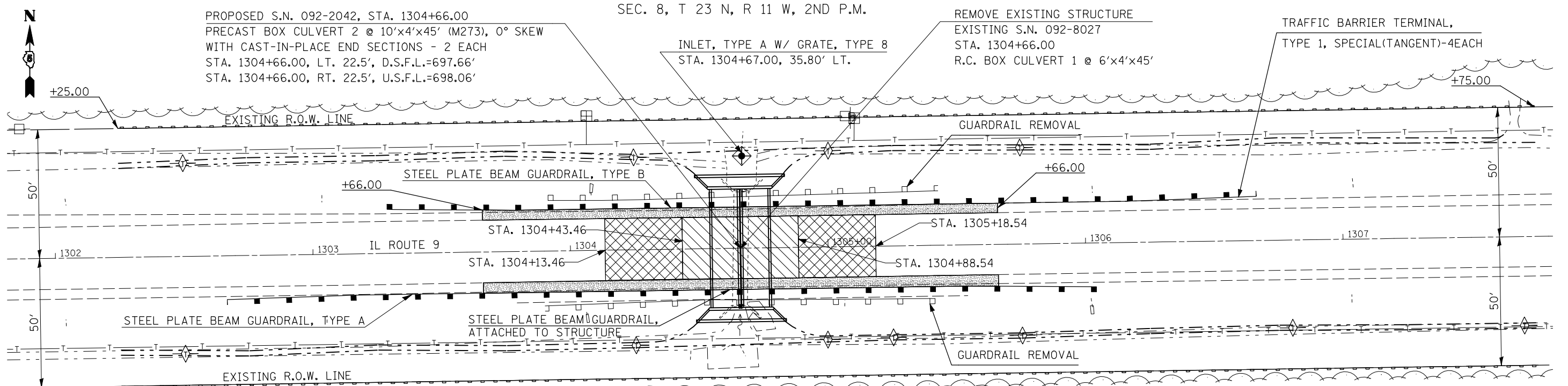

- HOT-MIX ASPHALT SURFACE REMOVAL, 1 1/2"
- CLASS D PATCH, TYPE IV, 9" = 121.0 SQ YDS
- AGGREGATE SHOULDERS, TYPE B, 6"
- PERIMETER EROSION CONTROL BARRIER
- INLET AND PIPE PROTECTION
- TEMPORARY DITCH CHECKS

PLAN NOTE: THE EXISTING FIELD TILE AT LT. STA. 1304+67.00 SHALL BE EXTENDED TO MEET THE TYPE A INLET, AS SHOWN IN THE PLANS. THE MATERIAL USED SHALL CONFORM TO THE REQUIREMENTS AS STATED IN ARTICLE 542.03 OF THE STANDARD SPECIFICATIONS. THIS WORK WILL NOT BE PAID FOR SEPARATELY, BUT SHALL BE INCLUDED IN THE COST OF THE INSTALLATION OF THE TYPE A INLET, IN ACCORDANCE WITH ARTICLE 109.04 OF THE STANDARD SPECIFICATIONS.

SEC. 17, T 23 N, R 11 W, 2ND P.M.

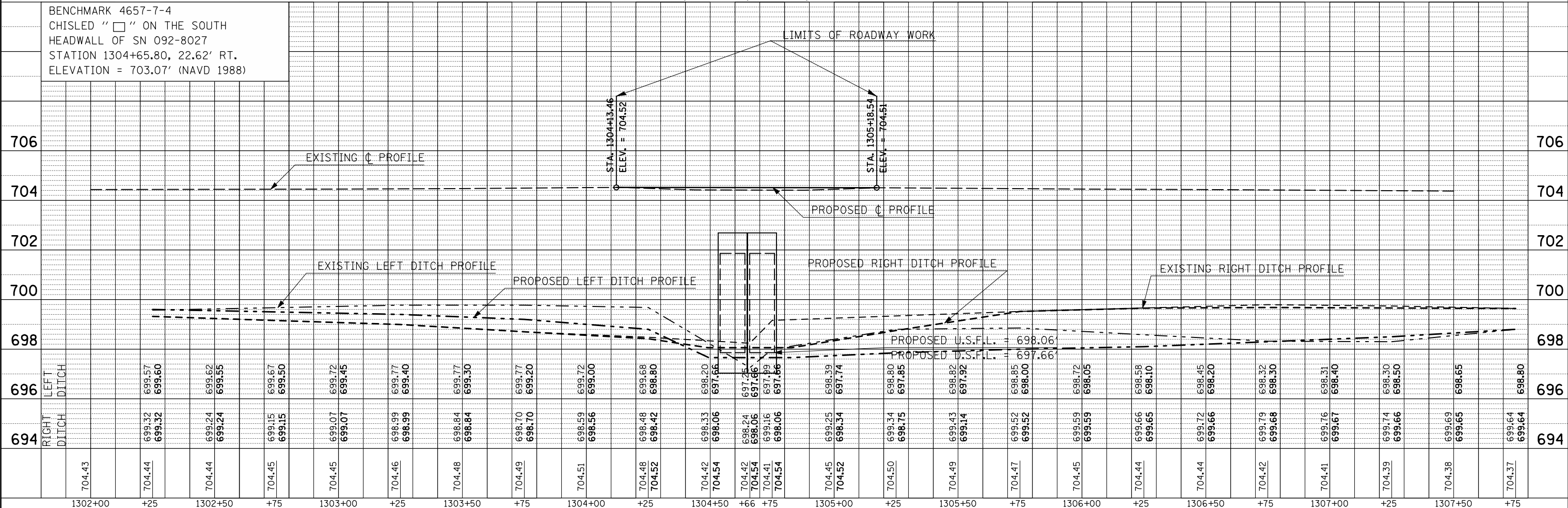

FILE NAME =	USER NAME = ceorlockjd	DESIGNED -	REVISED -	STATE OF ILLINOIS DEPARTMENT OF TRANSPORTATION	PLAN & PROFILE (S.N. 092-2042)			F.A.P. RTE.	SECTION	COUNTY	TOTAL SHEETS	SHEET NO.
ct:\pwwork\p\WIDOT\CEARLOCKJD\0132042\0570594-sht-plnpr.f.dgn	PLOT SCALE = 40.0000' / IN.	DRAWN -	REVISED -					697	46BR	Vermillion	31	11
	PLOT DATE = 10/19/2009	CHECKED -	REVISED -					CONTRACT NO. 70594				
		DATE -	REVISED -					ILLINOIS FED. AID PROJECT				