

STATE OF ILLINOIS
DEPARTMENT OF TRANSPORTATION
DIVISION OF HIGHWAYS

**PROPOSED
HIGHWAY PLANS**

FAP ROUTE 836 (IL ROUTE 49)
SECTION 119CR
PROJECT **ACF-0836(029)**
CULVERT REPLACEMENT
CHAMPAIGN COUNTY

C-95-081-07

F.A.P. RTE.	SECTION	COUNTY	TOTAL SHEETS	SHEET NO.
836	119CR	CHAMPAIGN	29	1
		ILLINOIS	CONTRACT NO. 70698	

FOR INDEX OF SHEETS, SEE SHEET NO. 2
FOR SUMMARY OF QUANTITIES, SEE SHEETS NO.4 & NO.5

DESIGN DESIGNATION
3,300 (2008) MINOR ARTERIAL IL.RTE.49

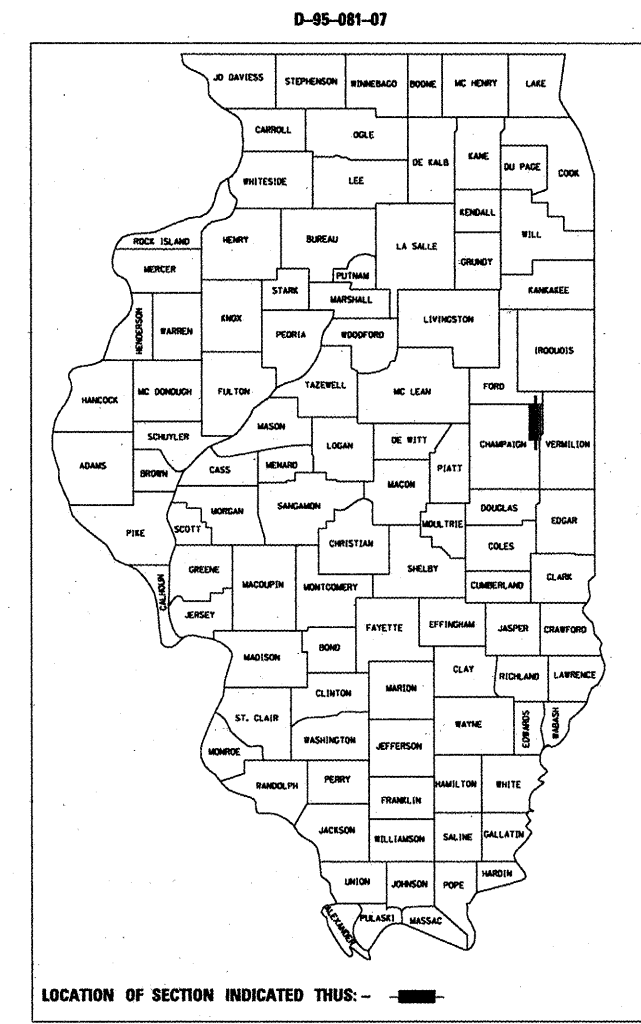

SN010-8131(P) ; SN010-8101(E)
STA. 1133 + 79
1 @ 12'x3'x37.5'
PRCBC W/PRECAST END SECTIONS

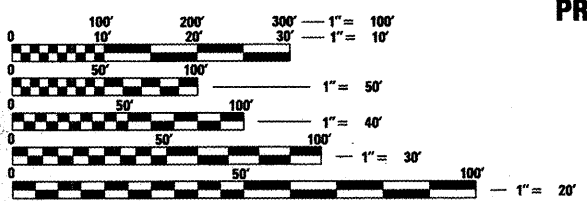
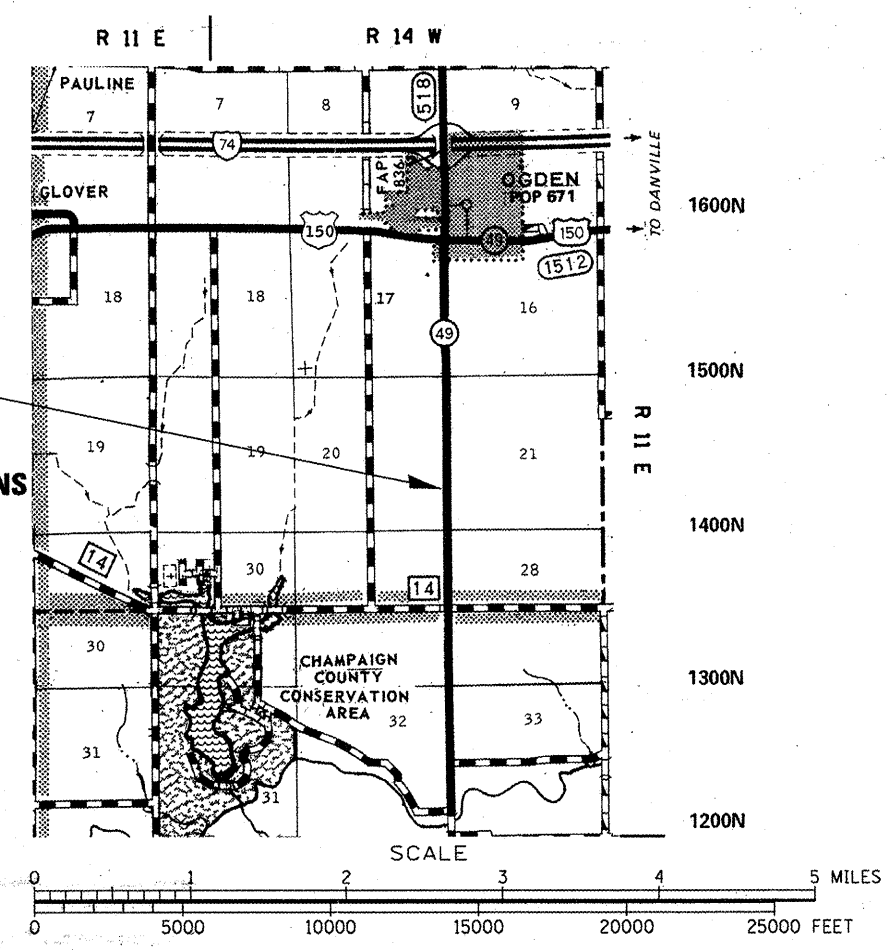

FULL SIZE PLANS HAVE BEEN PREPARED USING STANDARD ENGINEERING SCALES. REDUCED SIZED PLANS WILL NOT CONFORM TO STANDARD SCALES. IN MAKING MEASUREMENTS ON REDUCED PLANS, THE ABOVE SCALES MAY BE USED.

J.U.L.I.E.
JOINT UTILITY LOCATION INFORMATION FOR EXCAVATION
1-800-892-0123
OR 811

PROJECT ENGINEER: NANCY FASIG
PROJECT MANAGER: TODD BLACK

CONTRACT NO. 70698

STATE OF ILLINOIS
DEPARTMENT OF TRANSPORTATION
DIVISION OF HIGHWAYS

SUBMITTED 10/23 20 09
Joseph C. Lewis
DEPUTY DIRECTOR OF HIGHWAYS, REGION ENGINEER

December 4, 20 09
Charles G. Ingersoll
ENGINEER OF DESIGN AND ENVIRONMENT

December 4, 20 09
Christine M. Reed
DIRECTOR OF HIGHWAYS, CHIEF ENGINEER

**PRINTED BY THE AUTHORITY
OF THE STATE OF ILLINOIS**