

EXIST. CURVE 80
 PI STA. = 178+82.95
 $\Delta = 22^\circ 28' 30''$ (LT)
 D = 1° 16' 00''
 R = 4,523.76'
 T = 898.81'
 L = 1,774.51'
 E = 88.43'
 e = ----
 T.R. = ----
 S.E. RUN = ----
 P.C. STA. = 169+84.14
 P.T. STA. = 187+58.65

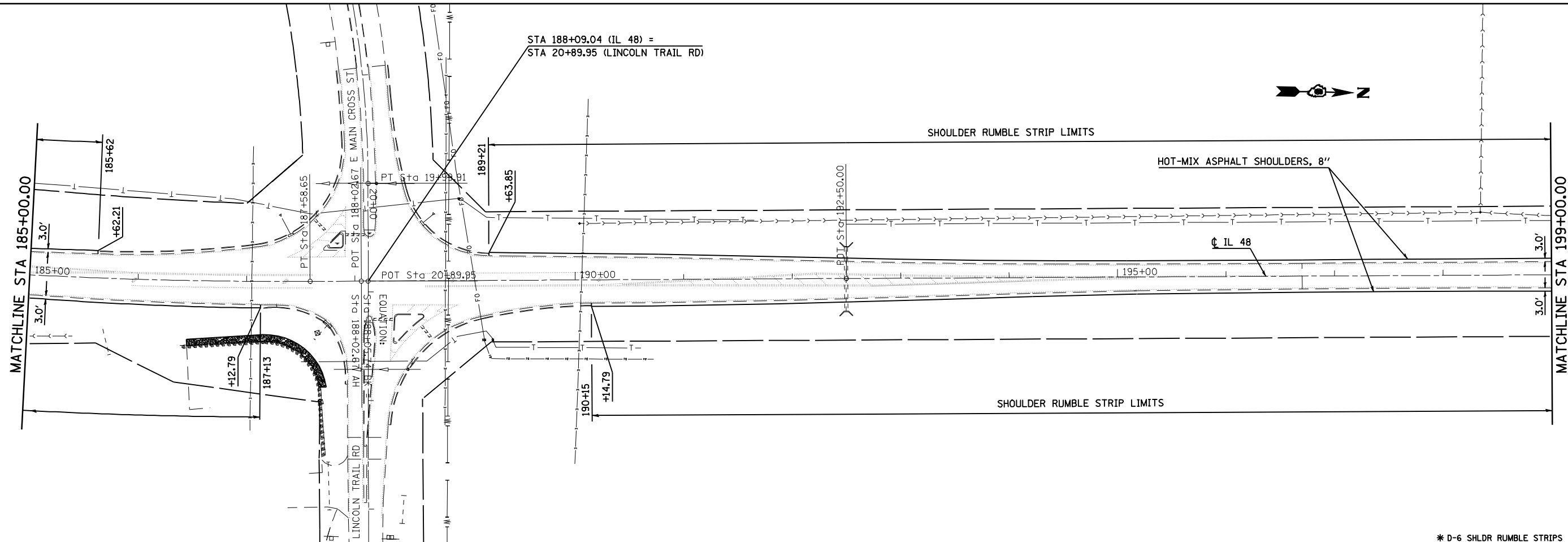
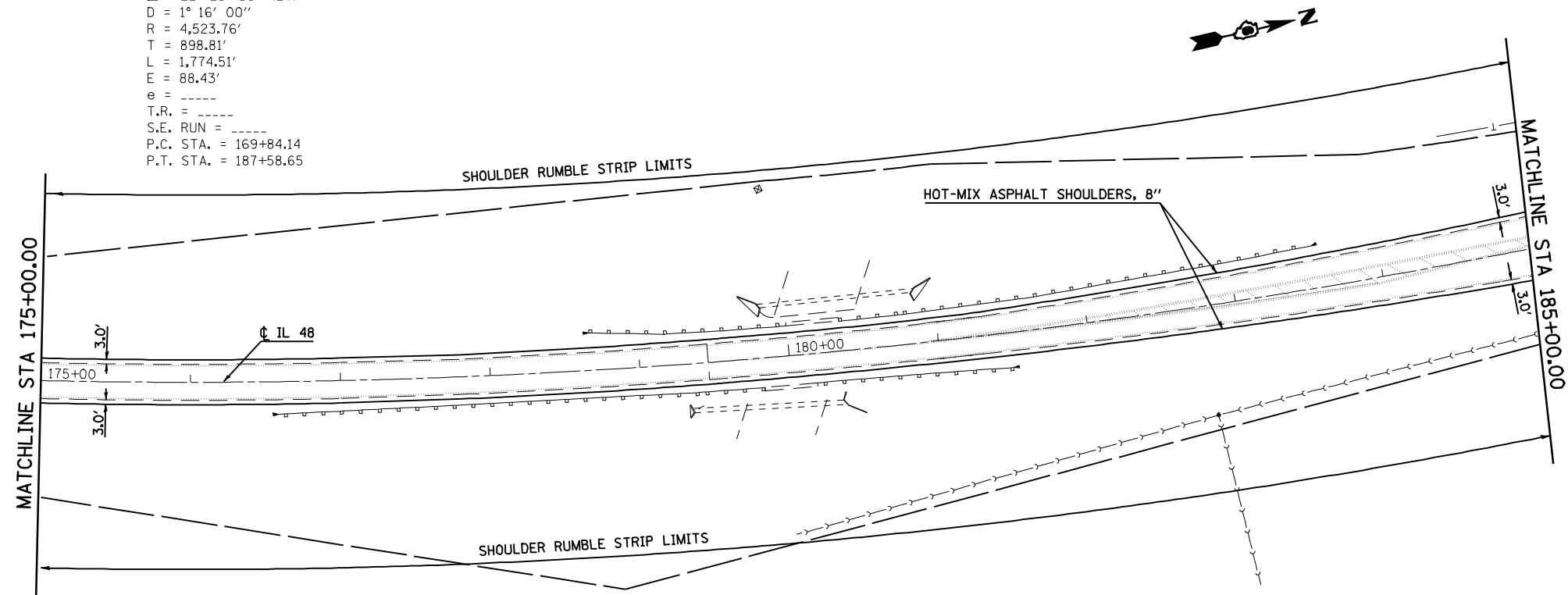

STA 188+09.04 (IL 48) =
 STA 20+89.95 (LINCOLN TRAIL RD)

FILE NAME =	USER NAME = laughlinr1	DESIGNED -	REVISED -
es:\pwork\pwork\LAUGHLINRL\0128096\0672C78-sht-plan1.dgn		DRAWN -	REVISED -
PLOT SCALE = 100.0000' / IN.		CHECKED -	REVISED -
PLOT DATE = Oct-02-2009 09:07:22AM		DATE -	REVISED -

**STATE OF ILLINOIS
 DEPARTMENT OF TRANSPORTATION**

PLAN SHEETS FAP 714 (IL 48)			
SECTION D6 RUMBLE STRIPS 2010			
SCALE: 1" = 50'	SHEET NO.	OF SHEETS	STA. TO STA.

* D-6 SHLDR RUMBLE STRIPS 2010				
F.A.P. RTE.	SECTION	COUNTY	TOTAL SHEETS	SHEET NO.
714	*	CHRISTIAN	18	16
CONTRACT NO. 72C78				
ILLINOIS FED. AID PROJECT				