

**TRAFFIC SIGNAL PLAN - EXISTING**

**TRAFFIC SIGNAL GENERAL NOTES**

1. SIGNAL FACES FOR THE SOUTH APPROACH ARE NOTED AS "B", "C" FOR THE WEST APPROACH AND "D" FOR THE EAST APPROACH.
2. SIGNAL HEADS (C<sub>2</sub>-C<sub>3</sub>) AND (D<sub>2</sub>-D<sub>3</sub>) SHALL BE WIRED IN PARALLEL.
3. PROPOSED SIGNAL HEAD C<sub>4</sub> SHALL UTILIZE THE EXISTING SEVEN CONDUCTOR CABLE THAT WAS PREVIOUSLY INSTALLED FOR FUTURE USE.
4. THIS SIGNAL INSTALLATION WILL BE TURNED OFF BY THE DISTRICT 7 BUREAU OF OPERATIONS TO FACILITATE STRUCTURE AND BRIDGE APPROACH WORK AND PORTIONS OF THE PCC PAVEMENT WORK. ALL TRAFFIC SIGNAL WORK SHOWN ON THIS SHEET SHOULD BE COMPLETED DURING THIS PERIOD.
5. THE EXISTING SIGNAL TIMINGS SHALL BE UTILIZED AT EACH INTERSECTION EXCEPT AS MODIFIED BY THE DISTRICT 7 BUREAU OF OPERATIONS.
6. MAST ARM MOUNTED SIGNALS SHALL BE INSTALLED SO THAT ALL PARTS OF THE SIGNAL HEAD, INCLUDING BACKPLATE, ARE A MINIMUM OF 16'-0" ABOVE THE ROADWAY SURFACE AT THE LOCATION OF THE SIGNAL HEAD. ALIGN ADJACENT RED INDICATIONS AT SAME HEIGHT.
7. MAINTENANCE OF EXISTING TRAFFIC SIGNAL INSTALLATION WILL BE REQUIRED AT THE FOLLOWING INTERSECTIONS.
  - CHARLESTON AVE./19th STREET
  - CHARLESTON AVE./LAKE LAND BLVD
  - CHARLESTON AVE./17th STREET

**LIST OF MATERIAL**

ITEM	UNIT	QUANTITY
LOCATING UNDERGROUND CABLE	FOOT	55
CONDUIT IN TRENCH, 2" DIA., PVC	FOOT	200
CONDUIT PUSHED, 4" DIA., PVC	FOOT	69
CONDUIT ENBEDDED IN STRUCTURE, 2" DIA., GALVANIZED STEEL	FOOT	232
HANDHOLE	EACH	2
HANDHOLE TO BE ADJUSTED	EACH	1
TRENCH AND BACKFILL FOR ELECTRICAL WORK	FOOT	50
TRENCH AND BACKFILL WITH SCREENINGS OR SAND	FOOT	150
MAINTENANCE OF EXISTING TRAFFIC SIGNAL INSTALLATION	EACH	3
FIBER OPTIC CABLE IN CONDUIT, NO. 62.5/125, 6F	FOOT	485
ELECTRIC CABLE IN CONDUIT, SIGNAL NO. 12 1/C	FOOT	485
ELECTRIC CABLE IN CONDUIT, SIGNAL NO. 14 4/C	FOOT	175
ELECTRIC CABLE IN CONDUIT, SIGNAL NO. 14 7/C	FOOT	400
SIGNAL HEAD, POLYCARBONATE, LED, 1-FACE, 5-SECTION, BRACKET MOUNTED	EACH	2
RELOCATE EXISTING TRAFFIC SIGNAL POST	EACH	2
RELOCATE EXISTING MAST ARM ASSEMBLY AND POLE	EACH	1
REMOVE ELECTRIC CABLE FROM CONDUIT	FOOT	1310
REMOVE AND REINSTALL ELECTRIC CABLE FROM CONDUIT	FOOT	250
REMOVE EXISTING HANDHOLE	EACH	1

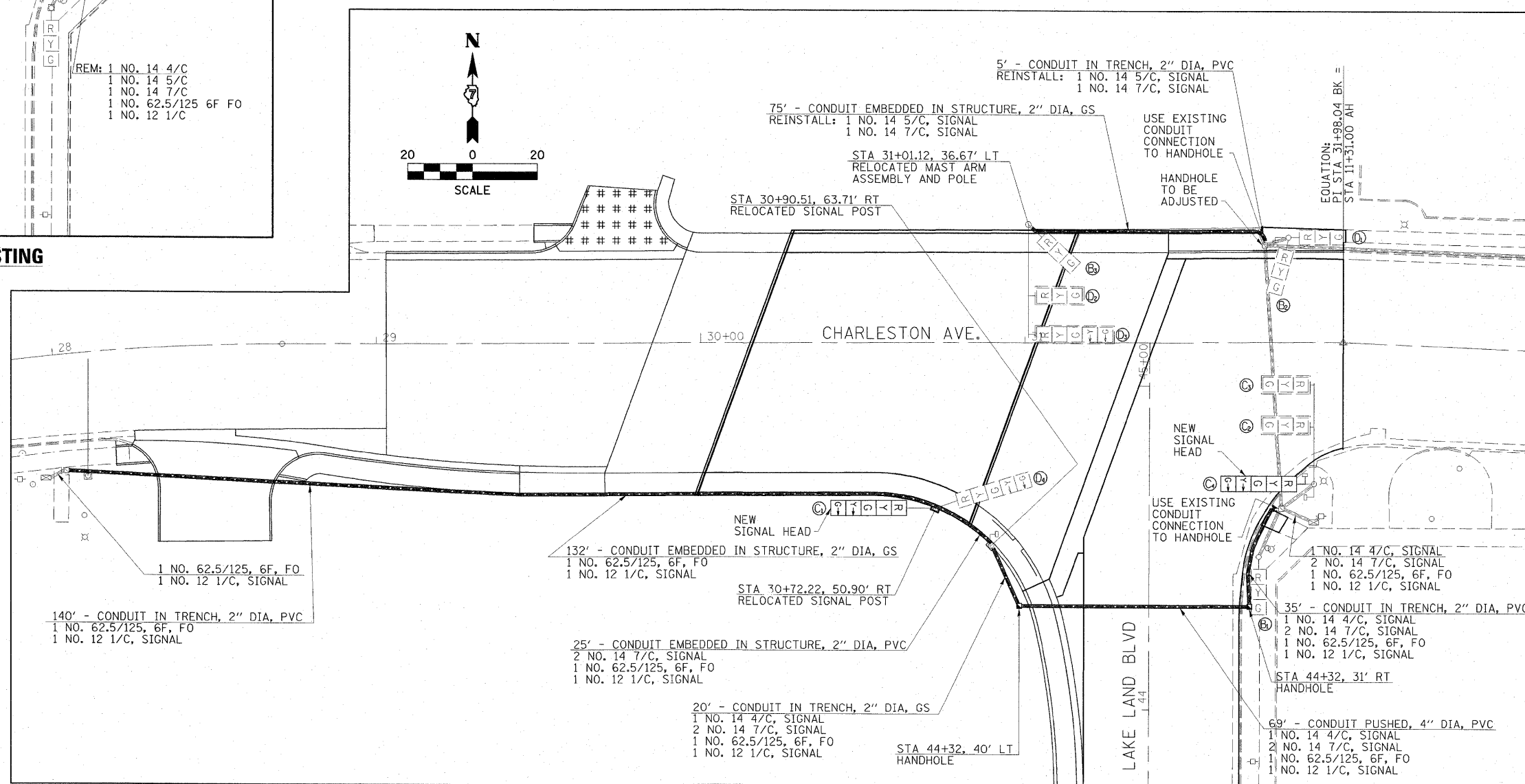

**TRAFFIC SIGNAL PLAN - MODIFICATIONS**

FILE NAME = 0774149-SHT-TS01.dgn	USER NAME = HAS	DESIGNED - MTD	REVISED -
		DRAWN - HAS	REVISED -
		CHECKED - MTD	REVISED -
		DATE - AUGUST 3, 2009	REVISED -

**STATE OF ILLINOIS  
DEPARTMENT OF TRANSPORTATION**

**TRAFFIC SIGNAL MODIFICATIONS  
CHARLESTON AVE./LAKE LAND BLVD**

SCALE: 1"=20' SHEET NO. 1 OF 1 SHEETS STA. 27+80 TO STA. 11+70

F.A.P. RTE. = 325	SECTION = (19VBR)BR	COUNTY = COLES	TOTAL SHEETS = 92	SHEET NO. = 20
CONTRACT NO. 74149				
FED. ROAD DIST. NO. ILLINOIS FED. AID PROJECT AID				