

STATE OF ILLINOIS  
DEPARTMENT OF TRANSPORTATION

2018'-7<sup>3</sup>/<sub>4</sub>" Bk. to Bk. Abutments (along SB PG)  
2189'-6<sup>1</sup>/<sub>2</sub>" Bk. to Bk. Abutments (along NB PG)

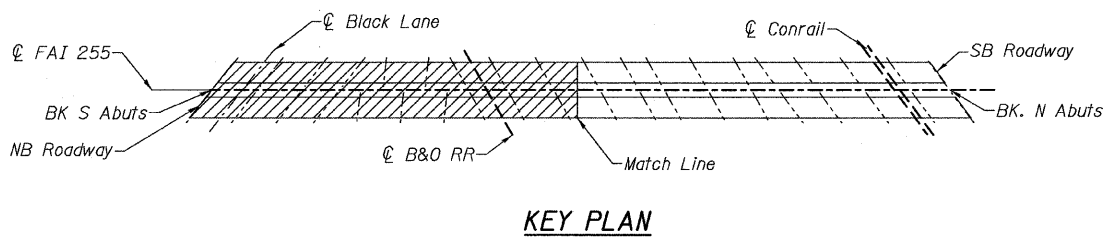
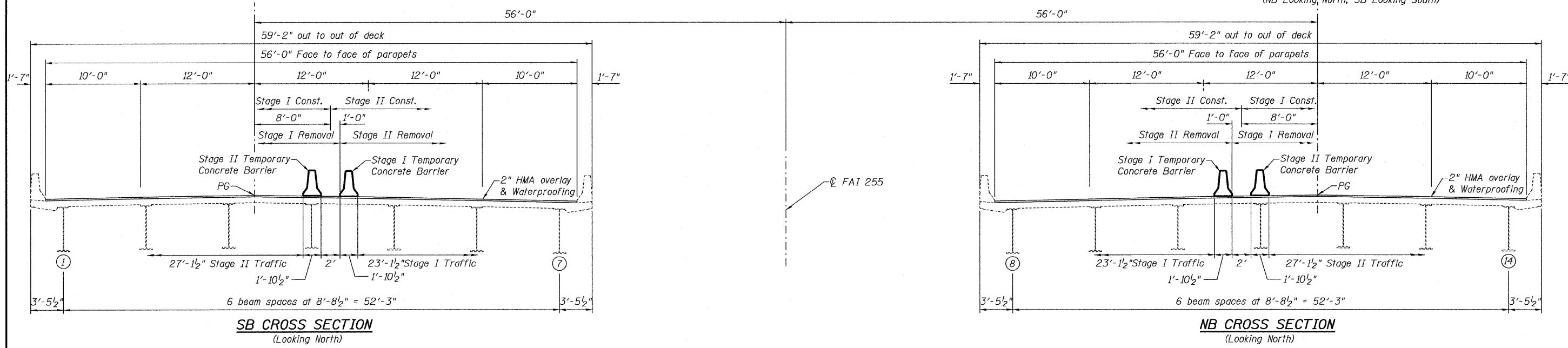
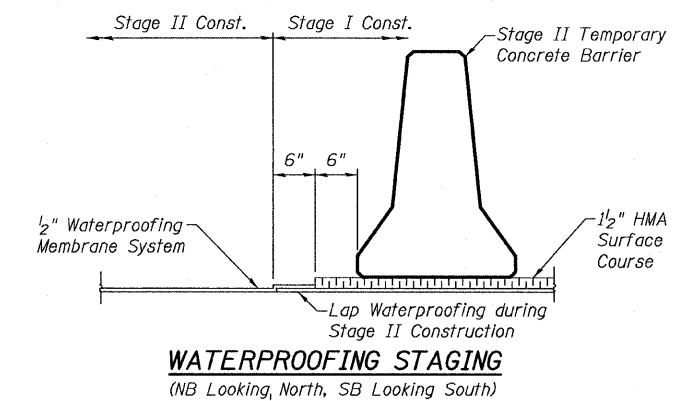
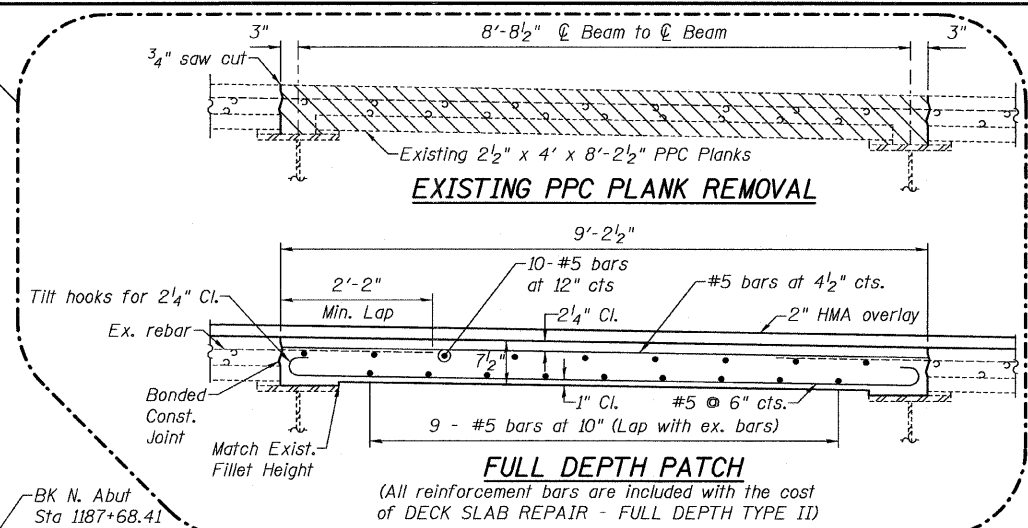
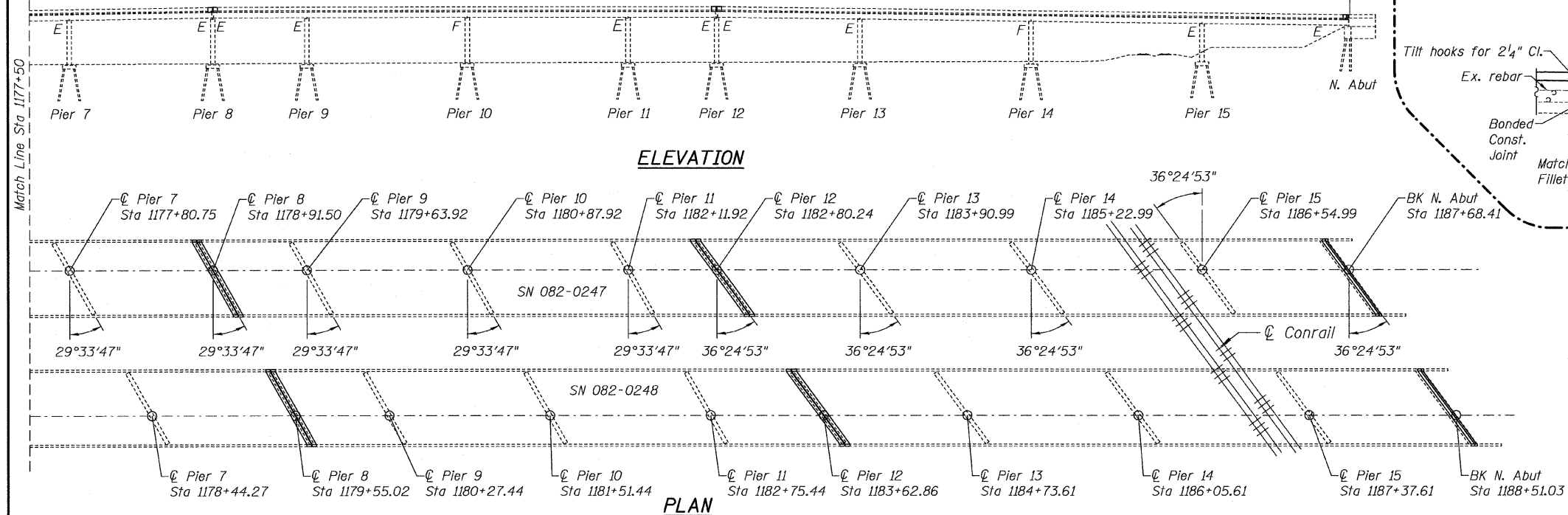

**PLAN & ELEVATION**  
**SN 082-0247 & 0248**

DESIGNED	J. Uehle
CHECKED	A. Holloway
DRAWN	J. Uehle
CHECKED	A. Holloway

NOVEMBER 5, 2009

EXAMINED *A. Carl Powers*  
ENGINEER OF STRUCTURAL SERVICES

PASSED *Ralph E. Anderson*  
ENGINEER OF BRIDGES AND STRUCTURES

SHEET NO. 2 20 SHEETS	F.A.I. RTE. 255	SECTION 82-1HVB-I-1	COUNTY ST. CLAIR	TOTAL SHEETS 45	SHEET NO. 27
	CONTRACT NO. 76926				
FED. ROAD DIST. NO.		ILLINOIS FED. AID PROJECT			