

- ↑ ARROW BOARD
- ⊥ SIGN
- ▲ DIRECTION INDICATOR BARRICADE WITH STEADY BURN MONODIRECTIONAL LIGHT
- ⬇ TYPE II BARRICADE, DRUM, OR VERTICAL BARRICADE WITH STEADY BURN MONODIRECTIONAL LIGHT
- ▨ IMPACT ATTENUATOR

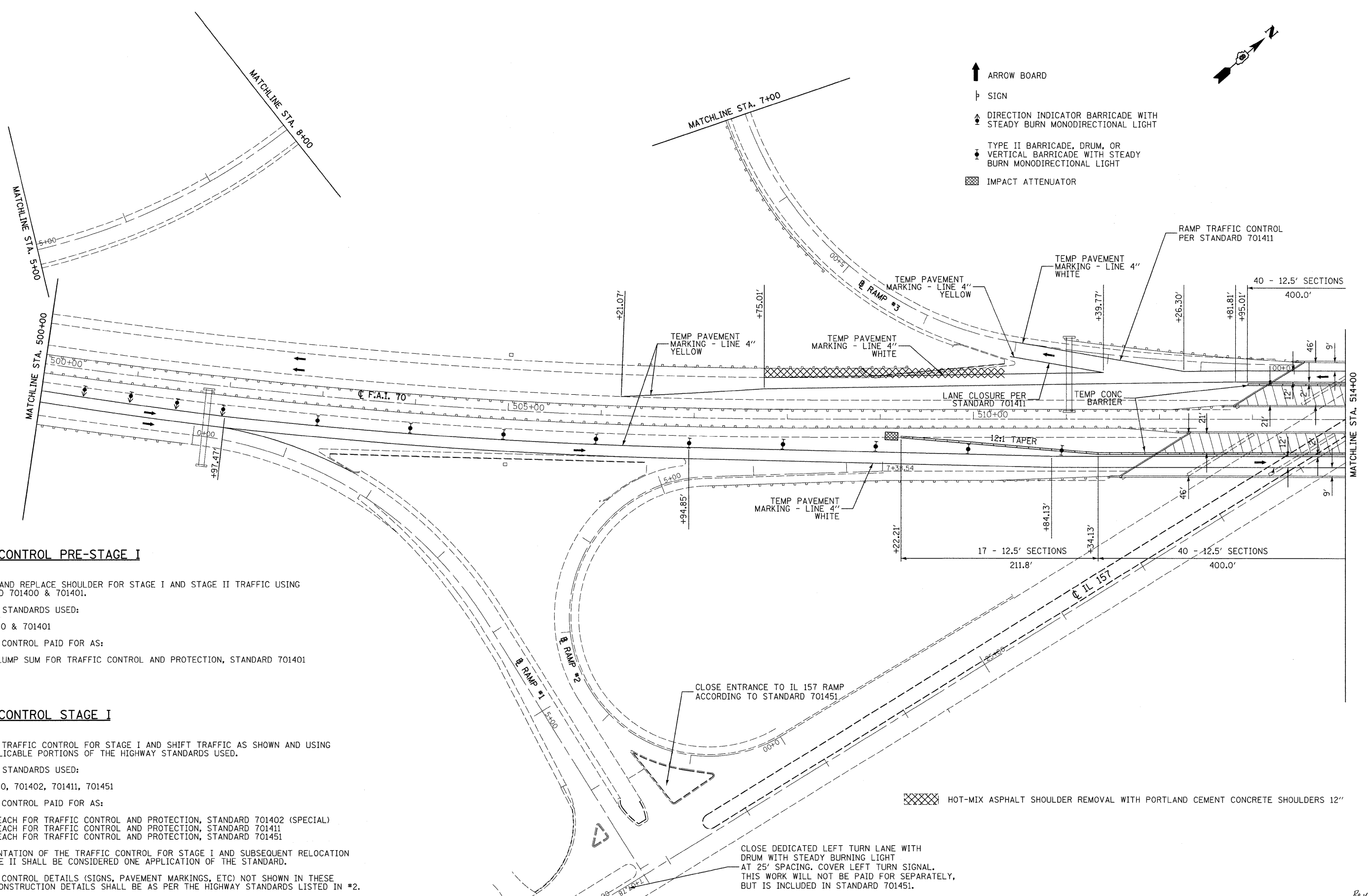

TRAFFIC CONTROL PRE-STAGE I

1. REMOVE AND REPLACE SHOULDER FOR STAGE I AND STAGE II TRAFFIC USING STANDARD 701400 & 701401.
2. HIGHWAY STANDARDS USED:
701400 & 701401
3. TRAFFIC CONTROL PAID FOR AS:
PER LUMP SUM FOR TRAFFIC CONTROL AND PROTECTION, STANDARD 701401

TRAFFIC CONTROL STAGE I

1. INSTALL TRAFFIC CONTROL FOR STAGE I AND SHIFT TRAFFIC AS SHOWN AND USING THE APPLICABLE PORTIONS OF THE HIGHWAY STANDARDS USED.
2. HIGHWAY STANDARDS USED:
701400, 701402, 701411, 701451
3. TRAFFIC CONTROL PAID FOR AS:
PER EACH FOR TRAFFIC CONTROL AND PROTECTION, STANDARD 701402 (SPECIAL)
PER EACH FOR TRAFFIC CONTROL AND PROTECTION, STANDARD 701411
PER EACH FOR TRAFFIC CONTROL AND PROTECTION, STANDARD 701451
4. IMPLEMENTATION OF THE TRAFFIC CONTROL FOR STAGE I AND SUBSEQUENT RELOCATION TO STAGE II SHALL BE CONSIDERED ONE APPLICATION OF THE STANDARD.
5. TRAFFIC CONTROL DETAILS (SIGNS, PAVEMENT MARKINGS, ETC) NOT SHOWN IN THESE STAGE CONSTRUCTION DETAILS SHALL BE AS PER THE HIGHWAY STANDARDS LISTED IN #2.

LAST SAVED = 9/11/2009
 PEN TABLE = VB.tbl
 PLOT DRIVER = TR-Xerox6204-Tp-Flt.plt

FILE NAME =	USER NAME = sdonahue	DESIGNED -	REVISED -
\\v08090\work_order\3\cad\plans\0876256-Sht-Staging-IL157-BeltLine-Stage1-02.dgn		DRAWN -	REVISED -
		CHECKED -	REVISED -
		DATE -	REVISED -

**STATE OF ILLINOIS
DEPARTMENT OF TRANSPORTATION**

**HORNER &
SHIFRIN, INC.**
ENGINEERS

STAGE CONSTRUCTION DETAILS
I-55/70 STRUCTURES OVER IL 157 & BELT LINE ROAD
STAGE I

F.A.I. RTE.	SECTION	COUNTY	TOTAL SHEETS	SHEET NO.
70	60-(5,6,7)RS, 60-(6,7)BR	MADISON	185	62
CONTRACT NO. 76C56				
FED. ROAD DIST. NO. ILLINOIS FED. AID PROJECT				