

QUANTITY  
 4 (100) LINE = 64.1 ft. (19.7 m)  
 21.1 sq. ft. (1.97 sq. m)

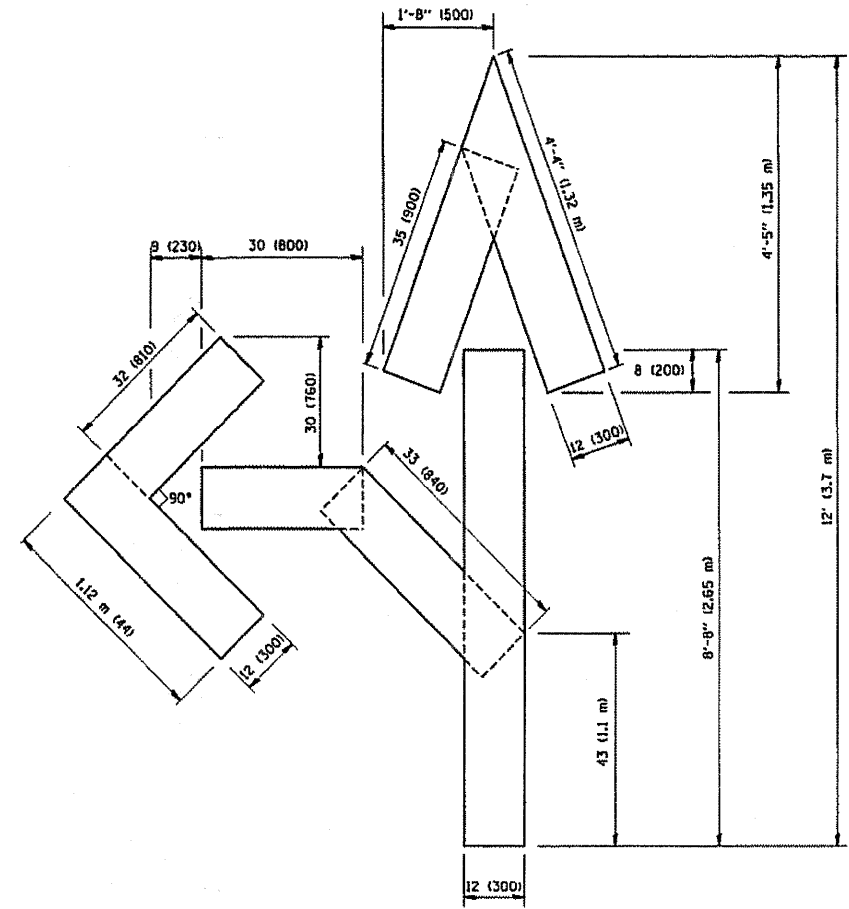

QUANTITY  
 4 (100) LINE = 82.5 ft. (25.3 m)  
 27.5 sq. ft. (2.53 sq. m)

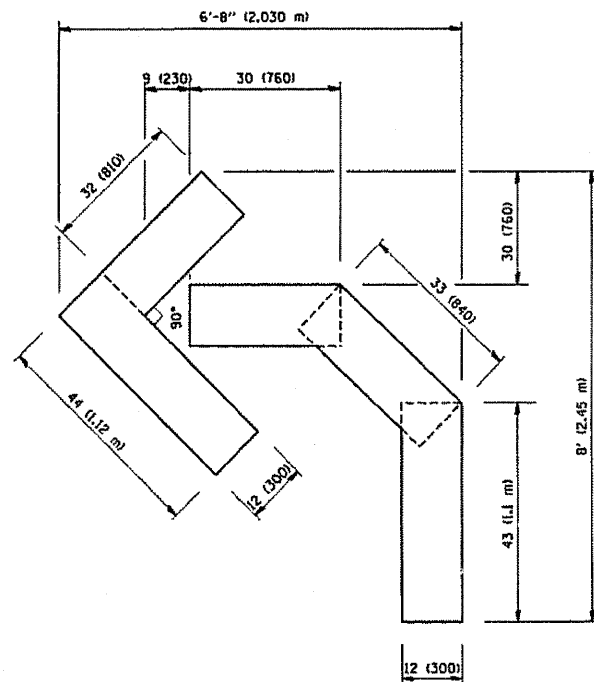

QUANTITY  
 4 (100) LINE = 45.5 ft. (13.9 m)  
 15.2 sq. ft. (1.39 sq. m)

All dimensions are in Inches (millimeters) unless otherwise shown.

|   |                             |                 |                                |
|---|-----------------------------|-----------------|--------------------------------|
| FILE NAME =<br>W:\dotstd\22-34\1c18.dgn | USER NAME = gajlonobt       | DESIGNED -      | REVISED -T. RAMMACHER 06-05-96 |
|   |                             | DRAWN -         | REVISED -T. RAMMACHER 11-04-97 |
|   | PLOT SCALE = 50.0000 / 1/8" | CHECKED -       | REVISED -T. RAMMACHER 03-02-98 |
|   | PLOT DATE = 1/4/2008        | DATE = 09-18-94 | REVISED -E. GOMEZ 08-28-00     |

STATE OF ILLINOIS  
 DEPARTMENT OF TRANSPORTATION

|   |  |  |  |   |         |                    |              |           |
|---|--|--|--|---|---------|--------------------|--------------|-----------|
| PAVEMENT MARKING LETTERS AND SYMBOLS<br>FOR TRAFFIC STAGING |  |  |  | F.A. RTE.                                       | SECTION | COUNTY             | TOTAL SHEETS | SHEET NO. |
| SCALE: NONE   |  |  |  | SHEET NO. 1                                     | OF 1    | SHEETS             | STA.         | TO STA.   |
|   |  |  |  | TC-16   |         | CONTRACT NO. 83909 |              |           |
|   |  |  |  | FED. ROAD DIST. NO. 1 ILLINOIS FED. AID PROJECT |         |                    |              |           |