

F.A.U. ROUTE NO.	SECTION	ILLINOIS PROJECT	CONTRACT NO.	COUNTY	TOTAL SHEETS	SHEET NUMBER
5405	09-00043-00-RS	ARA-5076 (007)	87413	DeKALB	6	1

STATE OF ILLINOIS
DEPARTMENT OF TRANSPORTATION

**PLANS FOR
PROPOSED LOCAL AGENCY IMPROVEMENT
AMERICAN RECOVERY AND REINVESTMENT ACT**

CITY OF SANDWICH – RAILROAD STREET (F.A.U. ROUTE 5405)
DEKALB COUNTY
SECTION 09-00043-00-RS
PROJECT : ARA – 5076 (007)
JOB NO. C-93-136-09

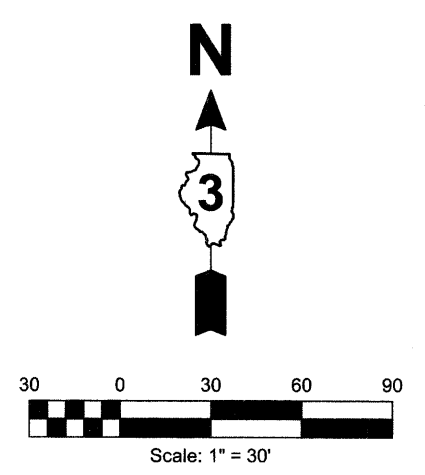
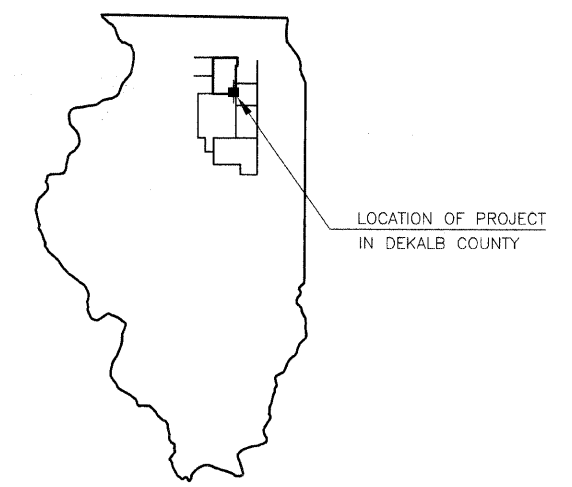

LOCATION MAP : NOT TO SCALE
TYPICAL SECTIONS : NOT TO SCALE
PLAN SHEETS : HORIZ. : 1" = 30'

INDEX OF SHEETS

- 1 COVER SHEET
- 2 SUMMARY OF QUANTITIES & TYPICAL SECTIONS
- 3 - 6 PLAN SHEETS

STANDARDS

- 701501-05 URBAN LANE CLOSURE, 2L, 2W, UNDIVIDED
- 701901 TRAFFIC CONTROL DEVICES
- 000001-05 STANDARD SYMBOLS, ABBREVIATIONS AND PATTERNS

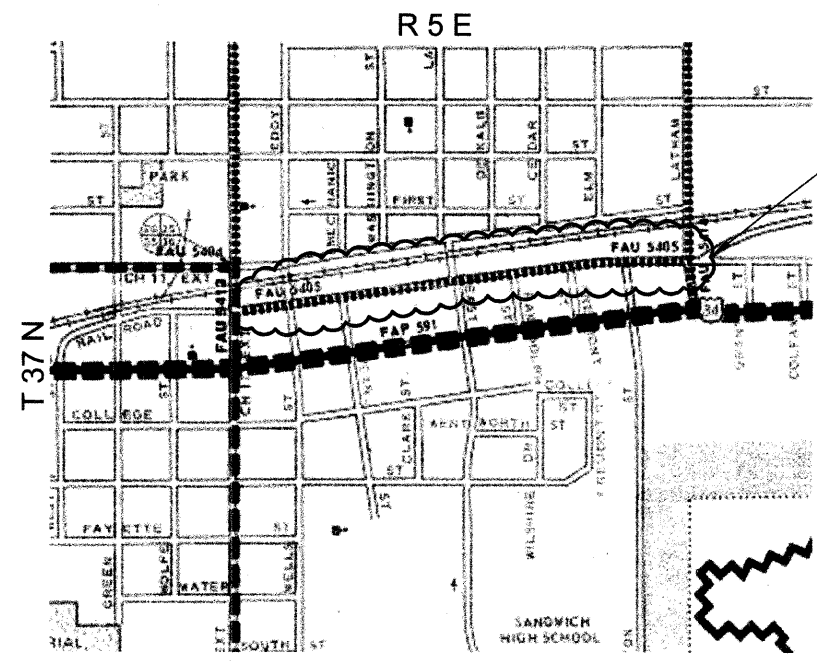

RAILROAD STREET
STATION 0+36 TO 26+73

GROSS LENGTH OF IMPROVEMENTS = 2637 FT. = 0.50 MI.
NET LENGTH OF IMPROVEMENTS = 2637 FT. = 0.50 MI.

PAVEMENT DESIGN INFORMATION

LOCATION	DESIGN CLASSIFICATION	STRUCTURAL DESIGN TRAFFIC (SDT)	TRAFFIC FACTOR
RAILROAD STREET - MAIN TO LAFAYETTE	CLASS II	2154 (2014)	0.07
RAILROAD STREET - LAFAYETTE TO LATHAM	CLASS III	1832 (2014)	0.06

PREPARED BY:

Thomas A. Duttlinger
THOMAS A. DUTTLINGER
I.R.P.E. NO. 62-52480
EXPIRES NOVEMBER 30, 2009

DATE: October 20, 2009



SECTION 09-00043-00-RS - L.A.P.P. - F.A.U. 5405
RAILROAD STREET - CITY OF SANDWICH

**ETSCHIED
DUTTLINGER
& ASSOCIATES INC.**
Professional Engineers & Land Surveyors

1304 Gemini Circle
Ottawa, Illinois 61350
TEL: 815-434-3925
FAX: 815-434-3953

PROFESSIONAL DESIGN FIRM # 184-000711
DRAWN BY: M.S.R. CHECKED BY: PROJECT #: 3227.04C
DATE PLOTTED: OCTOBER 17, 2009 FILENAME: J322704C_STREETPLAN

SHEET NO.
1 OF 6

APPROVED Oct 21 2009
Tom Remeck
MAYOR, CITY OF SANDWICH

APPROVED October 27th 2009
Kenneth L. Fay
DISTRICT 3 ENGINEER OF LOCAL ROADS & STREETS

APPROVED October 27th 2009
George F. Ryan
DEPUTY DIRECTOR OF HIGHWAYS, REGION 2

STATE OF ILLINOIS
DEPARTMENT OF TRANSPORTATION

F.A.U. ROUTE NO.	SECTION	ILLINOIS PROJECT	CONTRACT NO.	COUNTY	TOTAL SHEETS	SHEET NUMBER
5405	09-00043-00-RS	ARA-5076 (007)	87413	DeKALB	6	2

SUMMARY OF QUANTITIES

ITEM NO.	ITEM	UNIT	QUANTITY
44000156	HMA SURF. REM. (COLD MILL), 1-3/4"	S.Y.	4,602
44000160	HMA SURF. REM. (COLD MILL), 2-3/4"	S.Y.	1,566
44000198	HMA SURF. REM. (COLD MILL), VAR. DEPTH 0" TO 1-3/4"	S.Y.	2,418
40600982	HMA SURF. REM. - BUTT JOINT	S.Y.	344
40600100	BITUMINOUS MATERIALS (PRIME COAT), RC-70	GAL.	1,060
40600300	AGGREGATE (PRIME COAT)	TON	14
40600615	LEVELING BINDER (MACHINE METHOD), N30	TON	556
40603080	HOT-MIX ASPHALT BIND. CSE., IL-19.0, N50	TON	254
40603305	HOT-MIX ASPHALT SURF. CSE., MIX "C", N30	TON	1,010
67100100	MOBILIZATION	LUMP SUM	1

Construction Code: I000

ITEM NUMBER	ITEM	UNIT	LOCATION			TOTAL	UNIT
			SECTION #1 STA 0+36 TO 6+88	SECTION #2 STA 6+88 TO 10+16	SECTION #3 STA 10+16 TO 26+73		
44000156	HMA SURF. REM. (COLD MILL), 1-3/4"	S.Y.	4,602	0	0	4,602	S.Y.
44000160	HMA SURF. REM. (COLD MILL), 2-3/4"	S.Y.	0	1,566	0	1,566	S.Y.
44000198	HMA SURF. REM. (COLD MILL), VAR. DEPTH 0" TO 1-3/4"	S.Y.	0	0	2,418	2,418	S.Y.
40600982	HMA SURF. REM. - BUTT JOINT	S.Y.	0	0	344	344	S.Y.
40300100	BITUMINOUS MATERIALS (PRIME COAT), RC-70	GAL.	368	125	567	1,060	GAL.
40600300	AGGREGATE (PRIME COAT)	TON	5	2	7	14	TON
40600615	LEVELING BINDER (MACHINE METHOD), N30	TON	219	0	337	556	TON
40603080	HOT-MIX ASPHALT BIND. CSE., IL-19.0, N50	TON	0	254	0	254	TON
40603305	HOT-MIX ASPHALT SURF. CSE., MIX "C", N30	TON	359	115	536	1,010	TON
67100100	MOBILIZATION	LUMP SUM	0.33	0.33	0.33	1	LUMP SUM
	LENGTH		652 L.F.	328 L.F.	1657 L.F.	2,637	L.F.
	WIDTH		61.7' (AVERAGE)	54.4' TO 39.0'	39.3' TO 29.3'		
	AREA OF IMPROVEMENT		4,602 S.Y.	1,566 S.Y.	7,087 S.Y.	13,255	S.Y.

ASPHALT TABLE

	HMA BINDER	HMA LEVEL BINDER	HMA SURFACE
PG GRADE	PG64-22	PG64-22	PG64-22
DESIGN AIR VOIDS	4.0% @ N50	3.0% @ N30	3.0% @ N30
MIXTURE COMPOSITION	IL 19.0	IL 9.5	IL 9.5
FRICTION AGGREGATE			MIXTURE C
DENSITY TEST METHOD	CORES	SATISFACTION OF ENGINEER	CORES

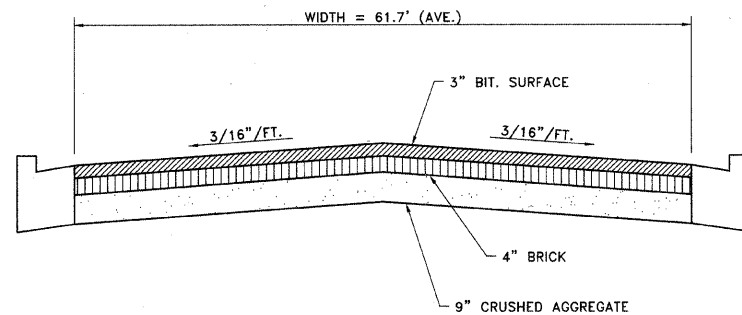

SECTION #1 (A-A) - EXISTING - STATION 0+36 TO 6+88

RAILROAD STREET - MAIN TO PEARL
EXISTING STRUCTURE : 3" BIT. SURFACE, 4" BRICK, 9" CRUSHED AGGREGATE

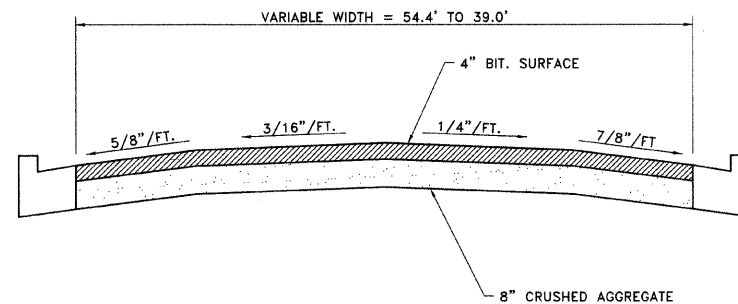

SECTION #2 (B-B) - EXISTING - STATION 6+88 TO 10+16

RAILROAD STREET - PEARL TO CLARK

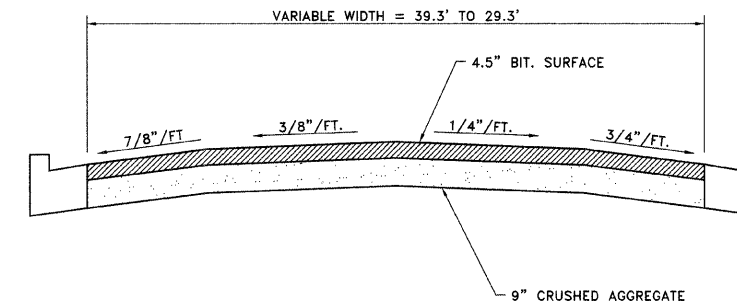

SECTION #3 (C-C) - EXISTING - STATION 10+16 TO 26+73

RAILROAD STREET - CLARK TO LATHAM

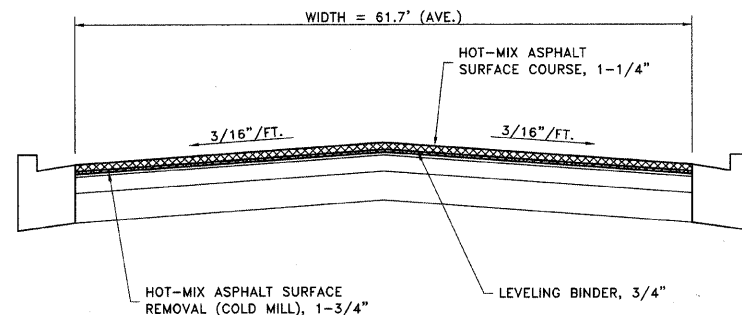

SECTION #1 (A-A) - PROPOSED - STATION 0+36 TO 6+88

RAILROAD STREET - MAIN TO PEARL

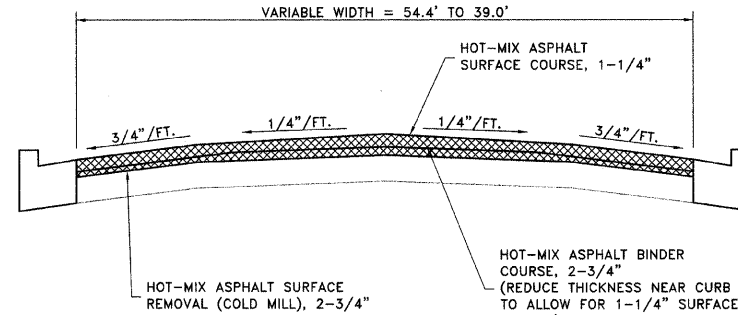

SECTION #2 (B-B) - PROPOSED - STATION 6+88 TO 10+16

RAILROAD STREET - PEARL TO CLARK

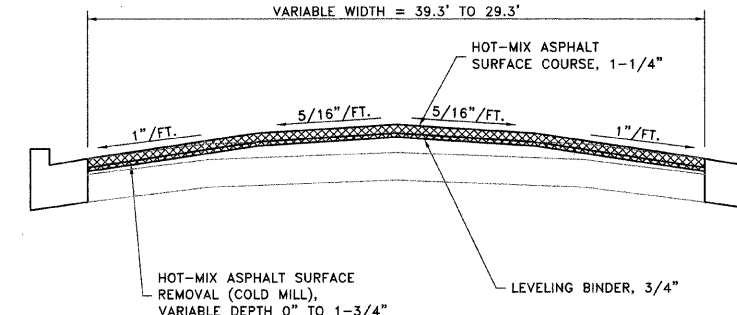

SECTION #3 (C-C) - PROPOSED - STATION 10+16 TO 26+73

RAILROAD STREET - CLARK TO LATHAM

1304 GEMINI CIRCLE
OTTAWA, IL 61350-1692
TEL: 815-464-3925
FAX: 815-464-3933

**ETSCHIED
DUTTLINGER
& ASSOCIATES**
Professional Engineers & Land Surveyors

PROFESSIONAL DESIGN
FIRM # 184-000711
DATE PLOTTED:
OCTOBER 17, 2009
DRAWN BY:
M.S.R.
CHECKED BY:
PROJECT NUMBER:
3227.04C
DRAWING FILE:
322704C_STREETPLAN

SHEET NO.
2 OF 6

SUMMARY OF QUANTITIES & TYPICAL SECTIONS

**F.A.U. 5405 - RAILROAD STREET
SECTION 09-000-43-00-RS
CITY OF SANDWICH, DEKALB COUNTY**

F.A.U. ROUTE NO.	SECTION	ILLINOIS PROJECT	CONTRACT NO.	COUNTY	TOTAL SHEETS	SHEET NUMBER
5405	09-00043-00-RS	ARA-5076 (007)	87413	DeKALB	6	3

F.A.U. L.A.P.P.

F.A.U. 5405 - RAILROAD STREET
SECTION 09-000-43-00-RS
CITY OF SANDWICH, DEKALB COUNTY

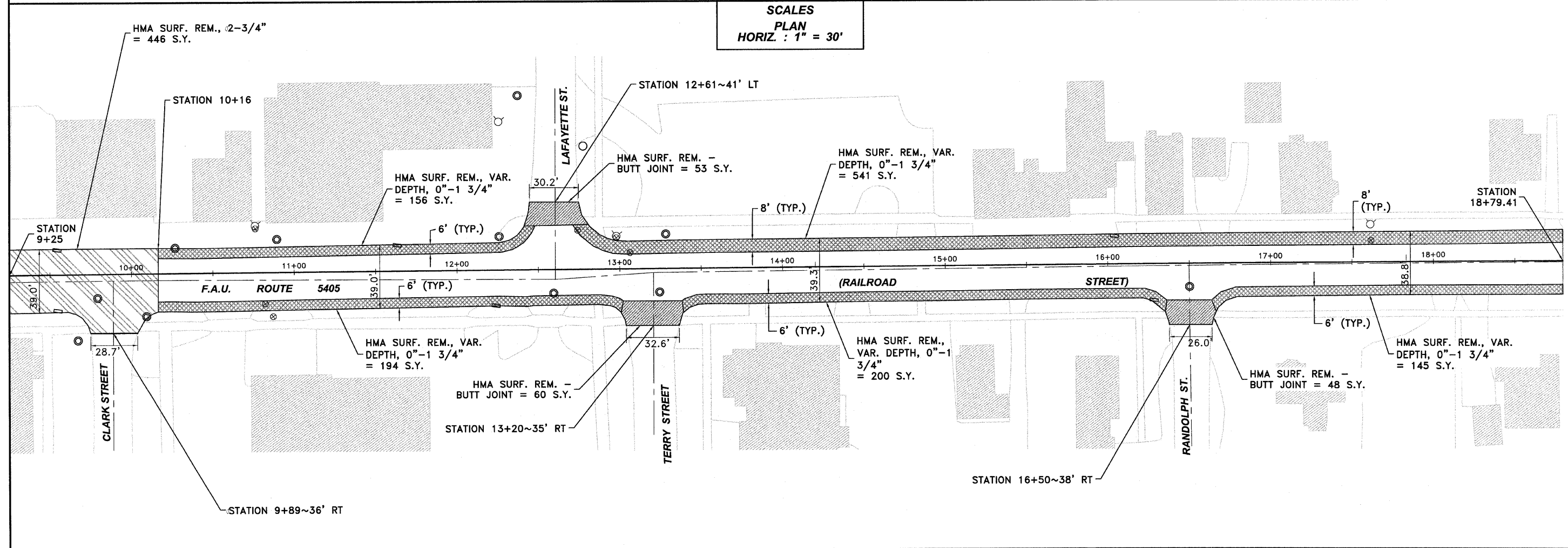
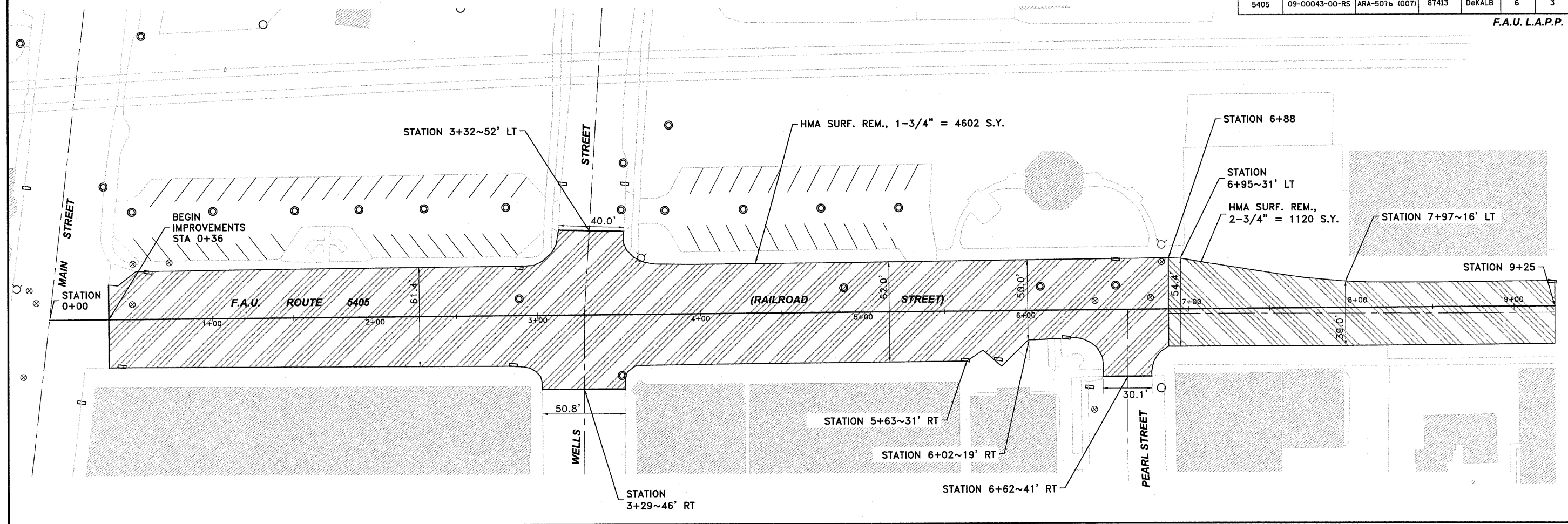

SCALES
PLAN
HORIZ. : 1" = 30'

1304 GEMINI CIRCLE
 OTTAWA, IL 61356-6092
 TEL: 815-454-9925
 FAX: 815-454-9925

E TSCHIED
D UTTLINGER
& ASSOCIATES INC.
 Professional Engineers & Land Surveyors

PROFESSIONAL DESIGN
 FIRM # 184-000711
 DATE PLOTTED:
 OCTOBER 17, 2009
 DRAWN BY:
 M.S.R.
 CHECKED BY:

PROJECT NUMBER:
 3227.04C
 DRAWING FILE:
 322704C_STREETPLAN
SHEET NO.
3 OF 6

HOT-MIX ASPHALT REMOVAL PLAN - RAILROAD STREET

F.A.U. ROUTE NO.	SECTION	ILLINOIS PROJECT	CONTRACT NO.	COUNTY	TOTAL SHEETS	SHEET NUMBER
5405	09-00043-00-RS	ARA-5076 (007)	87413	DeKALB	6	4

F.A.U. L.A.P.P.

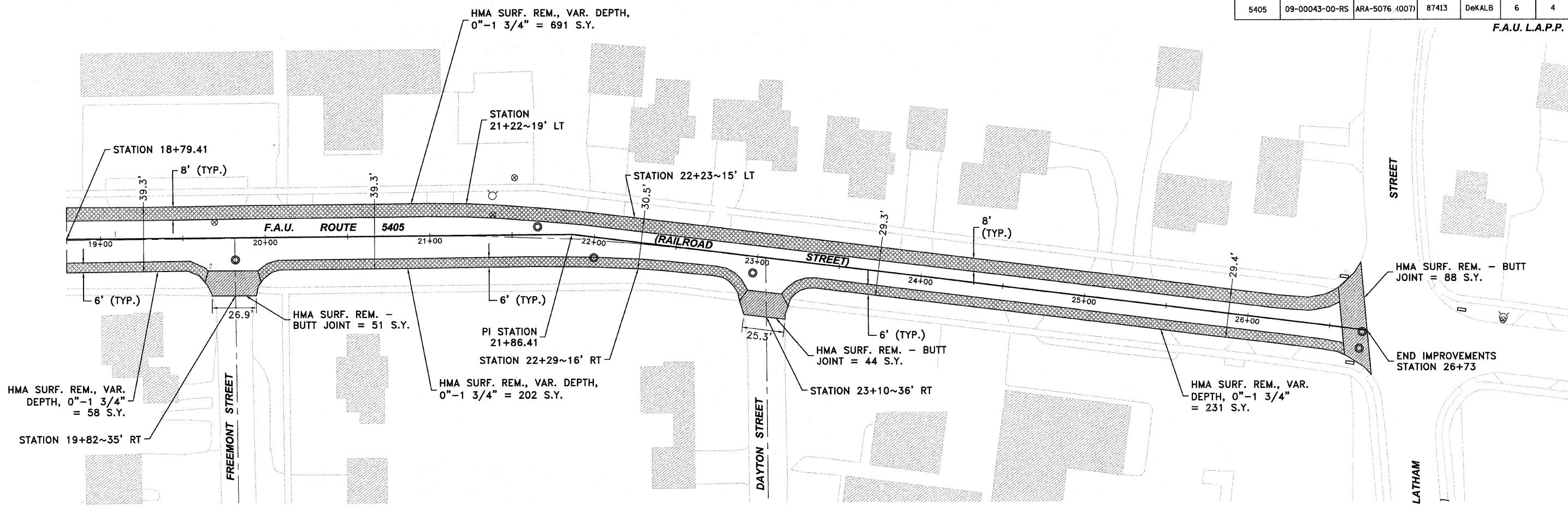

SCALES
PLAN
HORIZ : 1" = 30'

BUTT JOINT DETAIL
NOT TO SCALE

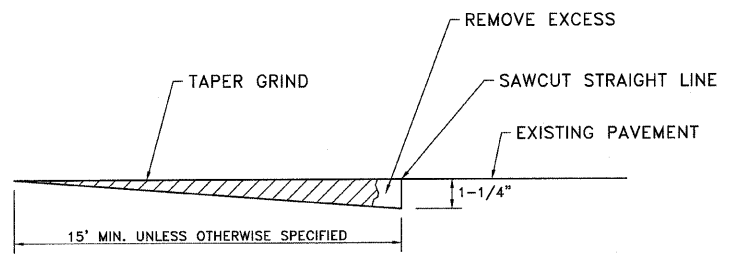

F.A.U. 5405 - RAILROAD STREET
SECTION 09-000-43-00-RS
CITY OF SANDWICH, DEKALB COUNTY

1304 GEMINI CIRCLE
OTAWA, IL 61350-1692
TEL: 815-464-3925
FAX: 815-464-3925

**E TSCHIED
DUTTLINGER
& ASSOCIATES**
Professional Engineers & Land Surveyors

PROFESSIONAL DESIGN
FIRM # 184-000711
DATE PLOTTED:
OCTOBER 17, 2009
DRAWN BY:
M.S.R.
CHECKED BY:

PROJECT NUMBER:
3227.04C
DRAWING FILE:
322704C_STREETPLAN
SHEET NO.
4 OF 6

F.A.U. ROUTE NO.	SECTION	ILLINOIS PROJECT	CONTRACT NO.	COUNTY	TOTAL SHEETS	SHEET NUMBER
5405	09-00043-00-RS	ARA-5076 (007)	87413	DeKALB	6	5

F.A.U. L.A.P.P.

F.A.U. 5405 - RAILROAD STREET
SECTION 09-000-43-00-RS
CITY OF SANDWICH, DEKALB COUNTY

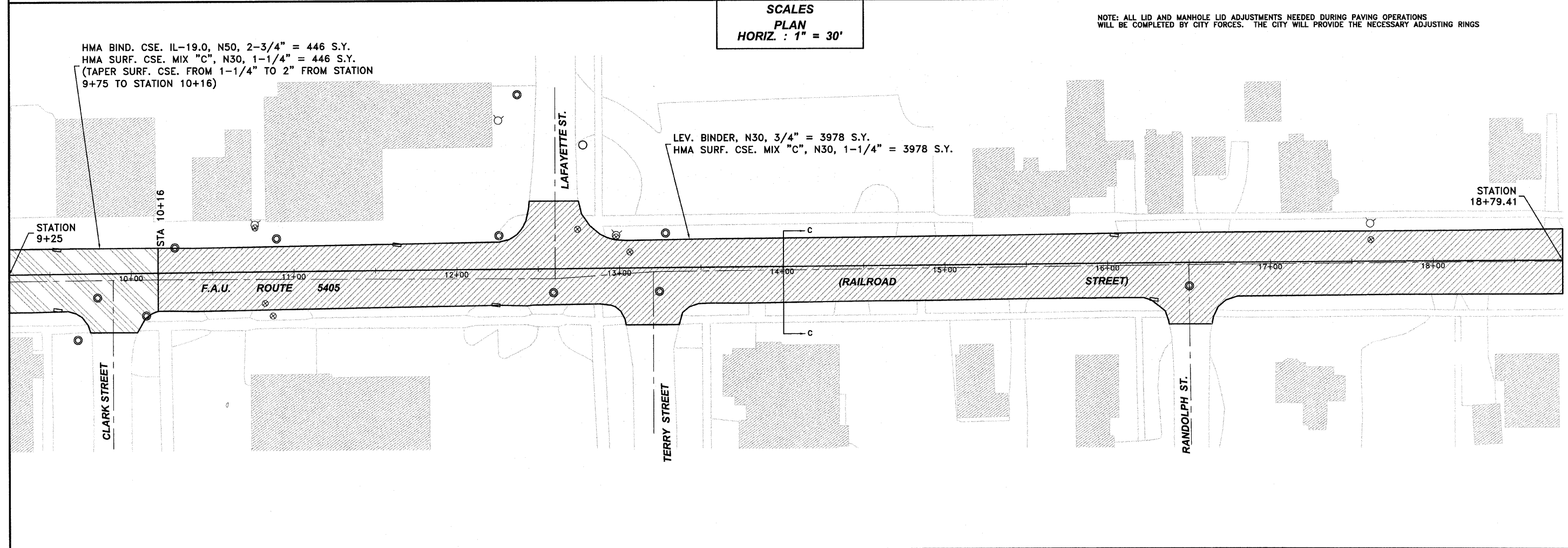
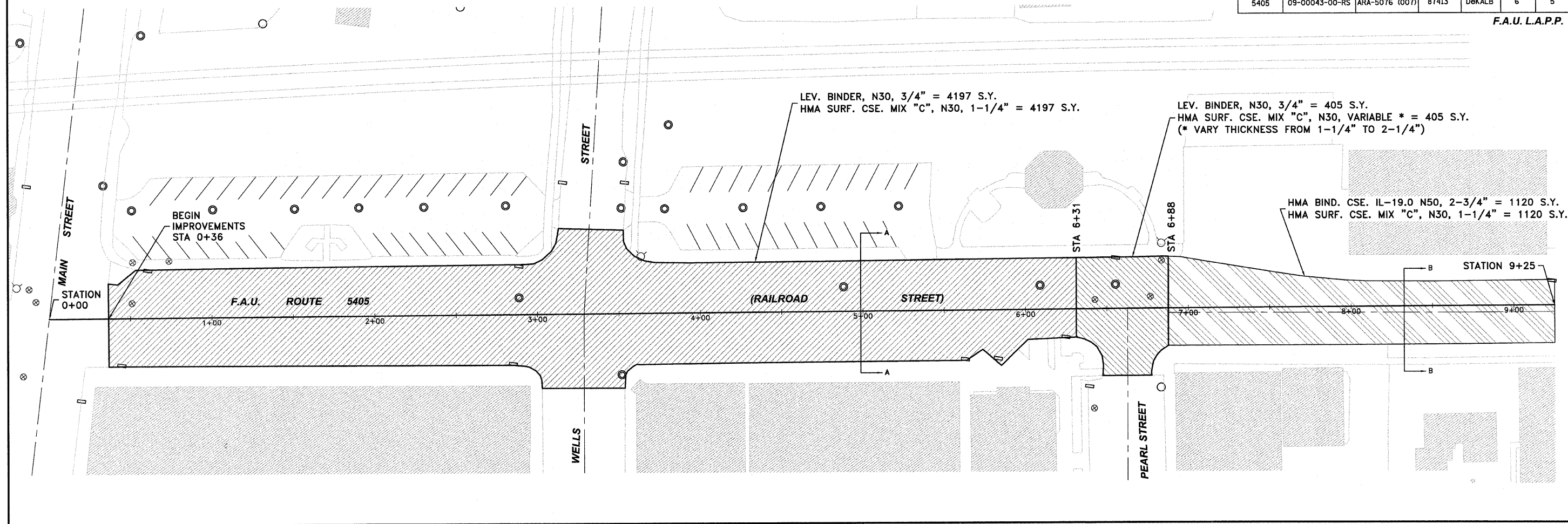

SCALES
PLAN
HORIZ. : 1" = 30'

NOTE: ALL LID AND MANHOLE LID ADJUSTMENTS NEEDED DURING PAVING OPERATIONS WILL BE COMPLETED BY CITY FORCES. THE CITY WILL PROVIDE THE NECESSARY ADJUSTING RINGS

1304 GEMINI CIRCLE
 OTTAWA, IL 61350-1692
 TEL: 815-464-9925
 FAX: 815-464-9925

Etscheid
Duttlinger & Associates Inc.
 Professional Engineers & Land Surveyors

PROFESSIONAL DESIGN FIRM # 184-000711
DATE PLOTTED: OCTOBER 17, 2009
DRAWN BY: M.S.R.
CHECKED BY:
PROJECT NUMBER: 3227.04C
DRAWING FILE: 322704C_STREETPLAN
SHEET NO.
5 OF 6

HOT-MIX ASPHALT RESURFACE PLAN - RAILROAD STREET

F.A.U. ROUTE NO.	SECTION	ILLINOIS PROJECT	CONTRACT NO.	COUNTY	TOTAL SHEETS	SHEET NUMBER
5405	09-00043-00-RS	ARA-5076 (007)	87413	DeKALB	6	6

F.A.U. L.A.P.P.

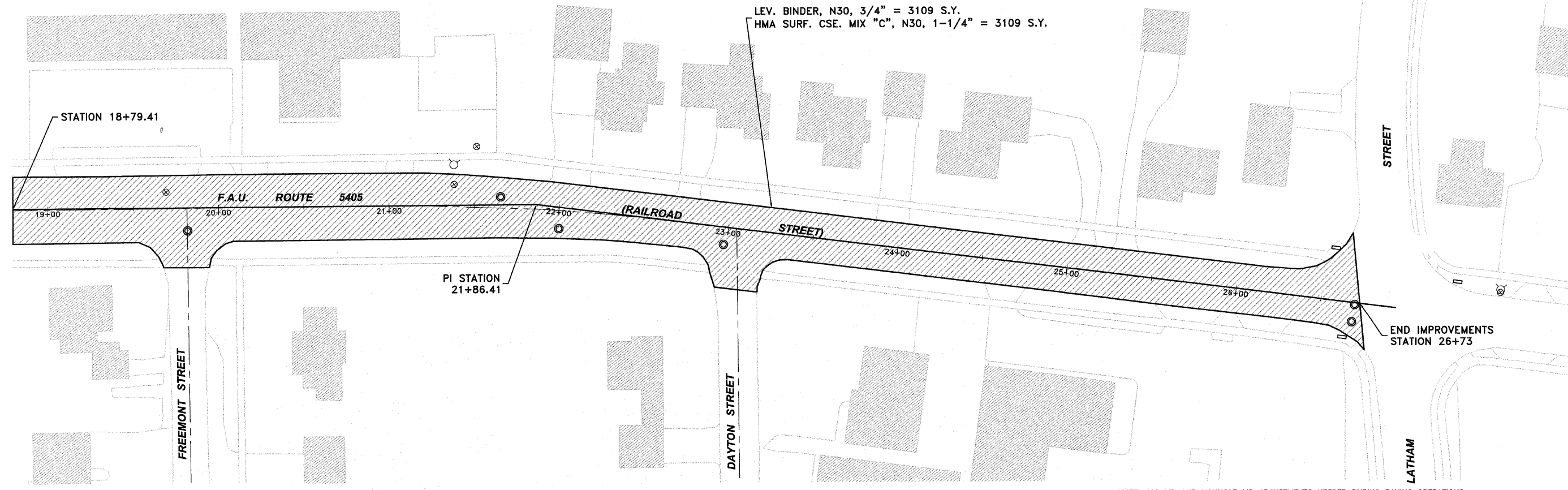

NOTE: ALL LID AND MANHOLE LID ADJUSTMENTS NEEDED DURING PAVING OPERATIONS WILL BE COMPLETED BY CITY FORCES. THE CITY WILL PROVIDE THE NECESSARY ADJUSTING RINGS

SCALES
PLAN
HORIZ. : 1" = 30'

F.A.U. 5405 - RAILROAD STREET
SECTION 09-000-43-00-RS
CITY OF SANDWICH, DEKALB COUNTY

134 GEMINI CIRCLE
OTTAWA, IL 61350-1092
TEL: 815-434-5925
FAX: 815-434-5935

**ETSCHHEID
& DUTTLINGER
& ASSOCIATES**
Professional Engineers & Land Surveyors

PROFESSIONAL DESIGN
FIRM # 184-000711
DATE PLOTTED:
OCTOBER 17, 2009
DRAWN BY:
M.S.R.
CHECKED BY:
PROJECT NUMBER:
3227.04C
DRAWING FILE:
322704C_STREETPLAN

SHEET NO.
6 OF 6

HOT-MIX ASPHALT RESURFACE PLAN - RAILROAD STREET