

LEGEND

- ☼-○-☼ PROPOSED ORNAMENTAL LIGHTING UNIT COMPLETE
- ☼-○-☼ EXISTING LIGHT
- EXISTING BURIED WIRING JUNCTION BOX
- EXISTING CATCH BASIN
- EXISTING UTILITY POLE
- EXISTING INLET
- EXISTING MANHOLE
- G EXISTING GAS
- W EXISTING WATER
- A B C DECORATIVE LIGHT TYPE A
DECORATIVE LIGHT TYPE B
DECORATIVE LIGHT TYPE C
- T EXISTING TELEPHONE
- E EXISTING ELECTRICAL
- G EXISTING GAS
- OE EXISTING OVERHEAD ELECTRICAL
- EXISTING R.O.W.
- - - EXISTING PIPE CULVERT
- - - EXISTING STORMSEWER
- - - EXISTING SANITARY SEWER

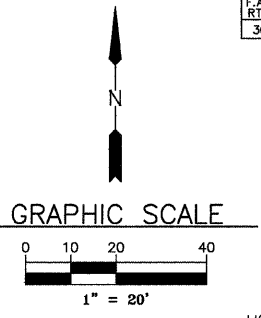

LIGHT NO. 14
(EXISTING)
STA. 125+96
23' LT.

LIGHT NO. 15
(PROPOSED)
STA. 127+55
24' LT.

LIGHTING CONTROL PANEL NO. 2
CONTROLS LIGHTS 12-16, 17-21,
49-53 AND 54-58

LIGHT NO. 16
(EXISTING)
STA. 129+13
24' LT.

LIGHT NO. 17
(EXISTING)
STA. 130+71
24' LT.

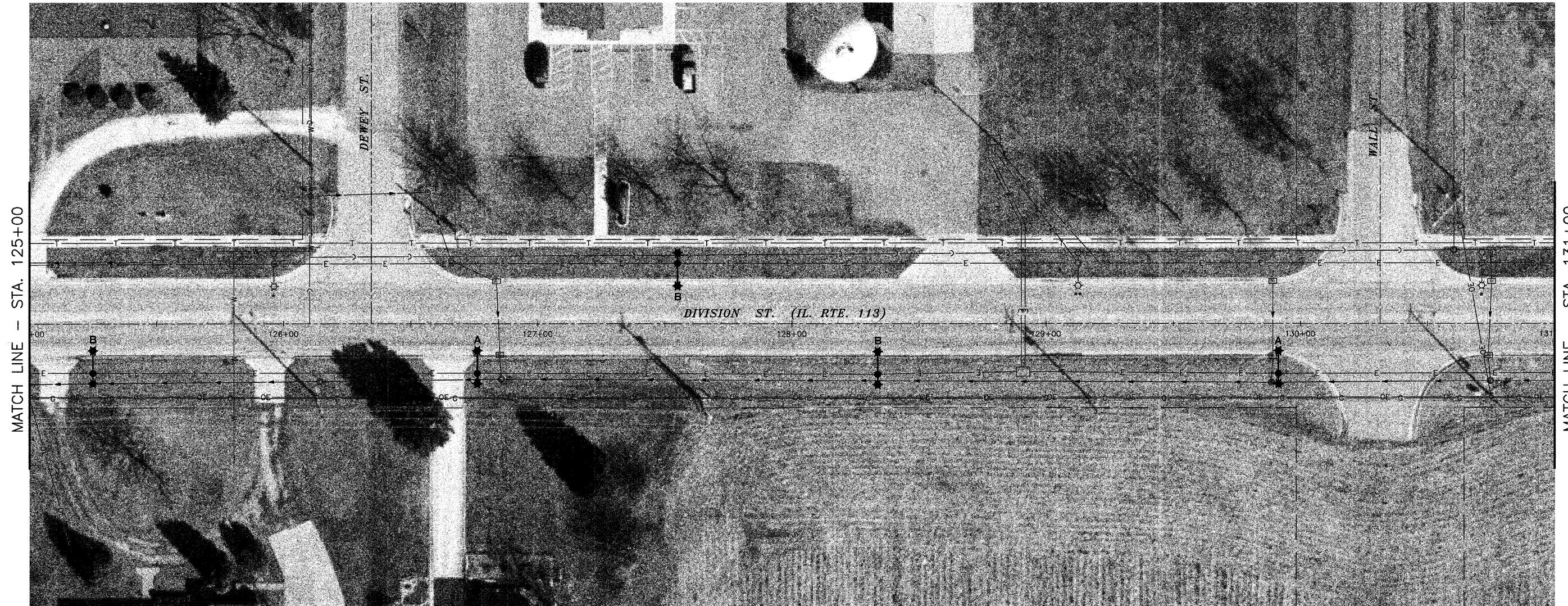

MATCH LINE - STA. 125+00

MATCH LINE - STA. 131+00

LIGHT NO. 51
(PROPOSED)
STA. 125+25
19' RT.

LIGHT NO. 52
(PROPOSED)
STA. 126+76
19' RT.

LIGHT NO. 53
(PROPOSED)
STA. 128+34
20' RT.

LIGHT NO. 54
(PROPOSED)
STA. 129+91
20' RT.

NOTE: AERIAL PHOTOGRAPHS SUPPLIED BY THE SIDWELL COMPANY

DRAWN BY: RGP/JMT	6978-00 CAD/DWG: P125-131 BASE	REVISIONS	
		DATE	BY
CHECKED BY: MWP/DJD	DATE: 09-24-09		

CHAMLIN ASSOCIATES
PERU MORRIS
ILLINOIS

**VILLAGE OF DIAMOND
DIVISION STREET LIGHTING IMPROVEMENTS - 2010**

PLAN SHEET - STA. 125+00 TO STA. 131+00

SCALE: AS NOTED	SHEET 7
FILE NO.: 6978-00	OF 12