

LEGEND

- | | |
|---|--|
| <ul style="list-style-type: none"> ☼-○-☼ PROPOSED ORNAMENTAL LIGHTING UNIT COMPLETE ☼-○-☼ EXISTING LIGHT □ EXISTING BURIED WIRING JUNCTION BOX ○ EXISTING CATCH BASIN ○ EXISTING UTILITY POLE ○ EXISTING INLET ○ EXISTING MANHOLE —G— EXISTING GAS —W— EXISTING WATER A DECORATIVE LIGHT TYPE A B DECORATIVE LIGHT TYPE B C DECORATIVE LIGHT TYPE C | <ul style="list-style-type: none"> —T— EXISTING TELEPHONE —E— EXISTING ELECTRICAL —G— EXISTING GAS —OE— EXISTING OVERHEAD ELECTRICAL — EXISTING R.O.W. --- EXISTING PIPE CULVERT — EXISTING STORMSEWER — EXISTING SANITARY SEWER |
|---|--|
- * REMOVAL OF LUMINAIRE, SALVAGE & LUMINAIRE, HIGH PRESSURE SODIUM SPECIAL (310 WATT)

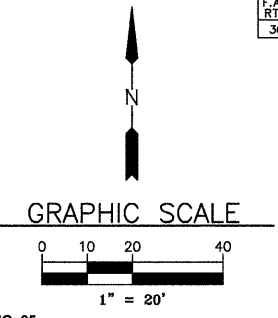

LIGHT NO. 22
(PROPOSED)
STA. 137+59
24' LT.

LIGHT NO. 23
(PROPOSED)
STA. 139+12
23' LT.

LIGHT NO. 24
(EXISTING)
STA. 140+68
22' LT.

LIGHT NO. 25
(PROPOSED)
STA. 141+99
23' LT.

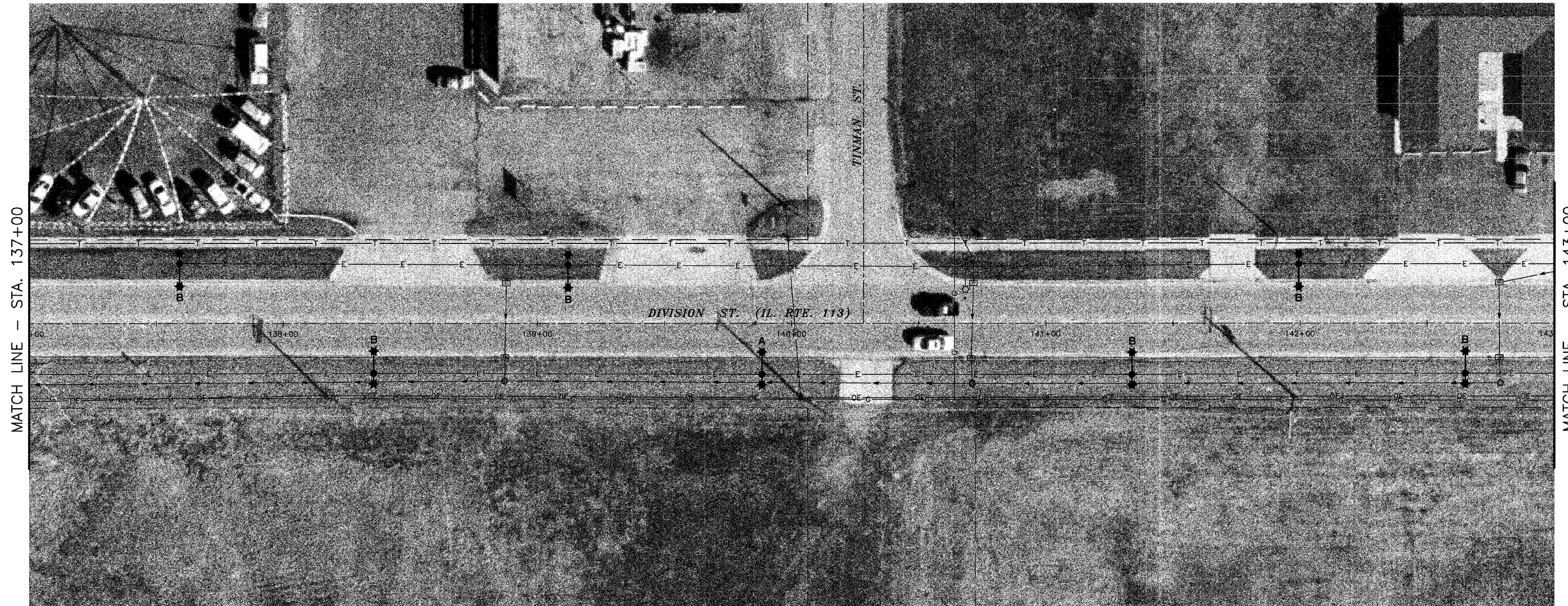

MATCH LINE - STA. 137+00

MATCH LINE - STA. 143+00

LIGHT NO. 60
(PROPOSED)
STA. 138+36
20' RT.

LIGHT NO. 61
(PROPOSED)
STA. 139+88
20' RT.

LIGHT NO. 62
(PROPOSED)
STA. 141+34
20' RT.

LIGHT NO. 63
(PROPOSED)
STA. 142+65
20' RT.

NOTE: AERIAL PHOTOGRAPHS SUPPLIED BY THE SIDWELL COMPANY

DRAWN BY: RGP/JMT
CHECKED BY: MWP/DJD

6978-00
CAD/DWG: P137-143
BASE
DATE: 09-24-09

REVISIONS	
DATE	BY



PERU MORRIS
ILLINOIS

VILLAGE OF DIAMOND
DIVISION STREET LIGHTING IMPROVEMENTS - 2010

PLAN SHEET - STA. 137+00 TO STA. 143+00

SCALE: AS NOTED
FILE NO.: 6978-00

SHEET 9
OF 12