

F.A.P. RTE.	SECTION	COUNTY	TOTAL SHEETS	SHEET NO.
717	110BR	DEWITT	40	12
STA. 736+00		TO STA. 741+00		
FED. ROAD DIST. NO. 5		ILLINOIS FED. AID PROJECT		
SHEET 5 OF 14 SHEETS				

CONTRACT NO. 90932

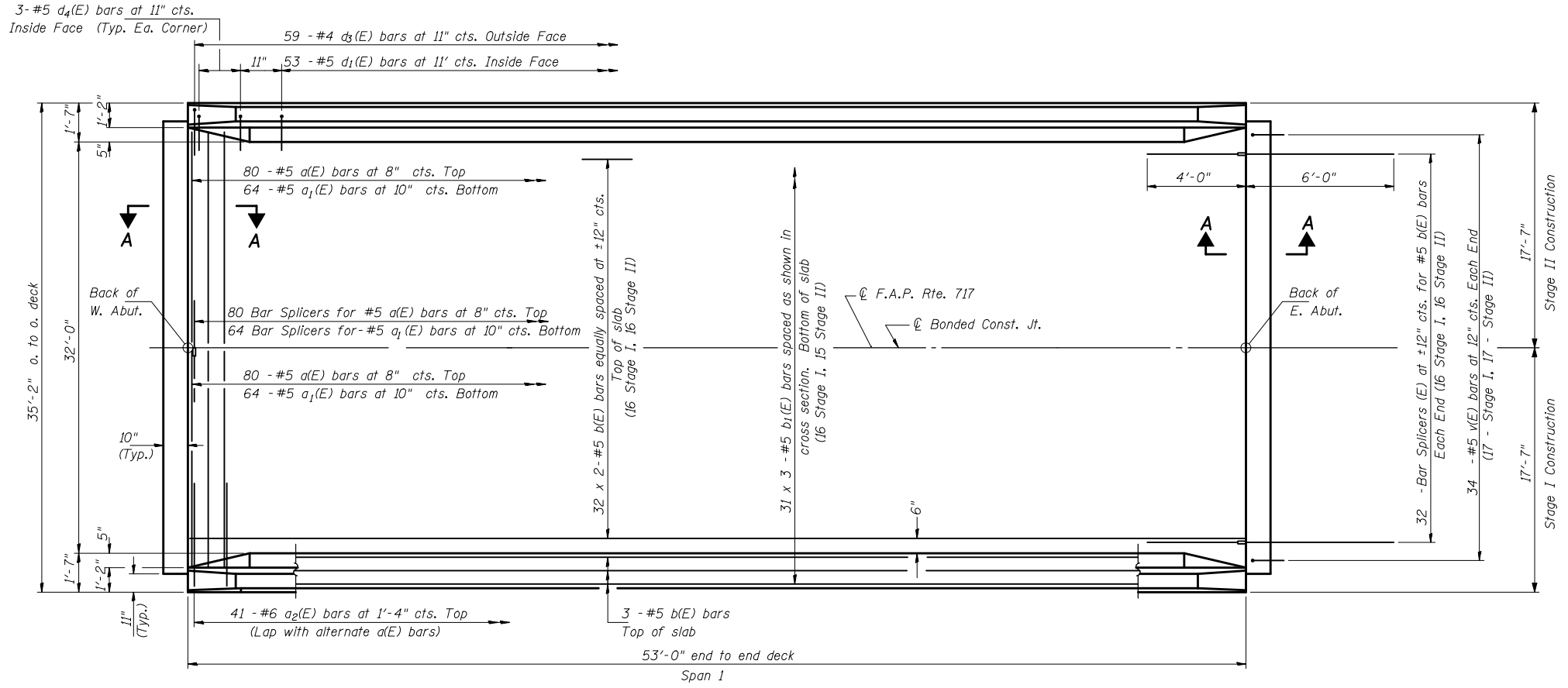

PLAN

- Notes:
1. See Sheet # 6 of 14 for Superstructure Details, Parapet Reinforcement, Section A-A, Bill of Material and Sections at Abutments.
 2. Bars indicated thus 31X3-#5 etc, indicates 31 lines of bars with 3 lengths per line.
 3. See sheet 11 of 14 for Bar Splicer Details.

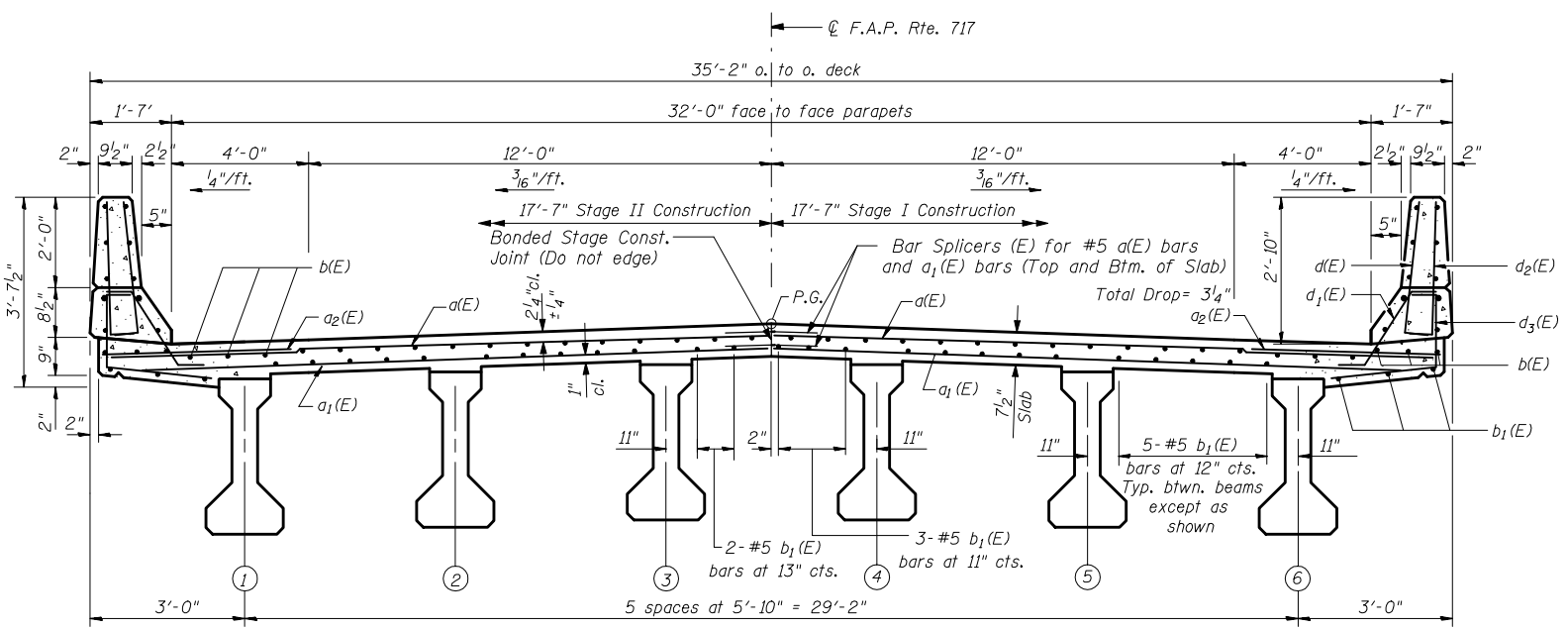

CROSS SECTION
(Looking Upstation)

MIN. BAR LAP
#5 Bar = 1'-8"

REVISIONS	
NAME	DATE

ILLINOIS DEPARTMENT OF TRANSPORTATION
DECK DETAILS
 IL. ROUTE 10 OVER UN-NAMED CREEK
 FAP RTE. 717 SECTION 110BR
 STA. 738+60
 DEWITT COUNTY STR. No. 020-0061
 SCALE: N.T.S. DRAWN BY
 DATE: MAY 2009 CHECKED BY: MJS

TUG PROJ. # 09010003
 PLOT DATE = 10/15/2009 4:15PM
 FILE NAME = 09FILE9