



STA 23+68.21 BK. BROADWAY STREET =
STA 400+00.00 WASHINGTON STREET

STA 23+68.21 AHD. BROADWAY STREET =
STA 400+06.21 WASHINGTON STREET

MATCH LINE STA 20+50

MATCH LINE STA 26+00

LEGEND

- PERIMETER EROSION CONTROL BARRIER
- INLET & PIPE PROTECTION
- PROPOSED DRAINAGE ARROW

NOTE:
SEE SECTIONS 250 AND 251 OF THE ILLINOIS DEPARTMENT OF TRANSPORTATION STANDARD SPECIFICATIONS FOR ROAD AND BRIDGE CONSTRUCTION, JANUARY 1, 2007, STORM WATER POLLUTION PREVENTION PLAN, AND PROVISIONS OF THE NPDES PERMIT NUMBER ILR10 FOR TEMPORARY AND PERMANENT SEEDING, DUST CONTROL AND CLEANING OF PAVEMENT AS NECESSARY.

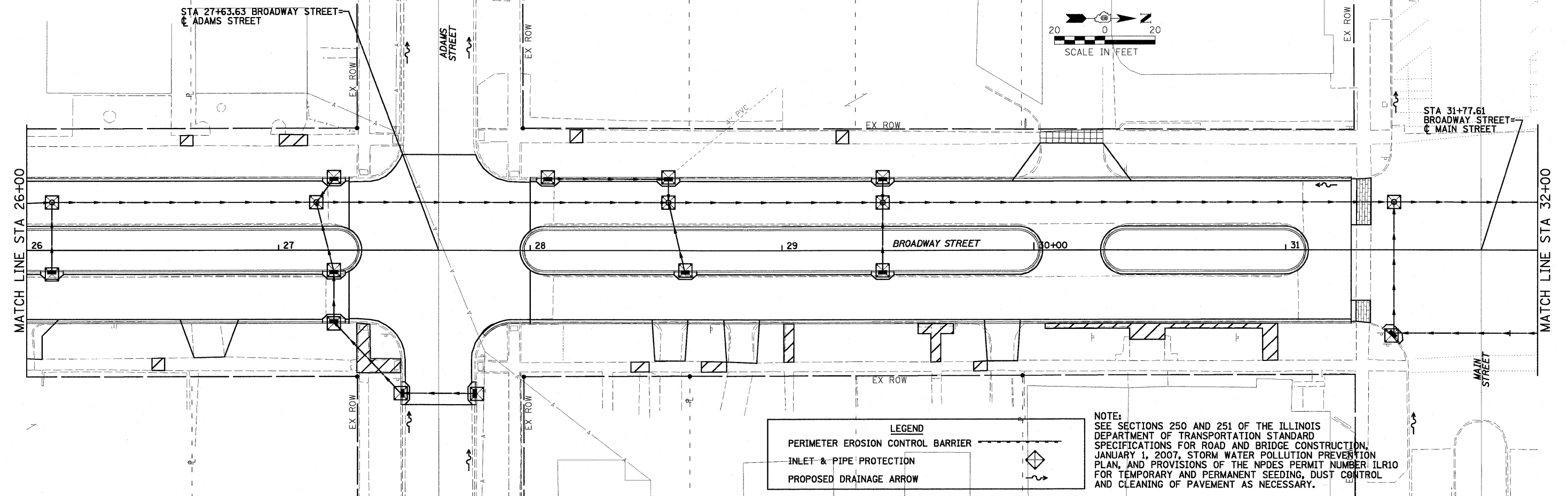

STA 27+63.63 BROADWAY STREET =
C ADAMS STREET

STA 31+77.61 BROADWAY STREET =
C MAIN STREET

MATCH LINE STA 26+00

MATCH LINE STA 32+00

LEGEND

- PERIMETER EROSION CONTROL BARRIER
- INLET & PIPE PROTECTION
- PROPOSED DRAINAGE ARROW

NOTE:
SEE SECTIONS 250 AND 251 OF THE ILLINOIS DEPARTMENT OF TRANSPORTATION STANDARD SPECIFICATIONS FOR ROAD AND BRIDGE CONSTRUCTION, JANUARY 1, 2007, STORM WATER POLLUTION PREVENTION PLAN, AND PROVISIONS OF THE NPDES PERMIT NUMBER ILR10 FOR TEMPORARY AND PERMANENT SEEDING, DUST CONTROL AND CLEANING OF PAVEMENT AS NECESSARY.

0081364.EROSION1.dgn 10/16/09 AM 9:25:00 0081364.10/16/09 10:46:01 AM

FILE NAME = 0081364.EROSION1.dgn	USER NAME =	DESIGNED - PSA	REVISED -	STATE OF ILLINOIS DEPARTMENT OF TRANSPORTATION	CITY OF HAVANA - BROADWAY STREET EROSION CONTROL PLAN "SWPPP"	F.A. RTE.	SECTION	COUNTY	TOTAL SHEETS	SHEET NO.
		DRAWN - JTC	REVISED -			05-00035-00-SS	MASON	60	26	
PLOT SCALE =		CHECKED - ERB/RDY	REVISED -			CONTRACT NO 9 3 5 0 2				
PLOT DATE = 9/28/2009 10:46:01 AM		DATE - 09/29/09	REVISED -			FED. ROAD DIST. NO.	ILLINOIS FED. AID PROJECT			
				SCALE: 1" = 20'		SHEET NO. OF SHEETS		STA. 20+50 TO STA. 32+00		