

FINAL SURVEY	SURVEYED	BY	DATE
NOTE BOOK	PLOTTED		
AREAS CHECKED	TEMPLATE		
NO.	AREAS CHECKED		

ORIGINAL SURVEY	SURVEYED	BY	DATE
NOTE BOOK	PLOTTED		
AREAS CHECKED	TEMPLATE		
NO.	AREAS CHECKED		

0081364\_XSECT-STH.dgn 10:46:19 AM  
 9/29/2009  
 17/2009/0081364\_XSECT-STH.dgn

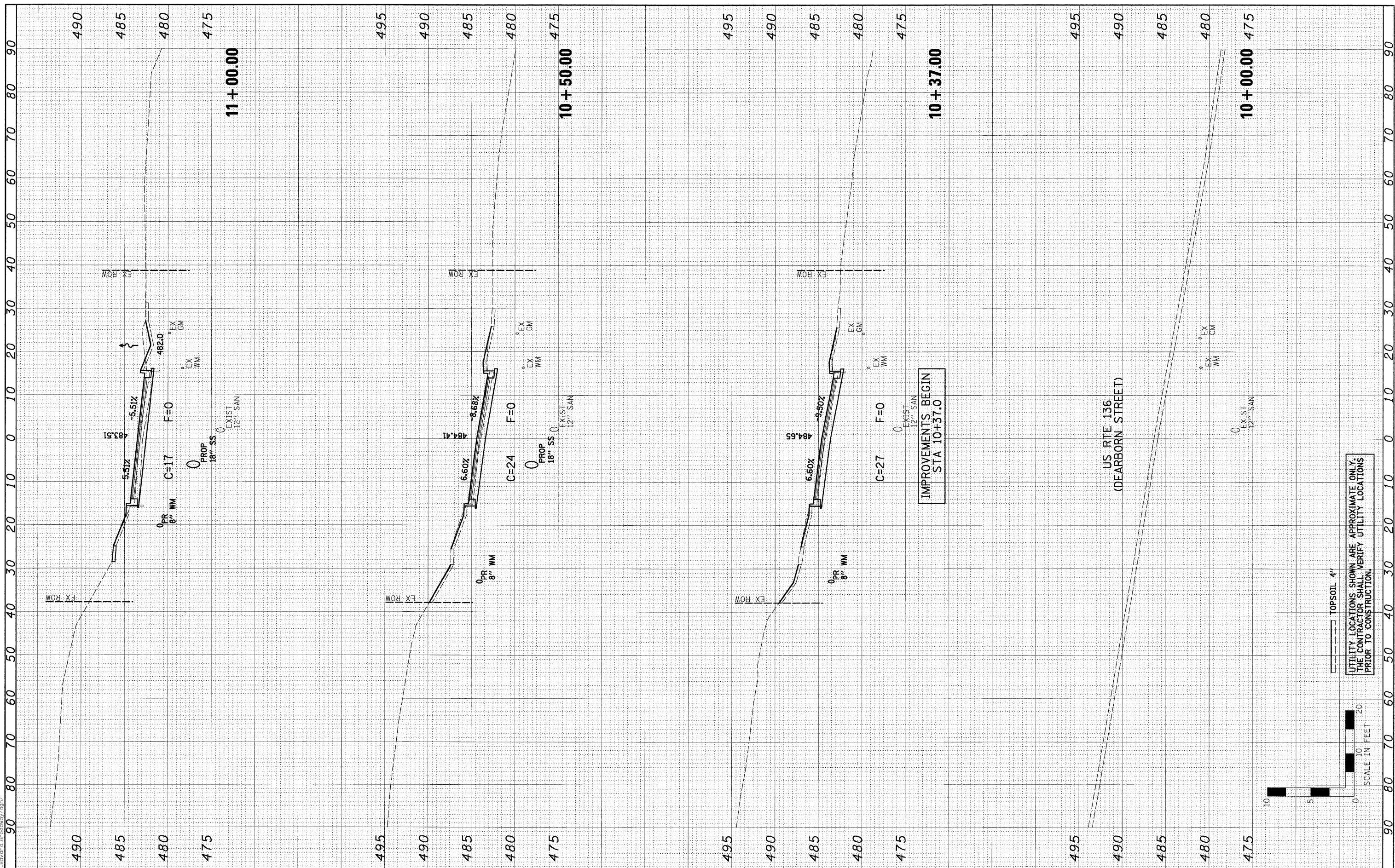

FILE NAME =	0081364_XSECT-STH.dgn
USER NAME =	
PLOT SCALE =	
PLOT DATE =	9/26/2009 10:46:19 AM

DESIGNED -	PSA	REVISED -	
DRAWN -	JTC	REVISED -	
CHECKED -	ERB/RDY	REVISED -	
DATE -	09/29/09	REVISED -	

DESIGNED -	PSA	REVISED -	
DRAWN -	JTC	REVISED -	
CHECKED -	ERB/RDY	REVISED -	
DATE -	09/29/09	REVISED -	

**STATE OF ILLINOIS  
 DEPARTMENT OF TRANSPORTATION**

<b>CITY OF HAVANA - BROADWAY STREET CROSS SECTIONS</b>			
SCALE: H=10, V=5	SHEET NO.	OF SHEETS	STA. 10+00.00 TO STA. 11+00.00

F.A. RTE.	SECTION	COUNTY	TOTAL SHEETS	SHEET NO.
	05-00035-00-SS	MASON	60	35
FED. ROAD DIST. NO. (ILLINOIS) FED. AID PROJECT				

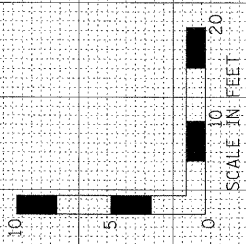

UTILITY LOCATIONS SHOWN ARE APPROXIMATE ONLY.  
 THE CONTRACTOR SHALL VERIFY UTILITY LOCATIONS  
 PRIOR TO CONSTRUCTION.