

F.A.S. RTE.	SECTION	COUNTY	TOTAL SHEETS	SHEET NO.
748	06-00053-00-RS	JERSEY	110	12
STA. NA	TO STA. NA			
CONTRACT # 97375	FAP NO. RS-0748(109)			

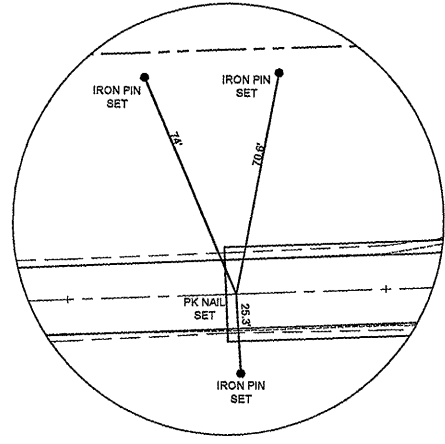

CONTROL POINT #1
DELHI ROAD
STA = 157+50
PC STA = 157+53.02

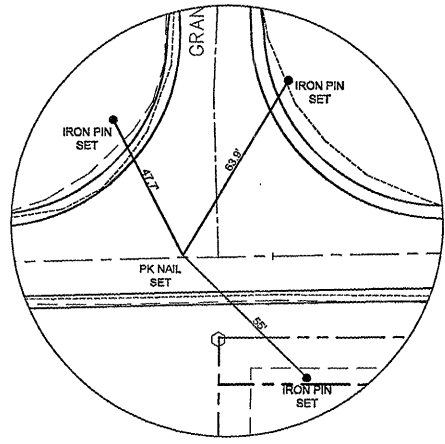

CONTROL POINT #2
GRANGE HALL ROAD
STA 158+71.93

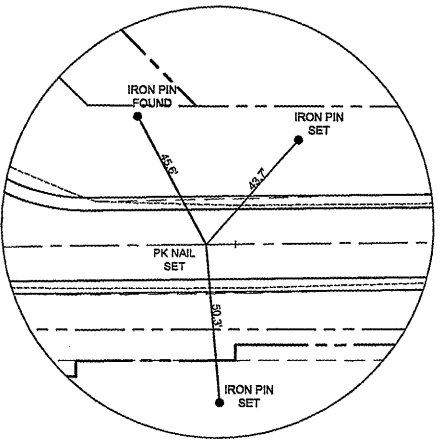

CONTROL POINT #3
DELHI ROAD
PT STA = 159+90.82

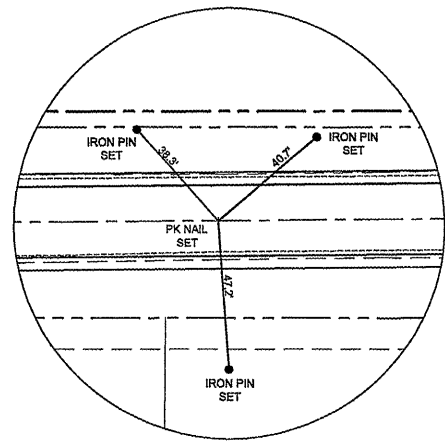

CONTROL POINT #4
DELHI ROAD
STA = 165+00

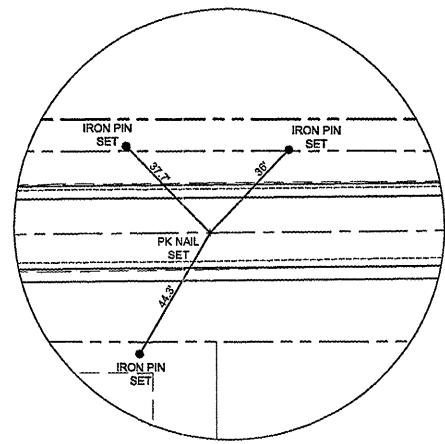

CONTROL POINT #5
DELHI ROAD
STA = 170+00

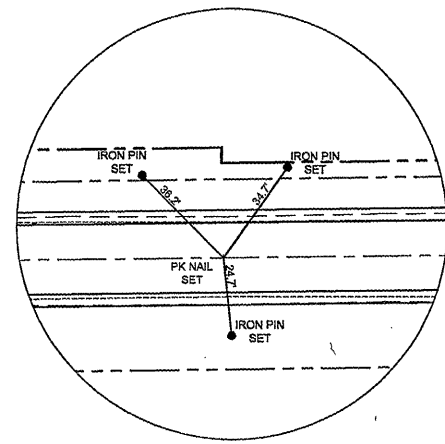

CONTROL POINT #6
DELHI ROAD
STA = 175+00

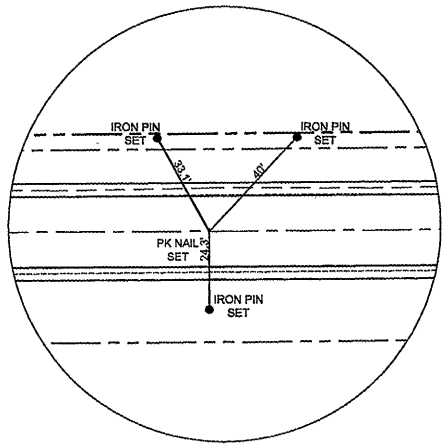

CONTROL POINT #7
DELHI ROAD
STA = 180+00

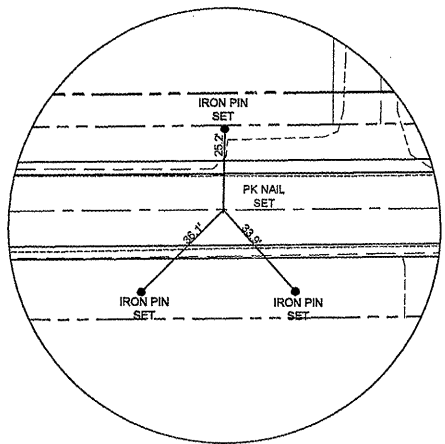

CONTROL POINT #8
DELHI ROAD
STA = 185+00

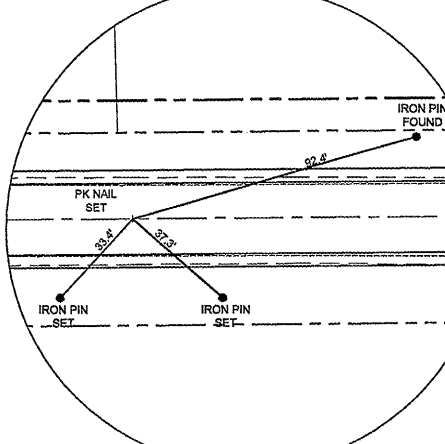

CONTROL POINT #9
DELHI ROAD
STA = 190+00

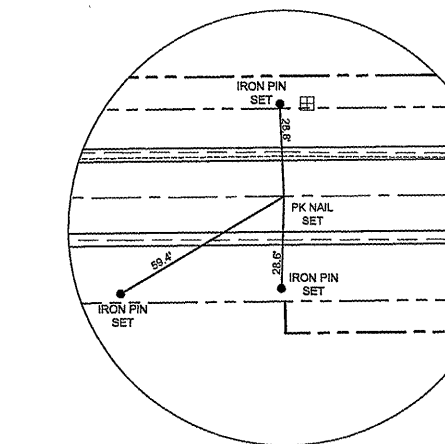

CONTROL POINT #10
DELHI ROAD
STA = 195+00

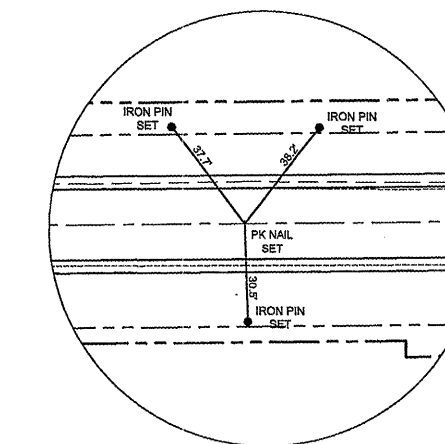

CONTROL POINT #11
DELHI ROAD
STA = 200+00

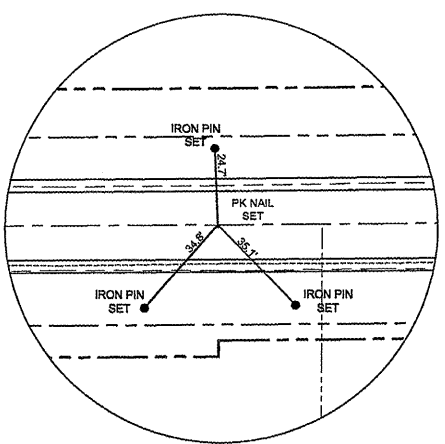

CONTROL POINT #12
DELHI ROAD
STA = 205+00

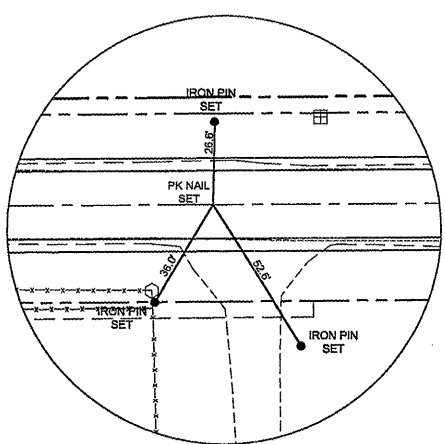

CONTROL POINT #13
DELHI ROAD
PC STA = 209+88.91

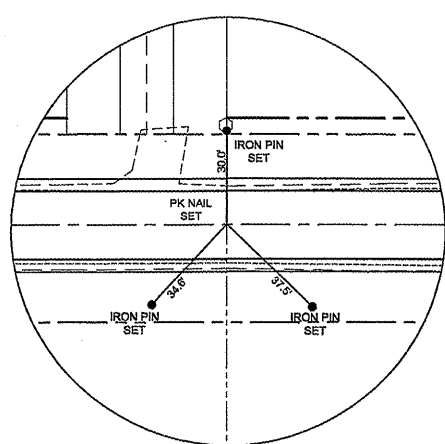

CONTROL POINT #14
DELHI ROAD
PI STA = 211+88.84

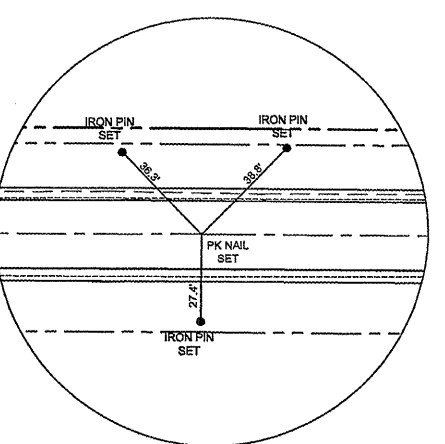

CONTROL POINT #15
DELHI ROAD
PT STA = 214+28.76

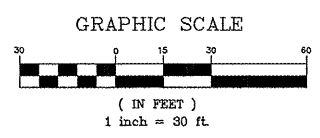

REVISIONS	DATE

ILLINOIS DEPARTMENT OF TRANSPORTATION

REFERENCE TIES

DELHI ROAD
F.A.S. ROUTE 748
SECTION 06-00053-00-RS
JERSEY COUNTY