

| | | | | |
|-----------------|----------------|--------------------------|--------------|-----------|
| F.A.S. RTE. | SECTION | COUNTY | TOTAL SHEETS | SHEET NO. |
| 748 | 06-00053-00 RS | JERSEY | 110 | 35 |
| STA. 186+00 | | TO STA. 216+00 | | |
| CONTRACT #97375 | | PROJECT NO. RS-0748(109) | | |

LEGEND

- ☒ PROPOSED PRE. CAST CONCRETE RIGHT OF WAY MARKER
- ⊙ PROPOSED PERMANENT SURVEY MARKER

MATCH LINE STA. 186+00

MATCH LINE STA. 201+00

n/f
MARK MCKEE
(Bk. 1386, Pg. 169)

n/f
MATHEW SCOTT & LAURA D. ALLEN
(Bk. 1251, Pg. 233)

n/f
VINCENT A. GOSS
(Bk. 922, Pg. 1)

n/f
VINCENT A. GOSS & LINDA S. GOSS
(Bk. 1388, Pg. 97)

n/f
OERTEL LAND TRUST 2001
L. FRANK OERTEL & JASON L. OERTEL, TRUSTEES
(Bk. 865, Pg. 330)

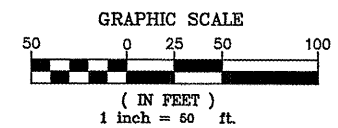
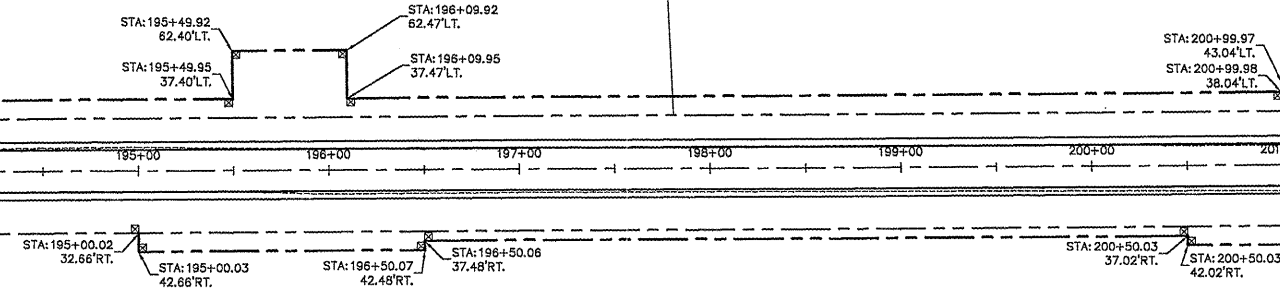

MATCH LINE STA. 201+00

MATCH LINE STA. 216+00

n/f
DAVID R. GOSS & PATRICIA GOSS
(Bk. 1425, Pg. 104)

n/f
CHARLES E. HUEBENER & WILLIAM F. HUEBENER
(Bk. 1521, Pg. 220)

n/f
OERTEL FAMILY REVOCABLE LIVING TRUST
LELAND W. & DOROTHY JUNE OERTEL, TRUSTEES
(Bk. 817, Pg. 271)

n/f
OERTEL LAND TRUST 2001
L. FRANK OERTEL & JASON L. OERTEL, TRUSTEES
(Bk. 865, Pg. 330)

n/f
MARTIN F. HUEBENER LAND TRUST
MARTIN F. HUEBENER, TRUSTEE
(Bk. 1062, Pg. 29)
AND
BERNARDINE C. HUEBENER LAND TRUST
BERNARDINE C. HUEBENER, TRUSTEE
(Bk. 1062, Pg. 25)

n/f
MARTIN F. HUEBENER LAND TRUST
MARTIN F. HUEBENER, TRUSTEE
(Bk. 1062, Pg. 29)
AND
BERNARDINE C. HUEBENER LAND TRUST
BERNARDINE C. HUEBENER, TRUSTEE
(Bk. 1062, Pg. 25)

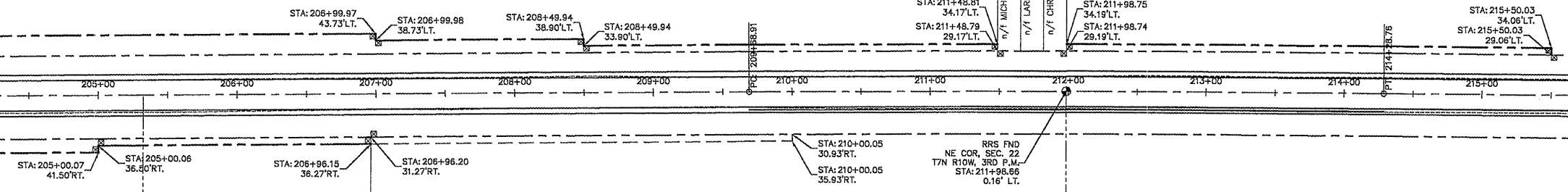

RRS FND
NE COR, SEC. 22
77N ROW, 3RD P.M.
STA:211+98.66
0.16' LT.

NOTE: STATION AND OFFSET CALLOUTS SHOWN ON THE PLANS ARE TO THE BREAKS IN RIGHT OF WAY. 3" IRON PINS ARE SET AT THESE LOCATIONS. CONTRACTORS SHALL USE EXTREME CAUTION WHEN SETTING THE RIGHT OF WAY MONUMENTS TO NOT DISTURB THE IRON PINS. ANY IRON PIN DAMAGED BY THE CONTRACTORS WORK SHALL BE RE-SET BY A PROFESSIONAL LAND SURVEYOR IN THE STATE OF ILLINOIS. ALL COSTS TO RE-SET ANY DAMAGED PINS SHALL BE BORNE BY THE CONTRACTOR.

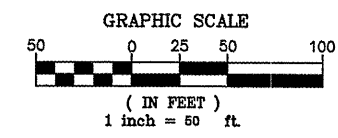

| REVISIONS | DATE |
|-----------|------|
| | |
| | |
| | |
| | |
| | |
| | |
| | |
| | |
| | |
| | |

ILLINOIS DEPARTMENT OF TRANSPORTATION

RIGHT OF WAY

DELHI ROAD
F.A.S. ROUTE 748
SECTION 06-00053-00-RS
JERSEY COUNTY