

NOTES:

1. EXISTING DETECTOR LOOPS & GULFBOX JUNCTIONS TO REMAIN IN PLACE UNLESS OTHERWISE INDICATED.
2. EXISTING SIGN PANELS ATTACHED TO MAST ARMS TO BE RELOCATED SHALL REMAIN IN PLACE.
3. REFER TO THE SPECIAL PROVISIONS SHEET FOR A LIST OF ITEMS TO BE INCLUDED IN THE COST FOR THE PAY ITEM REMOVAL OF EXISTING TRAFFIC SIGNAL EQUIPMENT.
4. REPLACE EXISTING YELLOW ARROW AND GREEN ARROW LENSES WITH YELLOW AND GREEN LENSES (NO ARROW). WORK, MATERIALS AND EQUIPMENT TO BE INCLUDED IN PRICE OF RELOCATE EXISTING SIGNAL HEAD.
5. QUANTITY OF CONCRETE MEDIAN SURFACE REMOVAL AND CONCRETE MEDIAN SURFACE, 4 INCH PROVIDED FOR WORK IN THE MEDIANS.

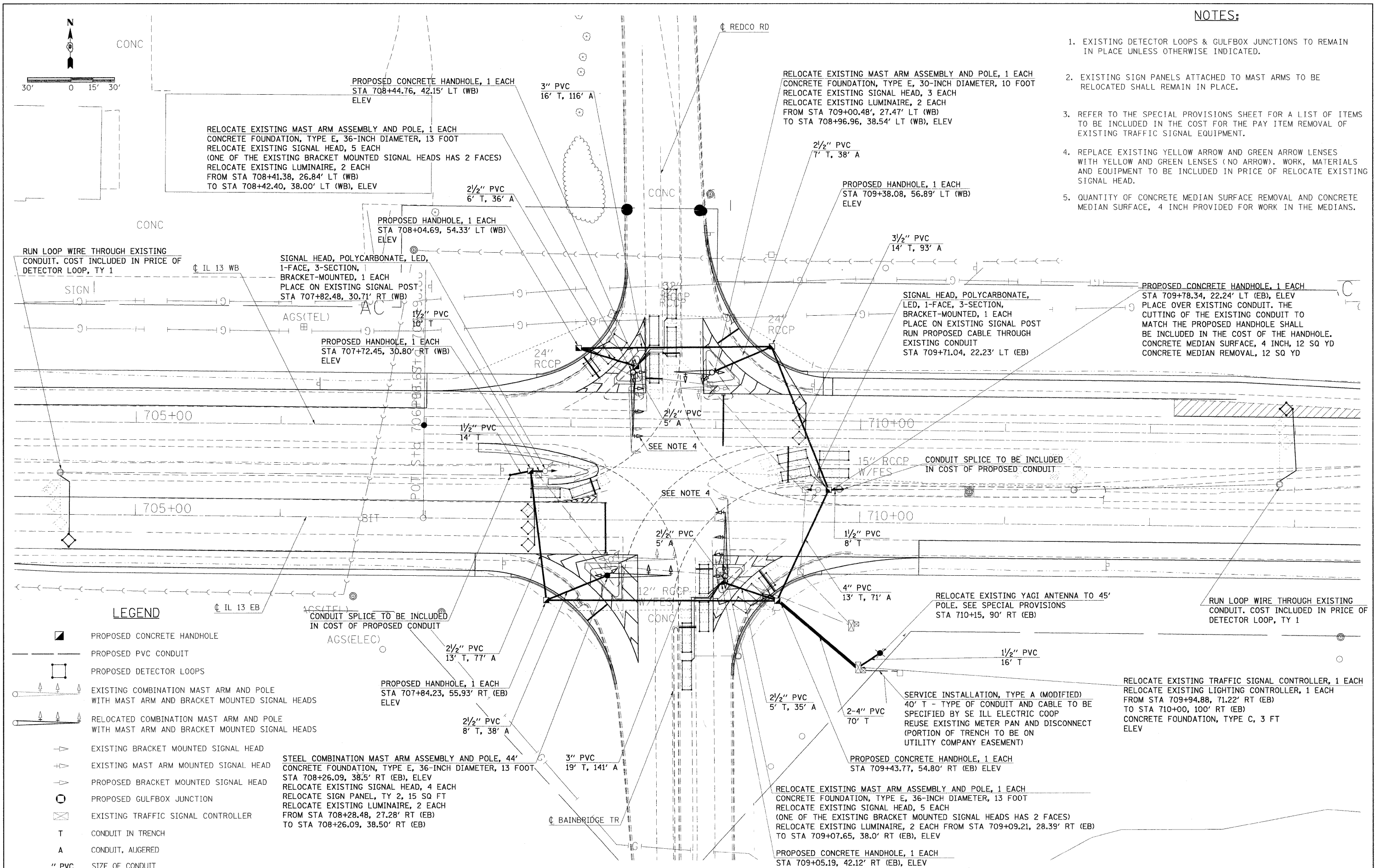

RUN LOOP WIRE THROUGH EXISTING CONDUIT. COST INCLUDED IN PRICE OF DETECTOR LOOP, TY 1

RELOCATE EXISTING MAST ARM ASSEMBLY AND POLE, 1 EACH CONCRETE FOUNDATION, TYPE E, 36-INCH DIAMETER, 13 FOOT
RELOCATE EXISTING SIGNAL HEAD, 5 EACH (ONE OF THE EXISTING BRACKET MOUNTED SIGNAL HEADS HAS 2 FACES)
RELOCATE EXISTING LUMINAIRE, 2 EACH FROM STA 708+41.38, 26.84' LT (WB) TO STA 708+42.40, 38.00' LT (WB), ELEV

RELOCATE EXISTING MAST ARM ASSEMBLY AND POLE, 1 EACH CONCRETE FOUNDATION, TYPE E, 30-INCH DIAMETER, 10 FOOT
RELOCATE EXISTING SIGNAL HEAD, 3 EACH
RELOCATE EXISTING LUMINAIRE, 2 EACH FROM STA 709+00.48', 27.47' LT (WB) TO STA 708+96.96, 38.54' LT (WB), ELEV

SIGNAL HEAD, POLYCARBONATE, LED, 1-FACE, 3-SECTION, BRACKET-MOUNTED, 1 EACH
PLACE ON EXISTING SIGNAL POST
STA 709+71.04, 22.23' LT (EB)

PROPOSED CONCRETE HANDHOLE, 1 EACH STA 709+78.34, 22.24' LT (EB), ELEV
PLACE OVER EXISTING CONDUIT. THE CUTTING OF THE EXISTING CONDUIT TO MATCH THE PROPOSED HANDHOLE SHALL BE INCLUDED IN THE COST OF THE HANDHOLE.
CONCRETE MEDIAN SURFACE, 4 INCH, 12 SQ YD
CONCRETE MEDIAN REMOVAL, 12 SQ YD

LEGEND

- PROPOSED CONCRETE HANDHOLE
- PROPOSED PVC CONDUIT
- PROPOSED DETECTOR LOOPS
- ⊕ EXISTING COMBINATION MAST ARM AND POLE WITH MAST ARM AND BRACKET MOUNTED SIGNAL HEADS
- ⊖ RELOCATED COMBINATION MAST ARM AND POLE WITH MAST ARM AND BRACKET MOUNTED SIGNAL HEADS
- ⊕ EXISTING BRACKET MOUNTED SIGNAL HEAD
- ⊖ EXISTING MAST ARM MOUNTED SIGNAL HEAD
- ⊕ PROPOSED BRACKET MOUNTED SIGNAL HEAD
- PROPOSED GULFBOX JUNCTION
- ⊗ EXISTING TRAFFIC SIGNAL CONTROLLER
- T CONDUIT IN TRENCH
- A CONDUIT, AUGERED
- " PVC SIZE OF CONDUIT

STEEL COMBINATION MAST ARM ASSEMBLY AND POLE, 44' CONCRETE FOUNDATION, TYPE E, 36-INCH DIAMETER, 13 FOOT
STA 708+26.09, 38.5' RT (EB), ELEV
RELOCATE EXISTING SIGNAL HEAD, 4 EACH
RELOCATE EXISTING SIGN PANEL, TY 2, 15 SQ FT
RELOCATE EXISTING LUMINAIRE, 2 EACH FROM STA 708+28.48, 27.28' RT (EB) TO STA 708+26.09, 38.50' RT (EB)

RELOCATE EXISTING YAGI ANTENNA TO 45' POLE. SEE SPECIAL PROVISIONS STA 710+15, 90' RT (EB)

RUN LOOP WIRE THROUGH EXISTING CONDUIT. COST INCLUDED IN PRICE OF DETECTOR LOOP, TY 1

SERVICE INSTALLATION, TYPE A (MODIFIED)
40' T - TYPE OF CONDUIT AND CABLE TO BE SPECIFIED BY SE ILL ELECTRIC COOP
REUSE EXISTING METER PAN AND DISCONNECT (PORTION OF TRENCH TO BE ON UTILITY COMPANY EASEMENT)

RELOCATE EXISTING TRAFFIC SIGNAL CONTROLLER, 1 EACH
RELOCATE EXISTING LIGHTING CONTROLLER, 1 EACH FROM STA 709+94.88, 71.22' RT (EB) TO STA 710+00, 100' RT (EB)
CONCRETE FOUNDATION, TYPE C, 3 FT ELEV

**STATE OF ILLINOIS
DEPARTMENT OF TRANSPORTATION**

**PROPOSED TRAFFIC SIGNAL & LIGHTING
ILLINOIS 13 AND REDCO ROAD/BAINBRIDGE TRAIL**

FILE NAME =	USER NAME = shepardgd	DESIGNED -	REVISED -
en:\pw_work\PIWIDOT\SHEPARDGD\dms47330\fdstun13-Bain-sht-TS.dgn		DRAWN -	REVISED -
PLOT SCALE = 30,0000' / IN.		CHECKED -	REVISED -
PLOT DATE = 10/14/2009		DATE -	REVISED -

SCALE: 1"=30'	SHEET NO.	OF	SHEETS	STA.	TO	STA.

F.A.P. RTE.	SECTION	COUNTY	TOTAL SHEETS	SHEET NO.
331	(1-2)N-2,R;(1X-1)N-3,R-2	WILLIAMSON	202	85
CONTRACT NO. 98857				
ILLINOIS FED. AID PROJECT				