

DATE _____ BY _____
 ORIGINAL SURVEY SURVEYED _____
 NOTE BOOK PLOTTED _____
 NO. TEMPLATE _____
 AREAS CHECKED _____

DATE _____ BY _____
 ORIGINAL SURVEY SURVEYED _____
 NOTE BOOK PLOTTED _____
 NO. TEMPLATE _____
 AREAS CHECKED _____

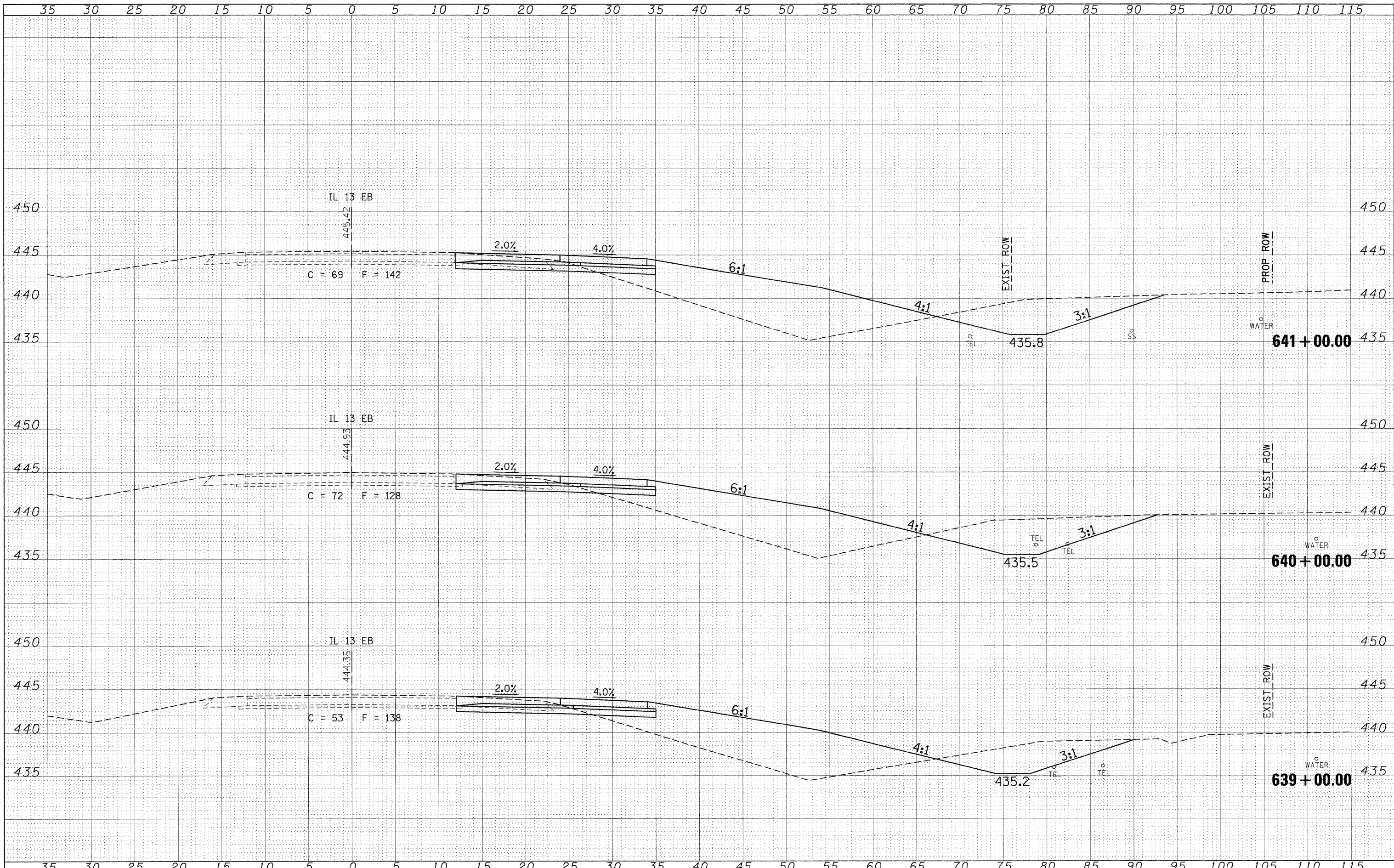

FILE NAME = cr:\pw_work\pw\dot\shepardgd\dms47330\fedstam13

USER NAME = shepardgd
 sht-xssht13mainline2.dgn
 PLOT SCALE = 5,0000 ' / IN.
 PLOT DATE = 10/14/2009

DESIGNED - ---
 DRAWN - ---
 CHECKED - ---
 DATE - ---

REVISED - ---
 REVISED - ---
 REVISED - ---
 REVISED - ---

**STATE OF ILLINOIS
 DEPARTMENT OF TRANSPORTATION**

IL 13 EASTBOUND CROSS SECTION SHEETS

SCALE: _____ SHEET NO. ___ OF ___ SHEETS STA. 639+00.00 TO STA. 641+00.00

| | | | | |
|--------------------|----------------------------------|-------------------|---------------------------|---------------|
| F.A.P. RTE. 331 | SECTION (1-2)N-2,R;(1X-1)N-3,R-2 | COUNTY WILLIAMSON | TOTAL SHEETS 202 | SHEET NO. 122 |
| CONTRACT NO. 98857 | | | ILLINOIS FED. AID PROJECT | |