

Route	Section	County	Total Sheets	Sheet No.
9550	09-00086-00-RS	SALINE	12	6
City of Harrisburg		Sloan Street		

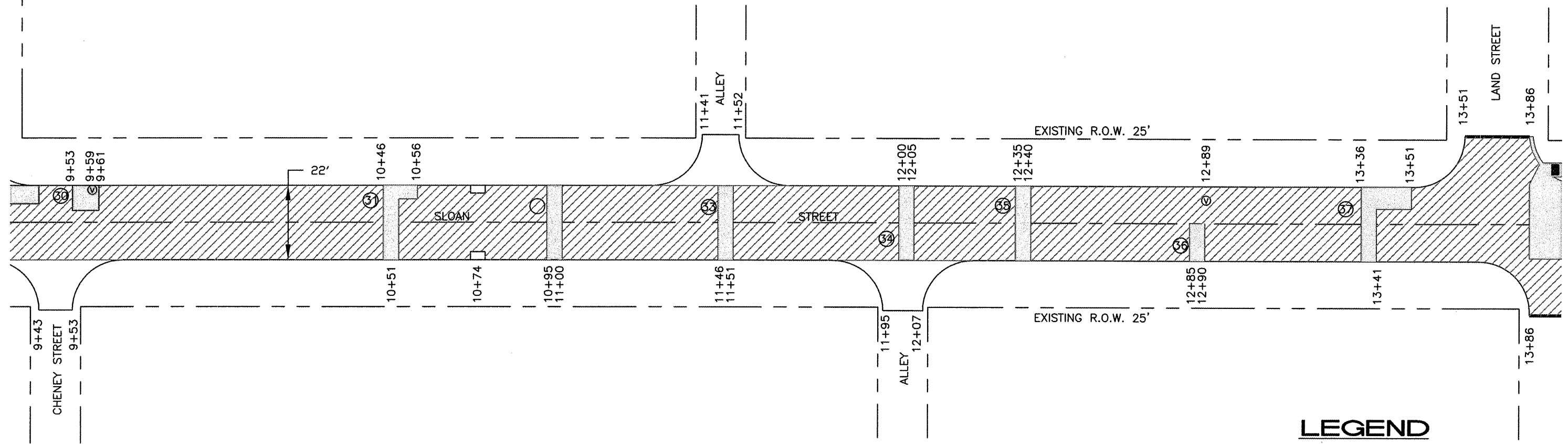





CONTRACT NO. 99401

CLASS B PATCHES, TYPE II, 8 INCH		
AREA #	LOCATION	AMOUNT TO BE REMOVED
30	9+53 TO 9+61	6.7 SQ. YD.
31	10+46 TO 10+56	13.4 SQ. YD.
32	10+95 TO 11+00	11.0 SQ. YD.
33	11+46 TO 11+51	11.0 SQ. YD.
34	12+00 TO 12+05	11.0 SQ. YD.
35	12+35 TO 12+40	11.0 SQ. YD.
36	12+85 TO 12+90	5.5 SQ. YD.
37	13+36 TO 13+51	18.6 SQ. YD.

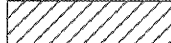
88.2 SQ. YD. TOTAL

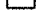

LEGEND

-  CLASS B PATCHES, TYPE II, 8 INCH
-  AREA OF HMA OVERLAY
-  AREA OF HMA SURFACE REMOVAL AND HMA OVERLAY
-  MANHOLE TO BE ADJUSTED
-  MANHOLE ADJUSTMENT, SPECIAL
-  WATER VALVE TO BE ADJUSTED
-  BUTT JOINT TO BE CONSTRUCTED
-  EXISTING INLET

SLOAN STREET - CHENEY STREET TO LAND STREET
STATION 9+43 TO 13+86