

CLASS B PATCHES, TYPE II, 8 INCH		
AREA #	LOCATION	AMOUNT TO BE REMOVED
38	13+86 TO 13+96	27.7 SQ. YD.
39	15+34 TO 15+39	4.0 SQ. YD.
40	17+86 TO 18+28	60.8 SQ. YD.

92.5 SQ. YD. TOTAL

Route	Section	County	Total Sheets	Sheet No.
9550	09-00086-00-RS	SALINE	12	7
City of Harrisburg		Sloan Street		

CONTRACT NO. 99401

PROPOSED 11 FOOT STORM SEWER, CLASS A, TYPE 1 12"
 PROPOSED INLET, TYPE A, SPECIAL
 PROPOSED CONCRETE COLLAR
 INLETS TO BE ADJUSTED W/NEW F&G (SPECIAL)
 PROPOSED INLET, TYPE A, SPECIAL

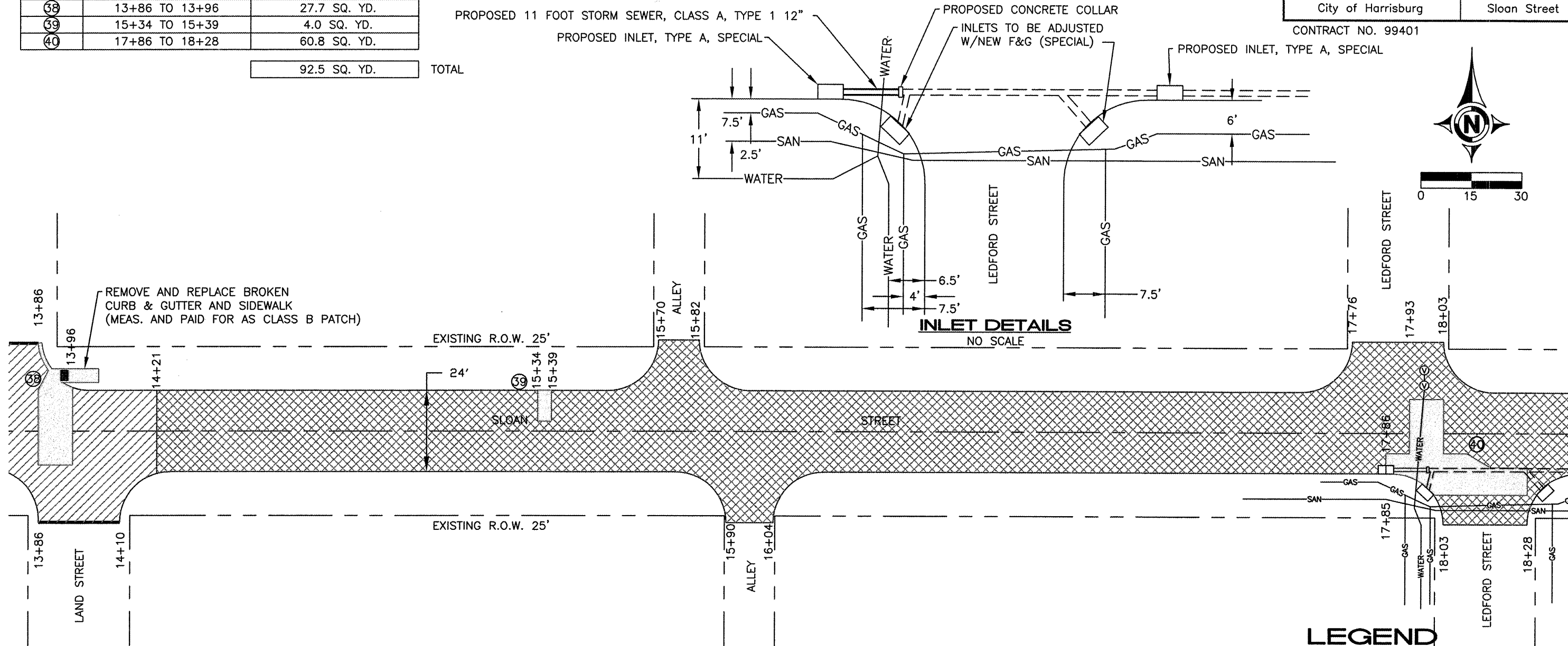

INLET DETAILS
NO SCALE



LEGEND

- CLASS B PATCHES, TYPE II, 8 INCH
- AREA OF HMA OVERLAY
- AREA OF HMA SURFACE REMOVAL AND HMA OVERLAY
- MANHOLE TO BE ADJUSTED
- MANHOLE ADJUSTMENT, SPECIAL
- WATER VALVE TO BE ADJUSTED
- BUTT JOINT TO BE CONSTRUCTED
- DETECTABLE WARNINGS

SLOAN STREET - LAND STREET TO LEDFORD STREET
STATION 13+86 TO 18+28