

01-15-2016 LETTING ITEM 038

STATE OF ILLINOIS  
DEPARTMENT OF TRANSPORTATION  
DIVISION OF HIGHWAYS

**PROPOSED  
HIGHWAY PLANS**

FAU ROUTE 9321 (S. MARKET ST.)  
SECTION 69RS-4

FROM IL 156 TO IL 3  
SMART RESURFACING  
MONROE COUNTY

C-98-047-15

FAU RTE.	SECTION	COUNTY	TOTAL SHEETS	SHEET NO.
9321	69RS-4	MONROE	9	1
		ILLINOIS	CONTRACT NO. 76H97	

FOR INDEX OF SHEETS, SEE SHEET NO. 2

TRAFFIC DATA

2014 ADT= 4350 (ACTUAL)  
2016 ADT= 4450 (ESTIMATED)  
2036 ADT= 5400 (ESTIMATED)  
SU= 3.6%  
MU= 2.2%

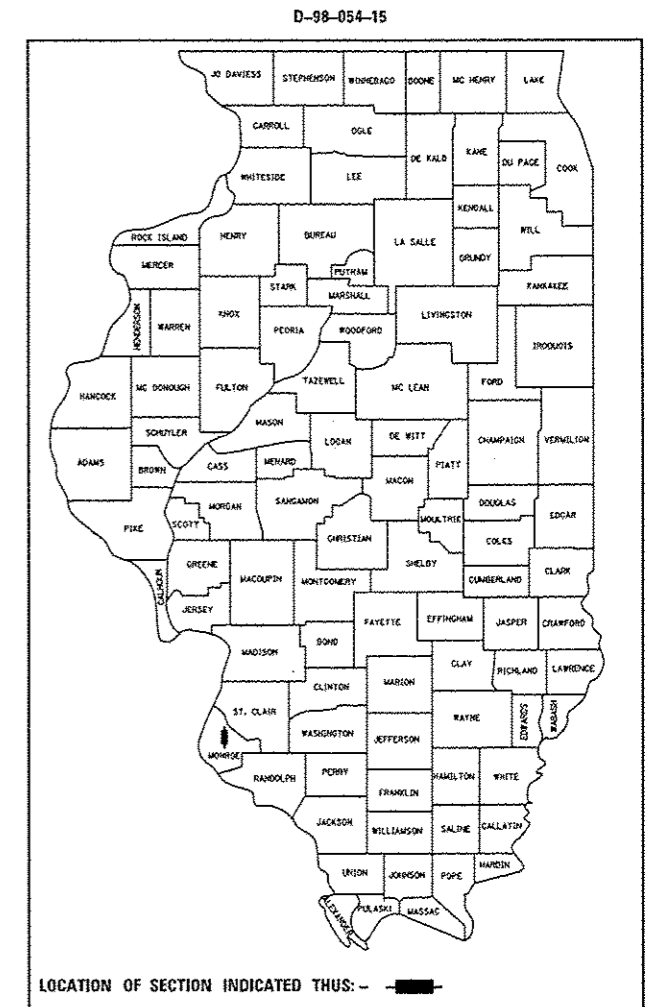

LOCATION OF SECTION INDICATED THIS: - [black rectangle]

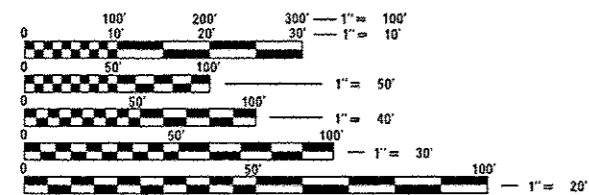

FULL SIZE PLANS HAVE BEEN PREPARED USING STANDARD ENGINEERING SCALES. REDUCED SIZED PLANS WILL NOT CONFORM TO STANDARD SCALES. IN MAKING MEASUREMENTS ON REDUCED PLANS, THE ABOVE SCALES MAY BE USED.

J.U.L.I.E.  
JOINT UTILITY LOCATION INFORMATION FOR EXCAVATION  
1-800-892-0123  
OR 811

PROJECT ENGINEER: TIM PADGETT (618) 346-3325  
PROJECT MANAGER: PHIL COPPERNOLL (618) 346-3480

CONTRACT NO. 76H97

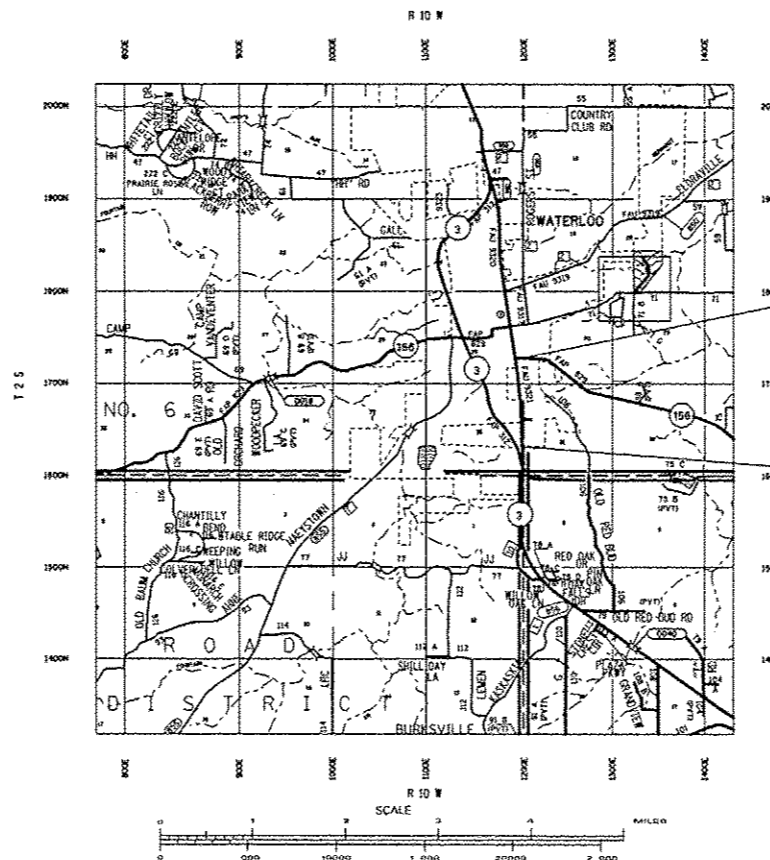

BEGIN PROJECT  
M.P. 0.02  
LAT: 38°18'53.73" N  
LONG: 90°08'45.21" W

END PROJECT  
M.P. 0.96  
LAT: 38°19'43.64" N  
LONG: 90°08'50.20" W

GROSS LENGTH = 4963.20 FT. = 0.940 MILE  
NET LENGTH = 4963.20 FT. = 0.940 MILE

STATE OF ILLINOIS  
DEPARTMENT OF TRANSPORTATION  
DIVISION OF HIGHWAYS

SUBMITTED 10/17/2015  
*Jeffrey Z. Ka...*  
DEPUTY DIRECTOR OF HIGHWAYS, REGION ENGINEER

Dec 4 2015  
*John D. Baranzelli PE*  
ENGINEER OF DESIGN AND ENVIRONMENT

Dec 4 2015  
*Onur Osman PE*  
DIRECTOR OF HIGHWAYS, CHIEF ENGINEER

**PRINTED BY THE AUTHORITY  
OF THE STATE OF ILLINOIS**



CODE NO.	ITEM	UNIT	TOTAL QUANTITY	100% STATE CONSTR. CODE	
				ROADWAY 0005 URBAN	
40600275	BITUMINOUS MATERIALS (PRIME COAT)	POUND	69983	69983	
40600982	HOT-MIX ASPHALT SURFACE REMOVAL - BUTT JOINT	SO YD	37	37	
40600990	TEMPORARY RAMP	SO YD	174	174	
40603340	HOT-MIX ASPHALT SURFACE COURSE, MIX "D", N70	TON	1304	1304	
44000155	HOT-MIX ASPHALT SURFACE REMOVAL, 1 1/2"	SO YD	15448	15448	
44201803	CLASS D PATCHES, TYPE II, 13 INCH	SO YD	37	37	
44201807	CLASS D PATCHES, TYPE III, 13 INCH	SO YD	37	37	
44201839	CLASS D PATCHES, TYPE II, 16 INCH	SO YD	274	274	
44201843	CLASS D PATCHES, TYPE III, 16 INCH	SO YD	126	126	
44201845	CLASS D PATCHES, TYPE IV, 16 INCH	SO YD	242	242	
44300200	STRIP REFLECTIVE CRACK CONTROL TREATMENT	FOOT	733	733	
48102100	AGGREGATE WEDGE SHOULDER, TYPE B	TON	59	59	
67100100	MOBILIZATION	L SUM	1	1	
70100450	TRAFFIC CONTROL AND PROTECTION, STANDARD 701201	L SUM	1	1	

CODE NO.	ITEM	UNIT	TOTAL QUANTITY	100% STATE CONSTR. CODE	
				ROADWAY 0005 URBAN	
70100460	TRAFFIC CONTROL AND PROTECTION, STANDARD 701306	L SUM	1	1	
70100600	TRAFFIC CONTROL AND PROTECTION, STANDARD 701336	L SUM	1	1	
70102620	TRAFFIC CONTROL AND PROTECTION, STANDARD 701501	L SUM	1	1	
70300100	SHORT TERM PAVEMENT MARKING	FOOT	1423	1423	
70300210	TEMPORARY PAVEMENT MARKING LETTERS AND SYMBOLS	SO FT	62.4	62.4	
70300220	TEMPORARY PAVEMENT MARKING - LINE 4"	FOOT	19503	19503	
70301000	WORK ZONE PAVEMENT MARKING REMOVAL	SO FT	474	474	
* 78000100	THERMOPLASTIC PAVEMENT MARKING - LETTERS AND SYMBOLS	SO FT	62.4	62.4	
* 78000200	THERMOPLASTIC PAVEMENT MARKING - LINE 4"	FOOT	19503	19503	
* 78000600	THERMOPLASTIC PAVEMENT MARKING - LINE 12"	FOOT	356	356	
* 78100100	RAISED REFLECTIVE PAVEMENT MARKER	EACH	163	163	
78300200	RAISED REFLECTIVE PAVEMENT MARKER REMOVAL	EACH	138	138	

12

\* SPECIALTY ITEM

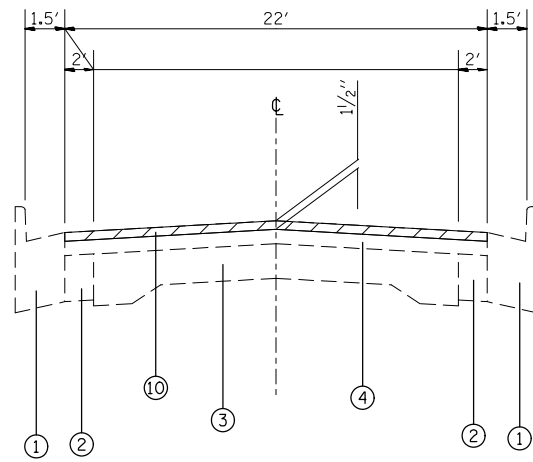

EXISTING TYPICAL SECTION (S. MARKET ST.)  
M.P. 0.02-0.13

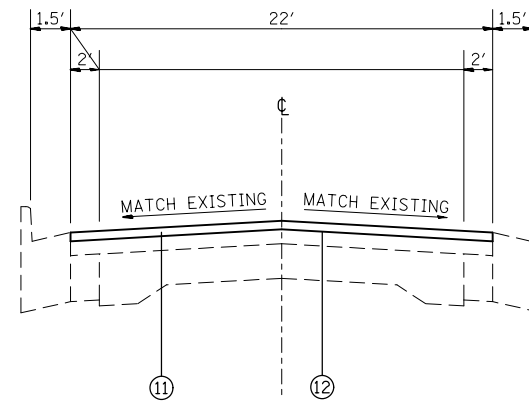

PROPOSED TYPICAL SECTION (S. MARKET ST.)  
M.P. 0.02-0.13

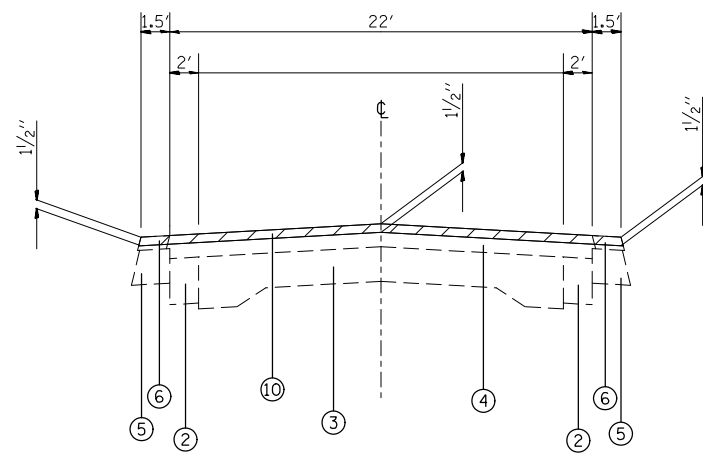

EXISTING TYPICAL SECTION (S. MARKET ST.)  
M.P. 0.13-0.21  
M.P. 0.49-0.56  
M.P. 0.83-0.96

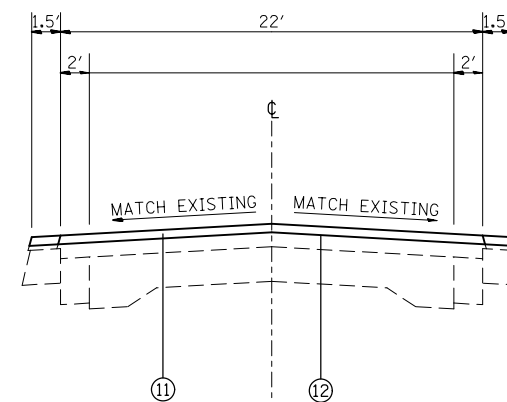

PROPOSED TYPICAL SECTION (S. MARKET ST.)  
M.P. 0.13-0.21  
M.P. 0.49-0.56  
M.P. 0.83-0.96

LEGEND

- ① EXISTING COMBINATION CURB & GUTTER TYPE B-15.60
- ② EXISTING BITUMINOUS WIDENING 8"
- ③ EXISTING 9"-6"-9" PCC PAVEMENT
- ④ EXISTING BITUMINOUS RESURFACING
- ⑤ EXISTING BITUMINOUS SHOULDERS 6"
- ⑥ EXISTING BITUMINOUS SHOULDERS 2.25"
- ⑦ EXISTING BITUMINOUS WIDENING 8.25"
- ⑧ EXISTING BITUMINOUS RESURFACING 2"
- ⑨ EXISTING SUBBASE GRANULAR MATERIAL TYPE A, 12"
- ⑩ PROPOSED HMA SURFACE REMOVAL 1.5"
- ⑪ PROPOSED HMA SURFACE COURSE 1.5"
- ⑫ PROPOSED BITUMINOUS MATERIALS (PRIME COAT)

FILE NAME =	USER NAME = Durozier-J	DESIGNED -	REVISED -
pw:\11084EBIDINTEG.illinois.gov\PIWIDOT\Documents\DOT Offices\District 8\Projects\0876\DRAWING\DATA\EA0sheets\0876H97-sht-plan.dwg		CHECKED -	REVISED -
		DATE -	REVISED -

STATE OF ILLINOIS  
DEPARTMENT OF TRANSPORTATION

TYPICAL SECTIONS

SCALE: SHEET NO. OF SHEETS STA. TO STA.

F.A.U. RTE.	SECTION	COUNTY	TOTAL SHEETS	SHEET NO.
9321	69RS-4	MONROE	9	4
FED. ROAD DIST. NO. ILLINOIS FED. AID PROJECT			CONTRACT NO. 76H97	

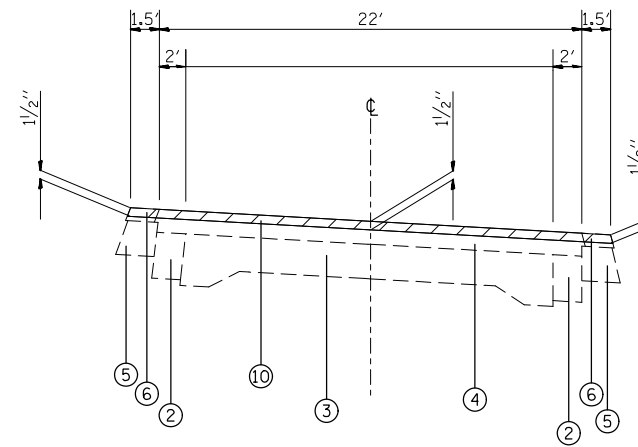

EXISTING TYPICAL SECTION (S. MARKET ST.)  
M.P. 0.21-0.49

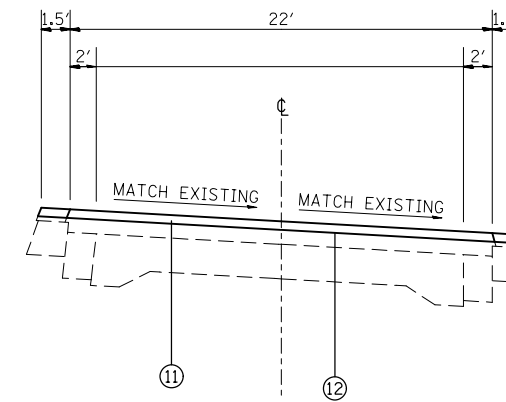

PROPOSED TYPICAL SECTION (S. MARKET ST.)  
M.P. 0.21-0.49

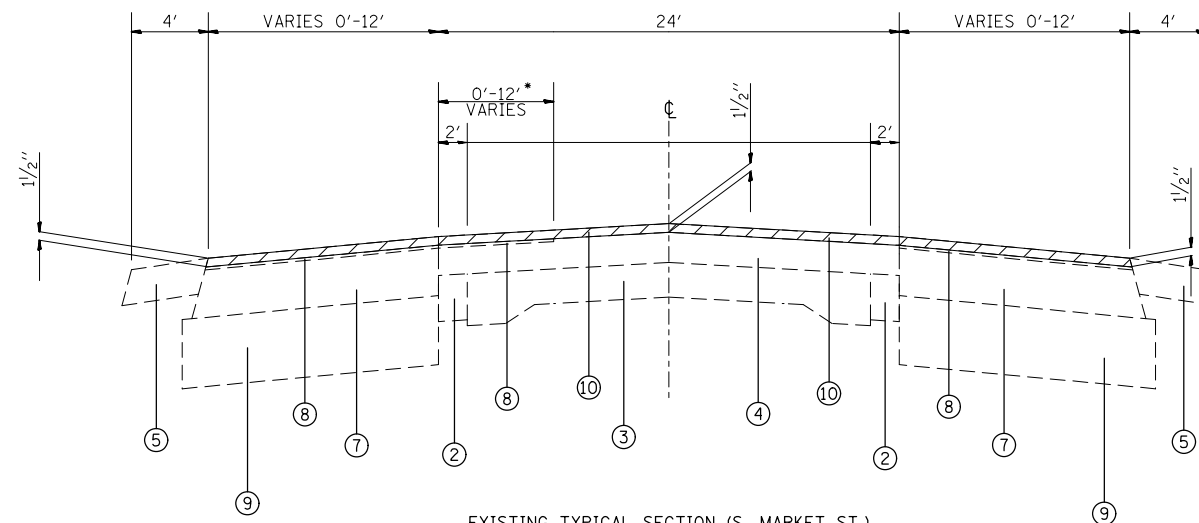

EXISTING TYPICAL SECTION (S. MARKET ST.)  
M.P. 0.56-0.83

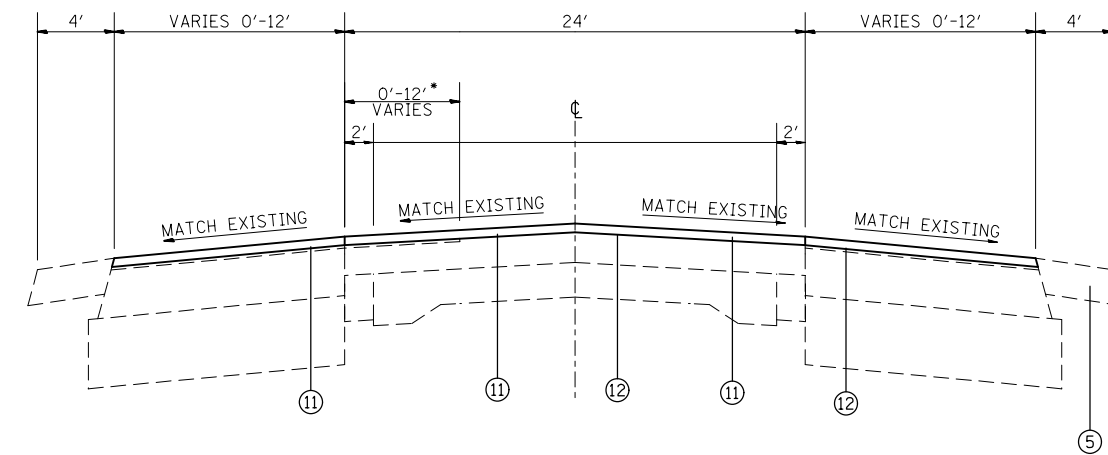

PROPOSED TYPICAL SECTION (S. MARKET ST.)  
M.P. 0.56-0.83

LEGEND

- ① EXISTING COMBINATION CURB & GUTTER TYPE B-15.60
- ② EXISTING BITUMINOUS WIDENING 8"
- ③ EXISTING 9"-6"-9" PCC PAVEMENT
- ④ EXISTING BITUMINOUS RESURFACING
- ⑤ EXISTING BITUMINOUS SHOULDERS 6"
- ⑥ EXISTING BITUMINOUS SHOULDERS 2.25"
- ⑦ EXISTING BITUMINOUS WIDENING 8.25"
- ⑧ EXISTING BITUMINOUS RESURFACING 2"
- ⑨ EXISTING SUBBASE GRANULAR MATERIAL TYPE A, 12"
- ⑩ PROPOSED HMA SURFACE REMOVAL 1.5"
- ⑪ PROPOSED HMA SURFACE COURSE 1.5"
- ⑫ PROPOSED BITUMINOUS MATERIALS (PRIME COAT)

FILE NAME =	USER NAME = Durosier-J	DESIGNED -	REVISED -
pw:\1L084EBIDINTEG.illinois.gov\PIWIDOT\Documents\IDOT Offices\District 8\Projects\0875\DRAWING\DATA\EA0\sheets\0875H97-sht-plandg		CHECKED -	REVISED -
		DATE -	REVISED -

STATE OF ILLINOIS  
DEPARTMENT OF TRANSPORTATION

TYPICAL SECTIONS

SCALE: SHEET NO. OF SHEETS STA. TO STA.

F.A.U. RTE.	SECTION	COUNTY	TOTAL SHEETS	SHEET NO.
9321	69RS-4	MONROE	9	5
CONTRACT NO. 76H97				
FED. ROAD DIST. NO. ILLINOIS FED. AID PROJECT				

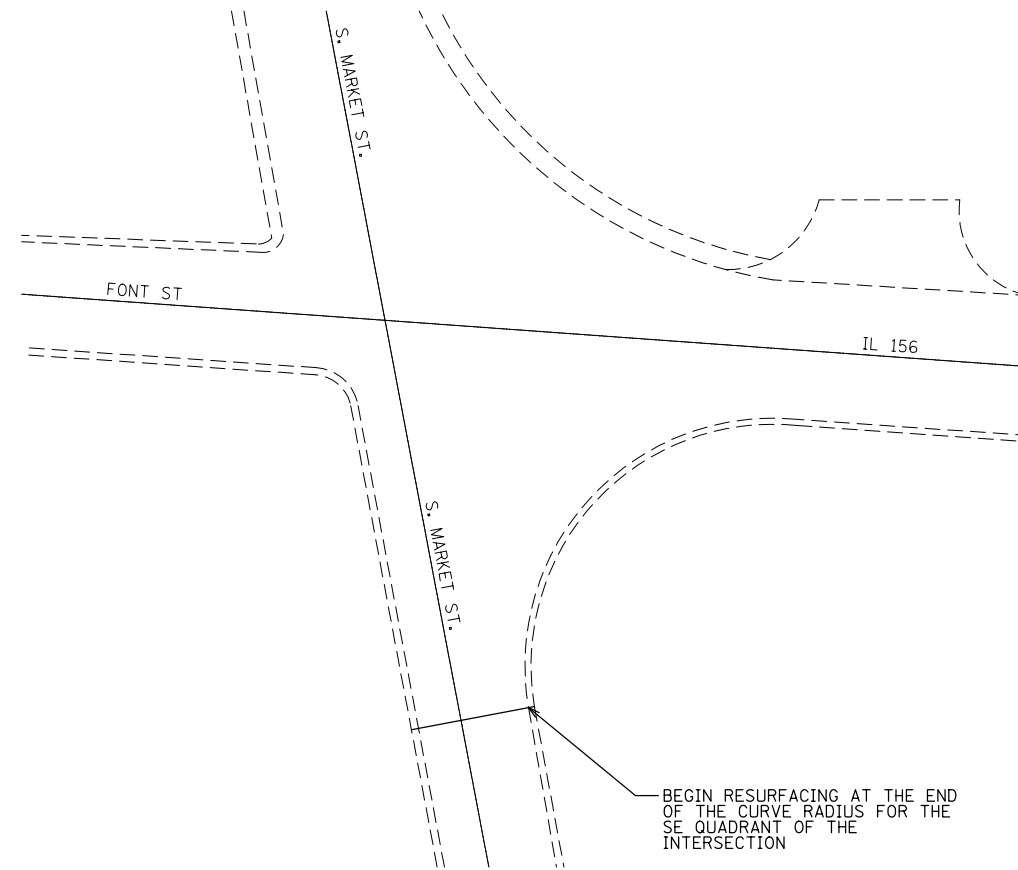
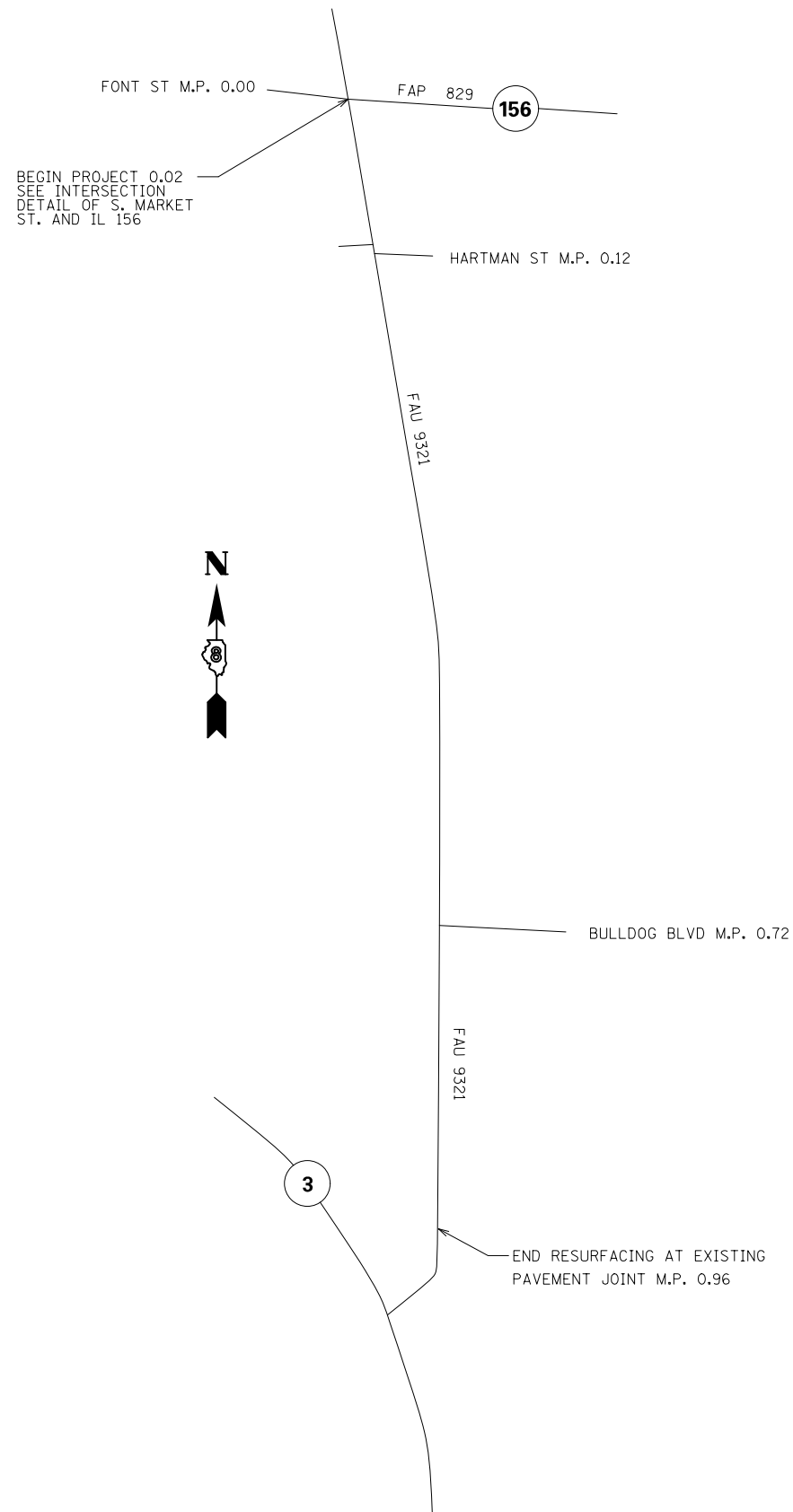

INTERSECTION DETAIL OF S. MARKET ST. AND IL 156

NOT TO SCALE

FILE NAME =	USER NAME = Durosier-J	DESIGNED -	REVISED -	<b>STATE OF ILLINOIS DEPARTMENT OF TRANSPORTATION</b>	<b>DETAILED LOCATION MAP</b>				F.A.U. RTE.	SECTION	COUNTY	TOTAL SHEETS	SHEET NO.
p:\IL\084EBIDINTEG.illinois.gov\PWIDOT\Documents\IDOT Offices\District 8\Projects\0875\DRAWING\DATA\EA0\sheets\D876H97-sht-plan.dwg		DRAWN -	REVISED -		9321	69RS-4	MONROE	9	6				
		CHECKED -	REVISED -		CONTRACT NO. 76H97				FED. ROAD DIST. NO.	ILLINOIS FED. AID PROJECT			
		DATE -	REVISED -		SCALE:	SHEET NO.	OF SHEETS	STA.	TO STA.				



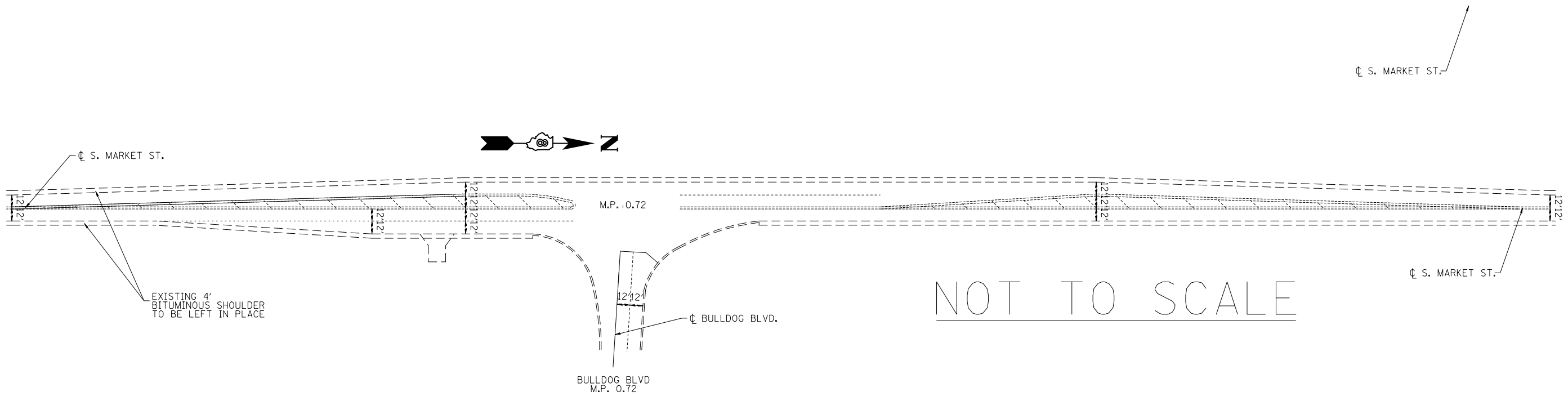

EXISTING INTERSECTION AT BULLDOG BLVD

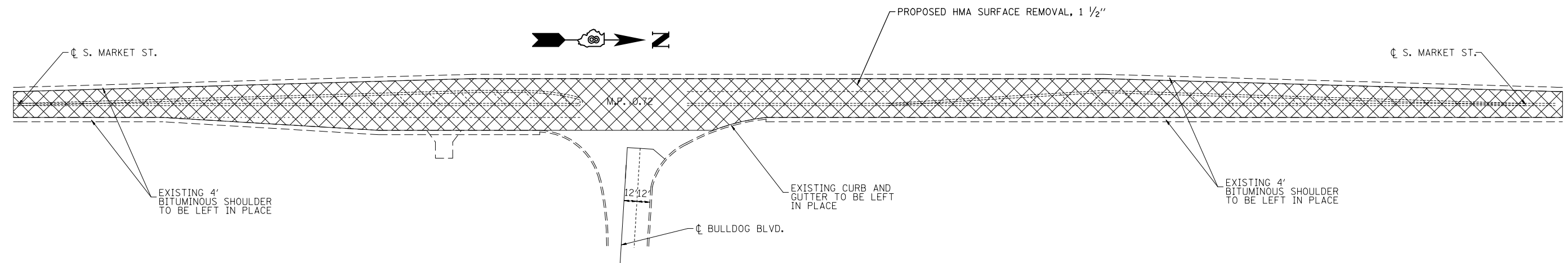

PROPOSED HMA SURFACE REMOVAL AT BULLDOG BLVD

NOT TO SCALE

FILE NAME =	USER NAME = Durosier-J	DESIGNED -	REVISED -
pw:\IL\084EBIDINTEG.illinois.gov\PWIDOT\Documents\DOT Offices\District 8\Projects\0876\DRAWING\DATA\EA0sheets\0876H97-sht-plan.dwg		DRAWN -	REVISED -
	PLOT SCALE = 100.0000' / 1in.	CHECKED -	REVISED -
	PLOT DATE = 9/22/2015	DATE -	REVISED -

**STATE OF ILLINOIS  
DEPARTMENT OF TRANSPORTATION**

**HMA SURFACE REMOVAL DETAIL**

SCALE: SHEET NO. OF SHEETS STA. TO STA.

F.A.U. RTE.	SECTION	COUNTY	TOTAL SHEETS	SHEET NO.
9321	69RS-4	MONROE	9	8
CONTRACT NO. 76H97				
FED. ROAD DIST. NO. ILLINOIS FED. AID PROJECT				



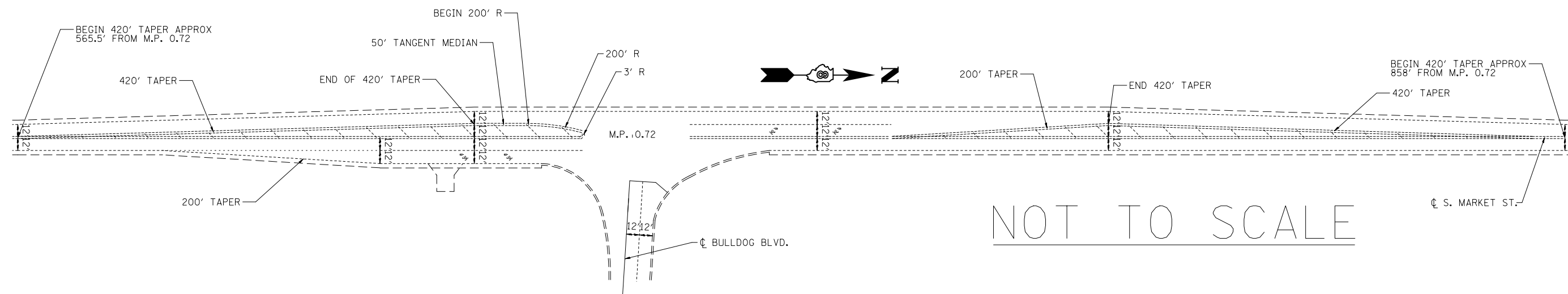

EXISTING PAVEMENT MARKING DETAILS AT BULLDOG BLVD.

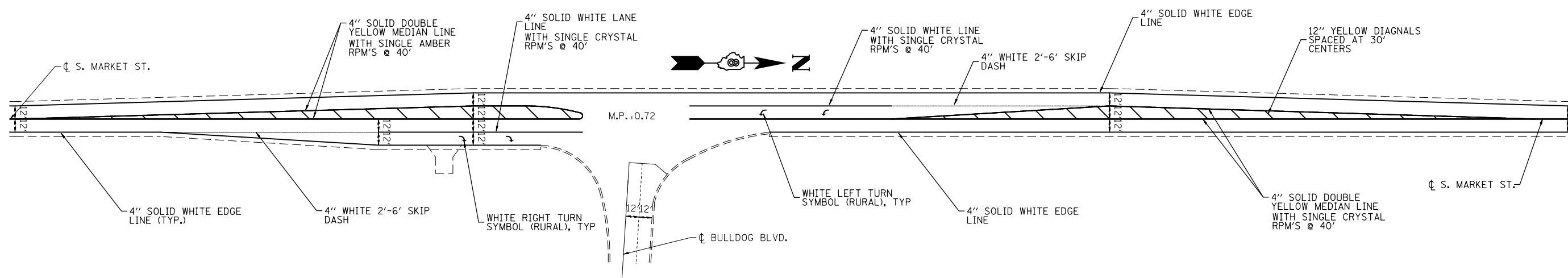

PROPOSED PAVEMENT MARKING DETAILS AT BULLDOG BLVD

**NOTES:**

1. PROPOSED PAVEMENT MARKING IS TO MATCH THE EXISTING PAVEMENT MARKING
2. ALL MEASUREMENTS SHOWN IN THE DETAIL WERE OBTAINED FROM MICROFILM AND ARE ASSUMED TO BE APPROXIMATE
3. RAISED REFLECTIVE PAVEMENT MARKERS ARE TO BE CONSTRUCTED IN ACCORDANCE WITH HIGHWAY STANDARD 781001 (SEE SHEET 7 FOR SCHEDULE)

FILE NAME =	USER NAME = Durosier-J	DESIGNED -	REVISED -	<b>STATE OF ILLINOIS DEPARTMENT OF TRANSPORTATION</b>	<b>PAVEMENT MARKING DETAIL</b>				F.A.U. RTE.	SECTION	COUNTY	TOTAL SHEETS	SHEET NO.
pw:\IL\084EBIDINTEG\illinois.gov\PIWIDOT\Documents\IDOT Offices\District 8\Projects\0875\DRAWING\DATA\EA0\Sheets\0875-sht-plan.dwg		REVISIONS	REVISIONS		9321	69RS-4	MONROE	9	9				
PLOT SCALE = 100.0000' / 1in.	CHECKED -	REVISIONS	REVISIONS		CONTRACT NO. 76H97								
PLOT DATE = 9/22/2015	DATE -	REVISIONS	REVISIONS		SCALE:	SHEET NO.	OF SHEETS	STA.	TO STA.	FED. ROAD DIST. NO.	ILLINOIS FED. AID PROJECT		