

STATE OF ILLINOIS
DEPARTMENT OF TRANSPORTATION

F.A.S. RTE.	SECTION	COUNTY	TOTAL SHEETS	SHEET NO.
1751	(Y-2,P-2)RS	FAYETTE	19	1
		ILLINOIS	CONTRACT NO. 74721	

PROPOSED HIGHWAY PLANS

F.A.S. ROUTE 1751 (US ROUTE 40)
SECTION (Y-2,P-2)RS
PROJECT STP-HC7Z(955)
3P RESURFACING
FAYETTE COUNTY
C-97-070-15

FOR INDEX OF SHEETS, SEE SHEET NO. 2

STRUCTURE OMISSIONS			
STATION	TO	STATION	STRUCTURE #
14 + 90.4		17 + 60.5	026-0042
74 + 72.82		75 + 65.32	026-0043
OMISSION INCLUDES APPROACH PAVEMENT			

ADT = 1600 (2019)

PROJECT BEGINS
STATION 0 + 00
BOND/FAYETTE COUNTY LINE

PROEJCT ENDS
STATION 120 + 13.47
(HURRICANE CREEK)

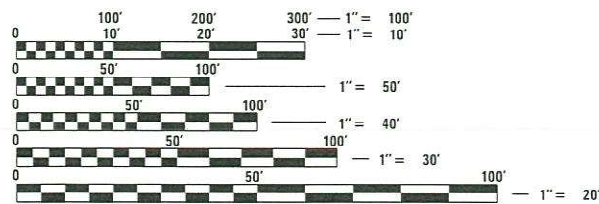

FULL SIZE PLANS HAVE BEEN PREPARED USING STANDARD ENGINEERING SCALES. REDUCED SIZED PLANS WILL NOT CONFORM TO STANDARD SCALES. IN MAKING MEASUREMENTS ON REDUCED PLANS, THE ABOVE SCALES MAY BE USED.

J.U.L.I.E.
JOINT UTILITY LOCATION INFORMATION FOR EXCAVATORS
1-800-892-0123
OR 811

PROJECT ENGINEER: BRIAN LEWIS
PROJECT MANAGER: MYRA OLTMAN

CONTRACT NO. 74721

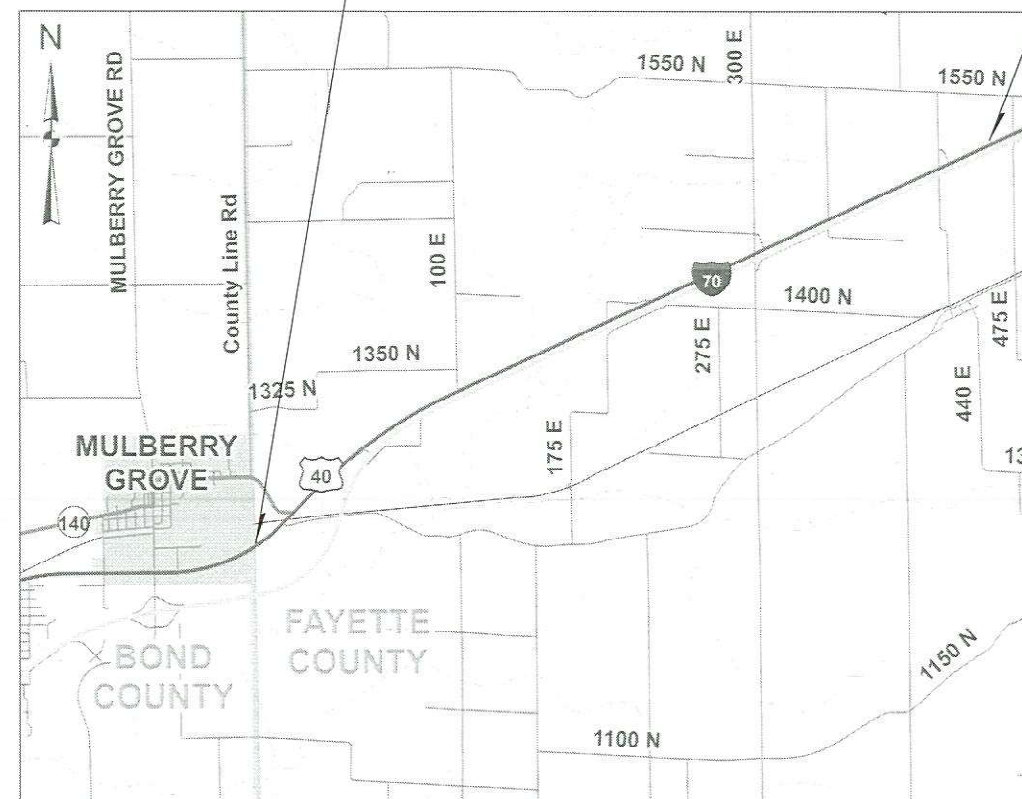

GROSS LENGTH = 12,013 FT. = 2.28 MILE
NET LENGTH = 11,654 FT. = 2.21 MILE

D-97-026-15

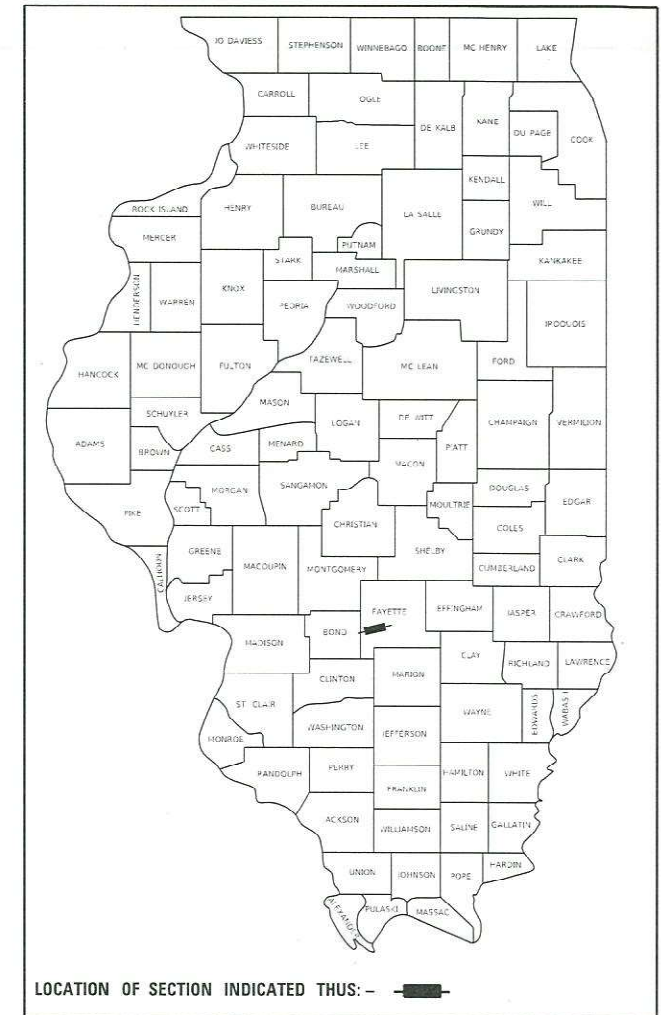

LOCATION OF SECTION INDICATED THUS: ———

STATE OF ILLINOIS
DEPARTMENT OF TRANSPORTATION

SUBMITTED October 16 2020
Jeffrey P. Myer
REGIONAL ENGINEER

December 4, 2020
Scott A. Etk
ENGINEER OF DESIGN AND ENVIRONMENT

December 4, 2020
James J. ...
DIRECTOR OF HIGHWAYS PROJECT IMPLEMENTATION

PRINTED BY THE AUTHORITY
OF THE STATE OF ILLINOIS

GENERAL NOTES

THIS PROJECT IS LOCATED ON FAP ROUTE 1751 (US ROUTE 40) IN FAYETTE COUNTY FROM THE BOND COUNTY LINE TO HURRICAN THE PROJECT INCLUDES 1 1/2" HMA SURFACE REMOVAL, 2.75" HMA SURFACE REMOVAL IN GUTTER SECTIONS, 1 1/4" HMA BINDER LONGITUDINAL JOINT SEALANT, 1 1/2 " HMA SURFACE COURSE, AGGREGATE SHOULDERS, AND OTHER NECESSARY WORK AS NEED

MATERIAL FOR AGGREGATE SURFACE COURSE, TYPE B SHALL BE CRUSHED STONE OR CRUSHED CONCRETE.
MATERIAL FOR AGGREGATE WEDGE SHOULDER, TYPE B SHALL BE CRUSHED STONE, CRUSHED CONCRETE OR RAP.

SHORT TERM PAVEMENT MARKING APPLIED TO ALL MILLED SURFACE SHALL BE PAINT AND THOSE APPLIED TO THE HMA COURSES :

QUANTITIES FOR PAINT PAVEMENT MARKING LINE 4 INCH CONSISTS OF 10,539 FEET OF YELLOW AND 24,026 FEET OF WHITE.

THERE ARE NO PERMANENT SURVEY MARKERS IN THE EXISTING PAVEMENT.

THE FOLLOWING RATES OF APPLICATION HAVE BEEN USED IN CALCULATING PLAN QUANTITIES:

BITUMINOUS MATERIALS (TACK COAT)	0.05 LBS/SQ FT
	0.025 LBS/SQ F MILLED SURFACE
AGGREGATE SHOULDERS	2.05 TONS/CU YD
HOT-MIX ASPHALT	112 LBS /SQ YD/IN

INDEX OF SHEETS

1	COVER SHEET
2	GENERAL NOTES & INDEX OF SHEETS
3-4	SUMMARY OF QUANTITIES
5	TYPICAL SECTIONS
6	TRANSITION DETAIL
7	SCHEDULE OF QUANTITIES
8-11	PLAN SHEETS
12	TREE REMOVAL PLAN SHEET
13	TREE PLANTING LOCATION PLAN SHEET
14	PLANTING DETAILS DISTRICT DETAIL 25300000
15	RURAL ENTRANCE AND MAILBOX TURNOUT DETAILS WITH SHOULDERS
16-19	PAVEMENT MARKING AND RAISED REFLECTIVE PAVEMENT MARKERS (RURAL & URBAN APPLICATION)D-7 DETAIL NO. 78000001

HIGHWAY STANDARDS

- 406201-01 MAILBOX TURNOUT
- 442101-09 CLASS C AND D PATCHES
- 482011-03 HMA SHLD. STRIPS/SHLDS WITH RESURFACING OR WIDENING AND RESURFACING I
- 701001-02 OFF-ROAD OPERATIONS, 2L, 2W, MORE THAN 15' AWAY
- 701006-05 OFF-ROAD OPERATIONS, 2L, 2W, 15' TO 24" FROM PAVEMENT EDGE
- 701011-04 OFF-ROAD MOVING OPERATIONS, 2L, 2W, DAY ONLY
- 701101-05 OFF RD OPERATIONS MULTILANE 15' TO 24" FROM EDGE OF PAVEMENT
- 701106-02 OFF RD OPERATIONS MULTILANE MORE THAN 15' AWAY
- 701201-05 LANE CLOSURE, 2L, 2W, DAY ONLY, FOR SPEEDS ≥ 45 MPH
- 701301-04 LANE CLOSURE, 2L, 2W, SHORT TIME OPERATIONS
- 701306-04 LANE CLOSURE, 2L, 2W, SLOW MOVING OPERATIONS DAY ONLY, FOR SPEEDS ≥ 4
- 701311-03 LANE CLOSURE, 2L, 2W, MOVING OPERATIONS - DAY ONLY

MATERIAL REQUIREMENTS

APPLICATION	AC/PG	DESIGN AIR VOIDS	MIXTURE COMPOSITION	FRICTION AGGREGATE	QUALITY MANAGEMENT
HMA SURFACE COURSE, MIX "C", N70, (1.5")	PG 64-22	4.0% @ N=70	IL - 9.5	MIXTURE C	QCP
HMA BINDER COURSE, IL-9.5FG, N70 (1.25")	PG 64-22	4.0% @ N=70	IL - 9.5FG	N/A	QCP
INCIDENTAL HMA SURFACING	PG 64-22	4.0% @ N=70	IL - 9.5	MIXTURE C	QC/QA
CLASS "D" PAVEMENT PATCHING	PG 64-22	4.0% @ N=70	IL - 19.0	N/A	QC/QA

REV. - MS

MODEL: Default
 FILE: M:\GIS\Projects\GIS\Projects\DOT\Office\District 7\Project\1751\CADD\DATA\CAD\Sheet\1751-19-2-1751-19-2.dgn

USER NAME = steffenmk	DESIGNED -	REVISED -	STATE OF ILLINOIS DEPARTMENT OF TRANSPORTATION	GENERAL NOTES AND INDEX OF SHEETS		F.A.S. RTE.	SECTION	COUNTY	TOTAL SHEETS	SHEET NO.
PLOT SCALE = 100.0000' / in.	DRAWN -	REVISED -				1751	(Y-2,P-2)RS	FAYETTE	19	2
PLOT DATE = 10/16/2020	CHECKED -	REVISED -		SCALE: SHEET OF SHEETS STA. TO STA.		CONTRACT NO. 74721				
	DATE -	REVISED -				ILLINOIS FED. AID PROJECT				

80% FED
20% STATE

80% FED
20% STATE

SUMMARY OF QUANTITIES			TOTAL QUANTITIES	CONSTRUCTION TYPE CODE		
CODE NO	ITEM	UNIT		0005	0031	
20100500	TREE REMOVAL, ACRES	ACRE	0.59		0.59	
40200800	AGGREGATE SURFACE COURSE, TYPE B	TON	12.3	12.3		
40600290	BITUMINOUS MATERIALS (TACK COAT)	POUND	20465	20465		
40600990	TEMPORARY RAMP	SO YD	187	187		
40602970	HOT-MIX ASPHALT BINDER COURSE, IL-9.5FG, N70	TON	2129	2129		
40604052	HOT-MIX ASPHALT SURFACE COURSE, IL-9.5, MIX "C", N70	TON	2555	2555		
40800050	INCIDENTAL HOT-MIX ASPHALT SURFACING	TON	13	13		
44000155	HOT-MIX ASPHALT SURFACE REMOVAL, 1 1/2"	SO YD	21730	21730		
44000160	HOT-MIX ASPHALT SURFACE REMOVAL, 2 3/4"	SO YD	8582	8582		
44201815	CLASS D PATCHES, TYPE II, 14 INCH	SO YD	1107	1107		
44201819	CLASS D PATCHES, TYPE III, 14 INCH	SO YD	116	116		
44201821	CLASS D PATCHES, TYPE IV, 14 INCH	SO YD	170	170		
48102100	AGGREGATE WEDGE SHOULDER, TYPE B	TON	912	912		
67000400	ENGINEER'S FIELD OFFICE, TYPE A	CAL MO	3	3		

SUMMARY OF QUANTITIES			TOTAL QUANTITIES	CONSTRUCTION TYPE CODE		
CODE NO	ITEM	UNIT		0005	0031	
67100100	MOBILIZATION	LSUM	1	1		
70100450	TRAFFIC CONTROL AND PROTECTION, STANDARD 701201	LSUM	1	1		
70100460	TRAFFIC CONTROL AND PROTECTION, STANDARD 701306	LSUM	1	1		
70107025	CHANGEABLE MESSAGE SIGN	CAL DA	28	28		
70300100	SHORT TERM PAVEMENT MARKING	FOOT	3604	3604		
70300150	SHORT TERM PAVEMENT MARKING REMOVAL	SO FT	401	401		
70300220	TEMPORARY PAVEMENT MARKING - LINE 4"	FOOT	34170	34170		
* 78001110	PAINT PAVEMENT MARKING - LINE 4"	FOOT	34170	34170		
* 78100100	RAISED REFLECTIVE PAVEMENT MARKER	EACH	150	150		
78300200	RAISED REFLECTIVE PAVEMENT MARKER REMOVAL	EACH	150	150		
* D2002972	EVERGREEN, PINUS STROBUS (EASTERN WHITE PINE), 6' HEIGHT, BALLED AND BURLAPPED	EACH	83	83		
X0326440	SURFACE REMOVAL, VARIABLE DEPTH (SPECIAL)	SO YD	302	302		
X4060995	TEMPORARY RAMP, SPECIAL	SO YD	137	137		

* SPECIALTY ITEM

MODEL: Default
 FILE: \\snp\baronon.dwg
 PLOT DATE: 10/16/2020
 PROJECT: 74721
 SHEET: 19 OF 3

USER NAME = steffenmk	DESIGNED -	REVISED -
	DRAWN -	REVISED -
PLOT SCALE = 100.0000' / in.	CHECKED -	REVISED -
PLOT DATE = 10/16/2020	DATE -	REVISED -

STATE OF ILLINOIS
DEPARTMENT OF TRANSPORTATION

SUMMARY OF QUANTITIES

SCALE: SHEET OF SHEETS STA. TO STA.

F.A.S. RTE.	SECTION	COUNTY	TOTAL SHEETS	SHEET NO.
1751	(Y-2,P-2)RS	FAYETTE	19	3
CONTRACT NO. 74721			ILLINOIS FED. AID PROJECT	

BOND/FAYETTE
COUNTY LINE

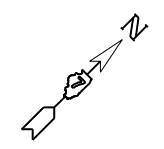

0+00 1 2 3 4 5+00 6 7 8 9 10+00 11 12 13 14 15+00

MILLING/PAVING LIMITS
3'
HAGARSTOWN RD
PRA + 55.5
(HMA)
POT 13+87.1
POT 14+44.4

ALIGNMENT AND TOPO ARE A STRAIGHT LINE GRAPHIC REPRESENTATION FOR INFORMATION ONLY

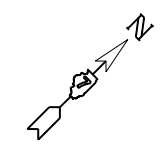

15+00 16 17 18 19 20+00 21 22 23 24 25+00 26 27 28 29 30+00

PAVING LIMITS
25'
ROUTE 140
IL PRA
ROUTE 140
(HMA)

POT 20+31.45

POT 23+64

OMISSION
STRUCTURE # 026-0042
STA. 14+90.4 TO STA. 17+60.5

MODEL: Default
FILE: h:\mfc_2010\pub\harcourt\dot\illinois\p\74721\dot\documents\DOT_Offices\174721\74721-1-shc-plan.dgn

USER NAME = steffenmk	DESIGNED -	REVISED -
	DRAWN -	REVISED -
PLOT SCALE = 100.0000 ' / in.	CHECKED -	REVISED -
PLOT DATE = 10/16/2020	DATE -	REVISED -

STATE OF ILLINOIS
DEPARTMENT OF TRANSPORTATION

PLAN SHEET			
STATION 0+00 TO STATION 30+00			
SCALE:	SHEET	OF	SHEETS
	STA.	TO	STA.

F.A.S RTE.	SECTION	COUNTY	TOTAL SHEETS	SHEET NO.
1751	(Y-2,P-2)RS	FAYETTE	19	8
ILLINOIS FED. AID PROJECT			CONTRACT NO. 74721	

MODEL: Default
 FILE: h:\m15c_p10\p10planroom.dwg
 PROJECT: 74721\CAADData\CAD\Drawings\74721-1-shc-plan.dgn

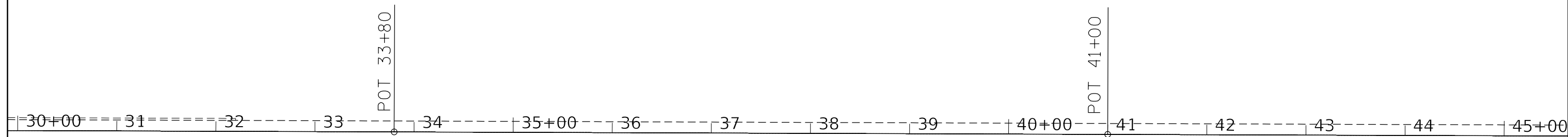

ALIGNMENT AND TOPO ARE A STRAIGHT LINE GRAPHIC REPRESENTATION FOR INFORMATION ONLY

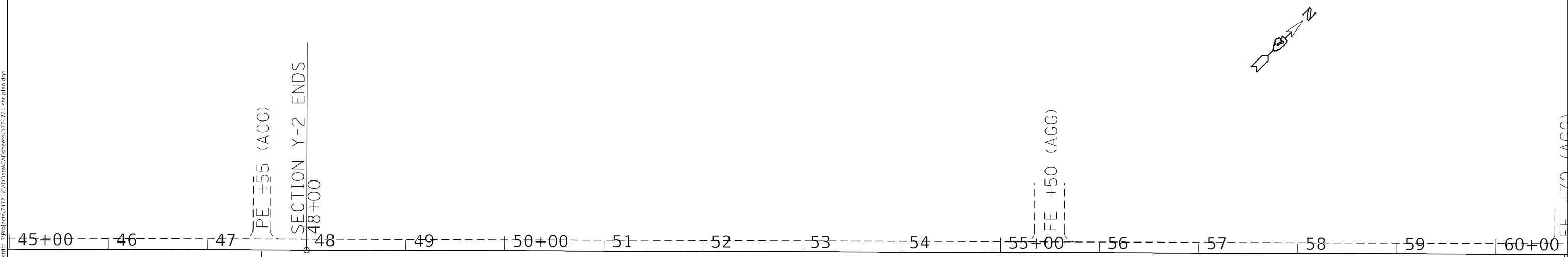

PRA +55
(OIL & CHIP)

MBT +55
(AGG)

SECTION Y-2 ENDS
48+00

FE +50 (AGG)

MBT +70 (AGG)

USER NAME = steffemk	DESIGNED -	REVISED -
	DRAWN -	REVISED -
PLOT SCALE = 100.0000' / in.	CHECKED -	REVISED -
PLOT DATE = 10/16/2020	DATE -	REVISED -

**STATE OF ILLINOIS
 DEPARTMENT OF TRANSPORTATION**

PLAN SHEET			
STATION 30+00 TO STATION 60+00			
SCALE:	SHEET	OF SHEETS	STA. TO STA.

F.A.S RTE.	SECTION	COUNTY	TOTAL SHEETS	SHEET NO.
1751	(Y-2,P-2)RS	FAYETTE	19	9
ILLINOIS FED. AID PROJECT			CONTRACT NO. 74721	

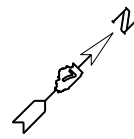

OMISSION
 STRUCTURE # 026-0043
 STA. 74+72.82 TO STA. 75+65.32

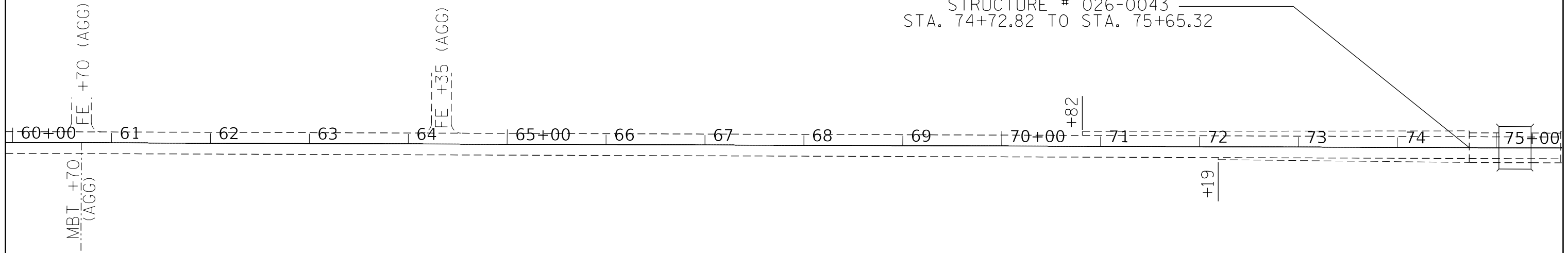

ALIGNMENT AND TOPO ARE A STRAIGHT LINE GRAPHIC REPRESENTATION FOR INFORMATION ONLY

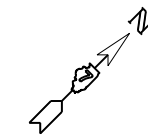

OMISSION
 STRUCTURE # 026-0043
 STA. 74+72.82 TO STA. 75+65.32

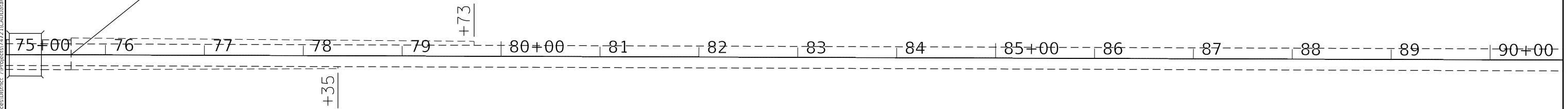

MODEL: Default
 FILE: h:\m\c\p\suplanroom.d\illinois.gov\PI\DOT\Documents\DOT_Offices\District_7\Projects\74721\CAAD\Drawings\74721-1-shc-plan.dgn

USER NAME = steffenmk	DESIGNED -	REVISED -
	DRAWN -	REVISED -
PLOT SCALE = 100.0000' / in.	CHECKED -	REVISED -
PLOT DATE = 10/16/2020	DATE -	REVISED -

**STATE OF ILLINOIS
 DEPARTMENT OF TRANSPORTATION**

PLAN SHEET			
STATION 60+00 TO STATION 90+00			
SCALE:	SHEET	OF SHEETS	STA. TO STA.

F.A.S RTE.	SECTION	COUNTY	TOTAL SHEETS	SHEET NO.
1751	(Y-2,P-2)RS	FAYETTE	19	10
CONTRACT NO. 74721				
ILLINOIS		FED. AID PROJECT		

MODEL: Default
 FILE: h:\m16c_p10\pub\barroom.dwg
 PROJECT: 74721\CADData\CAD\sheet\74721-1-shcplan.dgn

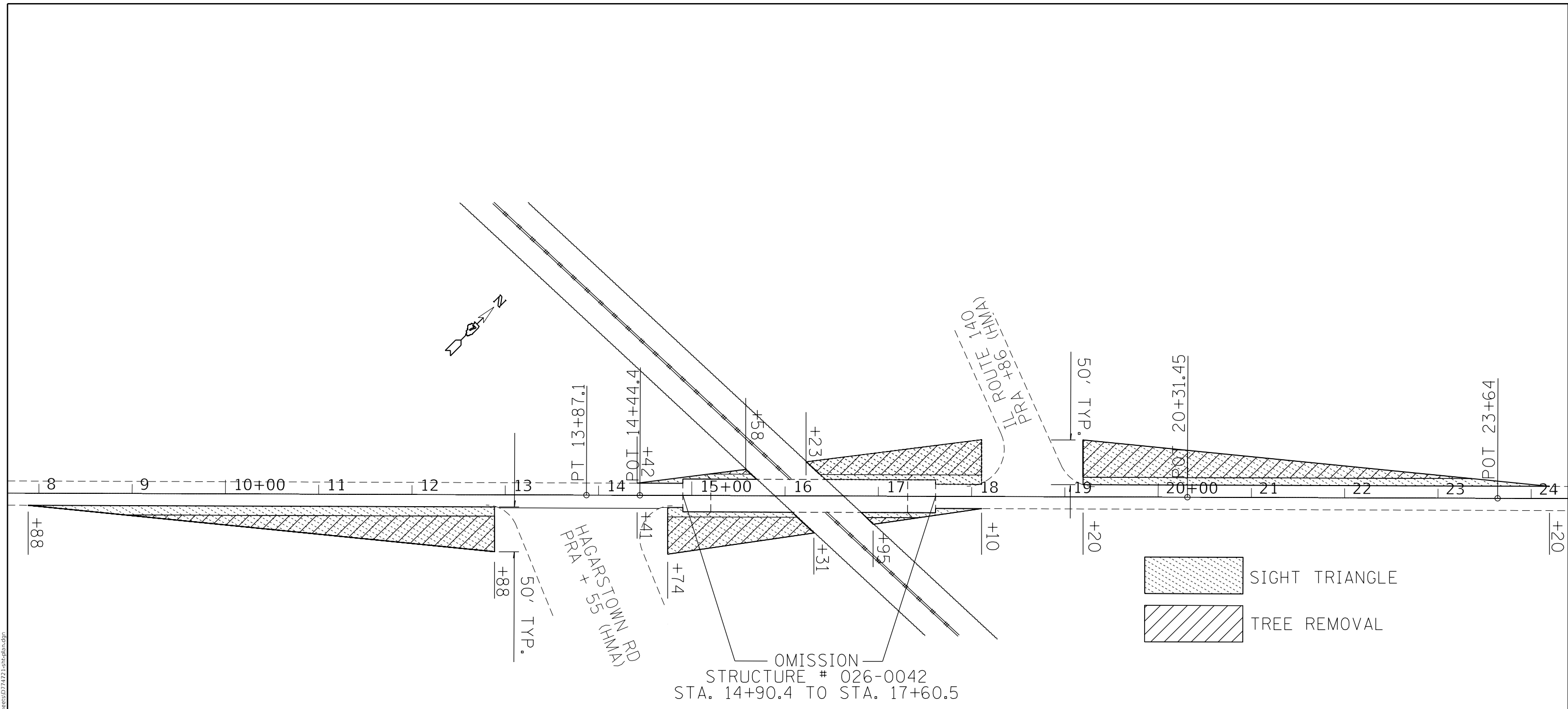

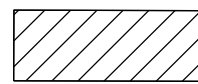
	SIGHT TRIANGLE
	TREE REMOVAL

TREE REMOVAL			
STATION	TO	STATION	ACRE
SOUTH SIDE			
		0	
7+94	TO	12+88	0.17
14+74	TO	16+31	0.10
16+95	TO	18+10	0.00
NORTH SIDE			
14+42	TO	15+58	0.00
16+23	TO	18+10	0.11
19+20	TO	21+32	0.19
		TOTAL	0.59

NOT TO SCALE

USER NAME = steffenmk	DESIGNED -	REVISED -
	DRAWN -	REVISED -
PLOT SCALE = 100,0000 ' / in.	CHECKED -	REVISED -
PLOT DATE = 10/16/2020	DATE -	REVISED -

STATE OF ILLINOIS
DEPARTMENT OF TRANSPORTATION

PLAN SHEET		TREE REMOVAL	
SCALE:	SHEET	OF	SHEETS
	STA.	TO	STA.

F.A.S. RTE.	SECTION	COUNTY	TOTAL SHEETS	SHEET NO.
1751	(Y-2,P-2)RS	FAYETTE	19	12
CONTRACT NO. 74721				
ILLINOIS FED. AID PROJECT				

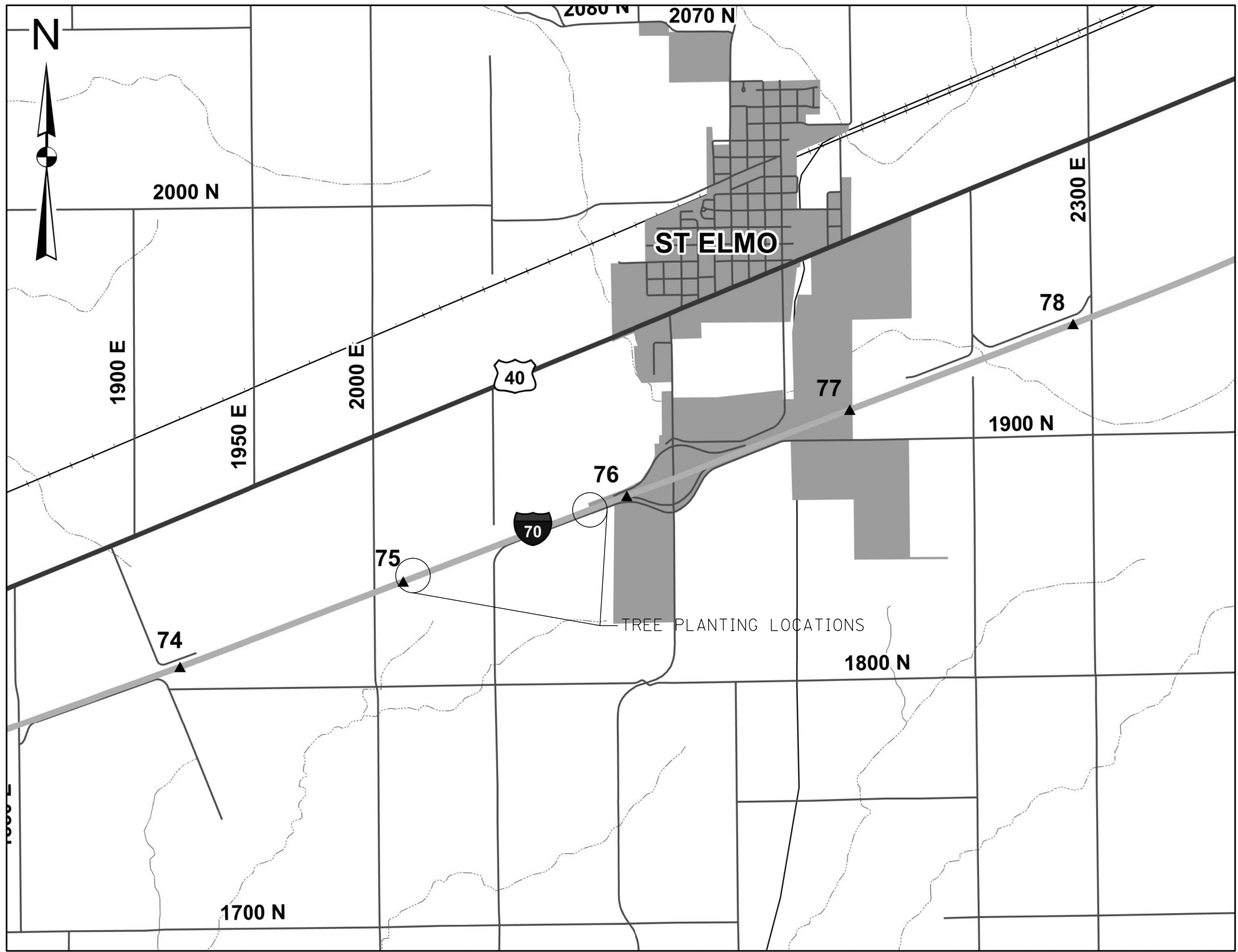

TREE PLACEMENT SCHEDULE	
EVERGREEN, PINUS STROBUS (EASTERN WHITE PINE) 6' HEIGHT, BALLED AND BURLAPPED PLACED @ 10 FOOT SPACING	
LOCATION:	
MILE MARKER 75.86 TO 75.94	43 TREES
MILE MARKER 75.00 TO 75.07	40 TREES
	83 TREES

TREES WILL BE PLANTED 10' OFF
 ROW FENCE ON WESTBOUND FAI 70
 PLACEMENT WILL BE DETERMINED BY THE RESIDENT ENGINEER

MODEL: Default
 FILE: h:\m\c\p\pub\h\m\room\dat\illinois\p\w\DOT\Documents\DOT_Offices\District_7\Projects\74721\CADD\DATA\CAD\Drawings\74721-1-shc-plan.dgn

USER NAME = steffemk	DESIGNED -	REVISED -
	DRAWN -	REVISED -
PLOT SCALE = 100,0000' / in.	CHECKED -	REVISED -
PLOT DATE = 10/16/2020	DATE -	REVISED -

**STATE OF ILLINOIS
 DEPARTMENT OF TRANSPORTATION**

PLAN SHEET	
TREE PLANTING LOCATIONS	
SCALE:	SHEET OF SHEETS STA. TO STA.

F.A.S. RTE.	SECTION	COUNTY	TOTAL SHEETS	SHEET NO.
1751	(Y-2,P-2)RS	FAYETTE	19	13
			CONTRACT NO. 74721	
ILLINOIS FED. AID PROJECT				

SEE SECTION 253 OF THE STANDARD SPECIFICATIONS FOR ROAD AND BRIDGE CONSTRUCTION FOR INFORMATION NOT SHOWN.

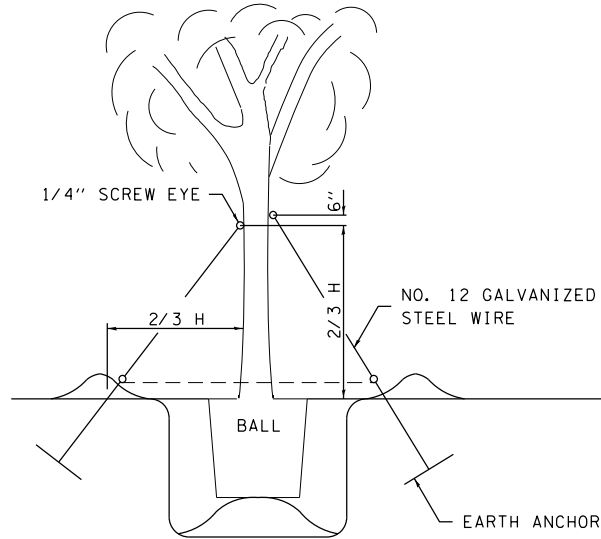

SECTION

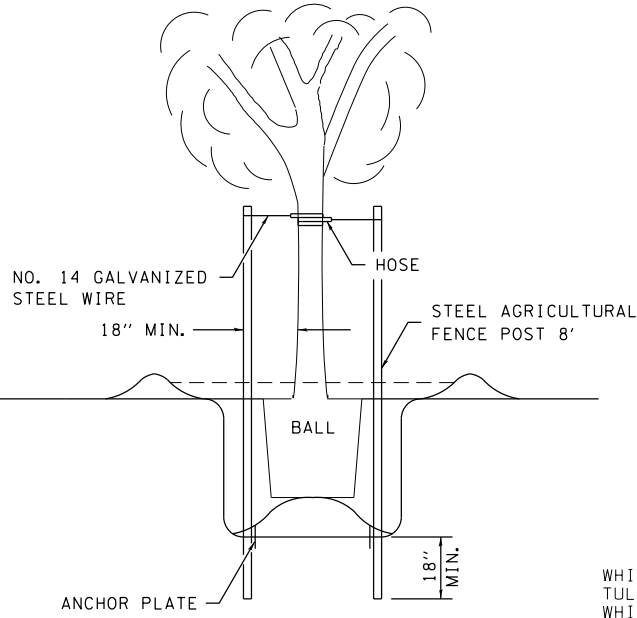

SECTION

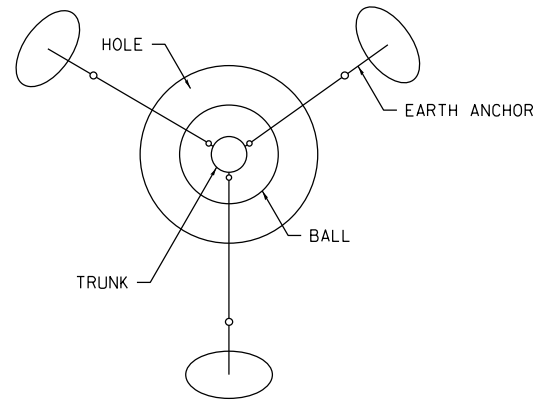

PLAN

TREES OVER 4 1/2" IN CALIPER

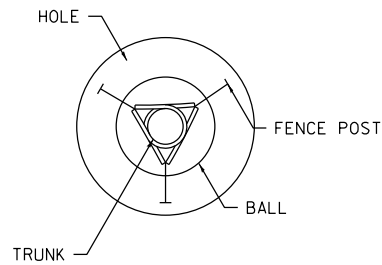

PLAN

TREES OVER 8' TALL AND 4 1/2" IN CALIPER AND ALL "A" & "D" CODED TREES.

• OVER 4' TALL

BRACING DETAIL

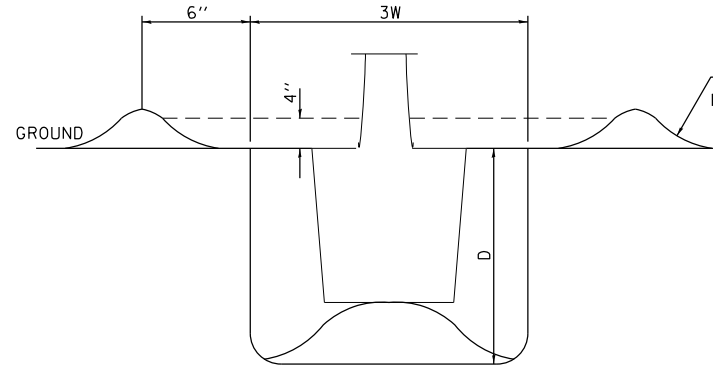

SINGLE PLANT

PLANTING DETAIL MULCH AND WATER RING

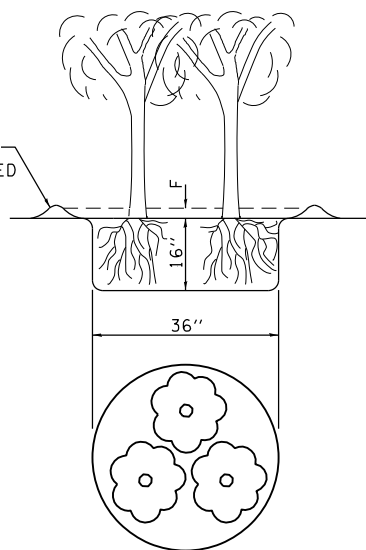

GROUPED PLANTS

INFORMATION ONLY

COMMON NAME	LATIN NAME
WHITE PINE	Pinus strobus
TULIP POPLAR	Liriodendron tulipifera
WHITE OAK	Quercus alba
PIN OAK	Quercus palustris
RED OAK	Quercus rubra
SUGAR MAPLE	Acer saccharum
RED MAPLE	Acer Rubrum
SWEET GUM	Liquidambar styraciflua
DOGWOOD	cornus florida
ASH	Fraxinus americana (Sps.)
CRAB APPLE	Malus sps.
RIVER BIRCH	Betula nigra
WITCH HAZEL	Hamamelis virginiana
RED BUD	Cercis canadensis
BRADFORD PEAR	Pyrus calleryana bradford
SHAGBARK HICKORY	Carya ovata
PINK FLOWERING DOGWOOD	Cornus florida rubra
WHITE CRAB APPLE	Malus snowdrift
NORWAY SPRUCE	Picea abies
TALL HEDGE (SHRUB)	Rhamnus fragula "columnaris"

SPACE LIMITATIONS IN THE ABBREVIATED PAY ITEM DESCRIPTION PRECLUDED SHOWING THE SIZES, YEARS OF GROWTH, AND OTHER CHARACTERISTICS OF TREES, SHRUBS, EVERGREENS AND VINES. THEREFORE, THESE CHARACTERISTICS HAVE BEEN CODED AS SHOWN FOR EACH CATEGORY OF PLANTS.

AN EXAMPLE OF THE APPLICATION OF PREFIX AND CODE IS:

CODE NUMBER ITEM (long description - short description)
A1002008 ACER SACCHARINUM 08 - ACER SACCINUM 08

A - IN THE CODE NUMBER INDICATES THE PREFIX
08 - IN THE ITEM DESCRIPTION IS FOR THE SIZE OF TREE (IN THIS CASE 2 - 2 1/2 INCH DIAMETER)

CODE	SIZE INCH DIAMETER	
01	1 1/4 - 1 1/2	
02	1 1/4 - 1 1/2	BB
03	1 1/2 - 1 3/4	
04	1 1/2 - 1 3/4	BB
05	1 3/4 - 2	
06	1 3/4 - 2	BB
07	2 - 2 1/2	
08	2 - 2 1/2	BB
09	2 1/2 - 3	
10	2 1/2 - 3	BB
11	3 - 3 1/2	
12	3 - 3 1/2	BB
13	3 1/2 - 4	
14	3 1/2 - 4	BB
15	4 - 4 1/2	
16	4 - 4 1/2	BB
17	4 1/2 - 5	
18	4 1/2 - 5	BB
19	5 - 5 1/2	
20	5 - 5 1/2	BB
21	5 1/2 - 6	
22	5 1/2 - 6	BB
23	6 - 7	
24	6 - 7	BB

NOTES: SIZES ARE BARE ROOT EXCEPT WHEN FOLLOWED BY "BB" WHICH INDICATE BALL AND BURLAP.

CODE	SIZE HEIGHT IN FEET	
01	1 1/2 - 2	BB
02	2 - 2 1/2	BB
03	2 1/2 - 3	BB
04	3 - 3 1/2	BB
05	3 1/2 - 4	BB
06	4 - 5	BB
07	5 - 6	BB
08	6 - 7	BB
09	7 - 8	BB
10	8 - 9	BB

BB = BALL AND BURLAP OR IN POTS

VINES/GROUNDCOVERS (PREFIX "E")

CODE	SIZE	
01	1 YR. # 1	
02	1 YR. # 1	BB
03	2 YR. # 1	
04	2 YR. # 1	BB
05	3 YR. # 1	
06	3 YR. # 1	BB
07	4 YR. # 1	
08	4 YR. # 1	BB
09	5 YR. # 1	
10	5 YR. # 1	BB

BB = BALL AND BURLAP OR IN POTS

INTERMEDIATE TREES (PREFIX "B")

CODE	SIZE HEIGHT IN FEET	
01	1 1/2 - 2	BB
02	1 1/2 - 2	BB
03	2 - 3	BB
04	2 - 3	BB
05	3 - 4	BB
06	3 - 4	BB
07	4 - 5	BB
08	4 - 5	BB
09	5 - 6	BB
10	5 - 6	BB
11	6 - 7	BB
12	6 - 7	BB
13	7 - 8	BB
14	7 - 8	BB
15	8 - 9	BB
16	8 - 9	BB
17	9 - 10	BB
18	9 - 10	BB
19	10 - 12	BB
20	10 - 12	BB
21	12 - 14	BB
22	12 - 14	BB
23	14 - 16	BB
24	14 - 16	BB

NOTES: SIZES ARE BARE ROOT EXCEPT WHEN FOLLOWED BY "BB" WHICH INDICATE BALL AND BURLAP.

SEEDLING TREES (PREFIX "F")

CODE	SIZE YEARS OF GROWTH & TIMES TRANSPLANTED "T"	
01	1 YR.	
02	2 YR.	
03	3 YR. T	
04	2 YR. T	
05	2 - 3'	BR
06	3 - 4'	BR
07	4 - 6'	BR
08	6 - 8'	BR
09	12 - 18"	
10	18 - 24"	

BR = "WHIPS" OR "LINERS"

SEEDLING SHRUBS (PREFIX "G")

CODE	SIZE CROWN DIAMETER IN INCHES, YEARS OF GROWTH & TIMES TRANSPLANTED "T"
01	1/8 - 3/16
02	3/16 - 1/4
03	1/4 - 3/8
04	1 YR. T
05	1/2 - 3/4
06	2 YR. T

SHRUBS (PREFIX "C")

CODE	SIZE HEIGHT IN FEET	
01	1 1/2 - 2	
02	1 1/2 - 2	BB
03	2 - 3	
04	2 - 3	BB
05	3 - 4	
06	3 - 4	BB
07	4 - 5	
08	4 - 5	BB
09	5 - 6	
10	5 - 6	BB
11	6 - 7	
12	6 - 7	BB

NOTES: SIZES ARE BARE ROOT EXCEPT WHEN FOLLOWED BY "BB" WHICH INDICATE BALL AND BURLAP.

SEEDLING EVERGREENS (PREFIX "H")

CODE	SIZE YEARS OF GROWTH & TIMES TRANSPLANTED "T"
01	1 YR.
02	2 YR.
03	2 YR. T
04	3 YR.
05	3 YR. T

NOT TO SCALE

FILE NAME =	USER NAME = steffennk	DESIGNED -	REVISED - MMO 12-99
		REVISED -	REVISED - MKS 04-08
PLOT SCALE = 100.0000' / in.	CHECKED -	REVISED -	REVISED -
PLOT DATE = 10/16/2020	DATE -	REVISED -	REVISED -

STATE OF ILLINOIS
DEPARTMENT OF TRANSPORTATION

PLANTING DETAILS

SCALE: SHEET NO. OF SHEETS STA. TO STA.

DISTRICT 7 DETAIL NO. 2530000

F.A.S. RTE.	SECTION	COUNTY	TOTAL SHEETS	SHEET NO.
1751	(Y-2,P-2)RS	FAYETTE	19	14
CONTRACT NO. 74721				
FED. ROAD DIST. NO. ILLINOIS FED. AID PROJECT				

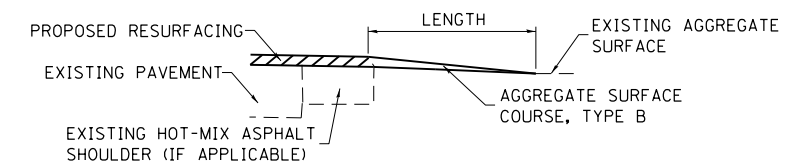
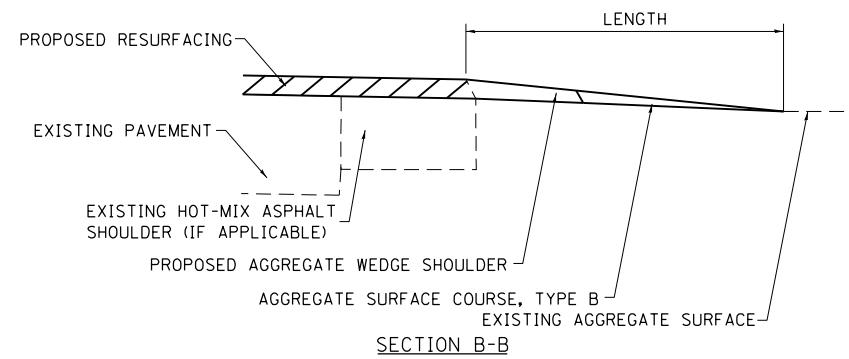
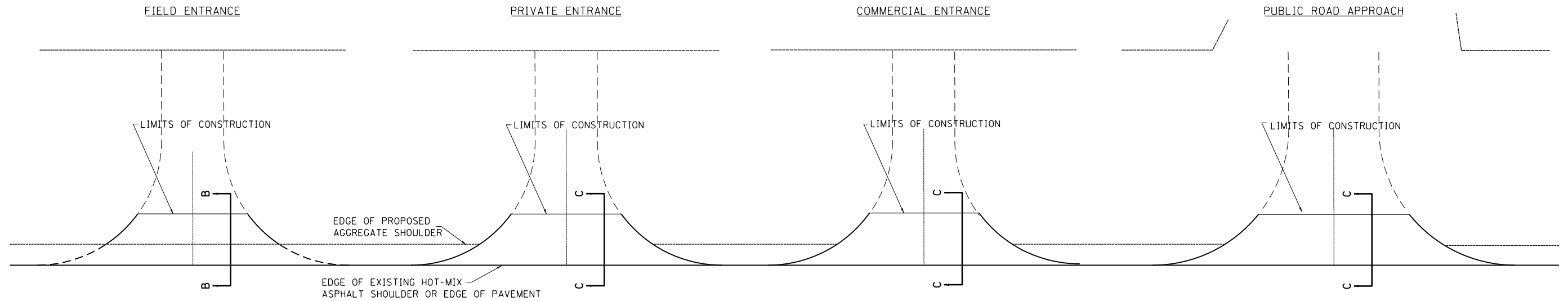

SECTION C-C

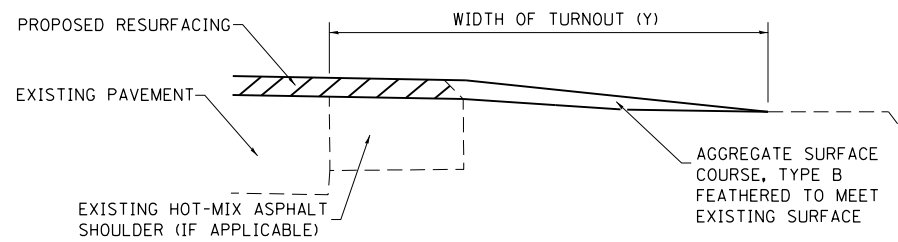

TYPICAL SECTION AT MAILBOX TURNOUT

NOTE: SEE STANDARD 406201 FOR MAILBOX TURNOUT DETAILS

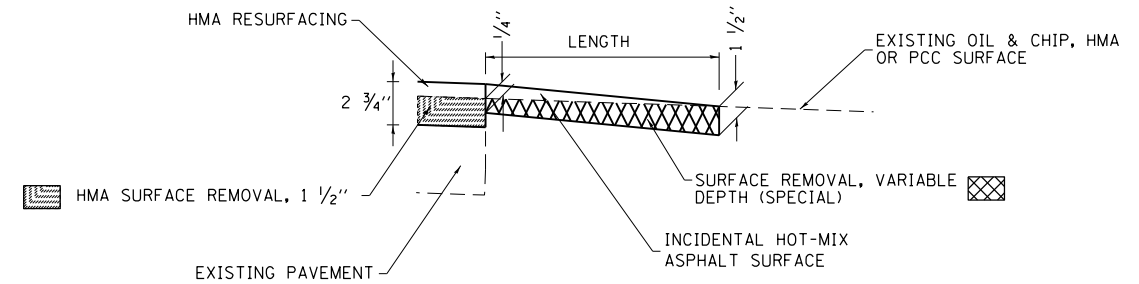

SECTION C-C

NOTES

LENGTH = 10' UNLESS OTHERWISE NOTED ON PLANS

IF THERE IS NOT EXISTING HOT-MIX ASPHALT SHOULDER THEN THE ENTRANCE TAPER STARTS AT THE EDGE OF EXISTING PAVEMENT.

MODEL: Default
 FILE: h:\mhc\p\pub\haronom.dwg
 PROJECT: 74721\CAD\DATA\CAD\harses\DOT\Office\Drawings\74721\74721-1-shd-draw.dwg

USER NAME = steffenmk	DESIGNED -	REVISED -
	DRAWN -	REVISED -
PLOT SCALE = 100.0000' / in.	CHECKED -	REVISED -
PLOT DATE = 10/16/2020	DATE -	REVISED -

STATE OF ILLINOIS
DEPARTMENT OF TRANSPORTATION

RURAL ENTRANCE AND MAILBOX TURNOUT DETAILS
WITH SHOULDERS

SCALE: SHEET OF SHEETS STA. TO STA.

F.A.S. RTE.	SECTION	COUNTY	TOTAL SHEETS	SHEET NO.
1751	(Y-2,P)-R5	FAYETTE	19	15
CONTRACT NO. 74721				
ILLINOIS FED. AID PROJECT				

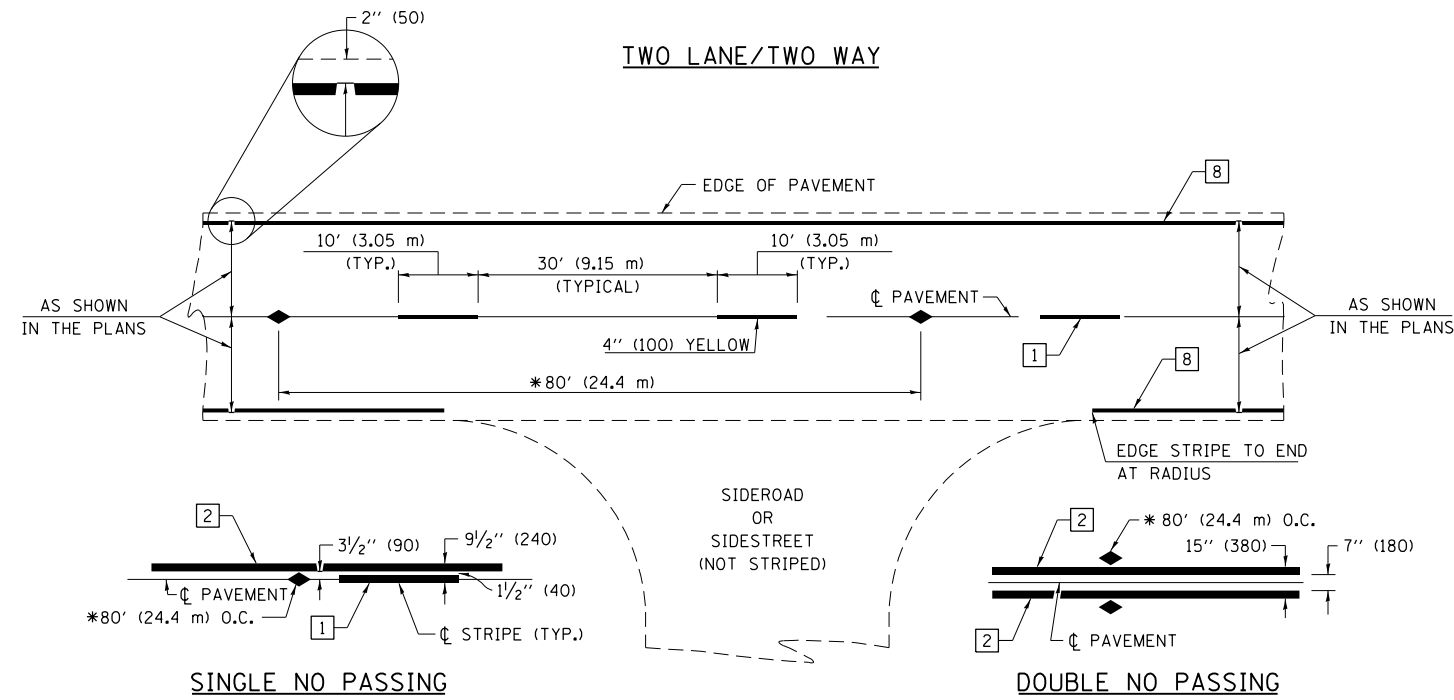

* REDUCE TO 40' (12.2 m) O.C. ON CURVES WITH POSTED OR ADVISORY SPEEDS OF 45 mph (70 km/h) OR LESS.

PAVEMENT MARKING LEGEND

- 1 4" (100) SKIP-DASH (YELLOW)
- 2 4" (100) SOLID (YELLOW)
- 3 12" (300) DIAGONAL (YELLOW)
- 4 4" (100) DOUBLE YELLOW (NARROW)
- 5 12" (300) SOLID WHITE
- 6 RESERVED
- 7 6" (150) SKIP-DASH (WHITE)
- 8 4" (100) SOLID (WHITE)
- 9 12" (300) DIAGONAL (WHITE)
- 10 6" (150) SOLID (WHITE)
- 11 24" (600) STOP BAR (WHITE)
- 12 8" (200) SOLID (WHITE)
- 13 4" (100) PARKING WHITE

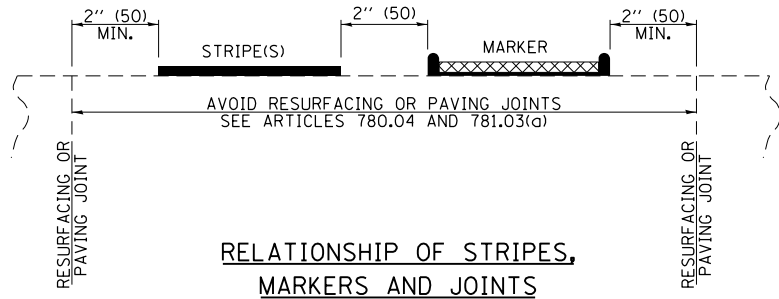

RELATIONSHIP OF STRIPES, MARKERS AND JOINTS

TYPICAL PAVEMENT MARKERS LEGEND

- ◆ TWO-WAY AMBER MARKER
- ▶ ONE-WAY AMBER MARKER
- ▷ ONE-WAY CRYSTAL MARKER

RAISED REFLECTIVE PAVEMENT MARKERS

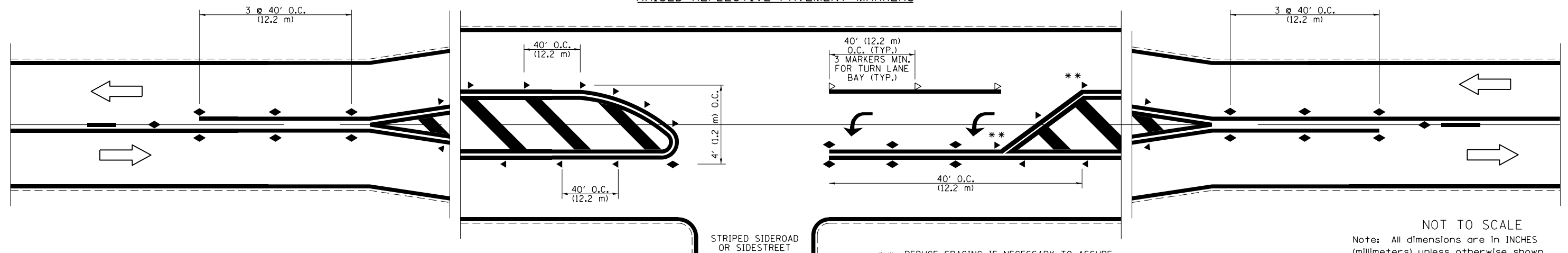

** REDUCE SPACING IF NECESSARY TO ASSURE MARKERS AT CORNER POINTS.

NOT TO SCALE
Note: All dimensions are in INCHES (millimeters) unless otherwise shown.

DISTRICT 7 DETAIL NO. 7800001

FILE NAME =	USER NAME = steffenmk	DESIGNED -	REVISED -
pw:\planning\dot.illinois.gov\PWIDOT\Documents\IDOT Offices\District 7\Projects\74721\CDRAW\CADsheets\0774721-sht-details.dgn		REVISOR -	REVISED -
	PLOT SCALE = 100.0000' / in.	CHECKED -	REVISED -
	PLOT DATE = 10/16/2020	DATE -	REVISED -

STATE OF ILLINOIS
DEPARTMENT OF TRANSPORTATION

PAVEMENT MARKING AND RAISED REFLECTIVE PAVEMENT MARKERS
(RURAL & URBAN APPLICATIONS)

SCALE: SHEET NO. 1 OF 4 SHEETS STA. TO STA.

F.A.S. RTE.	SECTION	COUNTY	TOTAL SHEETS	SHEET NO.
1751	(Y-2,P-2)RS	FAYETTE	19	16
CONTRACT NO. 74721				
ILLINOIS FED. AID PROJECT				

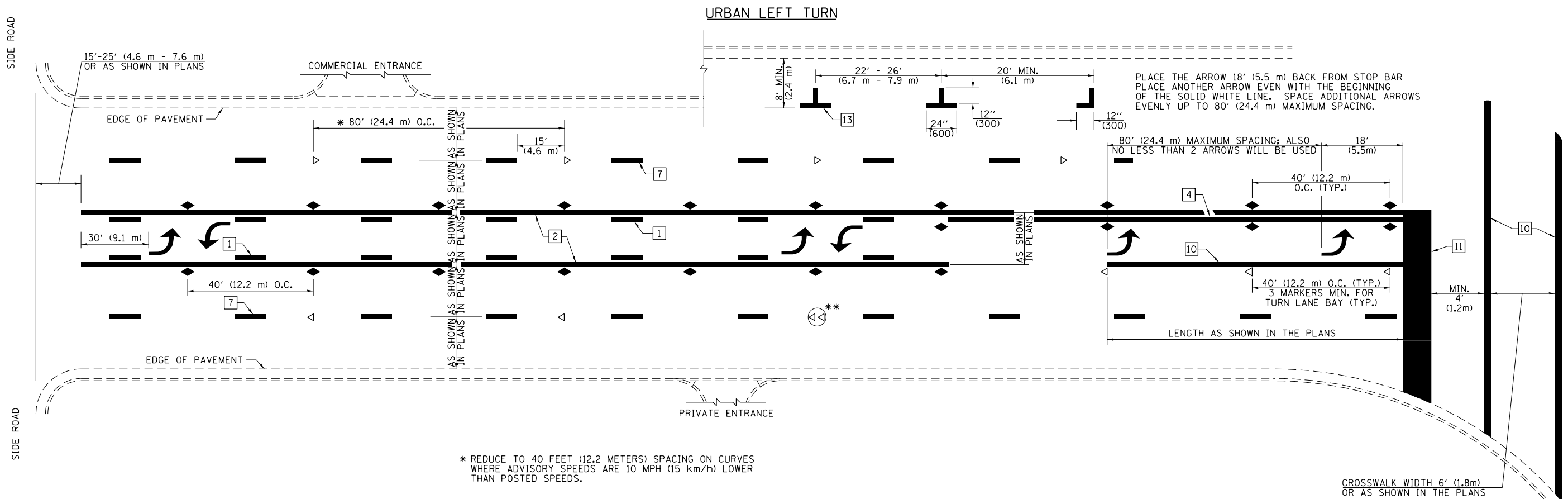

PLACE THE ARROW 18' (5.5 m) BACK FROM STOP BAR
 PLACE ANOTHER ARROW EVEN WITH THE BEGINNING
 OF THE SOLID WHITE LINE. SPACE ADDITIONAL ARROWS
 EVENLY UP TO 80' (24.4 m) MAXIMUM SPACING.

* REDUCE TO 40 FEET (12.2 METERS) SPACING ON CURVES
 WHERE ADVISORY SPEEDS ARE 10 MPH (15 km/h) LOWER
 THAN POSTED SPEEDS.

** DOUBLE LANE LINE MARKERS SHALL BE SPECIFIED
 AND SPACED AS SHOWN IN HIGHWAY STANDARD
 781001 FOR MULTI-LANE DIVIDED AND UNDIVIDED
 HIGHWAYS.

PAVEMENT MARKING LEGEND

- 1 4" (100) SKIP-DASH (YELLOW)
- 2 4" (100) SOLID (YELLOW)
- 3 12" (300) DIAGONAL (YELLOW)
- 4 4" (100) DOUBLE YELLOW (NARROW)
- 5 12" (300) SOLID WHITE
- 6 RESERVED
- 7 6" (150) SKIP-DASH (WHITE)
- 8 4" (100) SOLID (WHITE)
- 9 12" (300) DIAGONAL (WHITE)
- 10 6" (150) SOLID (WHITE)
- 11 24" (600) STOP BAR (WHITE)
- 12 8" (200) SOLID (WHITE)
- 13 4" (100) PARKING WHITE

GENERAL NOTES

1. TURN ARROW PAIRS SHALL BE PLACED AT 250' (75 m) INTERVALS AND SHALL BE EVENLY SPACED BETWEEN BOTH ENDS OF THE BIDIRECTIONAL LEFT TURN LANE. USE A MINIMUM OF TWO PAIRS PER BLOCK.
2. THE SOLID YELLOW PAVEMENT MARKINGS [2] SHOULD GENERALLY START OR END NEAR THE RADIUS POINT OF EACH STREET RETURN EXCEPT WHERE ONE OR BOTH ENDS WOULD INCLUDE STOP BARS.
3. THE SKIP-DASH PAVEMENT MARKINGS [1] OR [7] SHOULD BE CENTERED BETWEEN BOTH ENDS OF EACH CITY BLOCK AND SHALL BE PLACED SO THEY LINE UP ACROSS FROM EACH OTHER.
4. USE LARGE ARROW SIZE FOR BOTH RURAL AND URBAN LOCATIONS. (SEE LAST PAGE OF SECTION 780x FOR SYMBOLS TABLE)
5. LANE LINE EXTENSIONS SHALL BE THE SAME COLOR AND WIDTH AS THE LANE LINE BEING EXTENDED.

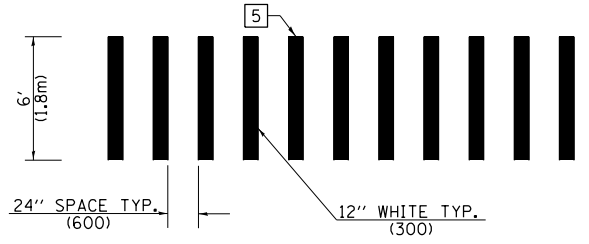

**CROSSWALK DETAIL
 (DECATUR CITY LIMITS ONLY)**

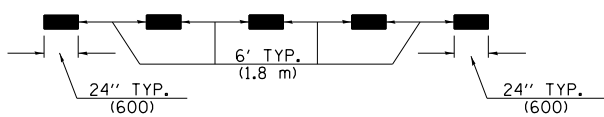

LANE LINE EXTENSIONS

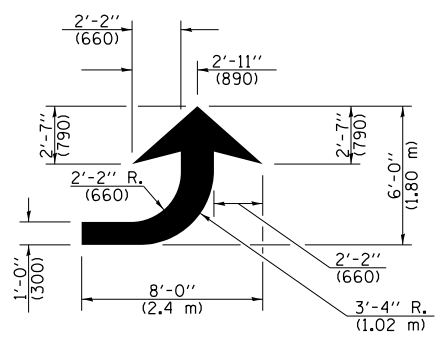

LEFT ARROW
 REVERSE FOR RIGHT ARROW
 AREA = 15.6 SQ. FT. (1.47 m²)
 (WHITE)

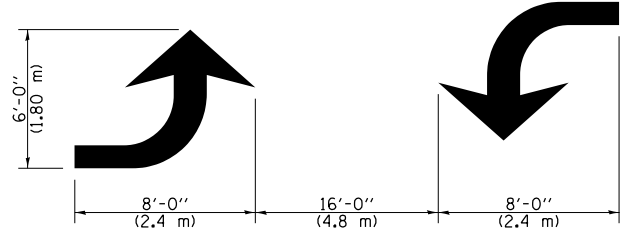

**TYPICAL DOUBLE
 TURN ARROWS (WHITE)**

NOT TO SCALE

Note: All dimensions are in INCHES
 (millimeters) unless otherwise shown.

DISTRICT 7 DETAIL NO. 7800001

FILE NAME =	USER NAME = steffennk	DESIGNED -	REVISED -	STATE OF ILLINOIS DEPARTMENT OF TRANSPORTATION	PAVEMENT MARKING AND RAISED REFLECTIVE PAVEMENT MARKERS (RURAL & URBAN APPLICATIONS)	F.A.S. RTE.	SECTION	COUNTY	TOTAL SHEETS	SHEET NO.	
pw\planroom.dot.illinois.gov\PIWIDOT\Documents\IDOT Offices\District 7\Projects\74721\CAD\CAD sheets\0774721-sht-details.dgn	100.0000' / in.	CHECKED -	REVISED -			1751	(Y-2,P-2)RS	FAYETTE	19	17	
PLOT SCALE =	DATE = 10/16/2020	DATE -	REVISED -			CONTRACT NO. 74721					
						ILLINOIS FED. AID PROJECT					

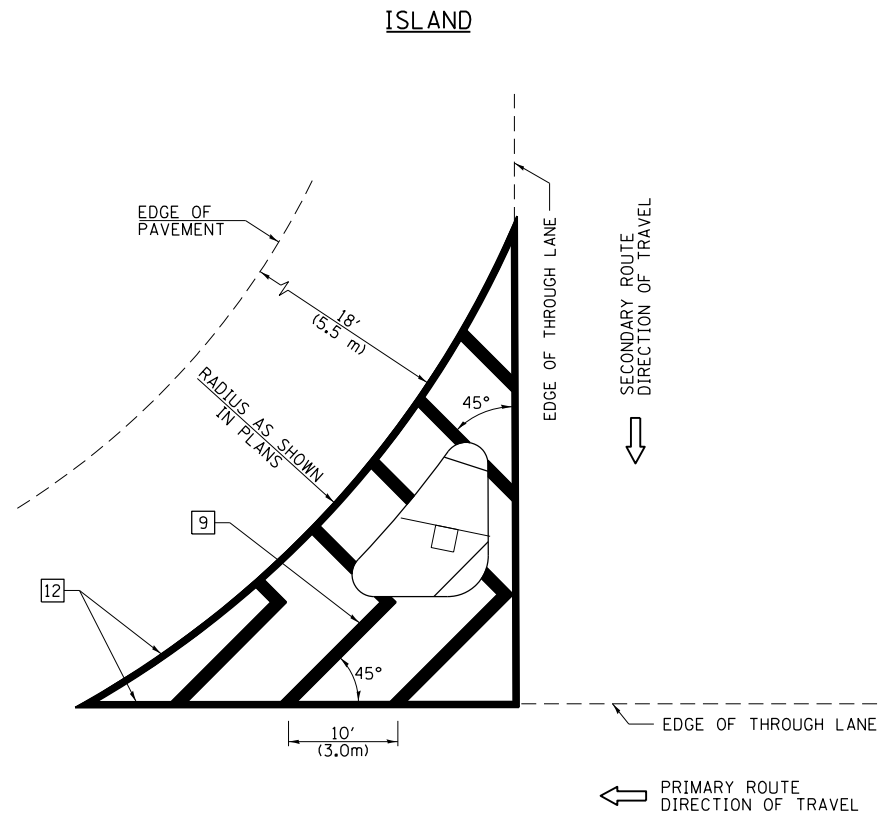

GENERAL NOTES

1. RAISED AND CORRUGATED MEDIANS SHALL BE OUTLINED WITH [2] IF PRESENT.
2. SOME OF THE INFORMATION INCLUDED WITH THIS DETAIL MAY NOT BE APPLICABLE TO THIS IMPROVEMENT.
3. PAVEMENT MARKINGS ARE TO BE EXTENDED THROUGH OMISSIONS WHEN APPLICABLE.
4. FINAL PAVEMENT MARKINGS SHALL BE IN PLACE PRIOR TO PLACING ANY RAISED REFLECTIVE PAVEMENT MARKERS.
5. THE FOLLOWING CRITERIA SHALL BE USED FOR SELECTING THE DIAGONAL PAVEMENT MARKING SPACING:

< 30 MPH (< 50 km/h)	15' (4.5 m)
30-45 MPH (50-75 km/h)	20' (6.0 m)
>45 MPH (>75 km/h)	30' (9.0 m)

PAVEMENT MARKING LEGEND

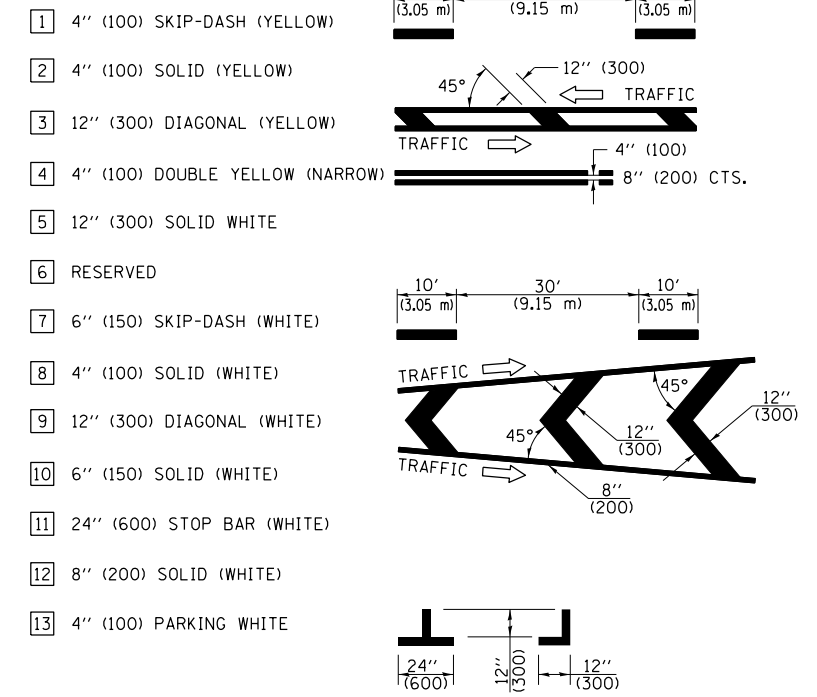

RURAL LEFT TURN STRIPING

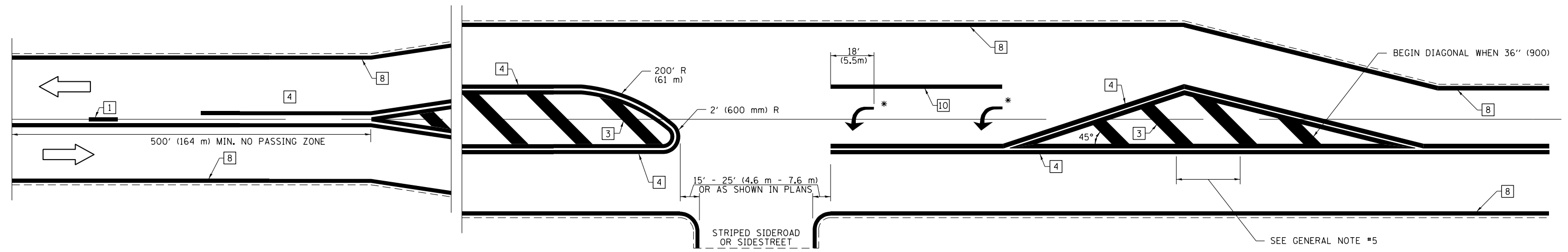

* PLACE AN ARROW 18' (5.5 m) BACK FROM STOP BAR. PLACE ANOTHER ARROW EVEN WITH THE BEGINNING OF THE SOLID WHITE LINE. SPACE ADDITIONAL ARROWS EVENLY UP TO 80' (24.4 m) MAXIMUM SPACING. USE MINIMUM OF 2 ARROWS.

SEE GENERAL NOTE #5

NOT TO SCALE

Note: All dimensions are in INCHES (millimeters) unless otherwise shown.

DISTRICT 7 DETAIL NO. 7800001

FILE NAME =	USER NAME = steffenmk	DESIGNED -	REVISED -
pw:\planroom.dot.illinois.gov\PIDOT\Documents\IDOT Offices\District 7\Projects\74721\CBRAW\CADsheets\0774721-sht-details.dgn		REVISION	REVISION
	PLOT SCALE = 100.0000' / in.	CHECKED -	REVISED -
	PLOT DATE = 10/16/2020	DATE -	REVISED -

**STATE OF ILLINOIS
DEPARTMENT OF TRANSPORTATION**

**PAVEMENT MARKING AND RAISED REFLECTIVE PAVEMENT MARKERS
(RURAL & URBAN APPLICATIONS)**

SCALE: SHEET NO. 1 OF 2 SHEETS STA. TO STA.

F.A.S. RTE.	SECTION	COUNTY	TOTAL SHEETS	SHEET NO.
1751	(Y-2,P-2)RS	FAYETTE	19	18
CONTRACT NO. 74721				
ILLINOIS FED. AID PROJECT				

PAVEMENT MARKINGS AT RAILROAD-HIGHWAY GRADE CROSSING

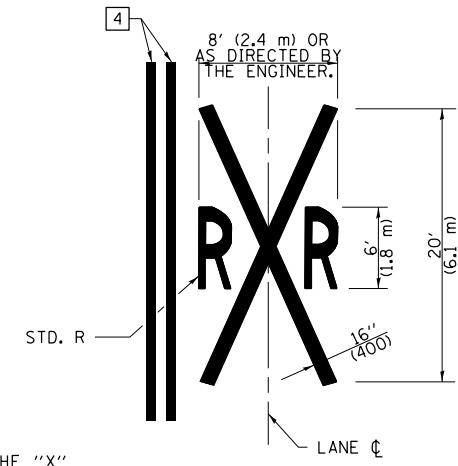
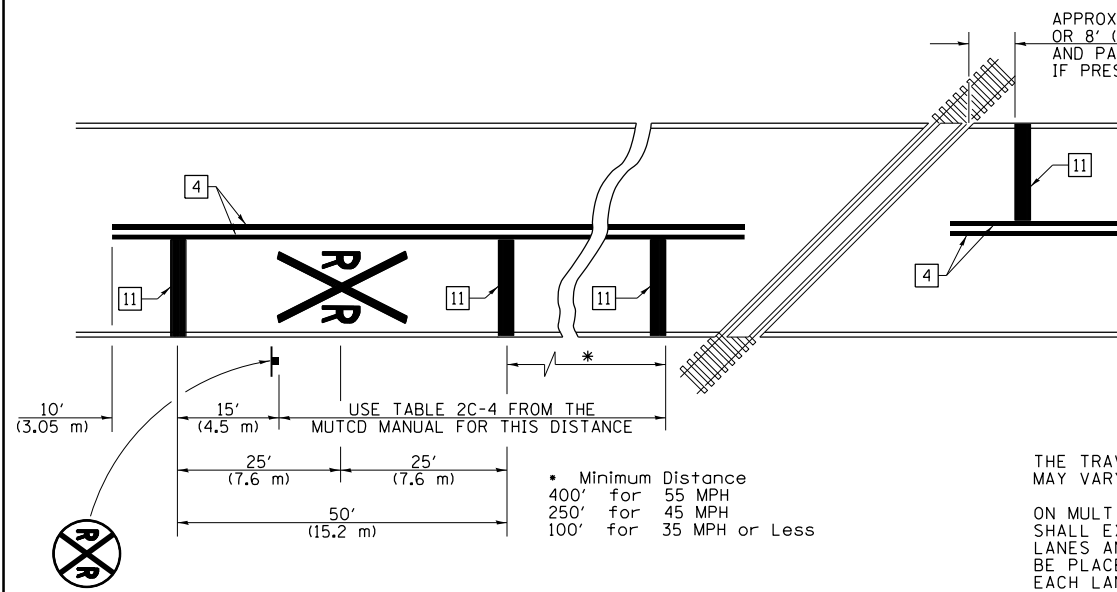

NOTES

THE TRAVERSE SPREAD OF THE "X" MAY VARY ACCORDING TO LANE WIDTH.

ON MULTI-LANE ROADS, THE STOP LINES SHALL EXTEND ACROSS ALL APPROACH LANES AND SEPARATE RXR SYMBOLS SHALL BE PLACED ADJACENT TO EACH OTHER IN EACH LANE.

WHEN THE PAVEMENT MARKING SYMBOL IS USED, A PORTION OF THE SYMBOL SHOULD BE LOCATED DIRECTLY ADJACENT TO THE ADVANCE WARNING SIGN (W10-1) AS PLACED BY TABLE II-1, CONDITION B OF THE MUTCD.

PAVEMENT MARKING LEGEND

- 1 4" (100) SKIP-DASH (YELLOW)
- 2 4" (100) SOLID (YELLOW)
- 3 12" (300) DIAGONAL (YELLOW)
- 4 4" (100) DOUBLE YELLOW (NARROW)
- 5 12" (300) SOLID WHITE
- 6 RESERVED
- 7 6" (150) SKIP-DASH (WHITE)
- 8 4" (100) SOLID (WHITE)
- 9 12" (300) DIAGONAL (WHITE)
- 10 6" (150) SOLID (WHITE)
- 11 24" (600) STOP BAR (WHITE)
- 12 8" (200) SOLID (WHITE)
- 13 4" (100) PARKING WHITE

RAILROAD CROSSING WITH INTERCONNECT ONLY

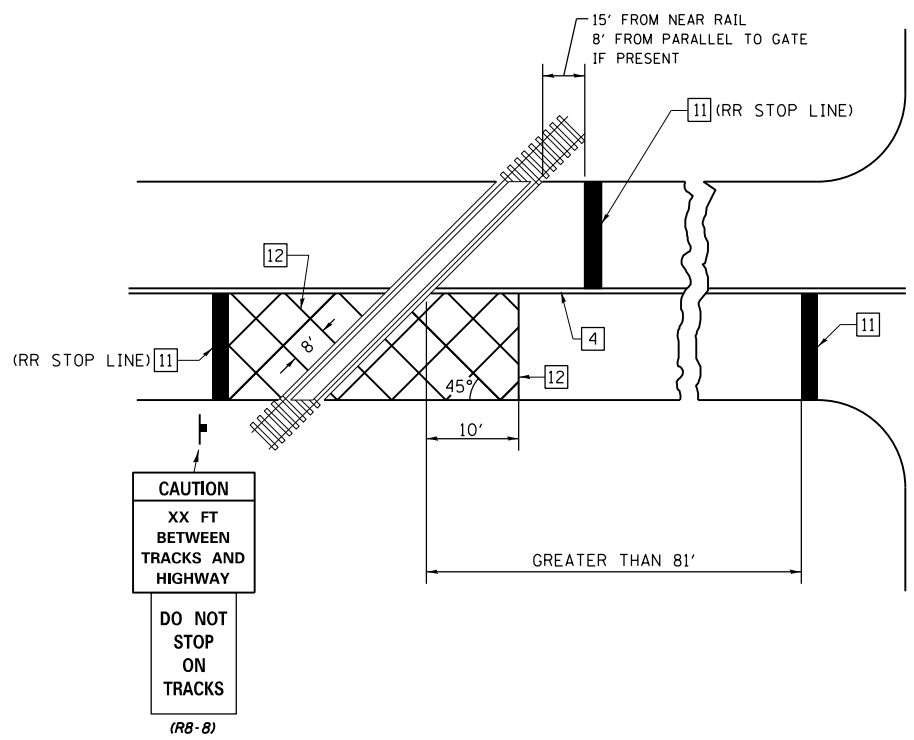

RAILROAD CROSSING WITH INTERCONNECT AND PRE-SIGNALS

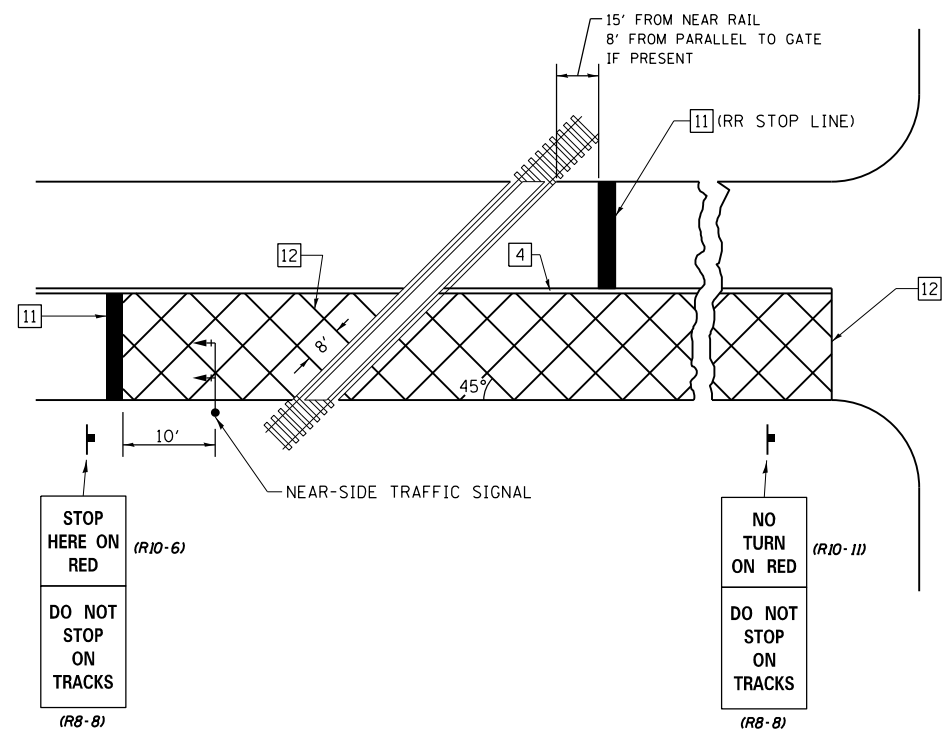

GENERAL NOTES

1. SUPPLEMENTAL PAVEMENT MARKINGS TO BE INSTALLED ONLY ON APPROACHES TO INTERSECTIONS CONTROLLED BY TRAFFIC SIGNALS WHICH ARE INTERCONNECTED WITH THE RAILROAD WARNING SIGNALS.
2. EXTEND PAVEMENT MARKINGS TO THE INTERSECTION ONLY WHERE NEAR-SIDE TRAFFIC SIGNALS ARE USED.

SUPPLEMENTAL PAVEMENT MARKING TREATMENT FOR RAILROAD-HIGHWAY GRADE CROSSING

NOT TO SCALE

Note: All dimensions are in INCHES (millimeters) unless otherwise shown.

DISTRICT 7 DETAIL NO. 7800001

FILE NAME =	USER NAME = steffenmk	DESIGNED -	REVISED -	STATE OF ILLINOIS DEPARTMENT OF TRANSPORTATION	PAVEMENT MARKING AND RAISED REFLECTIVE PAVEMENT MARKERS (RURAL & URBAN APPLICATIONS)	F.A.S. RTE.	SECTION	COUNTY	TOTAL SHEETS	SHEET NO.
pw:\planroom.dot.illinois.gov\PIWIDOT\Documents\IDOT Offices\District 7\Projects\74721\CAD\CAD sheets\0774721-sht-details.dgn	1751	(Y-2,P-2)RS	FAYETTE			19	19			
PLOT SCALE = 100.0000' / 1in.	CHECKED -	REVISED -	CONTRACT NO. 74721							
PLOT DATE = 10/16/2020	DATE -	REVISED -	ILLINOIS FED. AID PROJECT							