

SEE SHEET NO. 2 FOR INDEX OF SHEETS

STATE OF ILLINOIS
DEPARTMENT OF TRANSPORTATION

**PROPOSED
HIGHWAY PLANS**

**CH 24 (STATE RD)
SECTION 24RS-1
BITUMINOUS SURFACE TREATMENT CLASS A-2
FROM IL 267 TO SOUTH ST IN ROCKBRIDGE
GREENE COUNTY**

C-98-126-20

TRAFFIC DATA

IL 267 TO COUNTY ROAD
2017 ADT (ACTUAL): 275
2021 ADT (ESTIMATED): 275
2041 ADT (ESTIMATED): 325
SU: 1.2
MU: 0.1%

COUNTY ROAD TO SOUTH STREET
2017 ADT (ACTUAL): 225
2021 ADT (ESTIMATED): 225
2041 ADT (ESTIMATED): 275
SU: 1.2%
MU: 0.1%

BEGIN PROJECT
0.00 MI.
LAT: 39.280833
LONG: -90.205717

END PROJECT
0.82 MI.
LAT: 39.269210
LONG: -90.204294

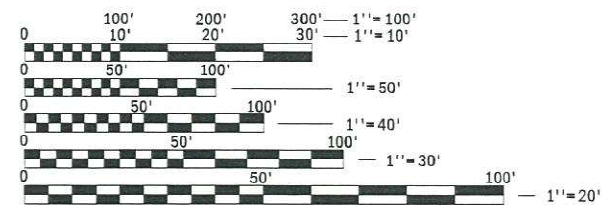

FULL SIZE PLANS HAVE BEEN PREPARED USING STANDARD ENGINEERING SCALES. REDUCED SIZED PLANS WILL NOT CONFORM TO STANDARD SCALES. IN MAKING MEASUREMENTS ON REDUCED PLANS, THE ABOVE SCALES MAY BE USED.

J.U.L.I.E.
JOINT UTILITY LOCATION INFORMATION FOR EXCAVATION
1-800-892-0123
OR 811

PROJECT ENGINEER: TIFFANY BRASE (618) 346-3175
PROJECT MANAGER: SILVIA ESTEVES (618) 346-3191

CONTRACT NO. 76N87

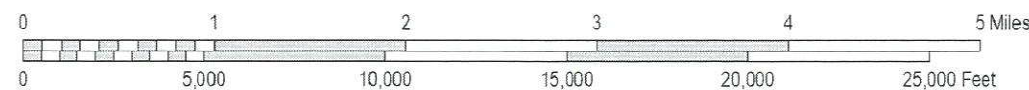
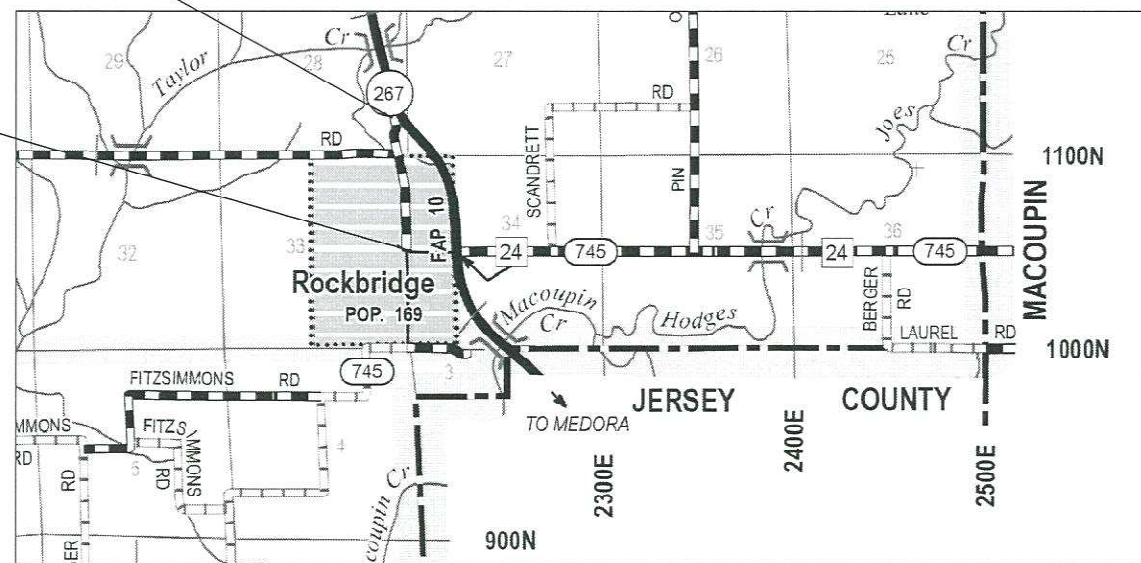

GROSS LENGTH = 4329.6 FEET = 0.82 MILES
NET LENGTH = 4329.6 FEET = 0.82 MILES

C.H. RTE.	SECTION	COUNTY	TOTAL SHEETS	SHEET NO.
24	24RS-1	GREENE	6	1
		ILLINOIS	CONTRACT NO. 76N87	

D-98-116-20

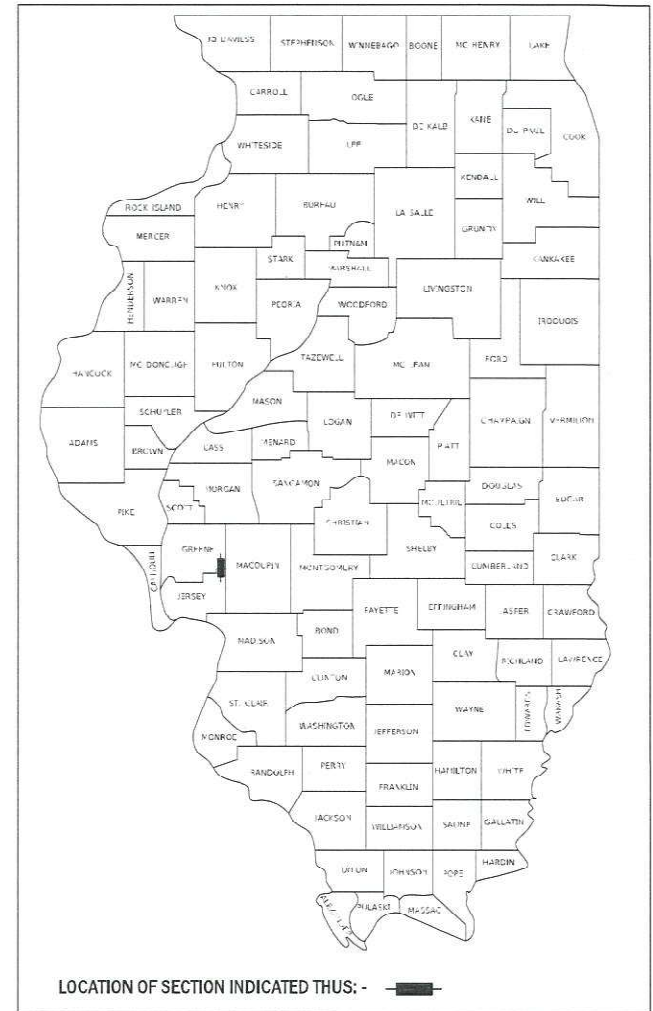

LOCATION OF SECTION INDICATED THIS: - [black rectangle]

STATE OF ILLINOIS
DEPARTMENT OF TRANSPORTATION

SUBMITTED October 8, 2020
K. Robertz
REGIONAL ENGINEER

December 4, 2020
S. E. A. Elk
ENGINEER OF DESIGN AND ENVIRONMENT

December 4, 2020
Gerald J. J...
DIRECTOR OF HIGHWAYS PROJECT IMPLEMENTATION

PRINTED BY THE AUTHORITY
OF THE STATE OF ILLINOIS

MODEL: s:\MODEL\MRF5
 FILE NAME: p:\pub\mcom\ma.dta\illinois.gov\PWIDOT\Documents\IDOT_Offices\IDOT\Projects\IDOT_76N87\CADDData\CAD\Sheet\IDOT_76N87-sh-500.dgn

100%
STATE

CODE NO.	ITEM	UNIT	TOTAL QUANTITY	CONSTR. CODE
				ROADWAY 0005 RURAL
40300400	BITUMINOUS MATERIALS (COVER AND SEAL COATS)	TON	30	30
40300500	COVER COAT AGGREGATE	TON	101	101
40300600	SEAL COAT AGGREGATE	TON	101	101
67100100	MOBILIZATION	L SUM	1	1
70100460	TRAFFIC CONTROL AND PROTECTION, STANDARD 701306	L SUM	1	1

USER NAME = ESTEVESST	DESIGNED - _____	REVISED - _____
	DRAWN - _____	REVISED - _____
PLOT SCALE = 100.0000' / in.	CHECKED - _____	REVISED - _____
PLOT DATE = 10/6/2020	DATE - _____	REVISED - _____

**STATE OF ILLINOIS
DEPARTMENT OF TRANSPORTATION**

SUMMARY OF QUANTITIES

SCALE: _____ SHEET 1 OF 1 SHEETS STA. _____ TO STA. _____

C.H. RTE.	SECTION	COUNTY	TOTAL SHEETS	SHEET NO.
24	24RS-1	GREENE	6	3
			CONTRACT NO. 76N87	
ILLINOIS				

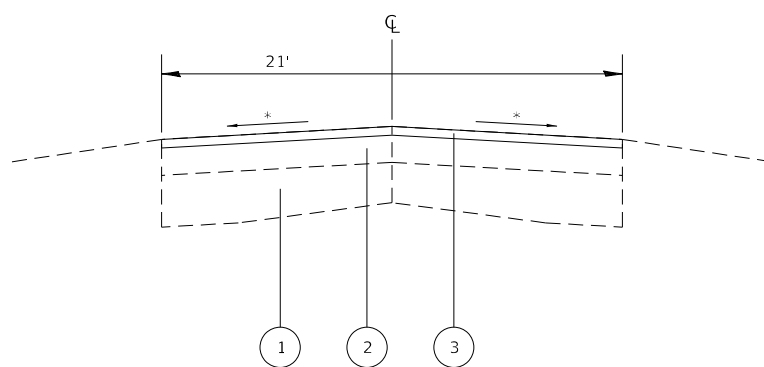

TYPICAL SECTION

0.00 MI. TO 0.82 MI.

LEGEND

- ① EXISTING CONCRETE PAVEMENT
- ② EXISTING BITUMINOUS SURFACE
- ③ PROPOSED BITUMINOUS SURFACE TREATMENT CLASS A-2

* MATCH EXISTING

MODEL: I:\MODEL\MAR15
 FILE: MAR15_Plan\Illinois\ma.dwg:PWIDOT\Documents\DOT_Offices\District 8\Projects\ID76N87\CADDData\CAD\Sheet\ID76N87-shc-typical.dgn

USER NAME = ESTEVESST	DESIGNED - _____	REVISED - _____
	DRAWN - _____	REVISED - _____
PLOT SCALE = 100.0000' / in.	CHECKED - _____	REVISED - _____
PLOT DATE = 10/6/2020	DATE - _____	REVISED - _____

**STATE OF ILLINOIS
 DEPARTMENT OF TRANSPORTATION**

TYPICAL SECTIONS

SCALE: _____ SHEET 1 OF 1 SHEETS STA. _____ TO STA. _____

C.H. RTE.	SECTION	COUNTY	TOTAL SHEETS	SHEET NO.
24	24RS-1	GREENE	6	4
			CONTRACT NO. 76N87	
ILLINOIS				

BITUMINOUS SURFACE TREATMENT CLASS A-2 SCHEDULE

LOCATION			LENGTH	WIDTH	BITUMINOUS MATERIALS (COVER AND SEAL COATS)	COVER COAT AGGREGATE	SEAL COAT AGGREGATE
MM	TO	MM	(FOOT)	(FOOT)	(TON)	(TON)	(TON)
0.00	TO	0.82	4329.60	21	29.50	101.02	101.02
TOTAL					30	101	101

MODEL: s:\MODEL\MATFS
FILE NAME: p:\p\illinois\mtda\illinois.gov\PWIDOT\Documents\DOT_Offices\Dir\ctc B\Projects\076N87\CADD\ataCAD\papers\076N87-shc-schedule.dgn

USER NAME = ESTEVESST	DESIGNED - _____	REVISED - _____
	DRAWN - _____	REVISED - _____
PLOT SCALE = 100.0000 ' / in.	CHECKED - _____	REVISED - _____
PLOT DATE = 10/6/2020	DATE - _____	REVISED - _____

**STATE OF ILLINOIS
DEPARTMENT OF TRANSPORTATION**

SCHEDULES OF QUANTITIES

SCALE: _____ SHEET 1 OF 1 SHEETS STA. _____ TO STA. _____

C.H. RTE.	SECTION	COUNTY	TOTAL SHEETS	SHEET NO.
24	24R5-1	GREENE	6	5
ILLINOIS			CONTRACT NO. 76N87	

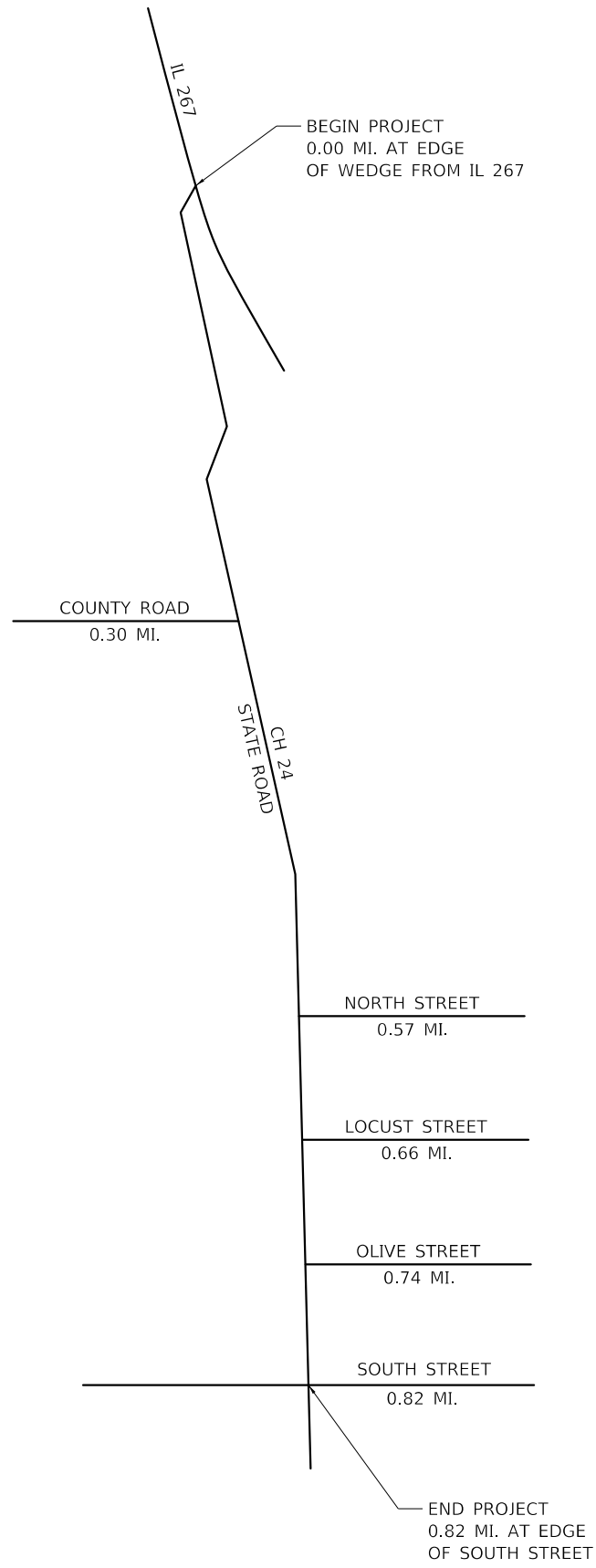

NOT TO SCALE

MODEL: s:\MODEL\MAR15
 FILE: MAR15_Plan\p10m100m.dwg
 PROJECT: I:\Projects\DOT\Documents\DOT_Offices\District 8\Projects\DOT\76N87\CADD\DATA\CAD\Sheet\DOT76N87-shc-detailed.dgn

USER NAME = ESTEVESST	DESIGNED - _____	REVISED - _____
	DRAWN - _____	REVISED - _____
PLOT SCALE = 100,0000' / in.	CHECKED - _____	REVISED - _____
PLOT DATE = 10/6/2020	DATE - _____	REVISED - _____

**STATE OF ILLINOIS
DEPARTMENT OF TRANSPORTATION**

LOCATION MAP

SCALE: _____ SHEET 1 OF 1 SHEETS STA. _____ TO STA. _____

C.H. RTE.	SECTION	COUNTY	TOTAL SHEETS	SHEET NO.
24	24RS-1	GREENE	6	6
			CONTRACT NO. 76N87	
ILLINOIS				