

069-0525 ELEVATION

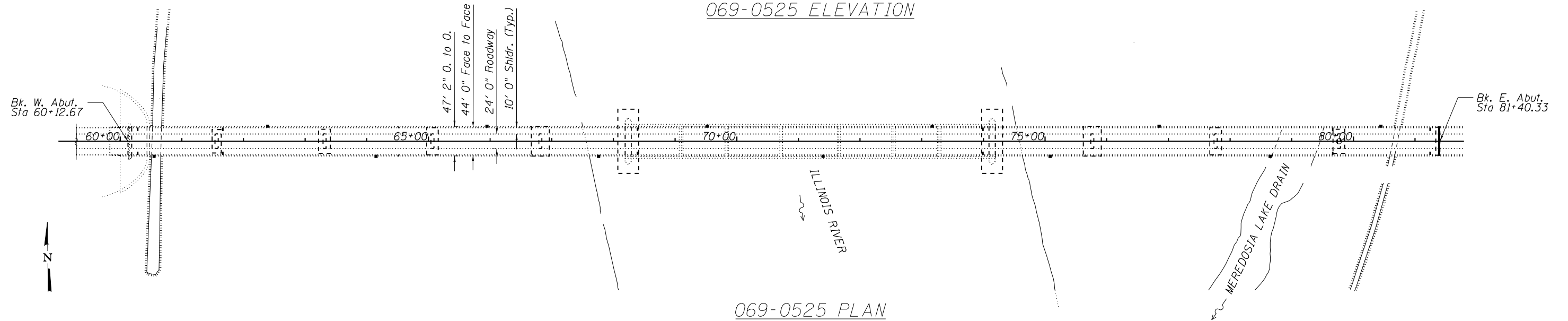

069-0525 PLAN

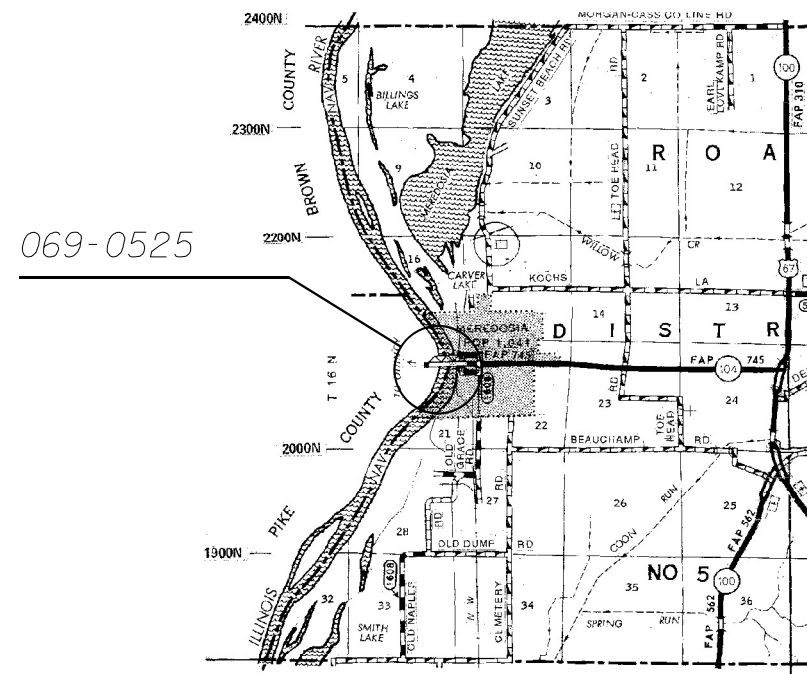

LOCATION MAP

TOTAL BILL OF MATERIAL (069-0525)

ITEM	UNIT	QUANTITY
Concrete Sealer	Sq. Ft.	6505
Bridge Washing No. 1	Each	1

REV. 1-5-2021

STRUCTURE GENERAL NOTES:

PLAN DIMENSIONS AND DETAILS RELATIVE TO EXISTING PLANS ARE SUBJECT TO NOMINAL CONSTRUCTION VARIATIONS. THE CONTRACTOR SHALL FIELD VERIFY EXISTING DIMENSIONS AND DETAILS AFFECTING NEW CONSTRUCTION AND MAKE NECESSARY APPROVED ADJUSTMENTS PRIOR TO CONSTRUCTION OR ORDERING OF MATERIALS. SUCH VARIATIONS SHALL NOT BE CAUSE FOR ADDITIONAL COMPENSATION FOR A CHANGE IN THE SCOPE OF WORK, HOWEVER, THE CONTRACTOR WILL BE PAID FOR THE QUANTITY ACTUALLY FURNISHED AT THE UNIT PRICE BID FOR THE WORK.

SEE CONTRACT GENERAL NOTES ON SHEET 2 FOR AREAS OF BRIDGE TO BE WASHED.

MODEL: D:\p\h\... OPERATIONS\Bridges\Bridges\069-0525 - Pike Co. BRIDGE 2021\bridge.dwg

USER NAME = dudleybm	DESIGNED - BRANDON DUDLEY	REVISED - VHV 01/04/2021
PLOT SCALE = 100,0000' / in.	DRAWN - BRANDON DUDLEY	REVISED -
PLOT DATE = 1/4/2021	CHECKED - JASON JONES	REVISED -
	DATE - 8/28/2020	REVISED -

STATE OF ILLINOIS
DEPARTMENT OF TRANSPORTATION

BRIDGE PLAN & ELEVATION
SN 069-0525

SCALE: SHEET 1 OF 6 SHEETS STA. TO STA.

F.A. RTE.	SECTION	COUNTY	TOTAL SHEETS	SHEET NO.
72,745	(75-3,123)BC(75,86)BR-2,BC	PIKE	30	10
CONTRACT NO. 72M42				
ILLINOIS FED. AID PROJECT				

1357' 5" BK. TO BK. ABUTS. (WBL)
 1371' 6-7/8" BK. TO BK. ABUTS. (EBL)

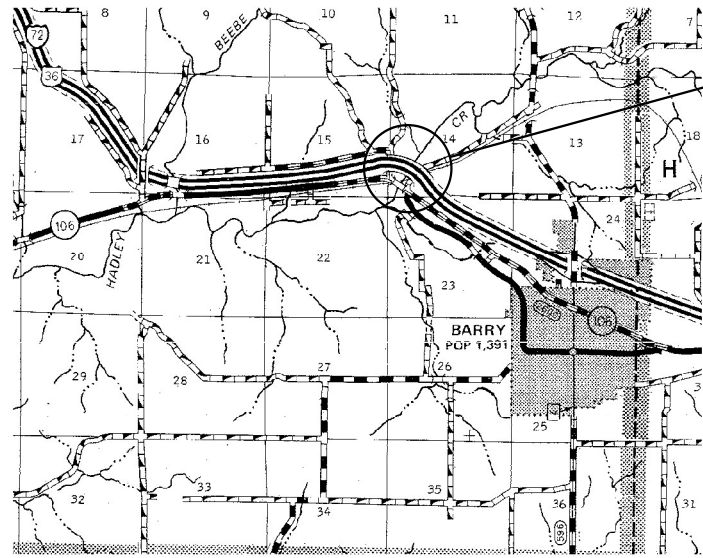
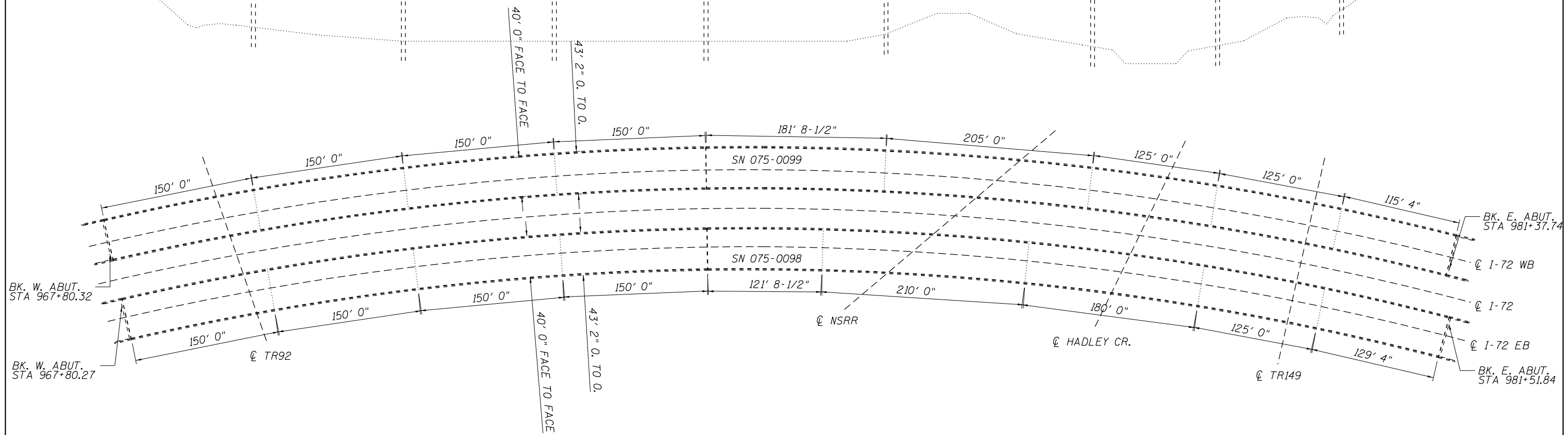

LOCATION MAP

TOTAL BILL OF MATERIAL (075-0098 & 0099)

ITEM	UNIT	QUANTITY
Concrete Sealer	Sq. Ft.	3280
Bridge Washing No. 2	Each	1
Bridge Washing No. 3	Each	1

REV. 1-5-2021

STRUCTURE GENERAL NOTES:

PLAN DIMENSIONS AND DETAILS RELATIVE TO EXISTING PLANS ARE SUBJECT TO NOMINAL CONSTRUCTION VARIATIONS. THE CONTRACTOR SHALL FIELD VERIFY EXISTING DIMENSIONS AND DETAILS AFFECTING NEW CONSTRUCTION AND MAKE NECESSARY APPROVED ADJUSTMENTS PRIOR TO CONSTRUCTION OR ORDERING OF MATERIALS. SUCH VARIATIONS SHALL NOT BE CAUSE FOR ADDITIONAL COMPENSATION FOR A CHANGE IN THE SCOPE OF WORK, HOWEVER, THE CONTRACTOR WILL BE PAID FOR THE QUANTITY ACTUALLY FURNISHED AT THE UNIT PRICE BID FOR THE WORK.

SEE CONTRACT GENERAL NOTES ON SHEET 2 FOR AREAS OF BRIDGE TO BE WASHED.

MODEL: D:\p\h\...
 FILE NAME: C:\OPERATIONS\Bridges\Bridges\Bridges_CAD\72M42 - Pike Co. MBRP\2021\brnsrcc.dgn

USER NAME = dudleybm	DESIGNED - BRANDON DUDLEY	REVISED - VHV 01/04/2021
PLOT SCALE = 100,0000' / in.	DRAWN - BRANDON DUDLEY	REVISOR -
PLOT DATE = 1/4/2021	CHECKED - JASON JONES	REVISOR -
	DATE - 8/28/2020	REVISOR -

STATE OF ILLINOIS
 DEPARTMENT OF TRANSPORTATION

BRIDGE PLAN & ELEVATION
 SN 075-0098 & 0099

SCALE: SHEET 1 OF 7 SHEETS STA. TO STA.

F.A. RTE.	SECTION	COUNTY	TOTAL SHEETS	SHEET NO.
72,745	(75-3,123)BC(75,86)BJR-2,BC	PIKE	30	16
CONTRACT NO. 72M42				
ILLINOIS FED. AID PROJECT				

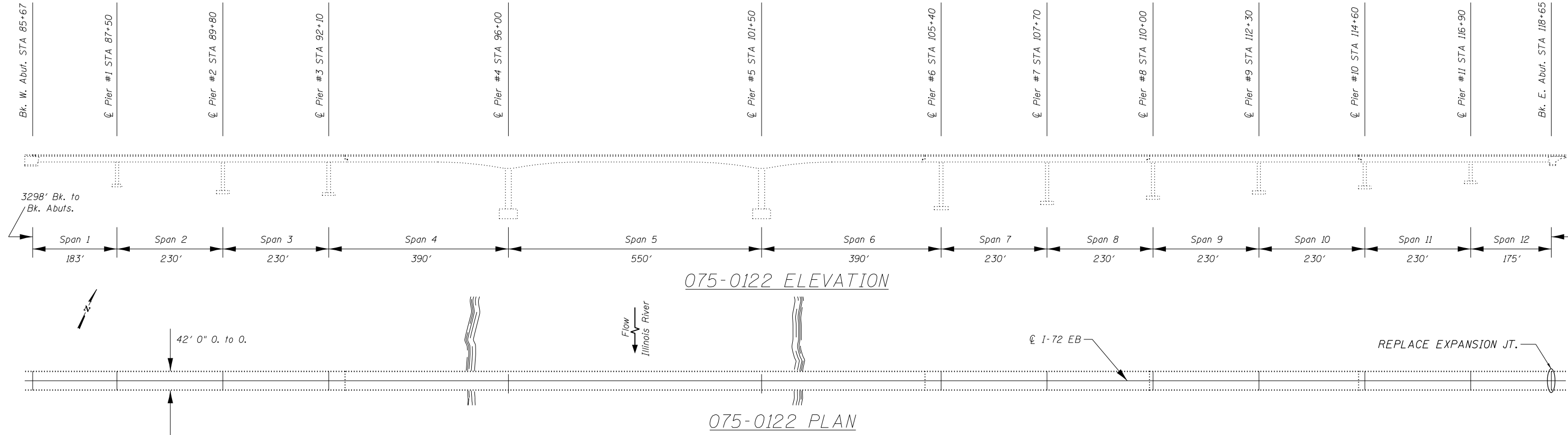

TOTAL BILL OF MATERIAL (075-0122)

ITEM	UNIT	QUANTITY
Concrete Removal	Cu. Yd.	1.4
Concrete Superstructure	Cu. Yd.	1.4
Reinforcement Bars, Epoxy Coated	Pound	260
Bar Splicers	Each	8
Preformed Joint Strip Seal	Foot	42
Concrete Sealer	Sq. Ft.	120
Bridge Washing No. 4	Each	1

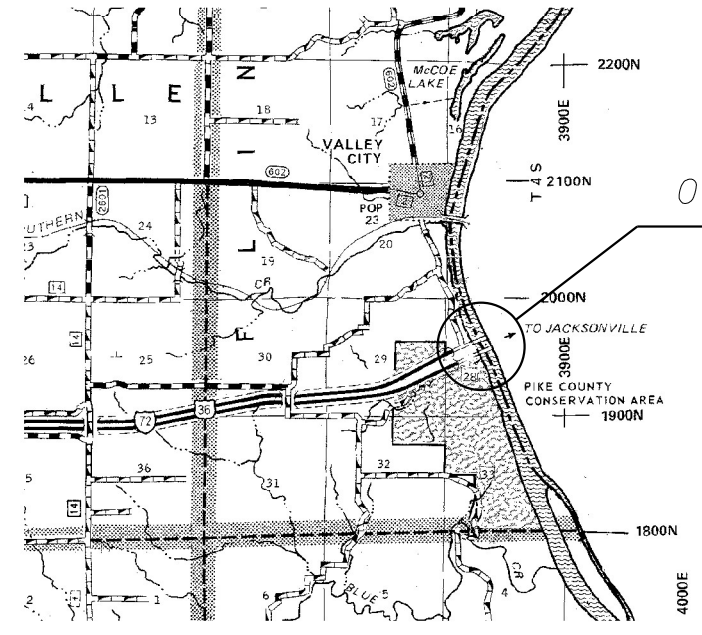

LOCATION MAP



Expires 11-30-2022
David Carl Puzey
 12/1/2020

STRUCTURE GENERAL NOTES:

- ALL STRUCTURAL STEEL SHALL BE AASHTO M-270 GRADE 36, UNLESS OTHERWISE NOTED.
- REINFORCEMENT BARS DESIGNATED (E) SHALL BE EPOXY COATED.
- PRIOR TO POURING THE NEW CONCRETE DECK, ALL HEAVY OR LOOSE MILL SCALE AND OTHER LOOSE OR POTENTIALLY DETRIMENTAL FOREIGN MATERIAL SHALL BE REMOVED FROM THE SURFACES IN CONTACT WITH CONCRETE. TIGHTLY ADHERED PAINT MAY REMAIN UNLESS OTHERWISE NOTED. REMOVAL SHALL BE ACCOMPLISHED BY METHODS THAT WILL NOT DAMAGE THE STEEL AND THE COST WILL BE INCLUDED IN CONCRETE REMOVAL.
- PLAN DIMENSIONS AND DETAILS RELATIVE TO EXISTING PLANS ARE SUBJECT TO NOMINAL CONSTRUCTION VARIATIONS. THE CONTRACTOR SHALL FIELD VERIFY EXISTING DIMENSIONS AND DETAILS AFFECTING NEW CONSTRUCTION AND MAKE NECESSARY APPROVED ADJUSTMENTS PRIOR TO CONSTRUCTION OR ORDERING OF MATERIALS. SUCH VARIATIONS SHALL NOT BE CAUSE FOR ADDITIONAL COMPENSATION FOR A CHANGE IN THE SCOPE OF WORK. HOWEVER, THE CONTRACTOR WILL BE PAID FOR THE QUANTITY ACTUALLY FURNISHED AT THE UNIT PRICE BID FOR THE WORK.
- EXISTING REINFORCEMENT BARS EXTENDING INTO THE REMOVAL AREA SHALL BE CLEANED, STRAIGHTENED, AND INCORPORATED INTO THE NEW CONSTRUCTION. ANY REINFORCEMENT BARS THAT ARE DAMAGED DURING CONCRETE REMOVAL SHALL BE REPLACED WITH AN APPROVED BAR SPLICER OR ANCHORAGE SYSTEM. COST INCLUDED WITH CONCRETE REMOVAL.
- JOINT OPENINGS SHALL BE ADJUSTED ACCORDING TO ARTICLE 520.04 OF THE STANDARD SPECIFICATIONS WHEN THE DECK IS POURED AT AN AMBIENT TEMPERATURE OTHER THAN 50°F.
- THE ABUTMENT AND DECK SURFACES IN THE AREAS OF EXPANSION JOINT REPLACEMENT SHALL HAVE A TINED FINISH AS PER ARTICLE 420.09(a)(1) OF THE STANDARD SPECIFICATIONS, COST INCLUDED WITH CONCRETE SUPERSTRUCTURE.
- CONCRETE SEALER SHALL ONLY BE APPLIED TO THE NEW CONCRETE DECK AND PARAPET SURFACES ADJACENT TO THE PROPOSED EXPANSION JOINTS.

SEE CONTRACT GENERAL NOTES ON SHEET 2 FOR AREAS OF BRIDGE TO BE WASHED.

REV. 1-5-2021

MODEL: D:\p\h\... FILE NAME: C:\OPERATIONS\Bids\Bids\Bids\Bids_CAD\172M42 - Pike Co. BRPM 2021\11\11\brpm2021.dgn

USER NAME = dudleybm	DESIGNED - BRANDON DUDLEY	REVISED - VHV_01/04/2021
PLOT SCALE = 100,0000' / in.	DRAWN - BRANDON DUDLEY	REVISED - _____
PLOT DATE = 10/13/2020	CHECKED - JASON JONES	REVISED - _____
	DATE - 8/28/2020	REVISED - _____

**STATE OF ILLINOIS
DEPARTMENT OF TRANSPORTATION**

**BRIDGE PLAN & ELEVATION
SN 075-0122 (EB)**

SCALE: _____ SHEET 1 OF 4 SHEETS STA. _____ TO STA. _____

F.A. RTÉ.	SECTION	COUNTY	TOTAL SHEETS	SHEET NO.
72,745	(75-3,123)BC(75,86)BJR-2,BC	PIKE	30	23
CONTRACT NO. 72M42				
ILLINOIS FED. AID PROJECT				

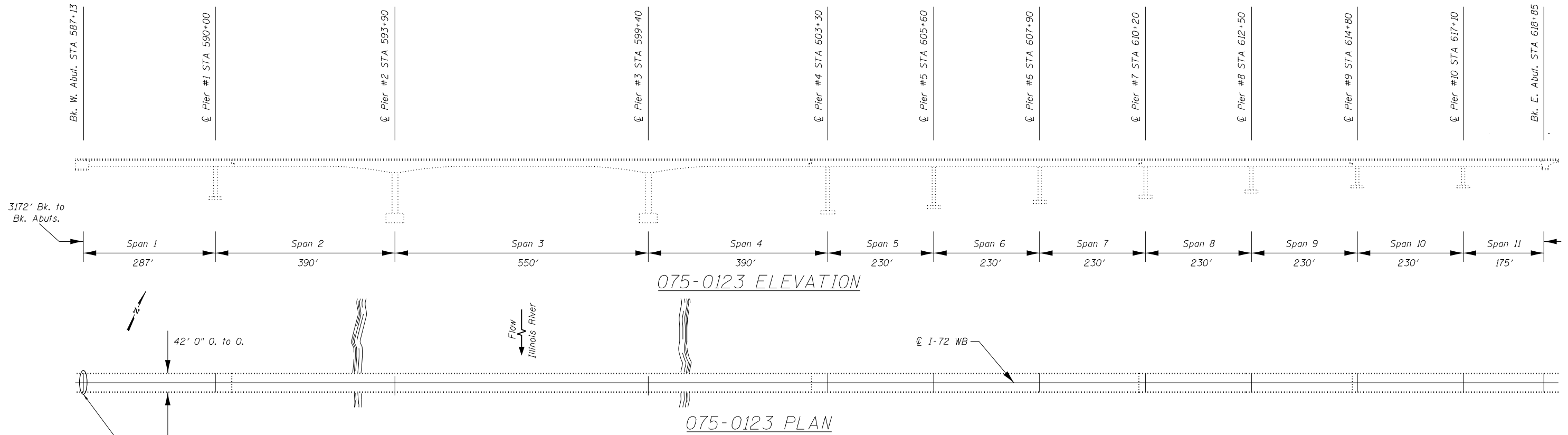

TOTAL BILL OF MATERIAL (075-0123)

ITEM	UNIT	QUANTITY
Concrete Removal	Cu. Yd.	2.0
Concrete Superstructure	Cu. Yd.	2.0
Reinforcement Bars, Epoxy Coated	Pound	240
Bar Splicers	Each	8
Preformed Joint Strip Seal	Foot	42
Concrete Sealer	Sq. Ft.	120
Bridge Washing No. 5	Each	1

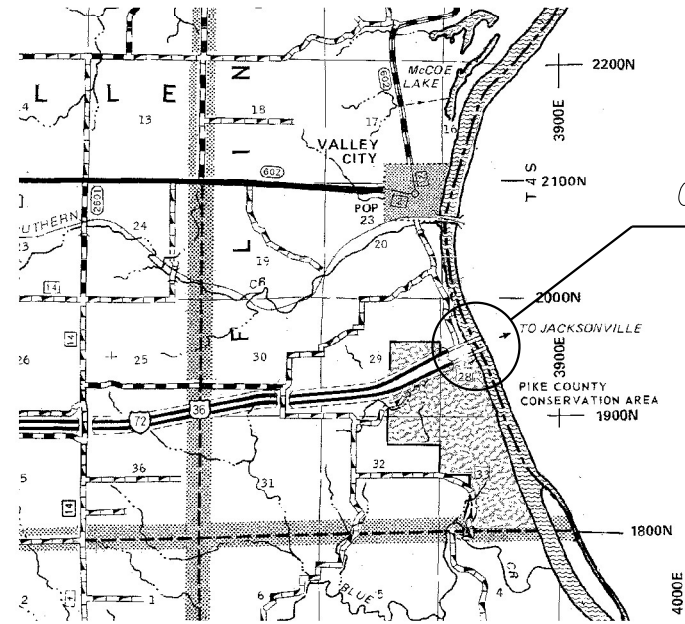

LOCATION MAP



Expires 11-30-2022
David Carl Puzey
 12/1/2020

STRUCTURE GENERAL NOTES:

ALL STRUCTURAL STEEL SHALL BE AASHTO M-270 GRADE 36, UNLESS OTHERWISE NOTED.

REINFORCEMENT BARS DESIGNATED (E) SHALL BE EPOXY COATED.

PRIOR TO POURING THE NEW CONCRETE DECK, ALL HEAVY OR LOOSE MILL SCALE AND OTHER LOOSE OR POTENTIALLY DETRIMENTAL FOREIGN MATERIAL SHALL BE REMOVED FROM THE SURFACES IN CONTACT WITH CONCRETE. TIGHTLY ADHERED PAINT MAY REMAIN UNLESS OTHERWISE NOTED. REMOVAL SHALL BE ACCOMPLISHED BY METHODS THAT WILL NOT DAMAGE THE STEEL AND THE COST WILL BE INCLUDED IN CONCRETE REMOVAL.

PLAN DIMENSIONS AND DETAILS RELATIVE TO EXISTING PLANS ARE SUBJECT TO NOMINAL CONSTRUCTION VARIATIONS. THE CONTRACTOR SHALL FIELD VERIFY EXISTING DIMENSIONS AND DETAILS AFFECTING NEW CONSTRUCTION AND MAKE NECESSARY APPROVED ADJUSTMENTS PRIOR TO CONSTRUCTION OR ORDERING OF MATERIALS. SUCH VARIATIONS SHALL NOT BE CAUSE FOR ADDITIONAL COMPENSATION FOR A CHANGE IN THE SCOPE OF WORK, HOWEVER, THE CONTRACTOR WILL BE PAID FOR THE QUANTITY ACTUALLY FURNISHED AT THE UNIT PRICE BID FOR THE WORK.

EXISTING REINFORCEMENT BARS EXTENDING INTO THE REMOVAL AREA SHALL BE CLEANED, STRAIGHTENED, AND INCORPORATED INTO THE NEW CONSTRUCTION. ANY REINFORCEMENT BARS THAT ARE DAMAGED DURING CONCRETE REMOVAL SHALL BE REPLACED WITH AN APPROVED BAR SPLICER OR ANCHORAGE SYSTEM. COST INCLUDED WITH CONCRETE REMOVAL.

JOINT OPENINGS SHALL BE ADJUSTED ACCORDING TO ARTICLE 520.04 OF THE STANDARD SPECIFICATIONS WHEN THE DECK IS POURED AT AN AMBIENT TEMPERATURE OTHER THAN 50°F.

THE ABUTMENT AND DECK SURFACES IN THE AREAS OF EXPANSION JOINT REPLACEMENT SHALL HAVE A TINED FINISH AS PER ARTICLE 420.09(e)(1) OF THE STANDARD SPECIFICATIONS. COST INCLUDED WITH CONCRETE SUPERSTRUCTURE.

CONCRETE SEALER SHALL ONLY BE APPLIED TO THE NEW CONCRETE DECK AND PARAPET SURFACES ADJACENT TO THE PROPOSED EXPANSION JOINTS.

SEE CONTRACT GENERAL NOTES ON SHEET 2 FOR AREAS OF THE BRIDGE TO BE WASHED.

REV. 1-5-2021

MODEL: D:\p\h\... FILE NAME: 075-0123\OPERATIONS\Bridges\Bridges\075-0123.dwg - Pike Co. MBPM 2021\h\dms\red.dwg

USER NAME = dudleybm	DESIGNED - BRANDON DUDLEY	REVISED - VHV_01/04/2021
PLOT SCALE = 100,0000' / in.	DRAWN - BRANDON DUDLEY	REVISED -
PLOT DATE = 10/13/2020	CHECKED - JASON JONES	REVISED -
	DATE - 8/28/2020	REVISED -

STATE OF ILLINOIS
 DEPARTMENT OF TRANSPORTATION

BRIDGE PLAN & ELEVATION
 SN 075-0123 (WB)

SCALE: _____ SHEET 1 OF 4 SHEETS STA. _____ TO STA. _____

F.A. RTE. = 72,745	SECTION = (75-3,123)BC(75,86)BJR-2,BC	COUNTY = PIKE	TOTAL SHEETS = 30	SHEET NO. = 27
CONTRACT NO. 72M42				
ILLINOIS FED. AID PROJECT				