

F.A.P. RTE.	SECTION	COUNTY	TOTAL SHEETS	SHEET NO.
B76	9Y-RS-7	WILL	108	69
STA. 1+700		TO STA. 2+400		
FED. ROAD DIST. NO. 1		ILLINOIS FED. AID PROJECT		
CONTRACT NO. 60E52				

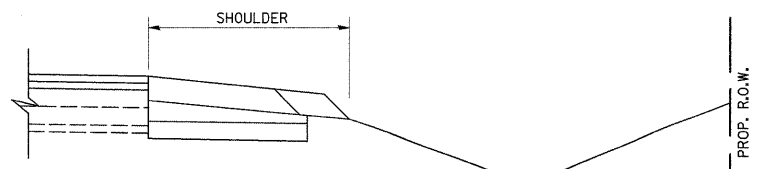
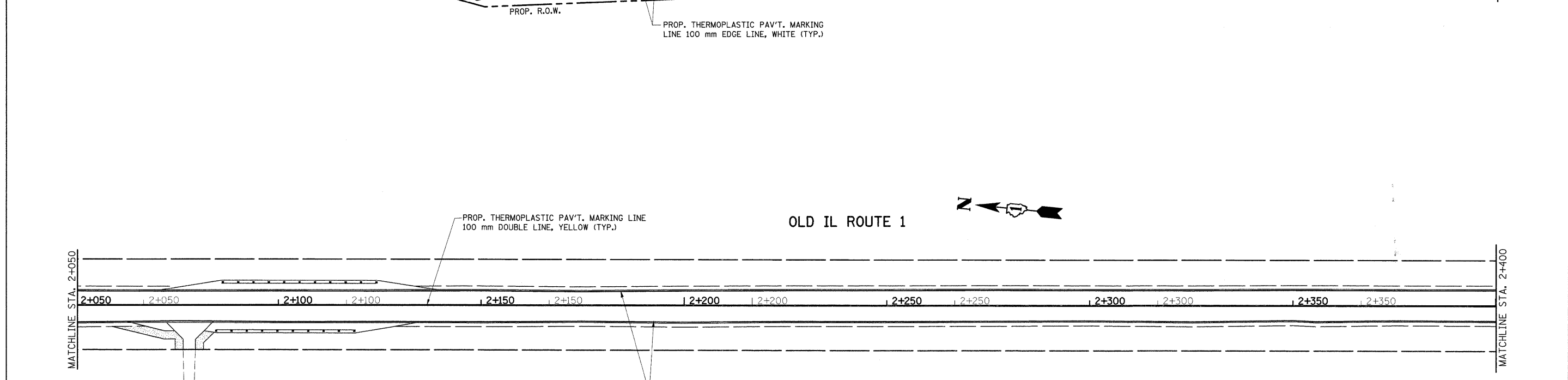
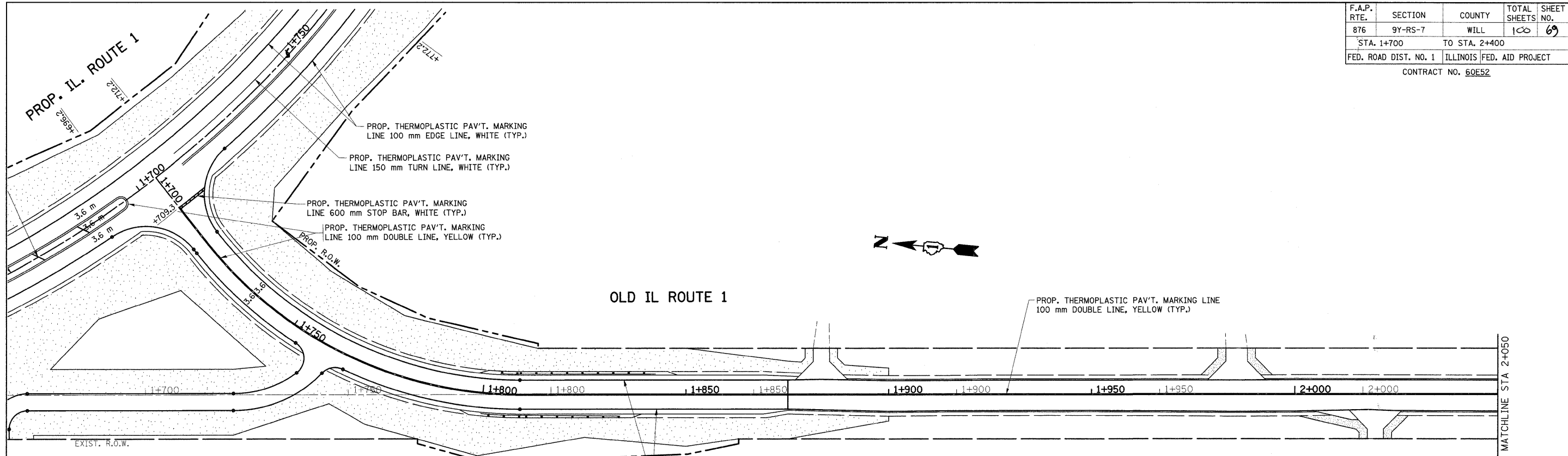

- SEEDING DETAIL (TYPICAL)**
- * TOPSOIL FURNISH AND PLACE, 4"
 - * SEEDING CL. 2A
 - * EROSION CONTROL BLANKET
 - * NUTRIENTS
 - * COMPOST FURNISH AND PLACE, 4"
 - * SEEDING CL. 4
 - * EROSION CONTROL BLANKET

- LEGEND**
- SODDING SALT TOLERANT
 - SEEDING CLASS 2A
 - SEEDING CLASS 4
 - EROSION CONTROL BLANKET (SEE SEEDING DETAIL THIS PAGE)

REVISIONS	
NAME	DATE

ILLINOIS DEPARTMENT OF TRANSPORTATION
**IL. ROUTE 1
 PROPOSED
 LANDSCAPING AND
 PAVEMENT MARKING PLAN**
 SCALE 1:500
 DATE 9/3/2008
 DRAWN BY
 CHECKED BY