

ROUTE	SECTION	COUNTY	TOTAL SHEETS	SHEET NUMBER
VARIOUS	2008-053 BP	VARIOUS	69	10

CONTRACT NO. 60F04

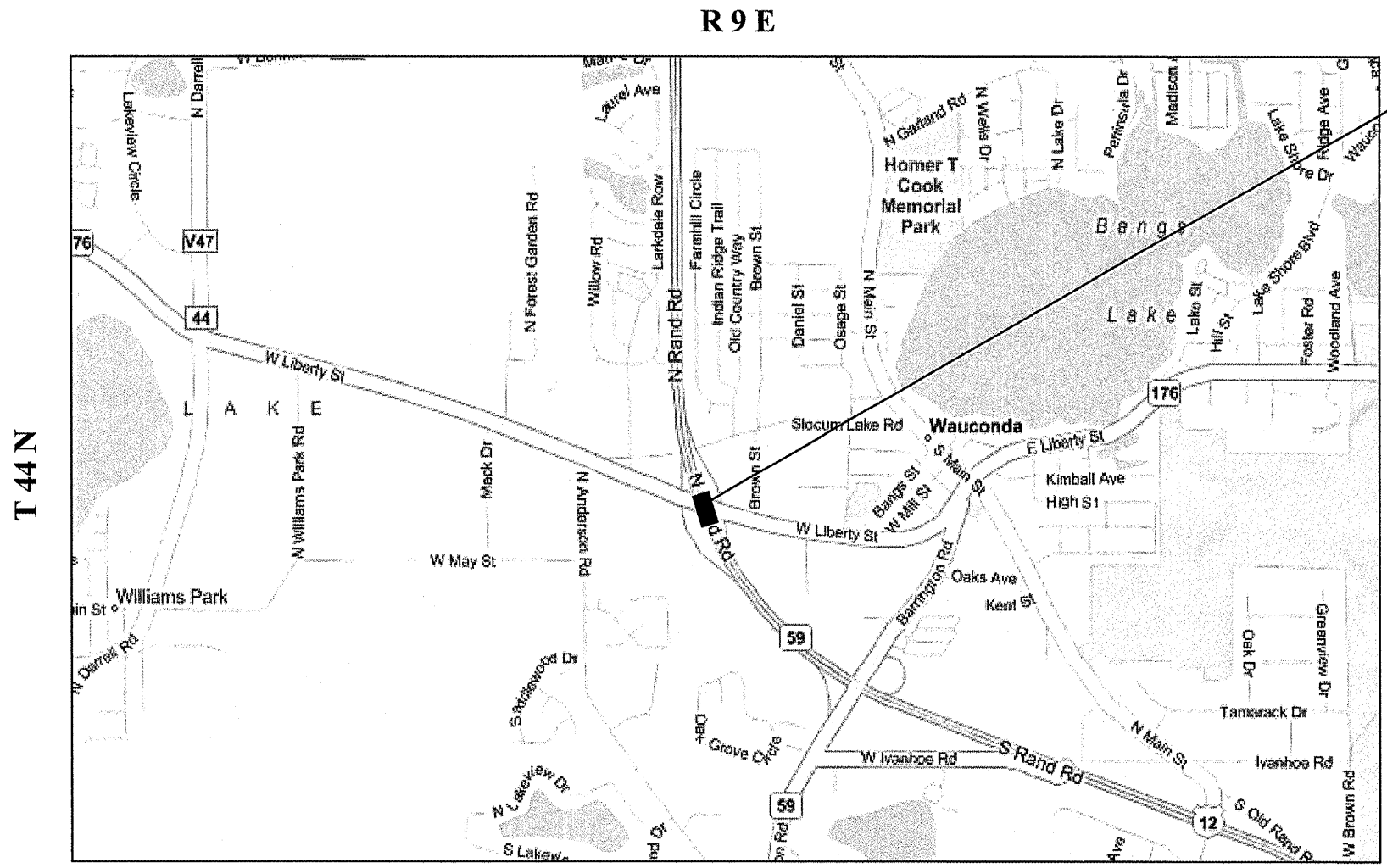

**LOCATION 5:**  
 SN 049-0022, -0023  
 US 12/IL 59 (RAND RD.) NB &  
 SB OVER IL 176  
**WAUCONDA TOWNSHIP**



**WAUCONDA TOWNSHIP  
 LAKE COUNTY**

**TRAFFIC DATA: US 12**  
 2007 ADT = 18,950  
 POSTED SPEED LIMIT = 55 MPH

**TRAFFIC DATA: IL 176**  
 2007 ADT = 20,000  
 POSTED SPEED LIMIT = 30 MPH

ILLINOIS DEPARTMENT OF TRANSPORTATION  
**LOCATION MAPS**  
 LOCATION 5: US 12 NB & SB OVER IL 176