

DATE
BY
REVISIONS
PLAN
NO.

DATE
BY
REVISIONS
PROFILE
NO.

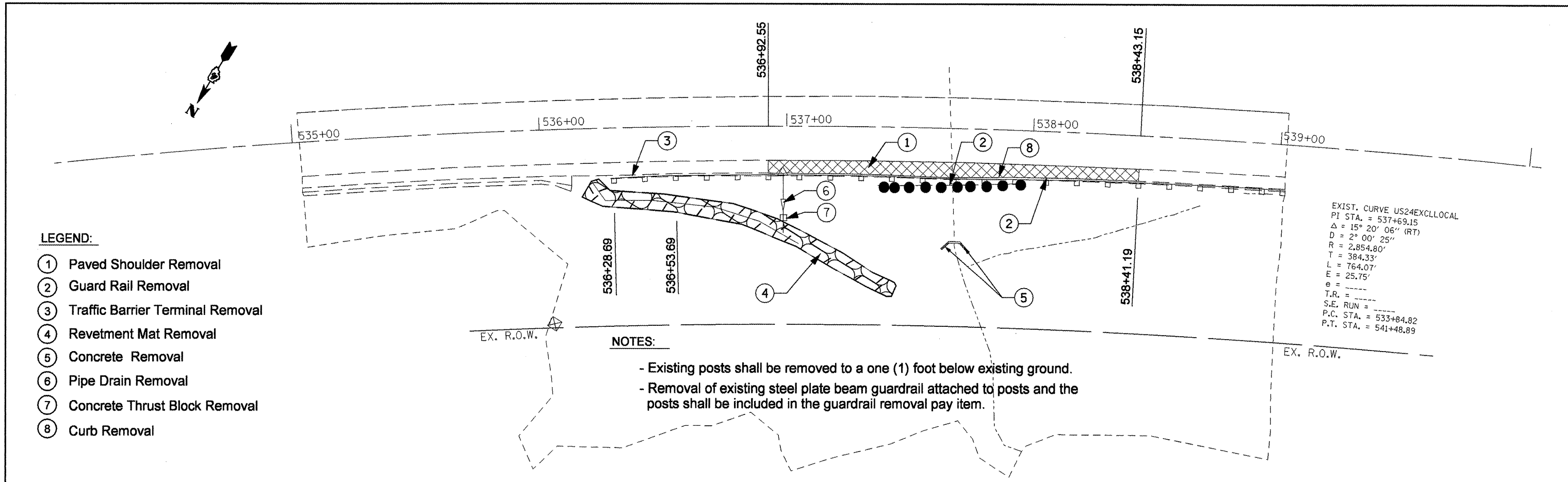

- LEGEND:**
- ① Paved Shoulder Removal
 - ② Guard Rail Removal
 - ③ Traffic Barrier Terminal Removal
 - ④ Revetment Mat Removal
 - ⑤ Concrete Removal
 - ⑥ Pipe Drain Removal
 - ⑦ Concrete Thrust Block Removal
 - ⑧ Curb Removal

EXIST. CURVE US24EXCLLOCAL
 PI STA. = 537+69.15
 $\Delta = 15^\circ 20' 06''$ (RT)
 $D = 2^\circ 00' 25''$
 $R = 2,854.00'$
 $T = 384.33'$
 $L = 764.07'$
 $E = 25.75'$
 $e =$
 T.R. =
 S.E. RUN =
 P.C. STA. = 533+84.82
 P.T. STA. = 541+48.89

NOTES:

- Existing posts shall be removed to a one (1) foot below existing ground.
- Removal of existing steel plate beam guardrail attached to posts and the posts shall be included in the guardrail removal pay item.

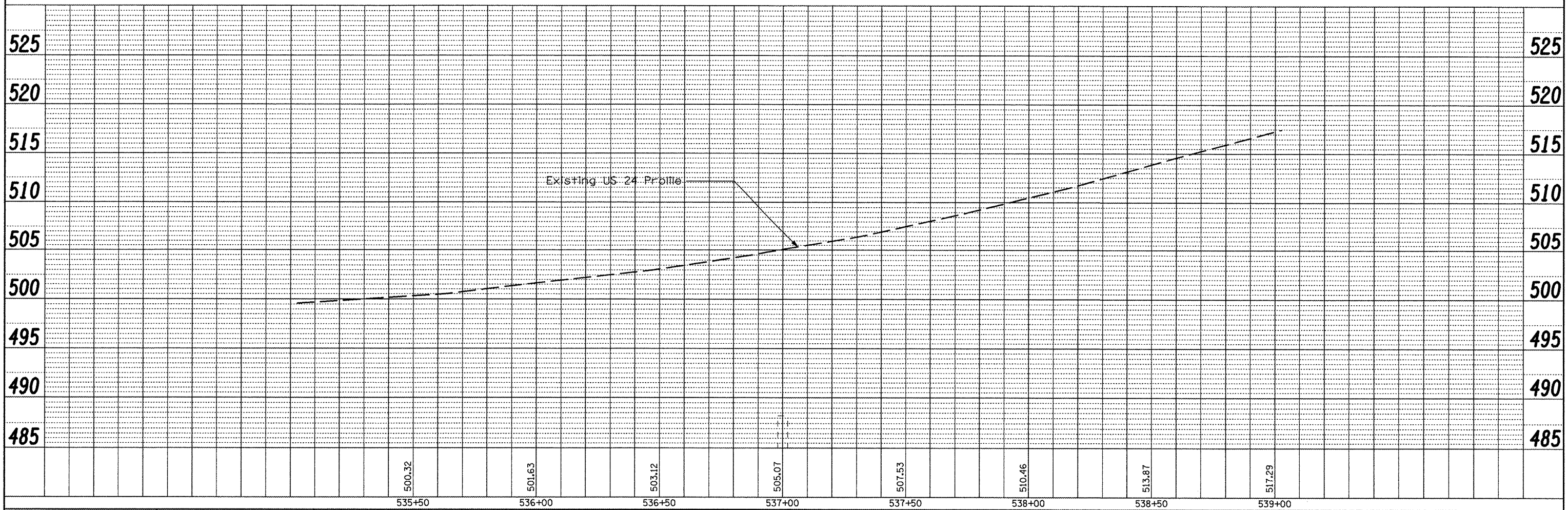

FILE NAME = c:\projects\us24\existing sht.dgn	USER NAME = crespole	DESIGNED -	REVISED -	STATE OF ILLINOIS DEPARTMENT OF TRANSPORTATION	Removal Plan -US 24 Culvert Extension	F.A.P. RTE. 317	SECTION (137,102)RS-4;10IRS-3	COUNTY FULTON	TOTAL SHEETS 56	SHEET NO. 23
PLT SCALE = 48.0000' / IN.	DRAWN -	REVISED -	CONTRACT NO. 68337							
PLT DATE = 10/14/2008	CHECKED -	REVISED -	FED. ROAD DIST. NO. 4 ILLINOIS FED. AID PROJECT							
	DATE -	REVISED -	SCALE:			SHEET NO. OF SHEETS	STA. TO STA.			