

PROJECT ENGINEER: MR. RICH DOTSON (309) 671-3455

CONSULTANT LIASON: MR. CHRIS MAUSHARD (309) 671-3453

F.A.P. RTE.	SECTION	COUNTY	TOTAL SHEETS	SHEET NO.
253	68(BR, BR-1)	MARSHALL	97	1
FED. ROAD DIST. NO. 4	ILLINOIS	CONTRACT NO. 68573		

STATE OF ILLINOIS  
DEPARTMENT OF TRANSPORTATION  
DIVISION OF HIGHWAYS

# PROPOSED HIGHWAY PLANS

FAS ROUTE 253 (IL 251)  
SECTION 68(BR, BR-1)  
PROJECT RS-0253(104)  
MARSHALL COUNTY  
BRIDGE REMOVAL AND REPLACEMENT  
AND ROADWAY RECONSTRUCTION  
C-94-047-06

**MASTER INDEX OF SHEETS**

1. COVER SHEET
- 2.-3. MASTER LIST OF STANDARDS, GENERAL NOTES, COMMITMENTS
- 4.-6. MASTER SUMMARY OF QUANTITIES
7. TEMPORARY DETOUR PLAN
- 8.-9. SN 062-0001 LOW WATER CROSSING PLAN/PROFILE
- 10.-18. SN 062-0001 LOW WATER CROSSING CROSS SECTIONS
- 19.-20. SN 062-0002 LOW WATER CROSSING PLAN/PROFILE
- 21.-32. SN 062-0002 LOW WATER CROSSING CROSS SECTIONS
- 33.-61. CONSTRUCTION PLANS, SN 062-0001 - SEE SHEET 33 FOR INDEX
- 62.-93. CONSTRUCTION PLANS, SN 062-0002 - SEE SHEET 62 FOR INDEX
- 94.-97. BRIDGE APPROACH PAVEMENT DETAIL

**TRAFFIC DATA**

ADT = 900 (2008)  
SU = 3.8%  
MU = 1.3%  
  
ADT = 1,350 (2028)

**POSTED SPEED LIMIT**

55 M.P.H.

**DESIGN DESIGNATION**

RURAL MAJOR COLLECTOR

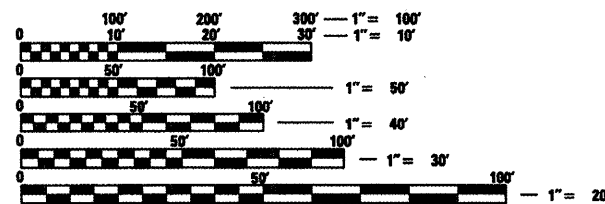

FULL SIZE PLANS HAVE BEEN PREPARED USING STANDARD ENGINEERING SCALES. REDUCED SIZED PLANS WILL NOT CONFORM TO STANDARD SCALES. IN MAKING MEASUREMENTS ON REDUCED PLANS, THE ABOVE SCALES MAY BE USED.

J.U.L.I.E.  
JOINT UTILITY LOCATION INFORMATION FOR EXCAVATION  
1-800-892-0123  
OR 811

**CONTRACT NO. 68573**

**CATALOG NO. 033201-00D**

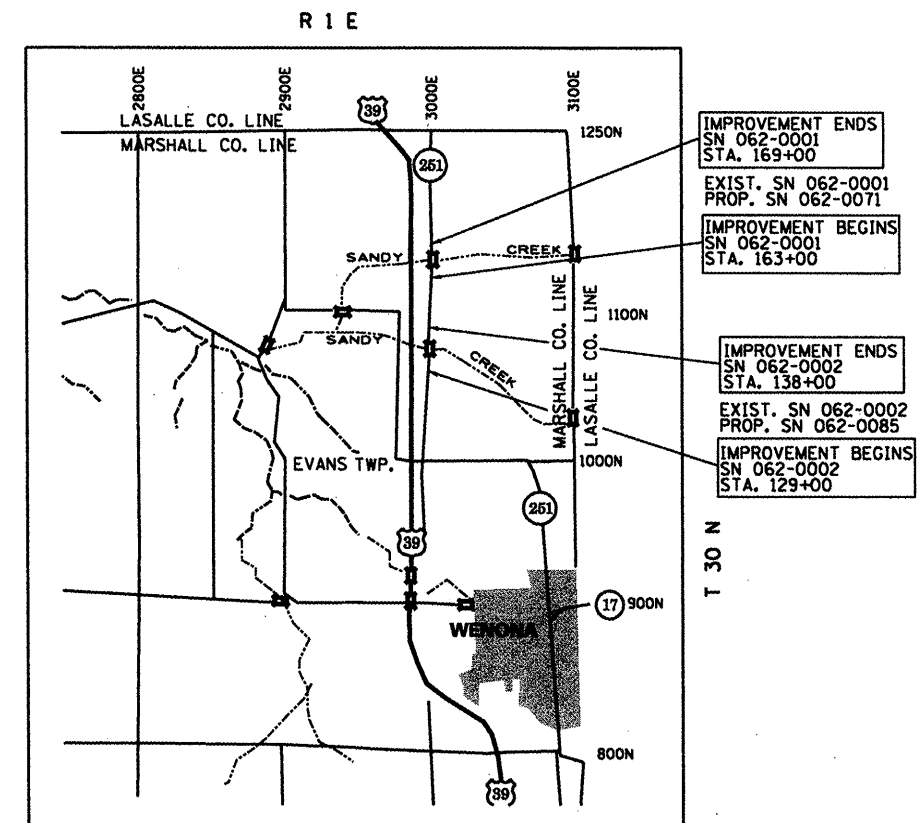
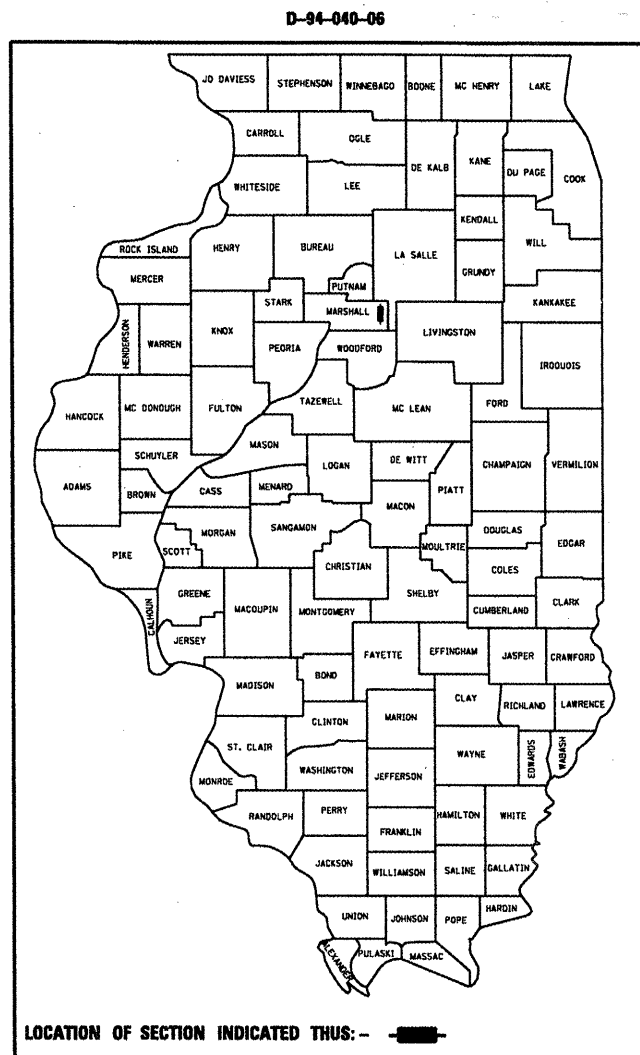

TOTAL LENGTH OF PROJECT = 4000 FT  
NET LENGTH OF IMPROVEMENT = 1500 FT

STATE OF ILLINOIS  
DEPARTMENT OF TRANSPORTATION  
DIVISION OF HIGHWAYS

SUBMITTED *Oct 15, 2008*

*[Signature]*  
DEPUTY DIRECTOR OF HIGHWAYS, REGION ENGINEER

*December 5, 2008*  
*[Signature]*  
ENGINEER OF DESIGN AND ENVIRONMENT

*December 5, 2008*  
*[Signature]*  
DIRECTOR OF HIGHWAYS, CHIEF ENGINEER

**PRINTED BY THE AUTHORITY  
OF THE STATE OF ILLINOIS**