

NOTE

GAS UTILITY IS AN EXISTING 4" STEEL MAIN OPERATING AT 500 PSIG ON A 720 PSIG SYSTEM. DEPTH OF UTILITY VARIES BETWEEN 3'-7" TO 8'-4" ALONG THE CROSSOVER

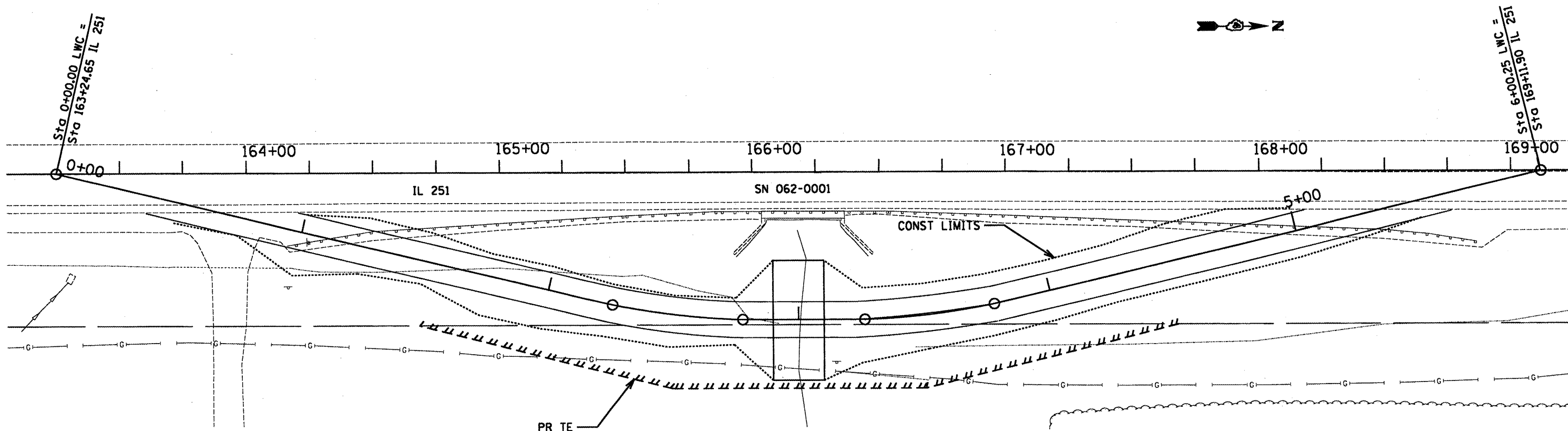

PROP. CURVE ALTICUR1
 PI STA. = 2+52.10
 $\Delta = 9^\circ 52' 37''$ (LT)
 $D = 19^\circ 05' 55''$
 $R = 300.00'$
 $T = 25.92'$
 $L = 51.71'$
 $E = 1.12'$
 P.C. STA. = 2+26.18 =
 ML STA. 165+44.80, 52.03' RT OFFSET
 P.T. STA. = 2+77.90 =
 ML STA. 165+96.03, 57.96' RT OFFSET

PROP. CURVE ALTICUR2
 PI STA. = 3+51.81
 $\Delta = 9^\circ 52' 29''$ (LT)
 $D = 19^\circ 05' 55''$
 $R = 300.00'$
 $T = 25.92'$
 $L = 51.70'$
 $E = 1.12'$
 P.C. STA. = 3+25.90 =
 ML STA. 166+44.10, 58.00 RT OFFSET
 P.T. STA. = 3+77.60 =
 ML STA. 166+95.35, 51.92' RT OFFSET

LOW WATER CROSSING TO BE USED BY ADJACENT PROPERTY OWNERS AND CONSTRUCTION PERSONNEL ONLY DURING CONSTRUCTION. THE CROSSING SHOWN IS PROVIDED FOR INFORMATIONAL PURPOSES ONLY. THE LOW WATER CROSSING SHALL CONFORM TO THE SPECIAL PROVISION FOR HAUL ROAD STREAM CROSSINGS, OTHER TEMPORARY CROSSINGS, AND IN-STREAM WORK PADS.

NOTES

A MINIMUM ROADWAY TOP WIDTH OF 14 FEET SHALL BE MAINTAINED ALONG THE LENGTH OF THE CROSSING

THE MAXIMUM IN-STREAM ELEVATION OF THE CROSSING SHALL NOT EXCEED EL. 636.51

A MINIMUM IN-STREAM CLEAR OPENING OF 48 SQUARE FEET SHALL BE MAINTAINED TO CONVEY STREAM FLOW

SEE CONSTRUCTION PLANS, SN 062-0001 FOR ALIGNMENT TIES AND BENCHMARK

FILE NAME = c:\projects\11251sandy\862000\plan01.dgn	USER NAME = maushardoe	DESIGNED - DRAWN - CHECKED - DATE -	REVISED - REVISED - REVISED - REVISED -	STATE OF ILLINOIS DEPARTMENT OF TRANSPORTATION	SN 062-0001 LOW WATER CROSSING PLAN VIEW			F.A.S. RTE. 253	SECTION 68(BR, BR-1)	COUNTY MARSHALL	TOTAL SHEETS 97	SHEET NO. 8
					SCALE:	SHEET NO.	OF	SHEETS	STA.	TO STA.	FED. ROAD DIST. NO. D-94-040-06	ILLINOIS FED. AID PROJECT