

CONTRACT NO. 68573				
FAS RTE	SECTION	COUNTY	TOTAL SHEETS	SHEET NO.
253	68(BR, BR-1)	MARSHALL	9	58
STA. 161+00.00 TO STA. 163+95.00				
FED. ROAD DIST. NO.	ILLINOIS		FED. AID PROJECT	

FINAL SURVEY	BY	DATE
REVISIONS		
NO. 1		
NO. 2		
NO. 3		

ORIGINAL SURVEY	BY	DATE
REVISIONS		
NO. 1		
NO. 2		
NO. 3		

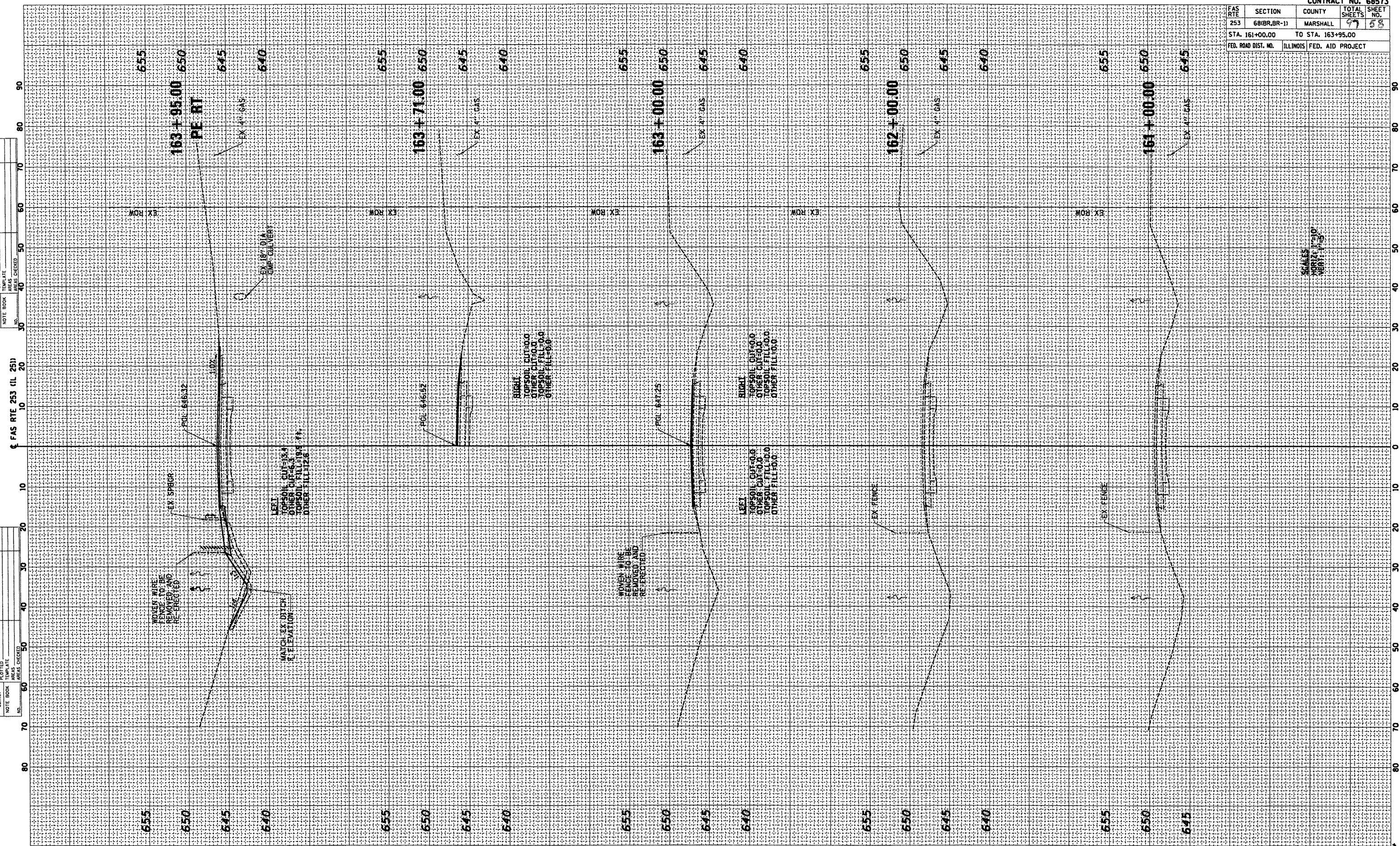

FAS RTE 253 (IL 251) CROSS SECTIONS
 STA 161+00.00 TO STA 163+95.00