

LOCATION #3 – F.A.I. 55 (I-55) FROM LOGAN CO. LINE TO SHIRLEY INTERCHANGE

(INTERSTATE)

MCLEAN COUNTY

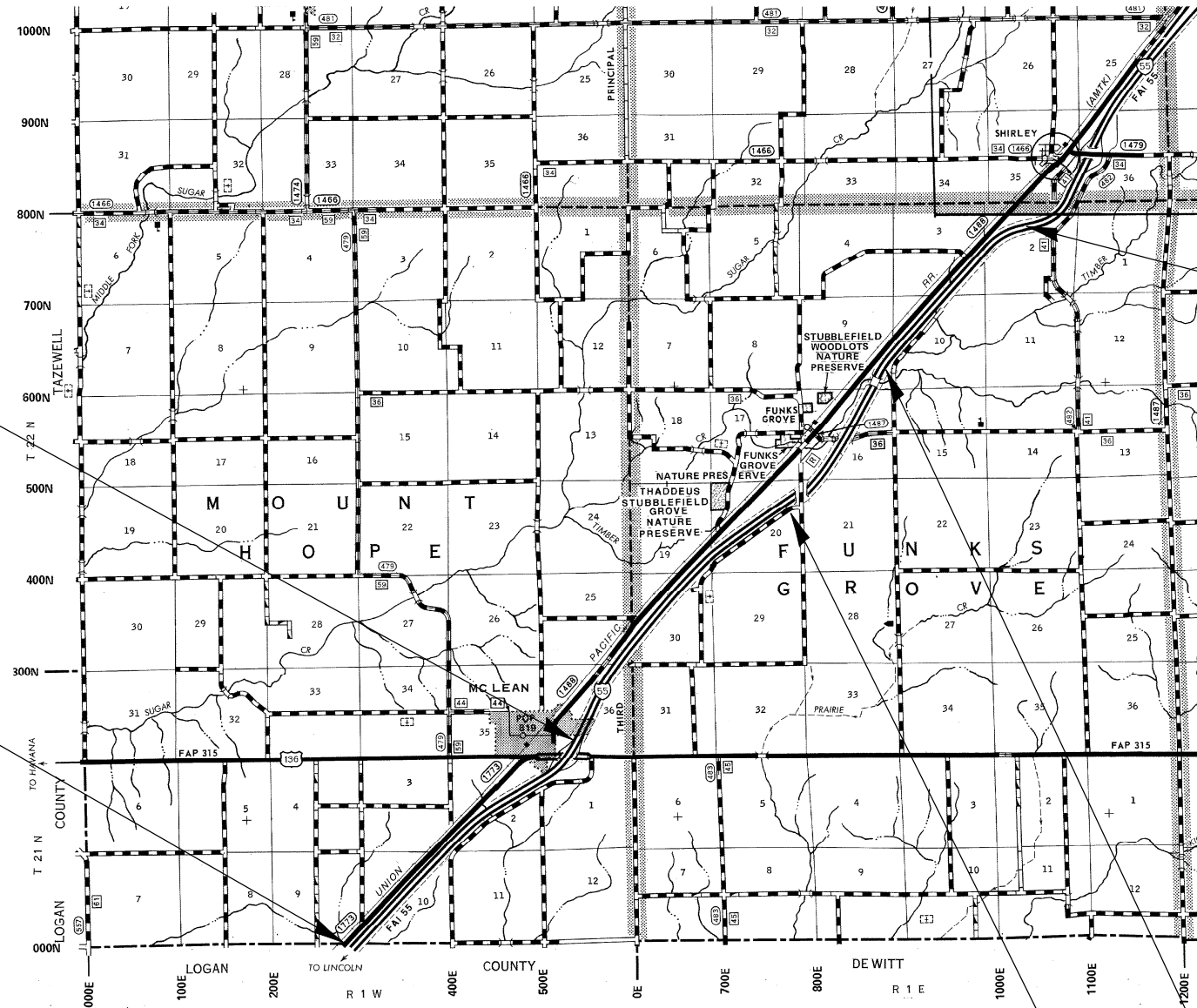

STATION EQUATION:
 STA. 783+30.73 (BK) = STA. 74+89.65 (AH)

LOCATION #3 (INTERSTATE)
 BEGIN STATION 587+34.90

LOCATION #3 (INTERSTATE)
 END STATION 434+10.00



STATION EQUATION:
 STA. 381+37.19 (BK) = STA. 376+50.00 (AH)

STATION EQUATION:
 STA. 252+74.34 (BK) = STA. 252+87.76 (AH)

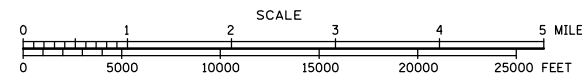

TOTAL & NET LENGTH OF LOCATION #3 = 55,989.95 FEET = 10.6 MILES

FILE NAME =	USER NAME = austinr1	DESIGNED - RLA	REVISED -
ct:\projects\d570736\cad\sheeta\d570736-sh1-plan.dgn		DRAWN - SAME	REVISED -
		CHECKED - JMS	REVISED -
		DATE - 08/2008	REVISED -

**STATE OF ILLINOIS
 DEPARTMENT OF TRANSPORTATION**

LOCATION MAPS

SCALE : N/A SHEET NO. OF SHEETS STA. TO STA.

F.A. RTE.	SECTION	COUNTY	TOTAL SHEETS	SHEET NO.
VAR.	D5 CRACK & JOINT SEAL 2009-1	MCLEAN	21	5
FED. ROAD DIST. NO.			ILLINOIS FED. AID PROJECT	
			CONTRACT NO. 70736	