

LOCATION #4 – FAP 315 (US 136) FROM E. OF I-55 TO W. OF US 51 @ HEYWORTH
(RURAL 2-LANE)
MCLEAN COUNTY

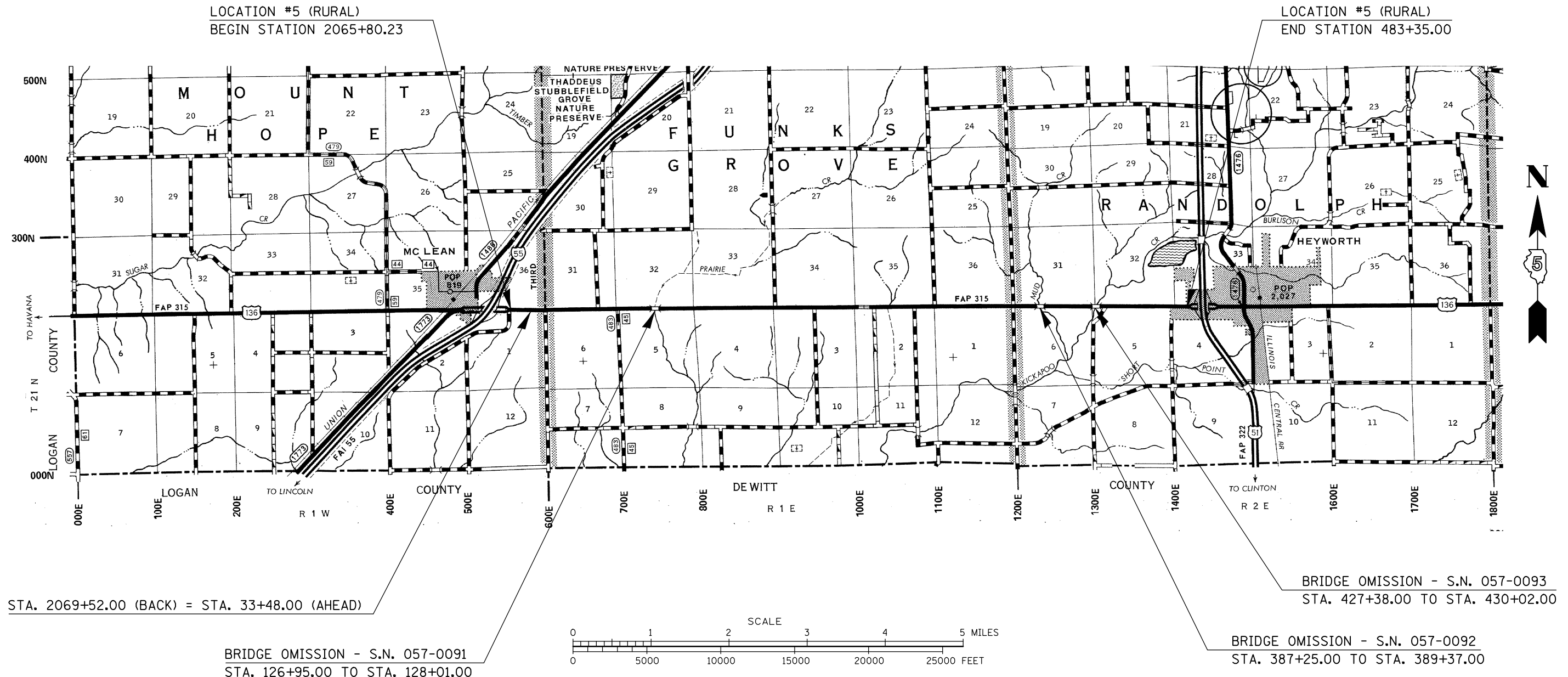

TOTAL LENGTH OF LOCATION #4 = 45,358.77 FEET = 8.591 MILES
NET LENGTH OF LOCATION #4 = 44,776.77 FEET = 8.480 MILES

FILE NAME = c:\projects\d570736\cad\sheet\d570736-sh1-plan.dgn	USER NAME = austinr1	DESIGNED - RLA	REVISED -	STATE OF ILLINOIS DEPARTMENT OF TRANSPORTATION	LOCATION MAPS			F.A. RTE.	SECTION	COUNTY	TOTAL SHEETS	SHEET NO.	
		DRAWN - SAME	REVISED -		SCALE : N/A	SHEET NO.	OF SHEETS	STA.	TO STA.	VAR. 05 CRACK & JOINT SEAL 2009-1	MCLEAN	21	6
		PLOT SCALE = 100.0000' / IN.	CHECKED - JMS		REVISED -				CONTRACT NO. 70736				
		PLOT DATE = 10/14/2008	DATE - 08/2008		REVISED -				FED. ROAD DIST. NO. ILLINOIS FED. AID PROJECT				