

STATE OF ILLINOIS
DEPARTMENT OF TRANSPORTATION
DIVISION OF HIGHWAYS
**PROPOSED
HIGHWAY PLANS**
VARIOUS ROUTES
**SECTION D5 CRACK & JOINT SEAL 2009-1
MCLEAN COUNTY**
C-95-025-08

F.A. RTE.	SECTION	COUNTY	TOTAL SHEETS	SHEET NO.
VAR.	*	MCLEAN	21	1
FED. ROAD DIST. NO.		ILLINOIS	CONTRACT NO. 70736	

* D5 CRACK & JOINT SEAL 2009-1

D-95-025-08

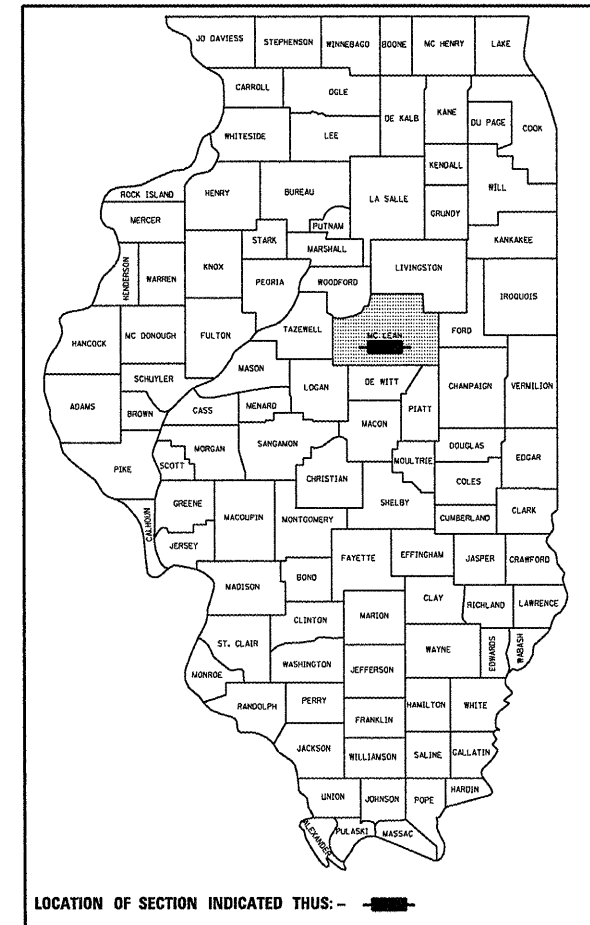

FOR INDEX OF SHEETS, SEE SHEET NO. 2
FOR SUMMARY OF QUANTITIES, SEE SHEET NO. 9

CURRENT ADT	
LOCATION #1	2,400 (2008)
LOCATION #2	1,150 (2008)
LOCATION #3	21,700 (2008)
LOCATION #4	2,700 (2007)
LOCATION #5	4,200 (2007)

DESIGN DESIGNATION
N/A

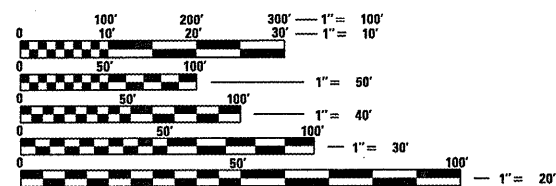

FULL SIZE PLANS HAVE BEEN PREPARED USING STANDARD ENGINEERING SCALES. REDUCED SIZED PLANS WILL NOT CONFORM TO STANDARD SCALES. IN MAKING MEASUREMENTS ON REDUCED PLANS, THE ABOVE SCALES MAY BE USED.

J.U.L.I.E.
JOINT UTILITY LOCATION INFORMATION FOR EXCAVATION
1-800-892-0123
OR 811

PROJECT ENGINEER: KEVIN TRAPP
SQUAD LEADER: JEFF SHERER
DESIGNER: RANDY AUSTIN
PHONE: (217)465-4181
CONTRACT NO. 70736

CRACK & JOINT SEALING - VARIOUS LOCATIONS

FOR LOCATION MAPS, SEE SHEETS NO. 3-7

FOR TOTAL & NET LENGTHS, SEE SHEETS NO. 3-7

STATE OF ILLINOIS
DEPARTMENT OF TRANSPORTATION
DIVISION OF HIGHWAYS

SUBMITTED 10/14/20 08
Joseph E. O'Connell
DEPUTY DIRECTOR OF HIGHWAYS, REGION THREE ENGINEER
December 5, 20 08
Eric E. Harm
ENGINEER OF DESIGN AND ENVIRONMENT
December 5, 20 08
Christine M. Reed
DIRECTOR OF HIGHWAYS, CHIEF ENGINEER

**PRINTED BY THE AUTHORITY
OF THE STATE OF ILLINOIS**

DATE = 10/16/2008
FILE NAME = c:\p\9\hwy\70736\cond\hwy\70736-dht-cover.dgn
PLOT SCALE = 10%
USER NAME = austinr1

INDEX OF SHEETS

<u>SHEET NO.</u>	<u>ITEM</u>
1	COVER SHEET
2	INDEX OF SHEETS
2	LIST OF STANDARDS
3-7	LOCATION MAPS
8	GENERAL NOTES
9	SUMMARY OF QUANTITIES
10	SCHEDULE OF QUANTITIES
11-15	EXISTING TYPICAL CROSS SECTIONS
16	DETAIL FOR CRACK & JOINT SEALING
17-20	DETAIL FOR PAVEMENT MARKINGS AND MARKERS (RURAL & URBAN)
21	DETAIL FOR PAVEMENT MARKINGS (INTERSTATE & MULTI-LANE)

LIST OF STANDARDS

<u>STANDARD NUMBER</u>	<u>NAME OF STANDARD</u>
701301-03	LANE CLOSURE, 2L, 2W, SHORT TIME OPERATIONS
701306-02	LANE CLOSURE, 2L, 2W, SLOW MOVING OPERATIONS DAY ONLY FOR SPEEDS \geq 45 MPH
701311-03	LANE CLOSURE, 2L, 2W, MOVING OPERATIONS - DAY ONLY
701400-03	APPROACH TO LANE CLOSURE, FREEWAY/EXPRESSWAY
701406-05	LANE CLOSURE, FREEWAY/EXPRESSWAY, DAY OPERATIONS ONLY
701426-03	LANE CLOSURE, MULTILANE, INTERMITTENT OR MOVING OPERATIONS FOR SPEEDS \geq 45 MPH
701901-01	TRAFFIC CONTROL DEVICES
780001-02	TYPICAL PAVEMENT MARKINGS

FILE NAME = c:\projects\d570736\cad\sheet\d570736-	USER NAME = austinn1 t-gennote.dgn	DESIGNED -	REVISED -	STATE OF ILLINOIS DEPARTMENT OF TRANSPORTATION	INDEX OF SHEETS & HIGHWAY STANDARDS	F.A. RTE.	SECTION	COUNTY	TOTAL SHEETS	SHEET NO.
PLOT SCALE = 100.0000' / IN.	PLOT DATE = 10/14/2008	DRAWN -	REVISED -	CHECKED -	REVISOR -	VAR.	DS CRACK & JOINT SEAL 2009-1	MCLEAN	21	2
				SCALE:	SHEET NO. OF SHEETS	STA.	TO STA.	FED. ROAD DIST. NO. ILLINOIS FED. AID PROJECT		
							CONTRACT NO. 70736			

**LOCATION #1 – FAP 693 (IL 9) FROM FAP 701 (IL 122) SPLIT TO TAZEWELL CO. LINE
(RURAL 2-LANE)
MCLEAN COUNTY**



**TOTAL LENGTH OF LOCATION #1 = 37,381.0 FEET = 7.08 MILES
NET LENGTH OF LOCATION #1 = 37,297.0 FEET = 7.06 MILES**

FILE NAME = c:\projects\d570736\cadsheets\d570736-sh1-plan.dgn	USER NAME = austinr1	DESIGNED - RLA	REVISED -	STATE OF ILLINOIS DEPARTMENT OF TRANSPORTATION	LOCATION MAPS			F.A. RTE.	SECTION	COUNTY	TOTAL SHEETS	SHEET NO.
	PLOT SCALE = 100.0000' / IN.	CHECKED - JMS	REVISED -					VAR. 05 CRACK & JOINT SEAL 2009-1	MCLEAN	21	3	
PLOT DATE = 10/14/2008	DATE - 08/2008	REVISED -		SCALE : N/A			SHEET NO.	OF SHEETS	STA.	TO STA.	CONTRACT NO. 70736	
											FED. ROAD DIST. NO.	ILLINOIS FED. AID PROJECT

LOCATION #2 -FAP 315 (US 136) FROM FAP 804 (US 150) IN MCLEAN CO. EAST TO FAP 71 (IL-54) (RURAL 2-LANE) MCLEAN COUNTY

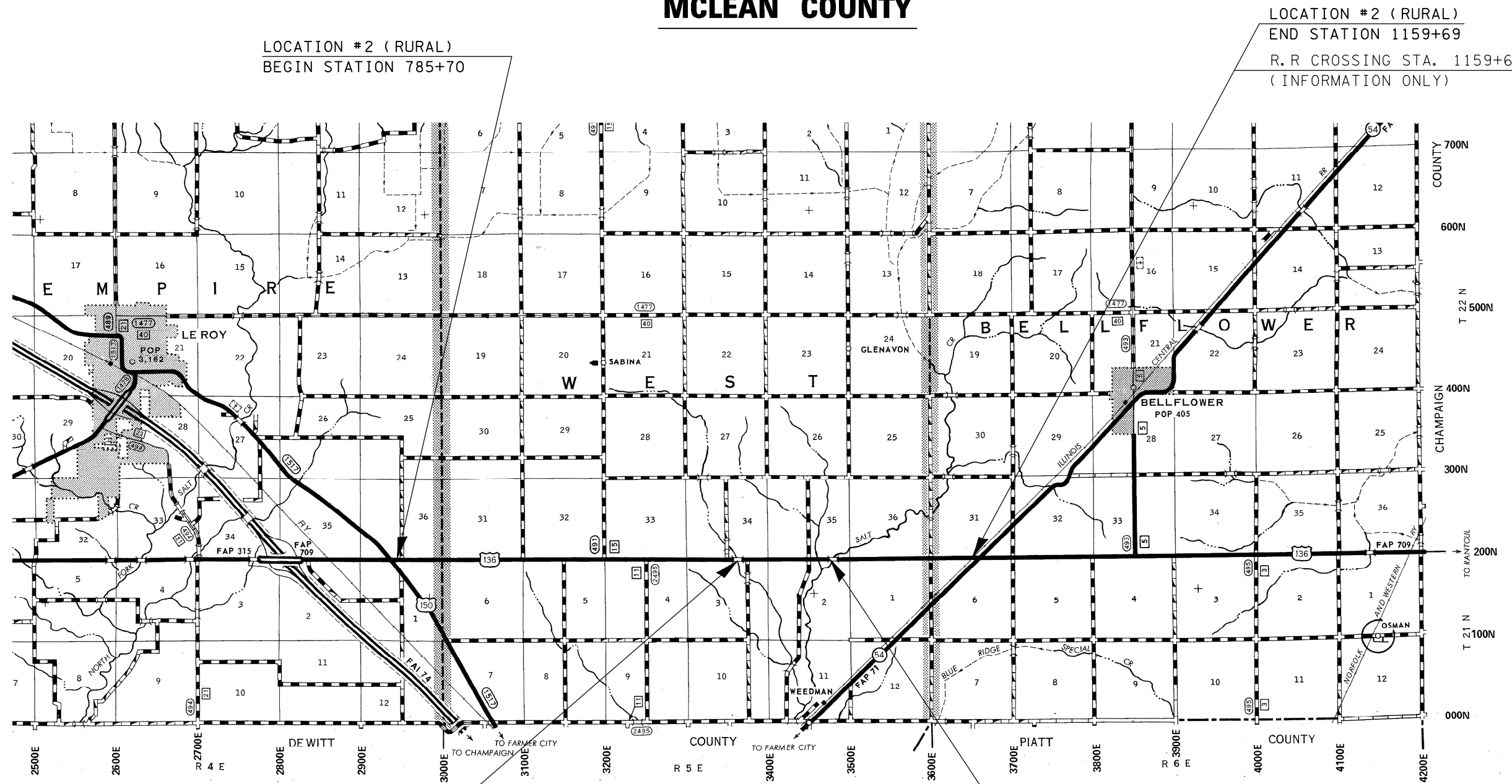

S.N. 057-0098
STA. 1006+29

BRIDGE OMISSION - S.N. 057-0218
STA. 1066+47.00 TO STA. 1068+42.00

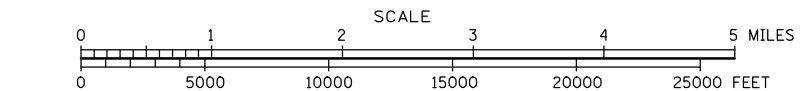

TOTAL LENGTH OF LOCATION #2 = 37,399.0 FEET = 7.08 MILES
NET LENGTH OF LOCATION #2 = 37,204.0 FEET = 7.05 MILES

FILE NAME =	USER NAME = austinr1	DESIGNED - RLA	REVISED -	STATE OF ILLINOIS DEPARTMENT OF TRANSPORTATION	LOCATION MAPS			F.A. RTE.	SECTION	COUNTY	TOTAL SHEETS	SHEET NO.
cr:\projects\d570736\cad\sheeta\d570736-sht-plan.dgn		DRAWN - SAME	REVISED -		SCALE : N/A	SHEET NO.	OF SHEETS	STA.	TO STA.	MCLEAN	21	4
		CHECKED - JMS	REVISED -							CONTRACT NO. 70736		
		DATE - 08/2008	REVISED -							ILLINOIS FED. AID PROJECT		

LOCATION #3 – F.A.I. 55 (I-55) FROM LOGAN CO. LINE TO SHIRLEY INTERCHANGE

(INTERSTATE)

MCLEAN COUNTY

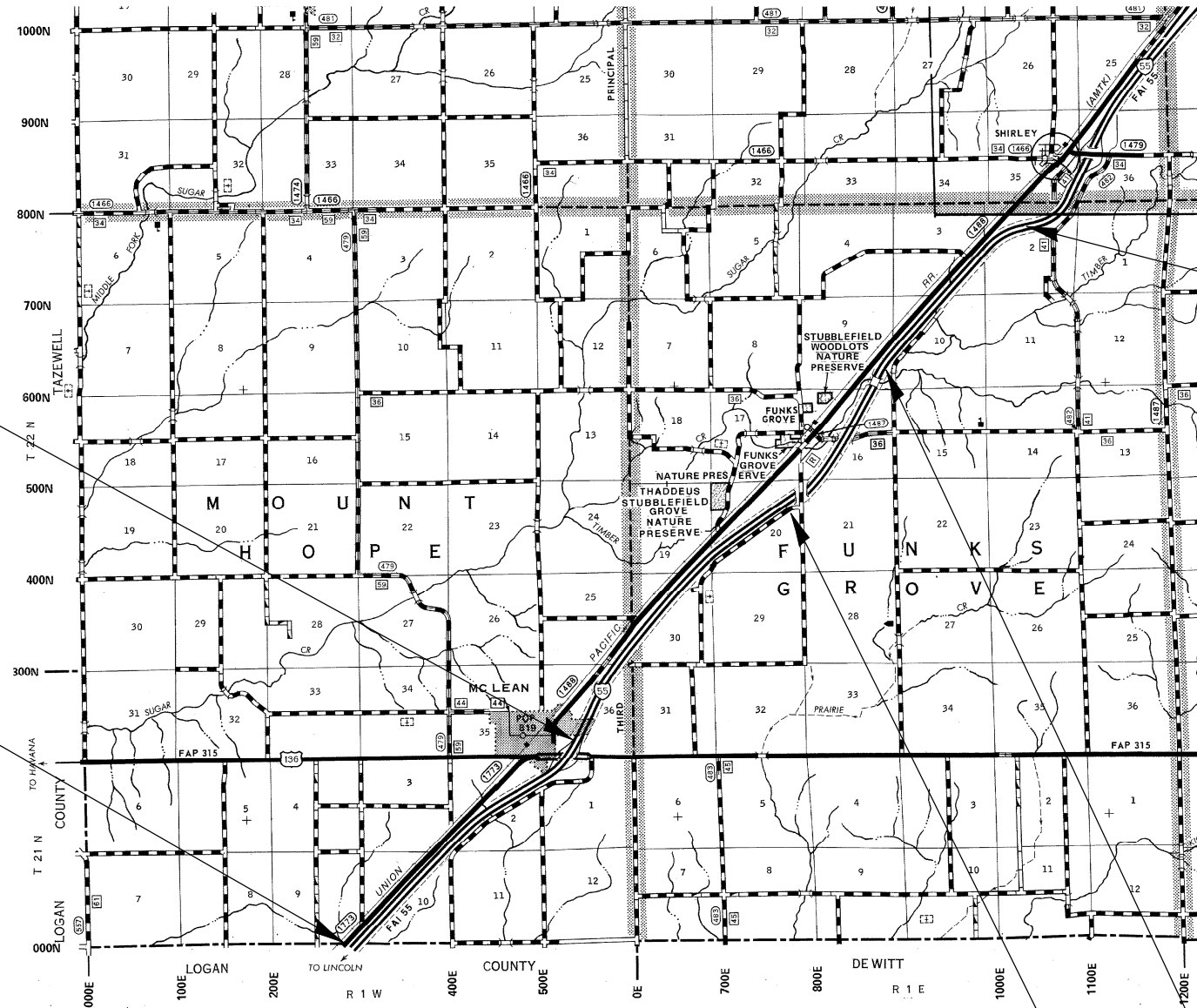

STATION EQUATION:
 STA. 783+30.73 (BK) = STA. 74+89.65 (AH)

LOCATION #3 (INTERSTATE)
 BEGIN STATION 587+34.90

LOCATION #3 (INTERSTATE)
 END STATION 434+10.00



STATION EQUATION:
 STA. 381+37.19 (BK) = STA. 376+50.00 (AH)

STATION EQUATION:
 STA. 252+74.34 (BK) = STA. 252+87.76 (AH)

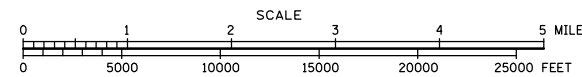

TOTAL & NET LENGTH OF LOCATION #3 = 55,989.95 FEET = 10.6 MILES

FILE NAME =	USER NAME = austinr1	DESIGNED - RLA	REVISED -
ct:\projects\d570736\cad\sheeta\d570736-sh1-plan.dgn		DRAWN - SAME	REVISED -
		CHECKED - JMS	REVISED -
		DATE - 08/2008	REVISED -

**STATE OF ILLINOIS
 DEPARTMENT OF TRANSPORTATION**

LOCATION MAPS

SCALE : N/A SHEET NO. OF SHEETS STA. TO STA.

F.A. RTE.	SECTION	COUNTY	TOTAL SHEETS	SHEET NO.
VAR. 05 CRACK & JOINT SEAL 2009-1		MCLEAN	21	5
CONTRACT NO. 70736				
FED. ROAD DIST. NO.	ILLINOIS	FED. AID PROJECT		

LOCATION #4 – FAP 315 (US 136) FROM E. OF I-55 TO W. OF US 51 @ HEYWORTH
(RURAL 2-LANE)
MCLEAN COUNTY

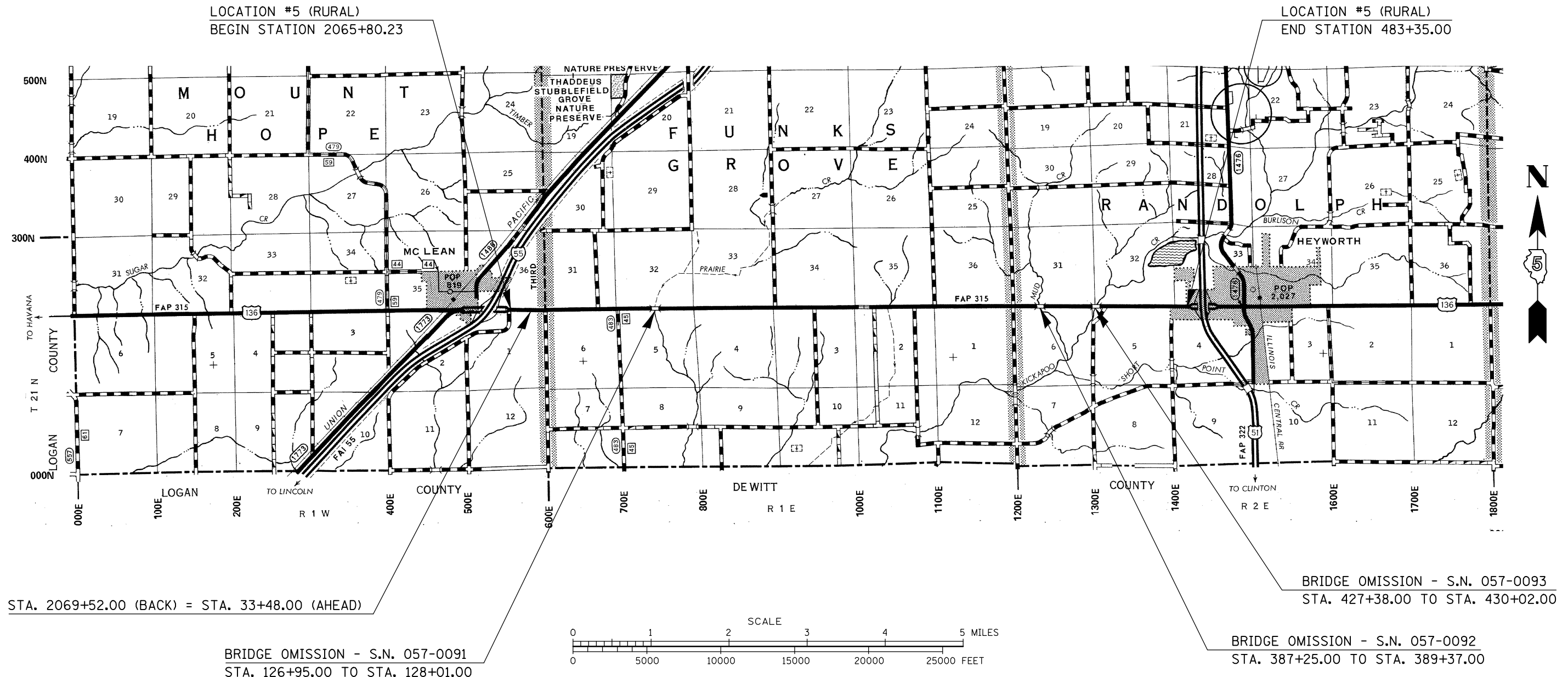

TOTAL LENGTH OF LOCATION #4 = 45,358.77 FEET = 8.591 MILES
NET LENGTH OF LOCATION #4 = 44,776.77 FEET = 8.480 MILES

FILE NAME = c:\projects\d570736\cad\sheet\d570736-sh1-plan.dgn	USER NAME = austinr1	DESIGNED - RLA	REVISED -	STATE OF ILLINOIS DEPARTMENT OF TRANSPORTATION	LOCATION MAPS			F.A. RTE.	SECTION	COUNTY	TOTAL SHEETS	SHEET NO.	
		DRAWN - SAME	REVISED -		SCALE : N/A	SHEET NO.	OF SHEETS	STA.	TO STA.	VAR. 05 CRACK & JOINT SEAL 2009-1	MCLEAN	21	6
		PLOT SCALE = 100.0000' / IN.	CHECKED - JMS		REVISED -				CONTRACT NO. 70736				
		PLOT DATE = 10/14/2008	DATE - 08/2008		REVISED -				FED. ROAD DIST. NO. ILLINOIS FED. AID PROJECT				

LOCATION #5 – FAP 317 (US 24) FROM WOODFORD COUNTY LINE TO GRIDLEY (RURAL 2-LANE) MCLEAN COUNTY

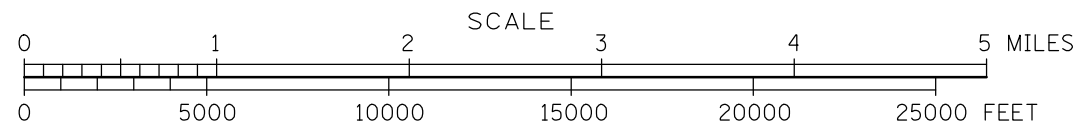
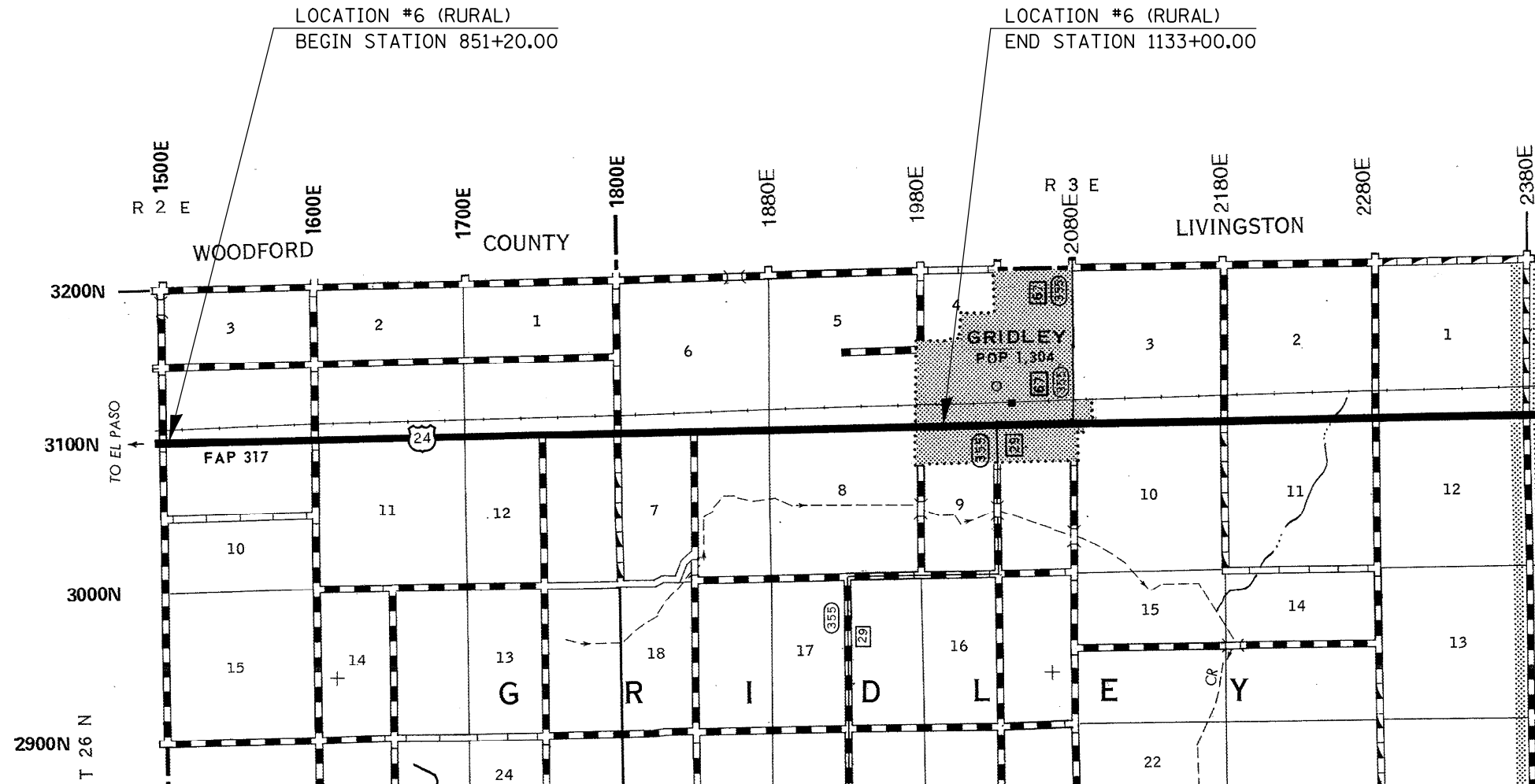

TOTAL & NET LENGTH OF LOCATION #5 = 28,180.00 FEET = 5.337 MILES

FILE NAME =	USER NAME = austinr1	DESIGNED - RLA	REVISED -	STATE OF ILLINOIS DEPARTMENT OF TRANSPORTATION	LOCATION MAPS				F.A. RTE.	SECTION	COUNTY	TOTAL SHEETS	SHEET NO.
ct\projects\d570736\cad\sheets\d570736-sh1-plan.dgn		DRAWN - SAME	REVISED -						VAR.	D5 CRACK & JOINT SEAL 2009-1	MCLEAN	21	7
		CHECKED - JMS	REVISED -						CONTRACT NO. 70736				
		DATE - 08/2008	REVISED -						FED. ROAD DIST. NO.	ILLINOIS	FED. AID PROJECT		
				SCALE : N/A				SHEET NO.	OF	SHEETS	STA.	TO STA.	

GENERAL NOTES

G. N. - 100
ENGLISH UNITS OF MEASUREMENT SHALL GOVERN OVER AND SUPERSEDE ANY METRIC UNITS SHOWN IN THIS CONTRACT. WHERE INCLUDED, METRIC UNITS ARE FOR INFORMATION ONLY.

G. N. -107.12A
RAILROAD PROTECTIVE LIABILITY INSURANCE IS NOT INCLUDED IN THIS CONTRACT. ALL ROUT AND SEAL OPERATIONS SHALL STOP AT THE RAILROAD RIGHT-OF-WAY LINE UNLESS THE RAILROAD RIGHT-OF-WAY LINE IS LESS THAN 25.0 FEET FROM THE RAILROAD TRACKS THEN THE ROUT AND SEAL OPERATIONS SHALL STOP 25.0 FEET FROM THE RAILROAD TRACKS. THE RAILROAD RIGHT-OF-WAY LINE SHALL BE DETERMINED IN THE FIELD BY THE RESIDENT ENGINEER.

G. N. - 451 (SPECIAL)
CRACK ROUTING AND FILLING CONSISTS OF BOTH LONGITUDINAL AND TRANSVERSE CRACKS. AN APPLICATION RATE OF 0.40 LBS./FOOT WAS USED TO DETERMINE CRACK FILLING QUANTITIES.

AT LOCATION #4 AND #5 THE SEALANT WILL BE DUSTED WITH FINE SAND, PORTLAND CEMENT, OR MINERAL FILLER, COVERED WITH TISSUE PAPER, OR SPRAYED WITH GLEN SOIL OR ANOTHER APPROVED PRODUCT TO PREVENT TRACKING.

LOCATION #1

THE INTENT IN LOCATION #1 IS TO ROUT AND SEAL THE ENTIRE CENTERLINE & AUXILIARY LANE JOINTS, AND ALL TRANSVERSE CRACKS AND MISCELLANEOUS LONGITUDINAL CRACKS IN THE EXISTING PAVEMENT.

LONGITUDINAL: 14,919.0 LBS
TRANSVERSE : 8,816.0 LBS
TOTAL: 23,735.0 LBS (ESTIMATED)

LOCATION #2

THE INTENT IN LOCATION #2 IS TO ROUT AND SEAL THE ENTIRE CENTERLINE & AUXILIARY LANE JOINTS, ALL TRANSVERSE CRACKS AND MISCELLANEOUS LONGITUDINAL CRACKS IN THE EXISTING PAVEMENT.

LONGITUDINAL: 16,370.0 LBS
TRANSVERSE : 21,646.0 LBS
TOTAL: 38,016.0 LBS (ESTIMATED)

LOCATION #3

THE INTENT IN LOCATION #3 IS TO ROUT AND SEAL THE ENTIRE CENTERLINE & AUXILIARY LANE JOINTS, ALL TRANSVERSE CRACKS AND MISCELLANEOUS LONGITUDINAL CRACKS IN THE EXISTING PAVEMENT.

LONGITUDINAL: 44,720.0 LBS
TRANSVERSE : 2,033.0 LBS
TOTAL: 46,753.0 LBS (ESTIMATED)

LOCATION #4

THE INTENT IN LOCATION #4 IS TO ROUT AND SEAL THE ENTIRE CENTERLINE & AUXILIARY LANE JOINTS, ALL TRANSVERSE CRACKS AND MISCELLANEOUS LONGITUDINAL CRACKS IN THE EXISTING PAVEMENT.

LONGITUDINAL: 20,598.0 LBS
TRANSVERSE : 3,210.0 LBS
TOTAL: 26,808.0 LBS (ESTIMATED)

LOCATION #5

THE INTENT IN LOCATION #5 IS TO ROUT AND SEAL THE ENTIRE CENTERLINE & AUXILIARY LANE JOINTS, ALL TRANSVERSE CRACKS AND MISCELLANEOUS LONGITUDINAL CRACKS IN THE EXISTING PAVEMENT.

LONGITUDINAL: 23,978.0 LBS
TRANSVERSE : 6,826.0 LBS
TOTAL: 30,804.0 LBS (ESTIMATED)

NOTE: ANY CHANGES TO THE INTENT OF ROUTING AND SEALING AT THE ABOVE LISTED LOCATIONS SHALL BE APPROVED BY THE ENGINEER.

G. N. - 451A (SPECIAL)

THE SECTION OF 452.04, WHICH REFERS TO BACKER ROD PLACEMENT, SHALL ALSO APPLY TO THIS CONTRACT. THIS WORK SHALL BE PERFORMED AT THE DISCRETION OF THE ENGINEER IN ORDER TO KEEP THE APPLICATION RATE OF JOINT FILLER AS CLOSE TO THE DESIGN RATE OF 0.40 LBS./FOOT AS POSSIBLE. FURNISHING AND INSTALLING BACKER ROD WHEN REQUIRED BY THE ENGINEER WILL BE PAID FOR ACCORDING TO ARTICLE 109.04.

NO COMMITMENTS

FILE NAME =	USER NAME = eustinn1	DESIGNED -	REVISED -	STATE OF ILLINOIS DEPARTMENT OF TRANSPORTATION	GENERAL NOTES	F.A. RTE.	SECTION	COUNTY	TOTAL SHEETS	SHEET NO.
ca\projects\4578736\cad\sheet\4578736-1	tt-gannote.dgn	DRAWN -	REVISED -			VAR.	D5 CRACK & JOINT SEAL 2009-1	MCLEAN	21	8
	PLOT SCALE = 100.0000 ' / IN.	CHECKED -	REVISED -							CONTRACT NO. 70736
	PLOT DATE = 10/14/2008	DATE -	REVISED -		SCALE:					FED. ROAD DIST. NO. ILLINOIS FED. AID PROJECT
					SHEET NO.	OF	SHEETS	STA.	TO	STA.

SUMMARY OF QUANTITIES

LOCATION OF WORK: VARIOUS ROUTES
D5 CRACK & JOINT SEAL 2009-1
MCLEAN COUNTY

MCLEAN CO.
RURAL
100% STATE
ROUT & SEAL
F000
TOTAL
QUANTITY

CONSTRUCTION TYPE CODE:

CODE NO	ITEM	UNIT	TOTAL QUANTITY
45100100	CRACK ROUTING (PAVEMENT)	FOOT	407,786.0
45100200	CRACK FILLING	POUND	163,116.0
67100100	MOBILIZATION	L SUM	1.0
70100460	TRAFFIC CONTROL AND PROTECTION, STANDARD 701306	L SUM	1.0
70100700	TRAFFIC CONTROL AND PROTECTION, STANDARD 701406	L SUM	1.0
*78001110	PAINT ^{PAVEMENT} MARKING - LINE 4"	FOOT	29,491.0
X7015005	CHANGEABLE MESSAGE SIGN	CAL DA	28.0

* SPECIALTY ITEM

FILE NAME =	USER NAME = austinr1	DESIGNED -	REVISED -	STATE OF ILLINOIS DEPARTMENT OF TRANSPORTATION	SUMMARY OF QUANTITIES	F.A. RTE.	SECTION	COUNTY	TOTAL SHEETS	SHEET NO.	
c:\projects\d570736\cedsheets\d570736-1	trsoq.dgn	DRAWN -	REVISED -			VAR.	D5 CRACK & JOINT SEAL 2009-1	MCLEAN	21	9	
PLOT SCALE = 40,0000' / IN.	CHECKED -	REVISED -				CONTRACT NO. 70736					
PLOT DATE = 10/14/2008	DATE -	REVISED -				SCALE:	SHEET NO.	OF	SHEETS	STA.	TO STA.

SCHEDULE OF QUANTITIES

LOCATION OF WORK: VARIOUS ROUTES
D5 CRACK AND JOINT SEAL 2009-1
MCLEAN COUNTY

IL 9	US 136	I-55	US 136	US 24
FAP 693	FAP 315	F.A.I. 55	FAP 315	FAP 317
MCLEAN CO.	MCLEAN CO.	MCLEAN CO.	MCLEAN CO.	MCLEAN CO.
2-LANE RURAL	2-LANE RURAL	4-LANE RURAL	2-LANE RURAL	2-LANE RURAL
100% STATE	100% STATE	100% STATE	100% STATE	100% STATE
ROUT & SEAL	ROUT & SEAL	ROUT & SEAL	ROUT & SEAL	ROUT & SEAL
LOCATION #1	LOCATION #2	LOCATION #3	LOCATION #4	LOCATION #5

CODE NO.	ITEM	UNIT	TOTAL QUANTITY					
45100100	CRACK ROUTING (PAVEMENT)	FOOT	407,786.0	59,336.0	95,039.0	116,882.0	59,518.0	77,011.0
45100200	CRACK FILLING	POUND	163,116.0	23,735.0	38,016.0	46,753.0	23,808.0	30,804.0
67100100	MOBLIZATION	L SUM	1.0	0.1	0.2	0.2	0.1	0.2
70100460	TRAFFIC CONTROL & PROT. 701306	L SUM	1.0	0.2	0.4	0.0	0.2	0.2
70100700	TRAFFIC CONTROL & PROT. 701406	L SUM	1.0	0.0	0.0	0.5	0.0	0.0
78001110	PAINT PAVE.MRK.-4"	FOOT	29,491.0	7,460.0	7,440.0	0.0	8,955.0	5,636.0
X7015005	CHANGEABLE MESSAGE SIGN	CAL DAY	28.0	0.0	0.0	28.0	0.0	0.0

FILE NAME =	USER NAME = austinr1	DESIGNED -	REVISED -	STATE OF ILLINOIS DEPARTMENT OF TRANSPORTATION	SCHEDULE OF QUANTITIES	F.A. RTE.	SECTION	COUNTY	TOTAL SHEETS	SHEET NO.	
ct\projects\4570736\cad\sheet\4570736-s	tr-schedule.dgn	DRAWN -	REVISED -			VAR.	D5 CRACK & JOINT SEAL 2009-1	MCLEAN	21	10	
	PLOT SCALE = 43.4288' / IN.	CHECKED -	REVISED -			CONTRACT NO. 70736					
	PLOT DATE = 10/14/2008	DATE -	REVISED -			SCALE:	SHEET NO.	OF	SHEETS	STA.	TO
						FED. ROAD DIST. NO. ILLINOIS FED. AID PROJECT					

EXISTING TYPICAL SECTION – FAP 693 (IL 9)

STATION TO STATION
 0+00.00 71+75.00
 78+75.00 373+81.00

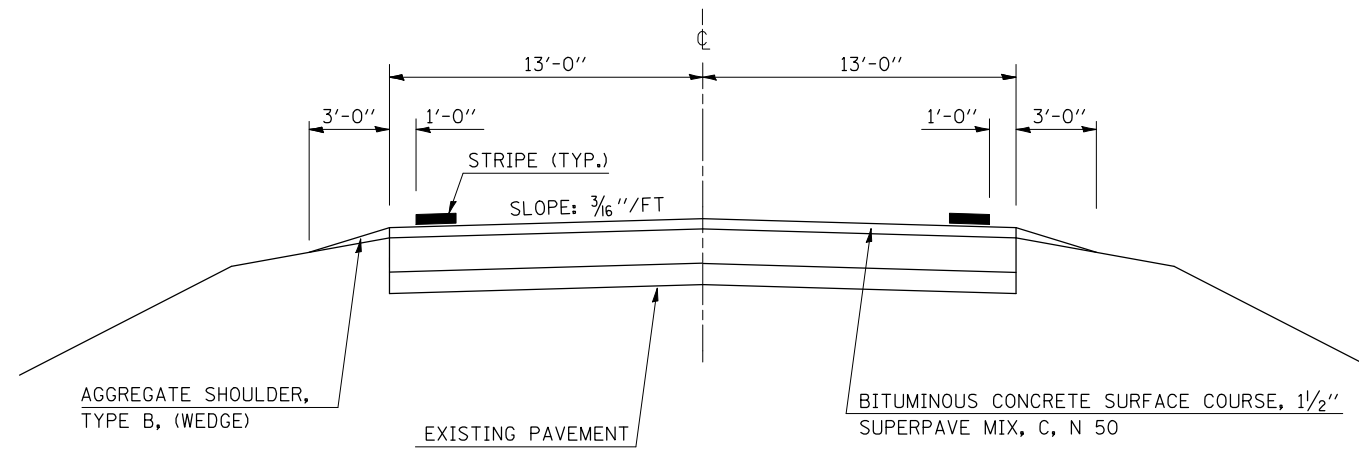

EXISTING TYPICAL SECTION – FAP 693 (IL 9)

STATION TO STATION
 71+75.00 78+75.00

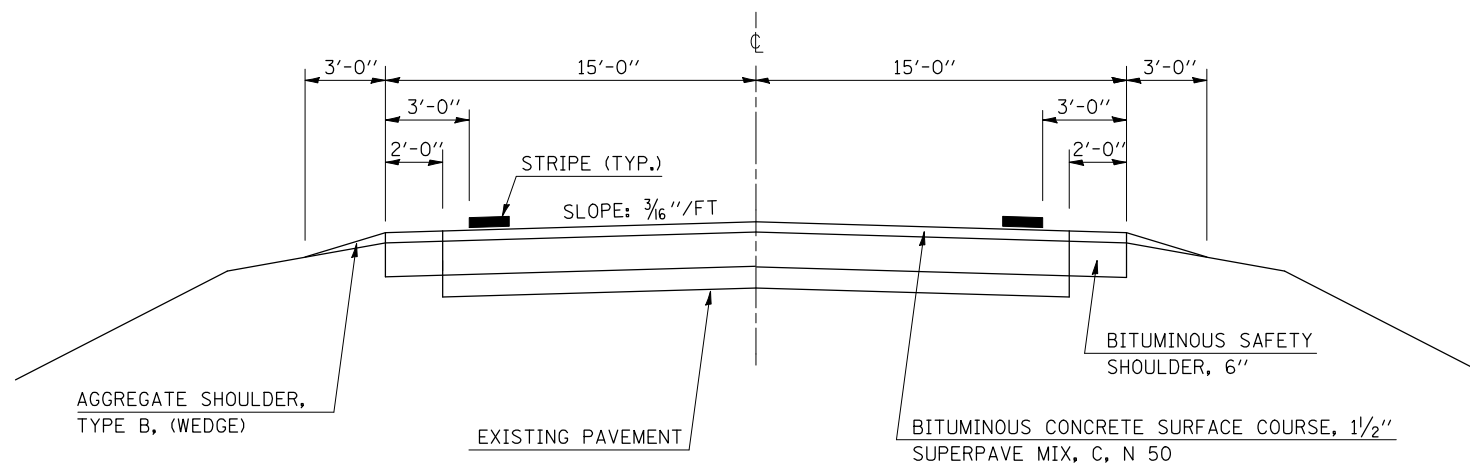

LOCATION #1

FILE NAME =	USER NAME = austinr1	DESIGNED - RLA	REVISED -	STATE OF ILLINOIS DEPARTMENT OF TRANSPORTATION	EXISTING TYPICAL SECTIONS			F.A. RTE.	SECTION	COUNTY	TOTAL SHEETS	SHEET NO.
ct:\projects\d570736\cad\sheet\d570736-sh1-typical.dgn	DRAWN - RLA	REVISED -	VAR.					D5 CRACK & JOINT SEAL 2009-1	MCLEAN	21	11	
PLOT SCALE = 100.0000' / IN.	CHECKED - JMS	REVISED -	CONTRACT NO. 70736									
PLOT DATE = 10/14/2008	DATE - 08-2008	REVISED -	SCALE: N/A		SHEET NO.	OF SHEETS	STA.	TO STA.	FED. ROAD DIST. NO.	ILLINOIS FED. AID PROJECT		

EXISTING TYPICAL SECTION – FAP 709 (US 136)

STATION TO STATION
785+70.00 786+56.00

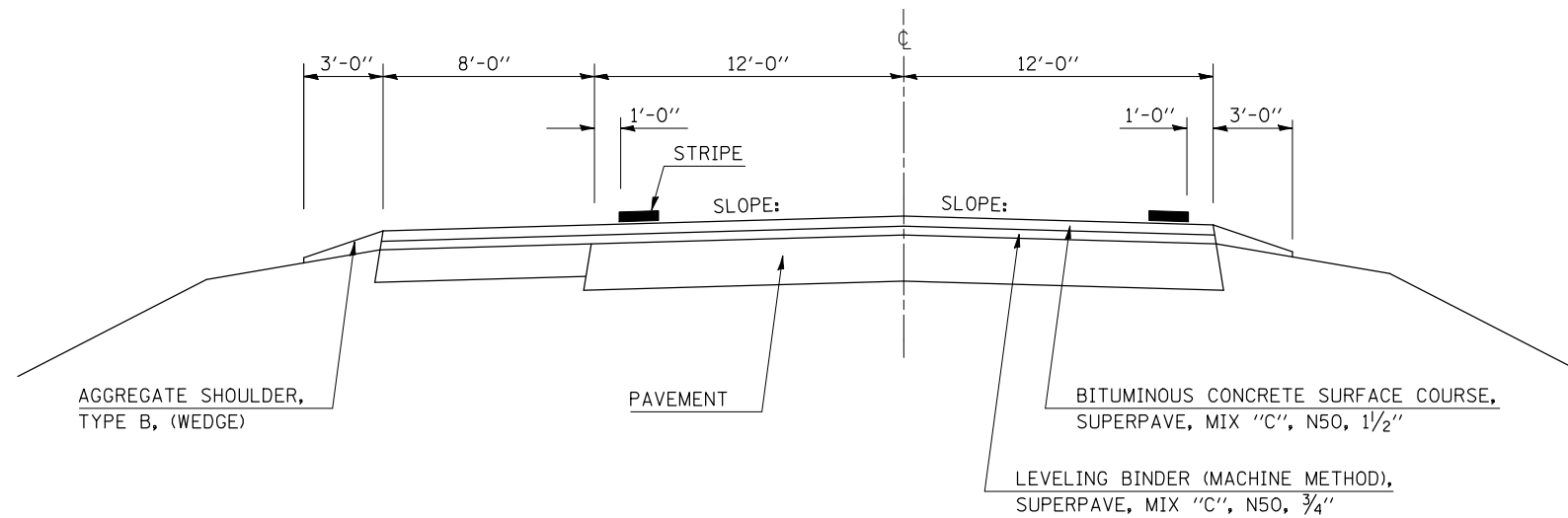

EXISTING TYPICAL SECTION – FAP 709 (US 136)

STATION TO STATION
786+56.00 1006+16.00
1031+42.00 1066+47.00
1068+42.00 1159+69.00
1006+16.00 1031+42.00

STRUCTURE OMISSION
STA. 1066+47.00 TO STA. 1068+42.00

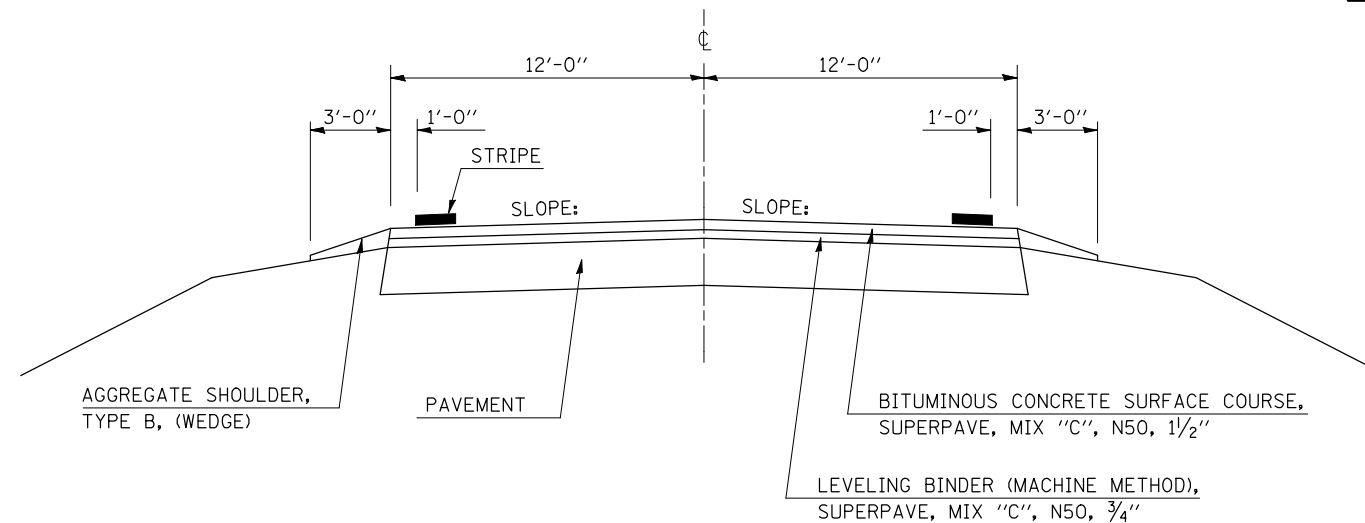

LOCATION #2

FILE NAME =	USER NAME = austinr1	DESIGNED - RLA	REVISED -	STATE OF ILLINOIS DEPARTMENT OF TRANSPORTATION	EXISTING TYPICAL SECTIONS			F.A. RTE.	SECTION	COUNTY	TOTAL SHEETS	SHEET NO.	
ct:\projects\d570736\cadsheets\d570736-sh-typical.dgn		DRAWN - RLA	REVISED -		SCALE: N/A	SHEET NO.	OF SHEETS	STA.	TO STA.	VAR. D5 CRACK & JOINT SEAL 2009-1	MCLEAN	21	12
PLOT SCALE = 100.0000' / IN.		CHECKED - JMS	REVISED -										
PLOT DATE = 10/14/2008		DATE - 08-2008	REVISED -										
										CONTRACT NO. 70736			
										FED. ROAD DIST. NO. ILLINOIS FED. AID PROJECT			

EXISTING TYPICAL SECTION – F.A.I. 55 (I-55)

STATION	TO	STATION
683+50.00		783+37.73 (BK)
74+89.65 (AH)		118+22.11
175+82.21		376+47.95
425+45.20		432+80.00

STATION EQUATION:
 STA. 783+30.73 (BK) = STA. 74+89.65 (AH)

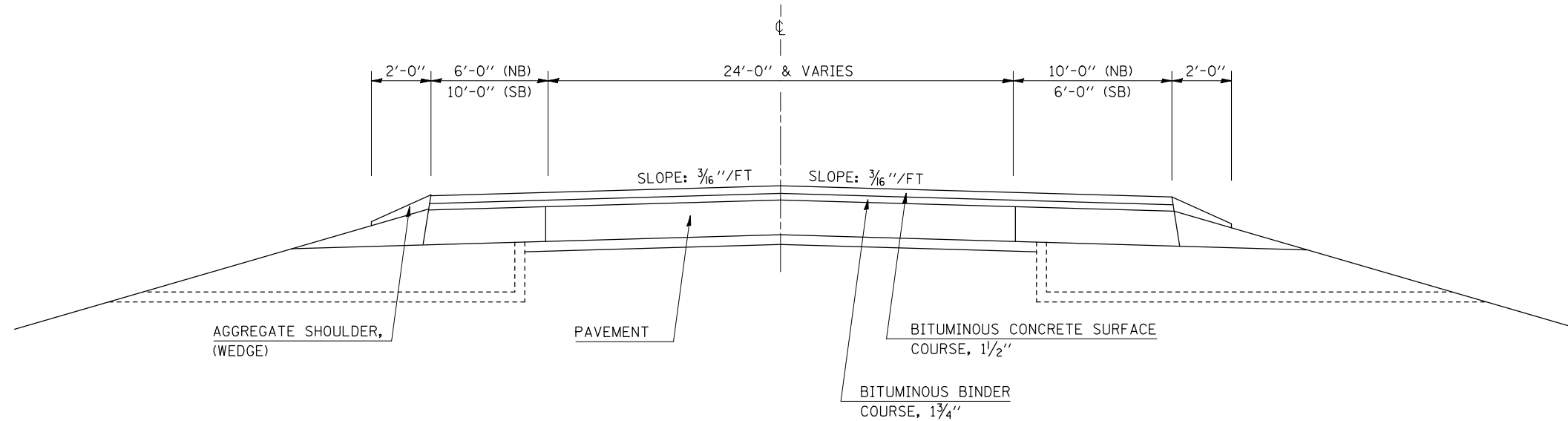

EXISTING TYPICAL SECTION – F.A.I. 55 (I-55)

STATION	TO	STATION
587+34.90		683+50.00
118+22.11		175+82.21
376+47.95		381+37.19 (BK)
376+50.00 (AH)		425+45.20

STATION EQUATION:
 STA. 381+37.19 (BK) = STA. 376+50.00 (AH)

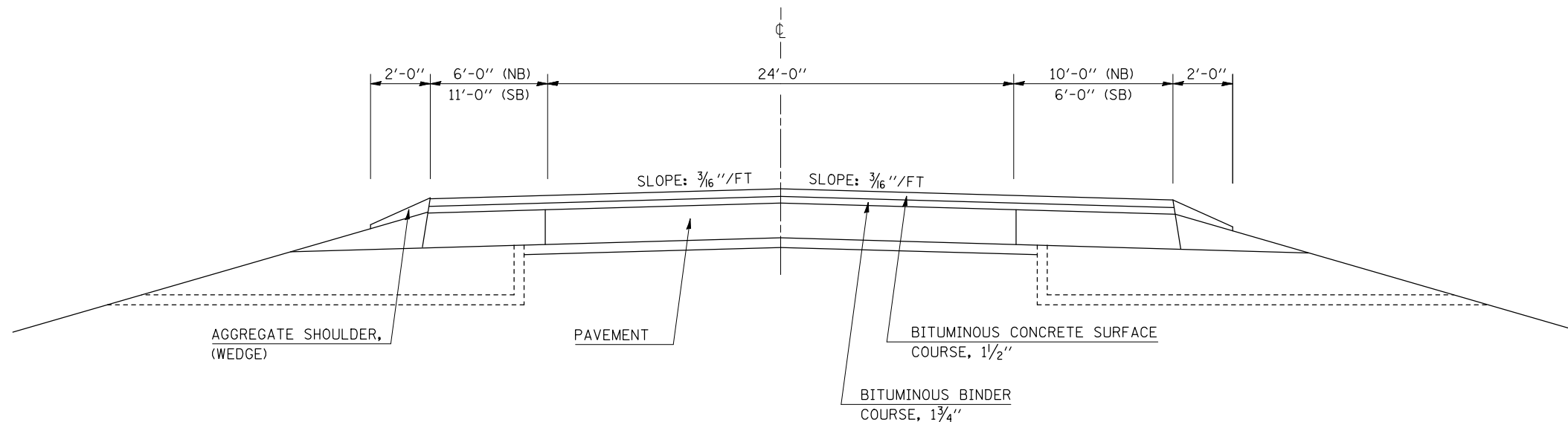

LOCATION #3

FILE NAME =	USER NAME = austinr1	DESIGNED - RLA	REVISED -
ct:\projects\d570736\cadsheets\d570736-sh-typical.dgn		DRAWN - RLA	REVISED -
PLOT SCALE = 100.0000' / IN.		CHECKED - JMS	REVISED -
PLOT DATE = 10/14/2008		DATE - 08-2008	REVISED -

**STATE OF ILLINOIS
 DEPARTMENT OF TRANSPORTATION**

EXISTING TYPICAL SECTIONS

SCALE: N/A SHEET NO. OF SHEETS STA. TO STA.

F.A. RTE.	SECTION	COUNTY	TOTAL SHEETS	SHEET NO.
VAR.	D5 CRACK & JOINT SEAL 2009-1	MCLEAN	21	13
FED. ROAD DIST. NO. ILLINOIS FED. AID PROJECT			CONTRACT NO. 70736	

EXISTING TYPICAL SECTION – FAP 317 (US 24)

STATION TO STATION
851+20.00 1133+00.00

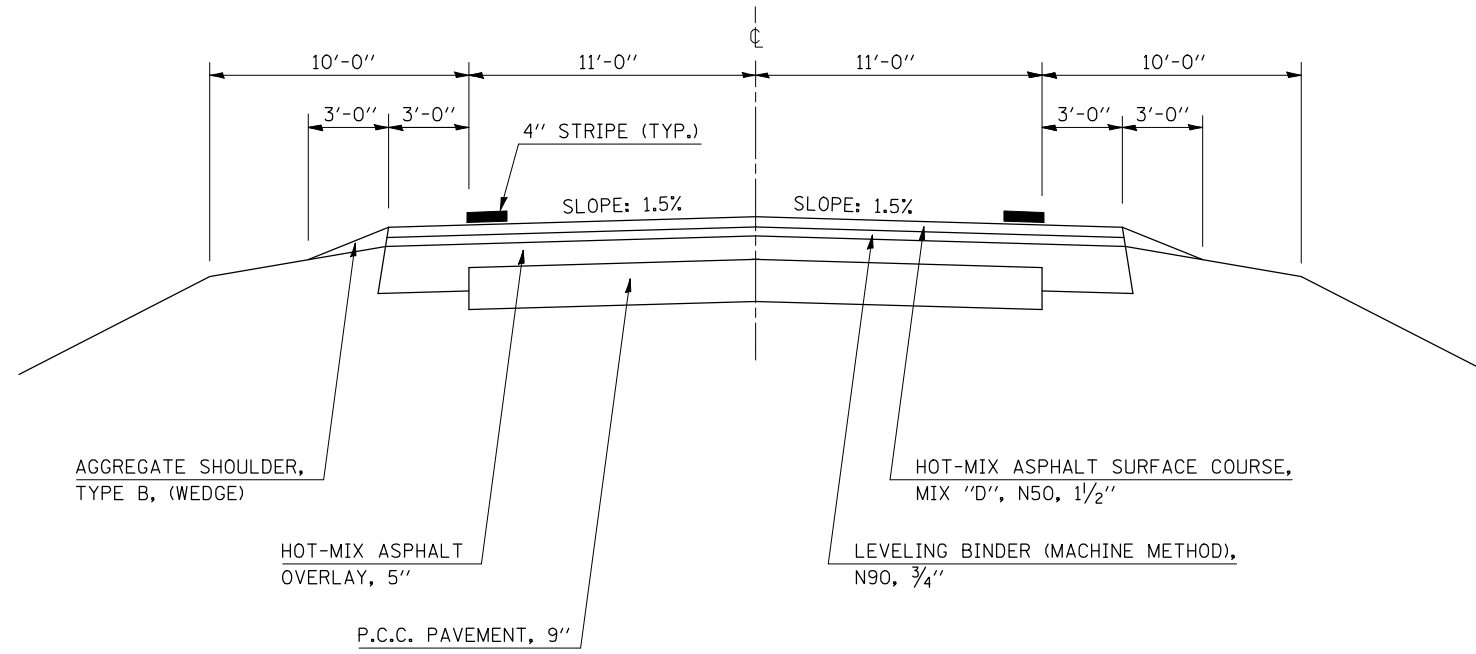

LOCATION #5

FILE NAME =	USER NAME = austinr1	DESIGNED - RLA	REVISED -
ct:\projects\d570736\cadsheets\d570736-sh-typical.dgn		DRAWN - RLA	REVISED -
PLOT SCALE = 100.0000' / IN.		CHECKED - JMS	REVISED -
PLOT DATE = 10/14/2008		DATE - 08-2008	REVISED -

**STATE OF ILLINOIS
DEPARTMENT OF TRANSPORTATION**

EXISTING TYPICAL SECTIONS

SCALE: N/A SHEET NO. OF SHEETS STA. TO STA.

F.A. RTE.	SECTION	COUNTY	TOTAL SHEETS	SHEET NO.
VAR.	D5 CRACK & JOINT SEAL 2009-1	MCLEAN	21	15
FED. ROAD DIST. NO. ILLINOIS FED. AID PROJECT			CONTRACT NO. 70736	

HMA PAVEMENT

(USE PAY ITEMS : 45100100 CRACK ROUTING (PAVEMENT)
AND 45100200 CRACK FILLING)

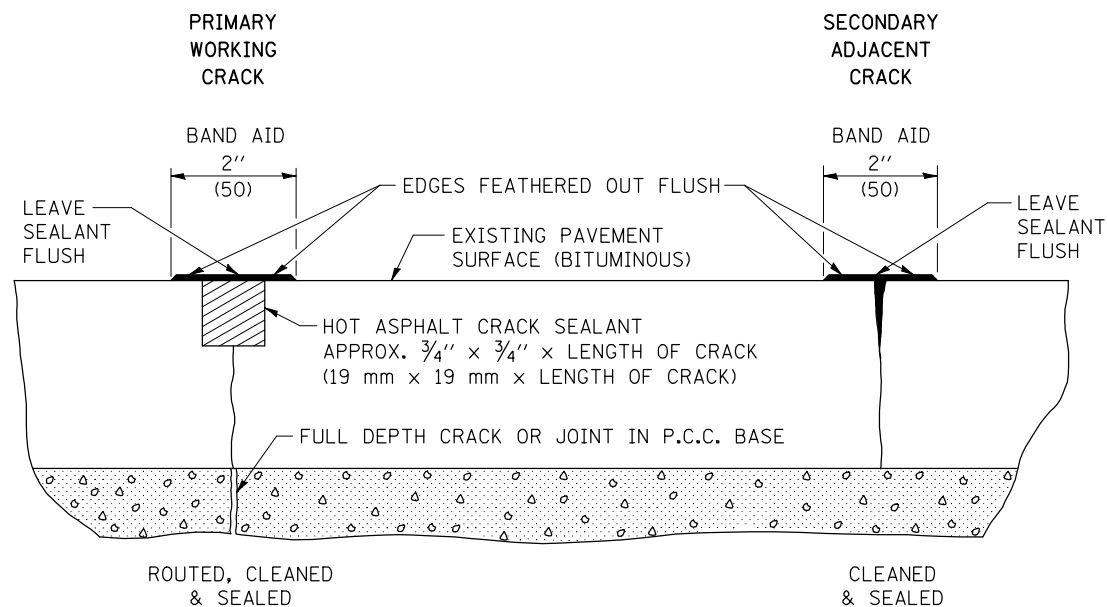

CRACK AND JOINT SEALING

(USE PAY ITEMS : 45200100 JOINT OR CRACK ROUTING (P.C.C. PAVEMENT & SHOULDERS)
AND 45200300 JOINT OR CRACK FILLING)

TRANSVERSE CRACKS AND JOINTS AND CENTERLINE JOINT

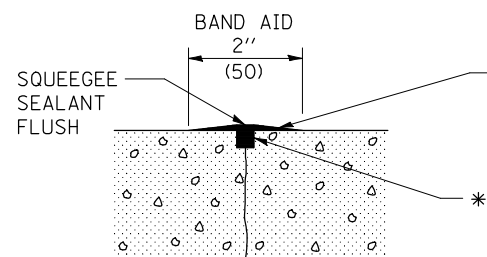

LONGITUDINAL SHOULDER JOINT

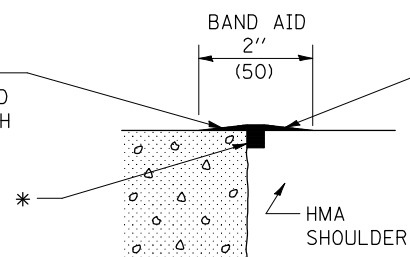

ANY WIDE LONGITUDINAL JOINT OR CRACK

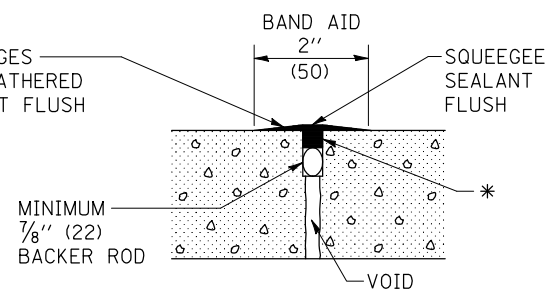

* HOT ASPHALT CRACK SEALANT
APPROX. 3/4" x 3/4" x LENGTH OF CRACK
(19 mm x 19 mm x LENGTH OF CRACK)

LONGITUDINAL RANDOM CRACK

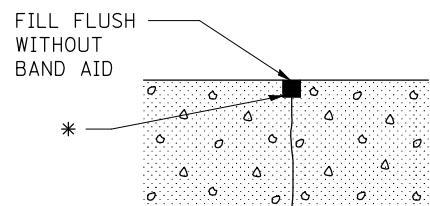

TRANSVERSE EXPANSION JOINT

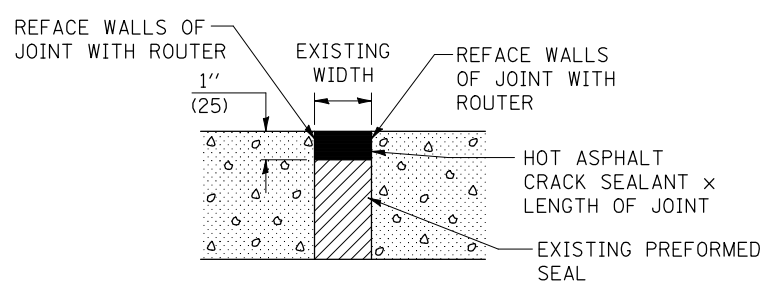

Note: All dimensions are in INCHES
(millimeters) unless otherwise shown.

DISTRICT 5 DETAIL NO. 45AAAAAA

FILE NAME =	USER NAME = austinr1	DESIGNED -	REVISED - 12/06
ct:\projects\d570736\cad\sheet\d570736-shr-detail1.dgn		DRAWN -	REVISED - 08/07
	PLOT SCALE = 40.0000' / IN.	CHECKED -	REVISED -
	PLOT DATE = 10/14/2008	DATE -	REVISED -

STATE OF ILLINOIS
DEPARTMENT OF TRANSPORTATION

CRACK AND JOINT SEALING

SCALE: SHEET NO. OF SHEETS STA. TO STA.

F.A. RTE.	SECTION	COUNTY	TOTAL SHEETS	SHEET NO.
VAR.	D5 CRACK & JOINT SEAL 2009-1	MCLEAN	21	16
			CONTRACT NO. 70736	
FED. ROAD DIST. NO. ILLINOIS FED. AID PROJECT				

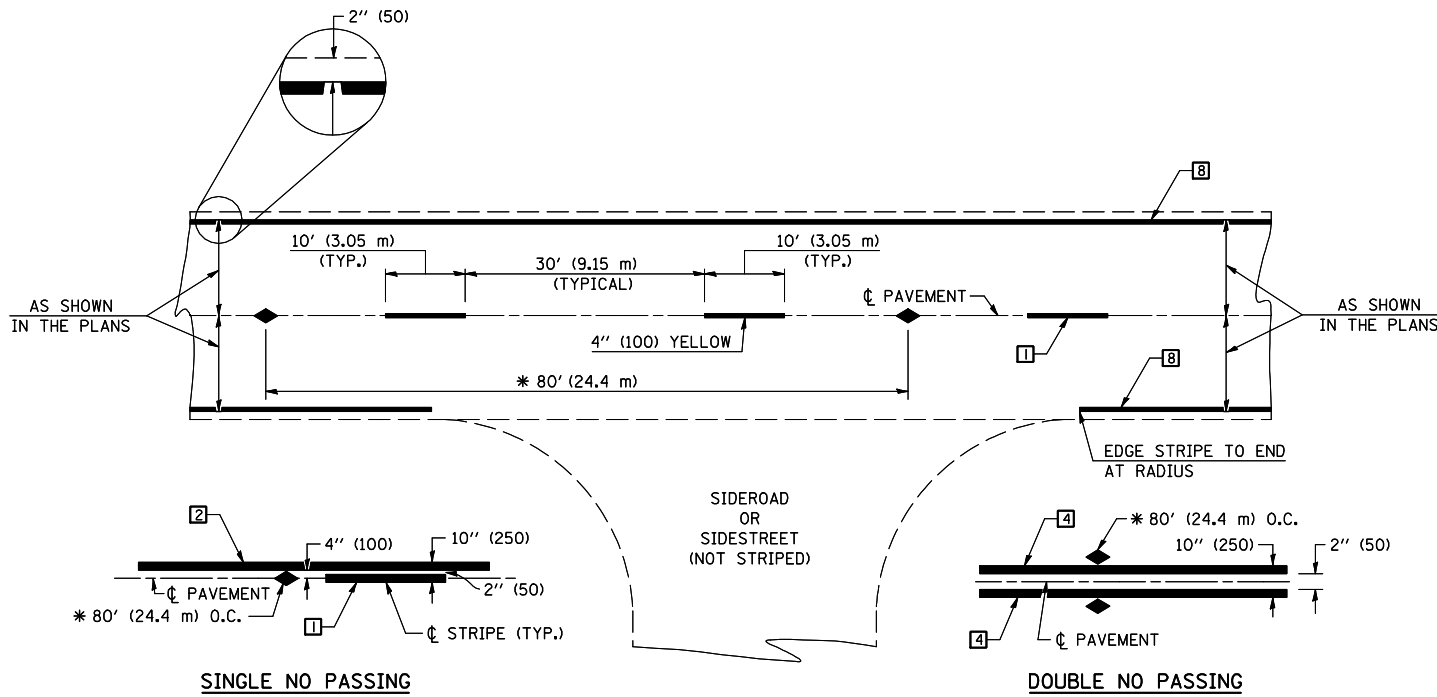

* REDUCE TO 40' (12.2 m) O.C. ON CURVES WITH POSTED OR ADVISORY SPEEDS OF 45 mph (70 km/h) OR LESS.

TWO LANE/TWO WAY

TYPICAL PAVEMENT MARKING LEGEND

- 1 4" (100) SKIP-DASH (YELLOW)
- 2 4" (100) SOLID (YELLOW)
- 3 12" (300) DIAGONAL (YELLOW)
- 4 4" (100) DOUBLE YELLOW (NARROW)
- 5 RESERVED
- 6 RESERVED
- 7 4" (100) SKIP-DASH (WHITE)
- 8 4" (100) SOLID (WHITE)
- 9 12" (300) DIAGONAL (WHITE)
- 10 6" (150) SOLID (WHITE)
- 11 24" (600) STOP BAR (WHITE)
- 12 8" (200) SOLID (WHITE)
- 13 4" (100) LANE LINE EXTENSIONS (WHITE)
- 14 4" (100) PARKING WHITE

TYPICAL PAVEMENT MARKERS LEGEND

- ◆ TWO-WAY AMBER MARKER
- ▶ ONE-WAY AMBER MARKER
- ▷ ONE-WAY CRYSTAL MARKER

RURAL LEFT TURN

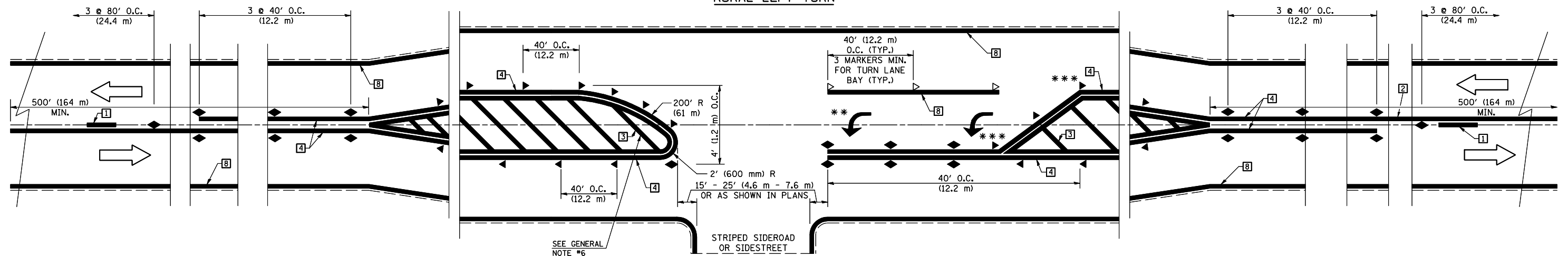

*** REDUCE SPACING IF NECESSARY TO ASSURE MARKERS AT CORNER POINTS.

** TURN ARROWS SHALL BE PLACED AS SHOWN ON SHEET #2.

Note: All dimensions are in INCHES (millimeters) unless otherwise shown.

DISTRICT 5 DETAIL NO. 7800AAA

FILE NAME =	USER NAME = austinr1	DESIGNED -	REVISED - 11/06
ct:\projects\d570736\cad\sheet\d570736-sh1-detailed.dgn		DRAWN -	REVISED -
	PLOT SCALE = 40.0000' / IN.	CHECKED -	REVISED -
	PLOT DATE = 10/14/2008	DATE -	REVISED -

**STATE OF ILLINOIS
DEPARTMENT OF TRANSPORTATION**

**PAVEMENT MARKING AND MARKERS
(RURAL & URBAN APPLICATIONS)**

SCALE: SHEET NO. 1 OF 4 SHEETS STA. TO STA.

F.A. RTE.	SECTION	COUNTY	TOTAL SHEETS	SHEET NO.
VAR. D5 CRACK & JOINT SEAL 2009-1		MCLEAN	21	17
			CONTRACT NO. 70736	
FED. ROAD DIST. NO.		ILLINOIS FED. AID PROJECT		

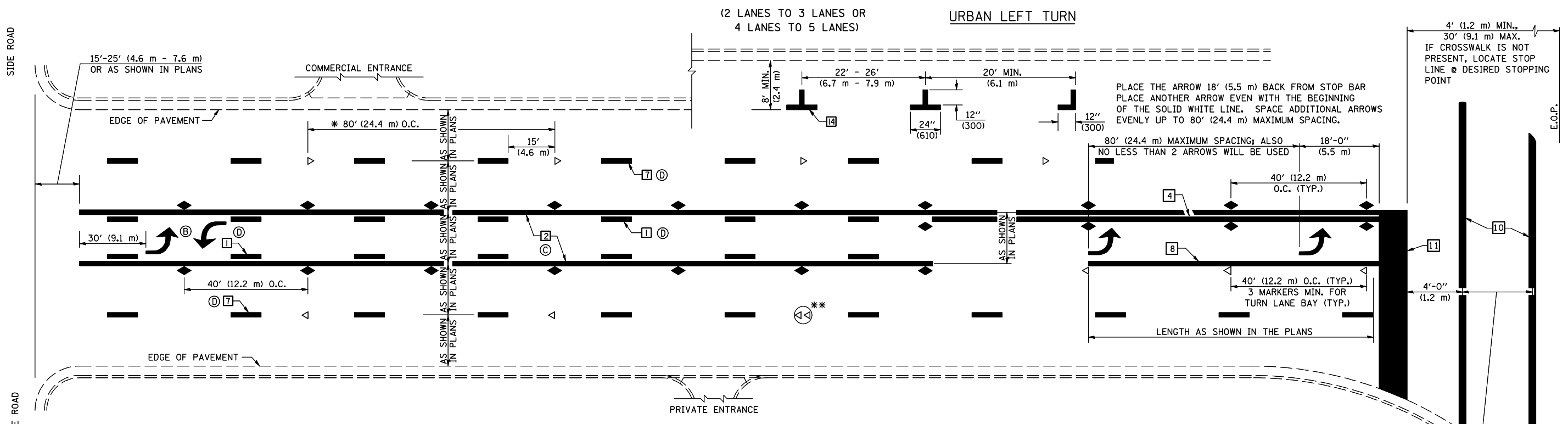

* REDUCE TO 40 FEET (12.2 METERS) ON CENTER ON CURVES WHERE ADVISORY SPEEDS ARE 10 MPH (15 km/h) LOWER THAN POSTED SPEEDS.

** DOUBLE LANE LINE MARKERS SHALL BE SPECIFIED AND SPACED AS SHOWN IN HIGHWAY STANDARD 781001 FOR MULTI-LANE DIVIDED AND UNDIVIDED HIGHWAYS.

- GENERAL NOTES:**
- Ⓑ TURN ARROW PAIRS SHALL BE PLACED AT 250' (75 m) INTERVALS AND SHALL BE EVENLY SPACED BETWEEN BOTH ENDS OF THE BIDIRECTIONAL LEFT TURN LANE.
 - Ⓒ THE SOLID YELLOW PAVEMENT MARKINGS [2] SHOULD GENERALLY START OR END NEAR THE RADIUS POINT OF EACH STREET RETURN EXCEPT WHERE ONE OR BOTH ENDS WOULD INCLUDE STOP BARS.
 - Ⓓ THE SKIP-DASH PAVEMENT MARKINGS [1] OR [7] SHOULD BE CENTERED BETWEEN BOTH ENDS OF EACH CITY BLOCK AND SHALL BE PLACED SO THEY LINE UP ACROSS FROM EACH OTHER. SEE EXAMPLE ON SHEET 2 OF 3.
 - Ⓔ USE LARGE ARROW SIZE FOR BOTH RURAL AND URBAN LOCATIONS. (SEE LAST PAGE OF SECTION 780x FOR SYMBOLS TABLE)

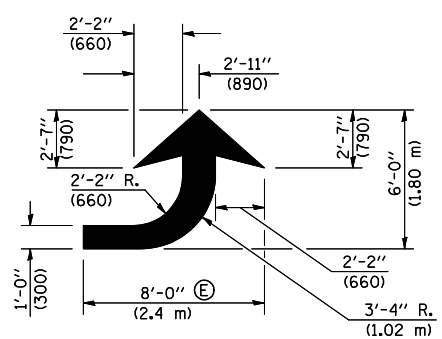

LEFT ARROW
 REVERSE FOR RIGHT ARROW
 AREA = 15.6 SQ. FT. (1.47 m²)
 (WHITE)

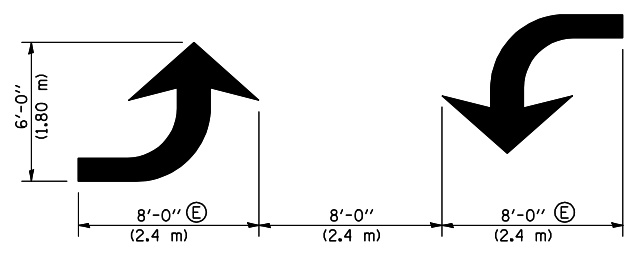

TYPICAL DOUBLE TURN ARROWS (WHITE)

BLOOMINGTON-NORMAL CITY LIMITS ONLY

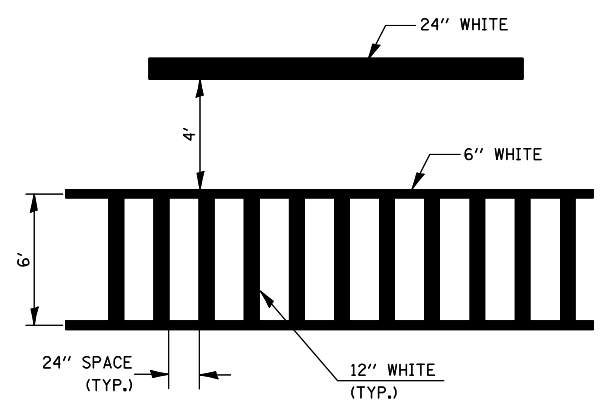

TYPICAL SPACING FOR CROSSWALKS & STOP BARS

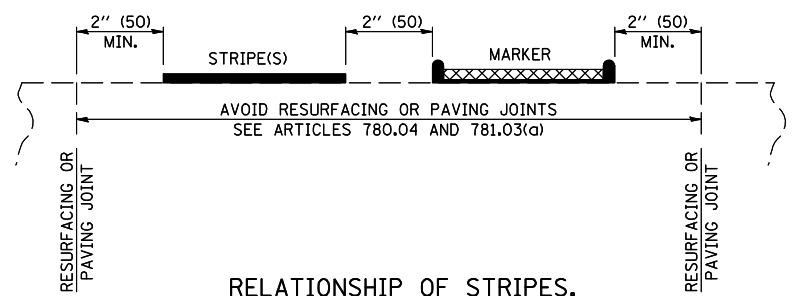

RELATIONSHIP OF STRIPES, MARKERS AND JOINTS

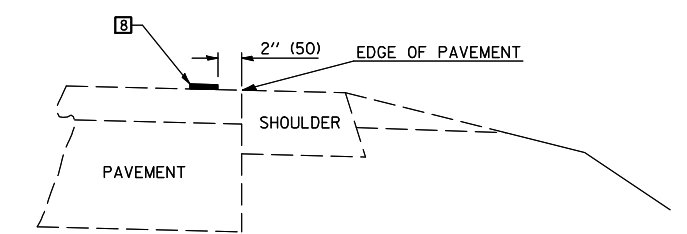

RELATIONSHIP OF EDGE LINE TO EDGE OF PAVEMENT
 (SAFETY SHOULDER OR PAVED SURFACE)
 SEE ARTICLE 780.04

CROSSWALK WIDTH 6'-0" (1.8 m) OR AS SHOWN IN THE PLANS

4' (1.2 m) MIN., 30' (9.1 m) MAX.
 IF CROSSWALK IS NOT PRESENT, LOCATE STOP LINE @ DESIRED STOPPING POINT

Note: All dimensions are in INCHES (millimeters) unless otherwise shown.

FILE NAME =	USER NAME = austinr1	DESIGNED -	REVISED - 11/06
ct:\projects\d570736\cad\sheet\d570736-shd-details.dgn		DRAWN -	REVISED -
		CHECKED -	REVISED -
		DATE -	REVISED -

**STATE OF ILLINOIS
 DEPARTMENT OF TRANSPORTATION**

**PAVEMENT MARKING AND MARKERS
 (RURAL & URBAN APPLICATIONS)**

SCALE: SHEET NO. 2 OF 4 SHEETS STA. TO STA.

DISTRICT 5 DETAIL NO. 7800AAA

F.A. RTE.	SECTION	COUNTY	TOTAL SHEETS	SHEET NO.
VAR.	D5 CRACK & JOINT SEAL 2009-1	MCLEAN	21	18
FED. ROAD DIST. NO.			ILLINOIS FED. AID PROJECT	
			CONTRACT NO. 70736	

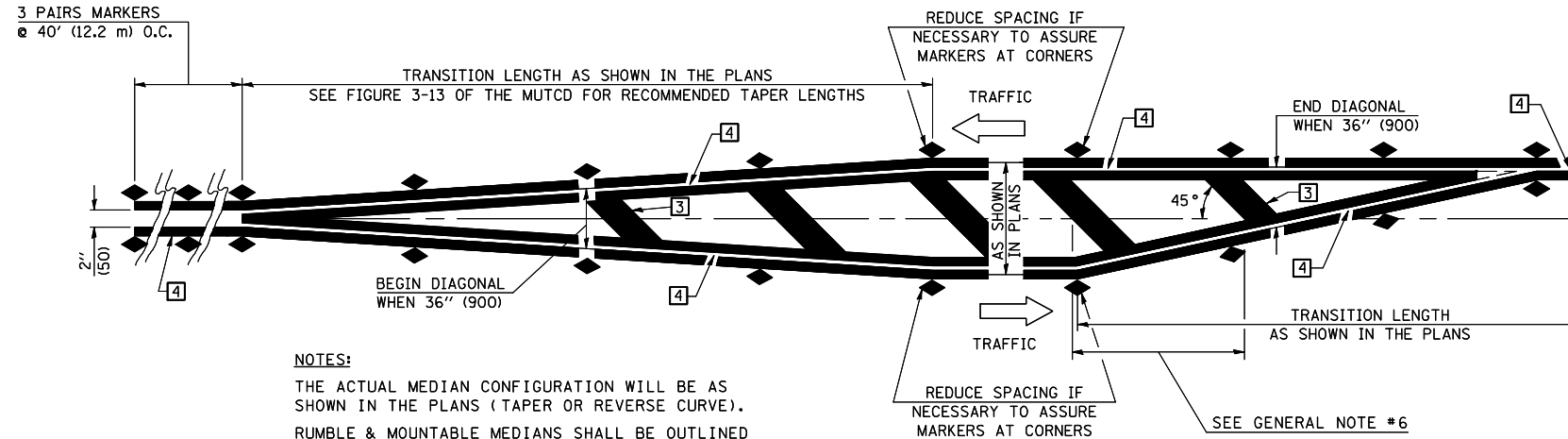

NOTES:
 THE ACTUAL MEDIAN CONFIGURATION WILL BE AS SHOWN IN THE PLANS (TAPER OR REVERSE CURVE).
 RUMBLE & MOUNTABLE MEDIANS SHALL BE OUTLINED WITH [2].

TYPICAL MEDIAN TRANSITIONS

GENERAL NOTES

1. WHEN MEDIANS ARE PRESENT, PAVEMENT MARKINGS ARE TO BE PLACED ADJACENT TO MEDIANS.
2. SOME OF THE INFORMATION INCLUDED WITH THIS DETAIL MAY NOT BE APPLICABLE TO THIS IMPROVEMENT.
3. PAVEMENT MARKINGS ARE TO BE EXTENDED THROUGH OMISSIONS WHEN APPLICABLE.
4. A STRIPING KEY IS AVAILABLE ELSEWHERE AND SHALL BE SHOWN WHERE THE QUANTITIES ARE LISTED.
5. FINAL PAVEMENT MARKINGS SHALL BE IN PLACE PRIOR TO PLACING ANY RAISED REFLECTIVE PAVEMENT MARKERS.
6. THE FOLLOWING CRITERIA SHALL BE USED FOR SELECTING THE DIAGONAL PAVEMENT MARKING SPACING,
 < 30 MPH USE 15' (< 50 km/h USE 4.5 m)
 30-45 MPH USE 20' (50-75 km/h USE 6.0 m)
 > 45 MPH USE 30' (> 75 km/h USE 9.0 m)

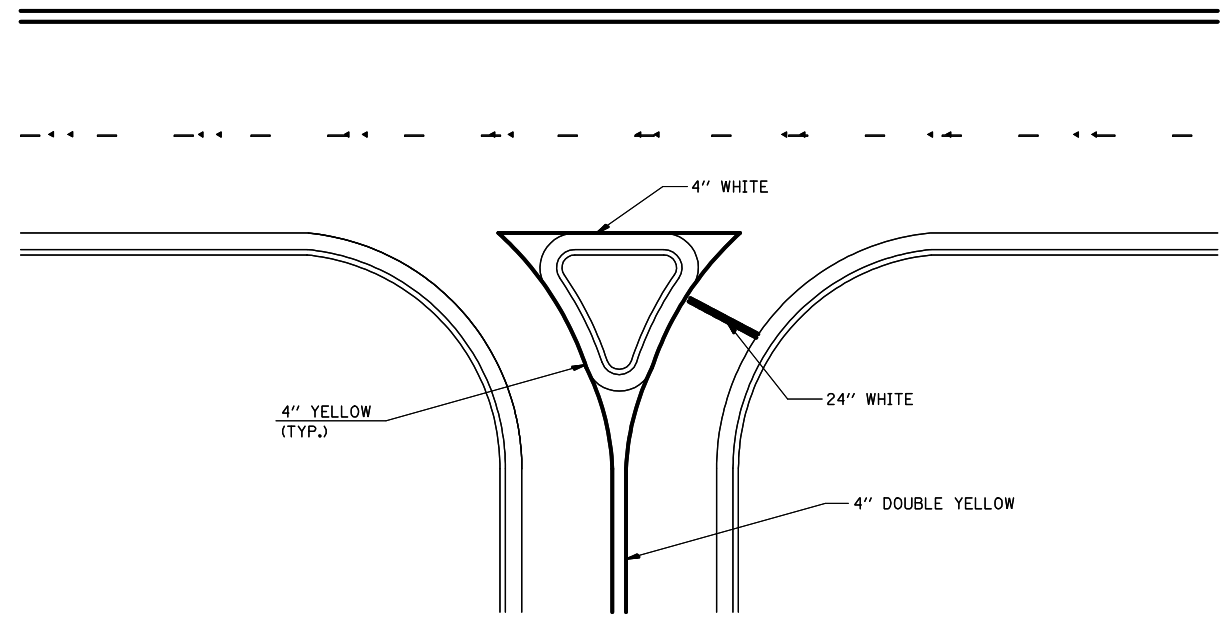

RIGHT IN - RIGHT OUT ACCESS

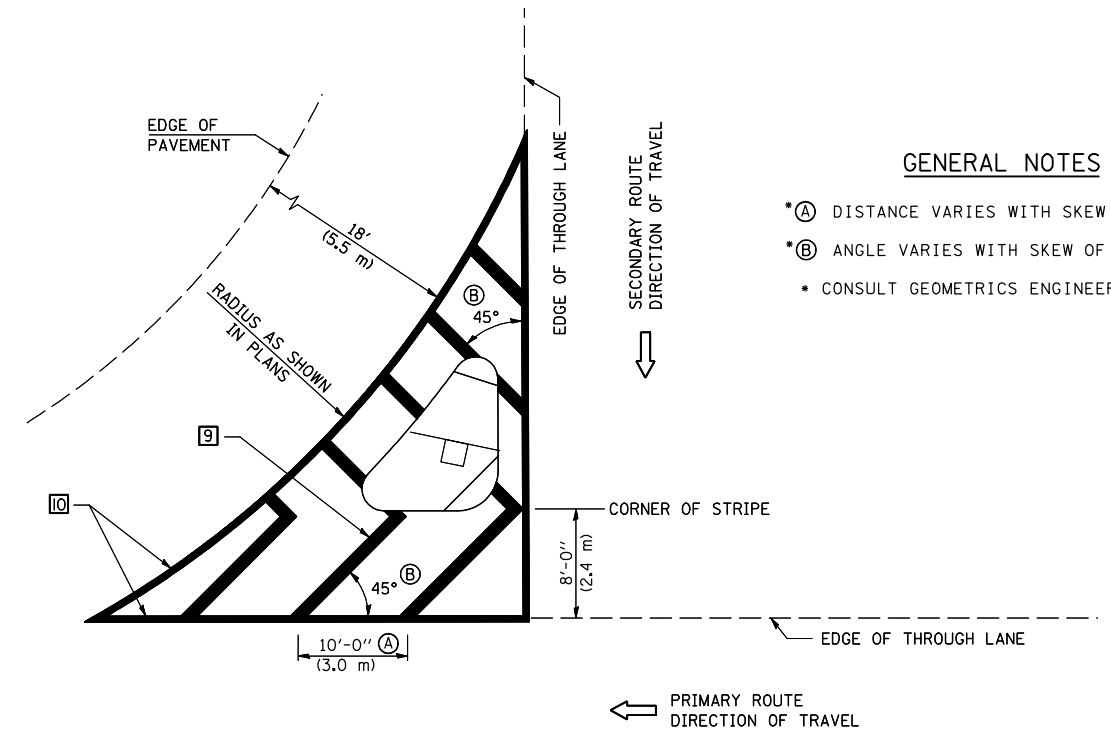

GENERAL NOTES

- *A DISTANCE VARIES WITH SKEW OF INTERSECTION.
- *B ANGLE VARIES WITH SKEW OF INTERSECTION.
- CONSULT GEOMETRICS ENGINEER

ISLAND

Note: All dimensions are in INCHES (millimeters) unless otherwise shown.

FILE NAME =	USER NAME = austinr1	DESIGNED -	REVISED - 11/06
ct:\projects\d570736\cad\sheet\d570736-sh1-detail.dgn		DRAWN -	REVISED -
	PLOT SCALE = 40.0000' / IN.	CHECKED -	REVISED -
	PLOT DATE = 10/14/2008	DATE -	REVISED -

**STATE OF ILLINOIS
 DEPARTMENT OF TRANSPORTATION**

**PAVEMENT MARKING AND MARKERS
 (RURAL & URBAN APPLICATIONS)**

SCALE: SHEET NO. 3 OF 4 SHEETS STA. TO STA.

DISTRICT 5 DETAIL NO. 7800AAA

F.A. RTE.	SECTION	COUNTY	TOTAL SHEETS	SHEET NO.
VAR.	D5 CRACK & JOINT SEAL 2009-1	MCLEAN	21	19
FED. ROAD DIST. NO. ILLINOIS FED. AID PROJECT			CONTRACT NO. 70736	

RAILROAD CROSSING WITH INTERCONNECT ONLY

RAILROAD CROSSING WITH INTERCONNECT AND PRE-SIGNALS

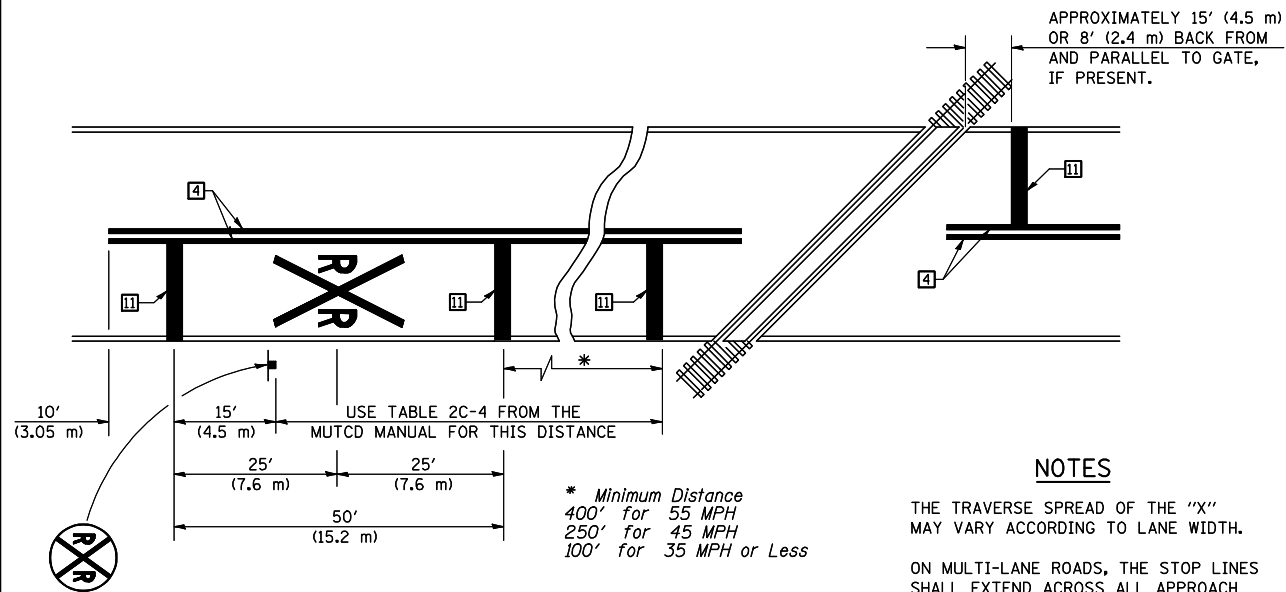

PAVEMENT MARKINGS AT RAILROAD-HIGHWAY GRADE CROSSING

NOTES

THE TRAVERSE SPREAD OF THE "X" MAY VARY ACCORDING TO LANE WIDTH.

ON MULTI-LANE ROADS, THE STOP LINES SHALL EXTEND ACROSS ALL APPROACH LANES AND SEPARATE RXR SYMBOLS SHALL BE PLACED ADJACENT TO EACH OTHER IN EACH LANE.

WHEN THE PAVEMENT MARKING SYMBOL IS USED, A PORTION OF THE SYMBOL SHOULD BE LOCATED DIRECTLY ADJACENT TO THE ADVANCE WARNING SIGN (W10-1) AS PLACED BY TABLE II-1, CONDITION B OF THE MUTCD.

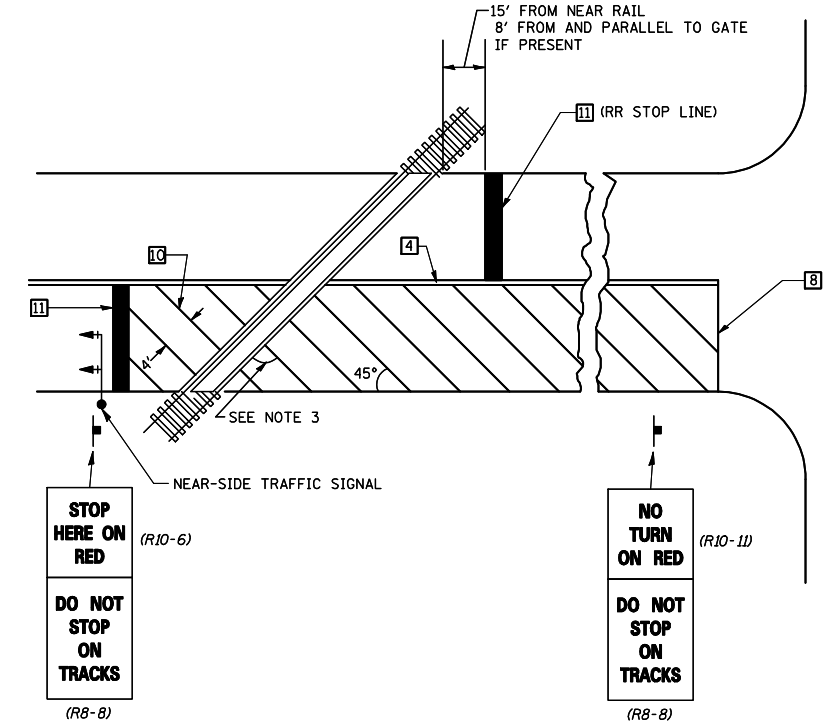
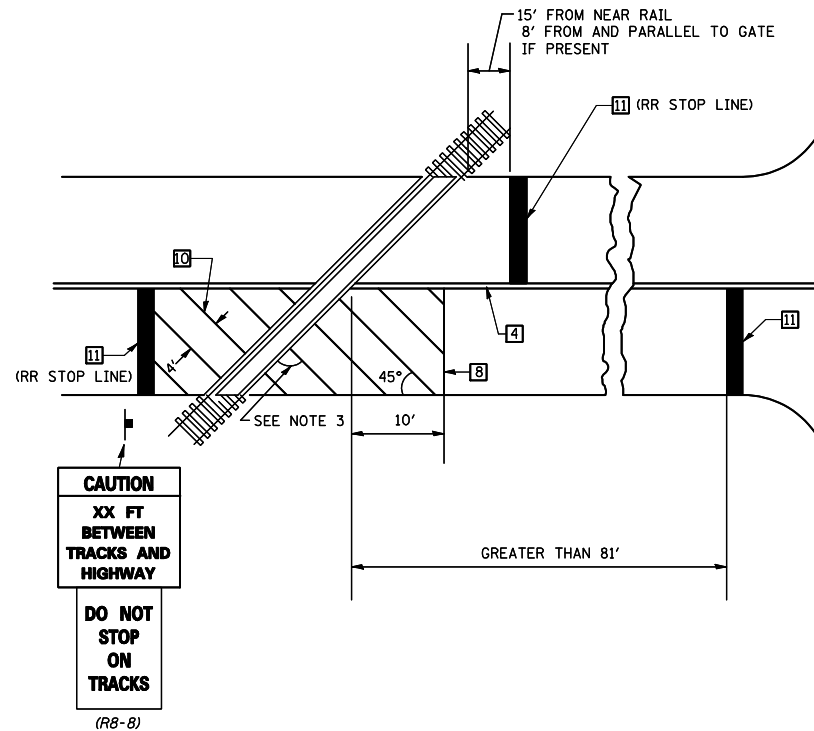

SUPPLEMENTAL PAVEMENT MARKING TREATMENT FOR RAILROAD-HIGHWAY GRADE CROSSING

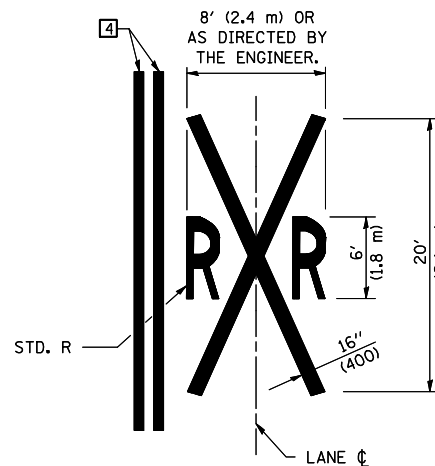

GENERAL NOTES

- SUPPLEMENTAL PAVEMENT MARKINGS TO BE INSTALLED ONLY ON APPROACHES TO INTERSECTIONS CONTROLLED BY TRAFFIC SIGNALS WHICH ARE INTERCONNECTED WITH THE RAILROAD WARNING SIGNALS.
- EXTEND PAVEMENT MARKINGS TO THE INTERSECTION ONLY WHERE NEAR-SIDE TRAFFIC SIGNALS ARE USED.
- WHERE THE ANGLE BETWEEN THE DIAGONAL PAVEMENT MARKINGS AND THE TRACK WOULD BE LESS THAN 20°, THE PAVEMENT MARKINGS SHOULD BE PLACED IN THE OPPOSITE DIRECTION FROM THAT SHOWN.

Note: All dimensions are in INCHES (millimeters) unless otherwise shown.

DISTRICT 5 DETAIL NO. 7800AAAA

FILE NAME =	USER NAME = austinr1	DESIGNED -	REVISED - 11/06
ct:\projects\d570736\cad\sheet\570736-sh1-detailed.dgn		DRAWN -	REVISED -
	PLOT SCALE = 40.0000' / IN.	CHECKED -	REVISED -
	PLOT DATE = 10/14/2008	DATE -	REVISED -

STATE OF ILLINOIS
DEPARTMENT OF TRANSPORTATION

PAVEMENT MARKING AND MARKERS
(RURAL & URBAN APPLICATIONS)

SCALE: SHEET NO. 4 OF 4 SHEETS STA. TO STA.

F.A. RTE.	SECTION	COUNTY	TOTAL SHEETS	SHEET NO.
VAR.	D5 CRACK & JOINT SEAL 2009-1	MCLEAN	21	20
FED. ROAD DIST. NO.			ILLINOIS FED. AID PROJECT	
			CONTRACT NO. 70736	

CENTERLINE INTERSTATE OR MULTI-LANE TWO WAY DIVIDED HIGHWAY

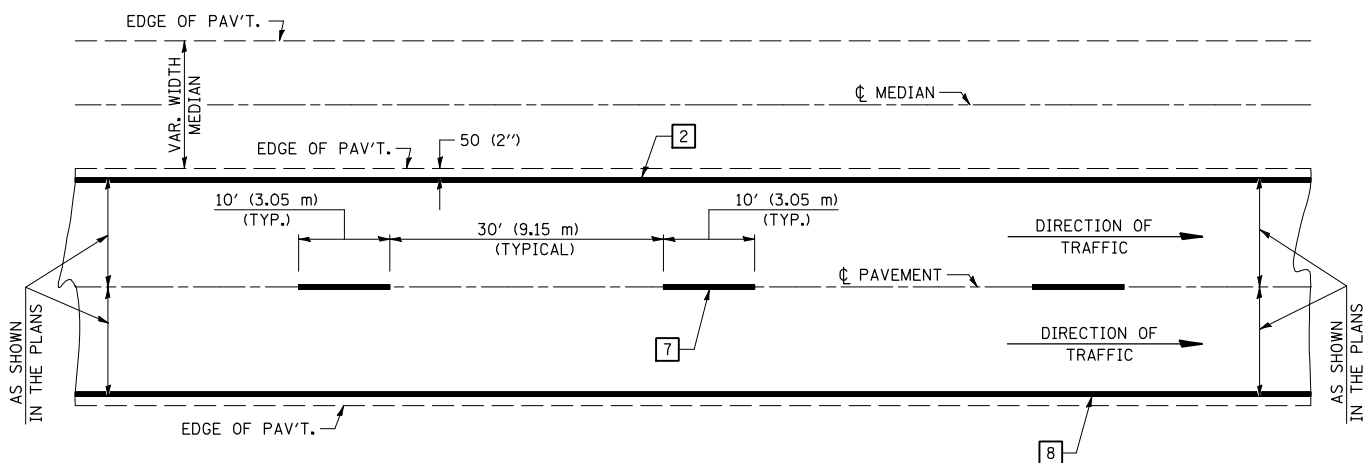

NOTE: PAVEMENT MARKINGS ARE TO BE EXTENDED THROUGH OMISSIONS WHEN APPLICABLE.

NOTE: SEE ARTICLES 780.04 & 781.03 FOR LOCATION OF STRIPES AND MARKERS RELATIVE TO EDGES OR JOINTS.

FOR RAISED REFLECTIVE PAVEMENT MARKERS, REFER TO STANDARD 781001.

TYPICAL EXIT RAMP TERMINAL

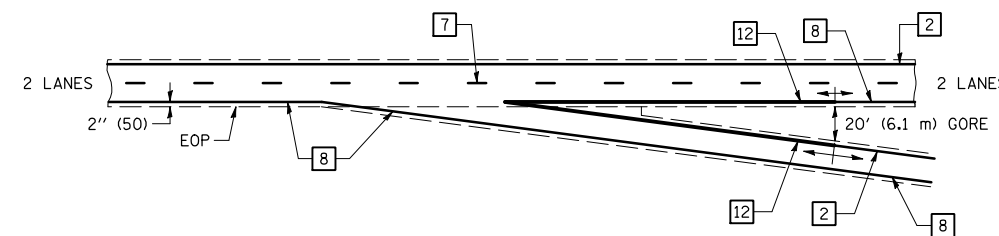

EXIT RAMP TERMINAL with EXCLUSIVE (auxiliary) LANE

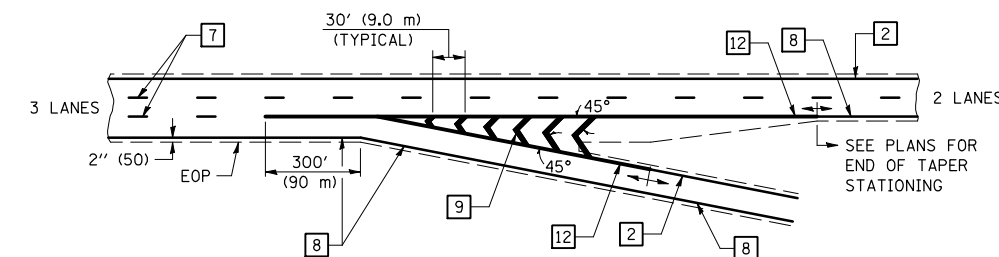

TYPICAL PAVEMENT MARKING LEGEND

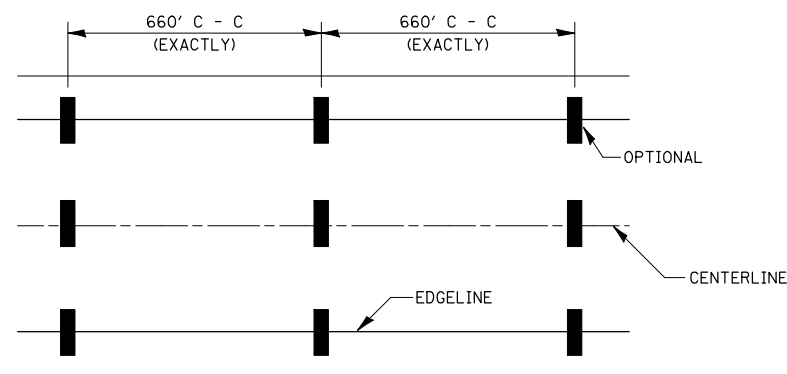

- 1 4" (100) SKIP-DASH (YELLOW)
- 2 4" (100) SOLID (YELLOW)
- 3 12" (300) DIAGONAL (YELLOW)
- 4 4" (100) DOUBLE YELLOW (NARROW)
- 5 RESERVED
- 6 RESERVED
- 7 4" (100) SKIP-DASH (WHITE)
- 8 4" (100) SOLID (WHITE)
- 9 12" (300) DIAGONAL (WHITE)
- 10 6" (150) SOLID (WHITE)
- 11 24" (600) STOP BAR (WHITE)
- 12 8" (200) SOLID (WHITE)
- 13 4" (100) LANE LINE EXTENSIONS (WHITE)

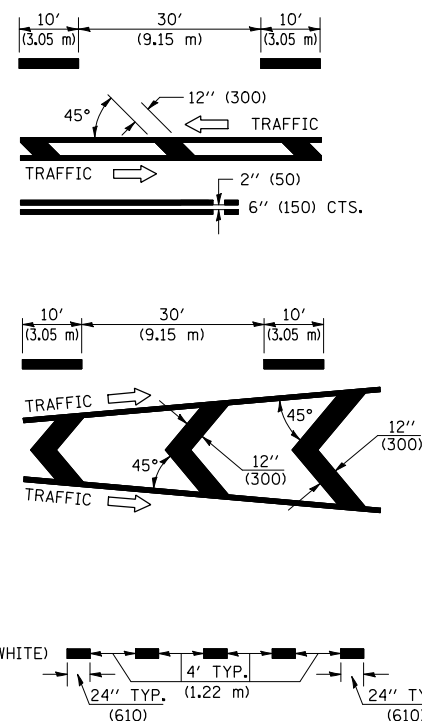

TYPICAL ENTRANCE RAMP TERMINAL

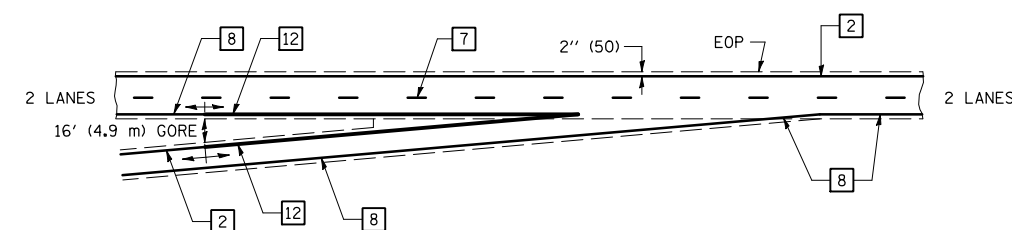

ENTRANCE RAMP TERMINAL with EXCLUSIVE LANE

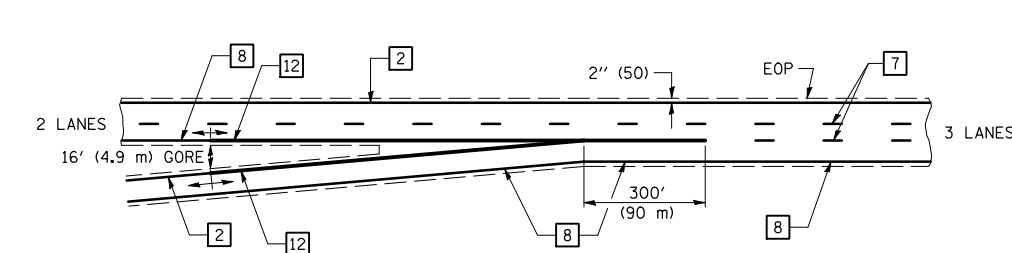

IT WILL BE NECESSARY TO HAVE A REPRESENTATIVE OF THE STATE POLICE PRESENT SO THAT THE ACCURACY OF MEASUREMENT CAN BE ATTESTED TO IN COURT.

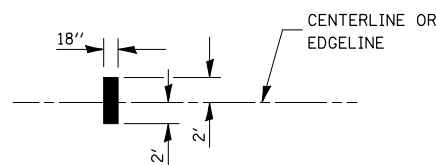

AERIAL SPEED CHECK ZONES

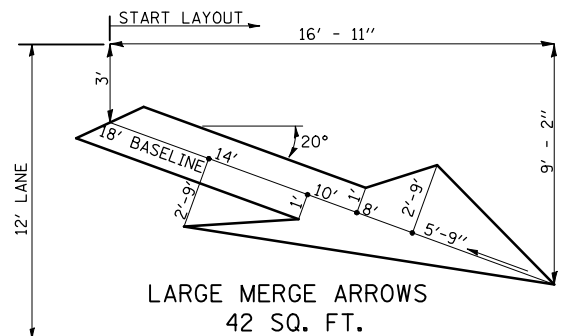

Note: All dimensions are in INCHES (millimeters) unless otherwise shown.

DISTRICT 5 DETAIL NO. 7800BBBB

FILE NAME =	USER NAME = austinr1	DESIGNED -	REVISED - 11/06
ct:\projects\d570736\cad\sheet\d570736-shd-detailed.dgn		DRAWN -	REVISED -
		CHECKED -	REVISED -
		DATE -	REVISED -

**STATE OF ILLINOIS
DEPARTMENT OF TRANSPORTATION**

PAVEMENT MARKING (INTERSTATE & MULTI-LANE APPLICATIONS)

SCALE:	SHEET NO.	OF SHEETS	STA.	TO STA.
--------	-----------	-----------	------	---------

F.A. RTE.	SECTION	COUNTY	TOTAL SHEETS	SHEET NO.
VAR.	D5 CRACK & JOINT SEAL 2009-1	MCLEAN	21	21
CONTRACT NO. 70736				
FED. ROAD DIST. NO. ILLINOIS FED. AID PROJECT				