

LOCATION #3 – FAP ROUTE 323 (US 36) THRU TUSCOLA TO CAMARGO

(RURAL 2-LANE)

DOUGLAS COUNTY

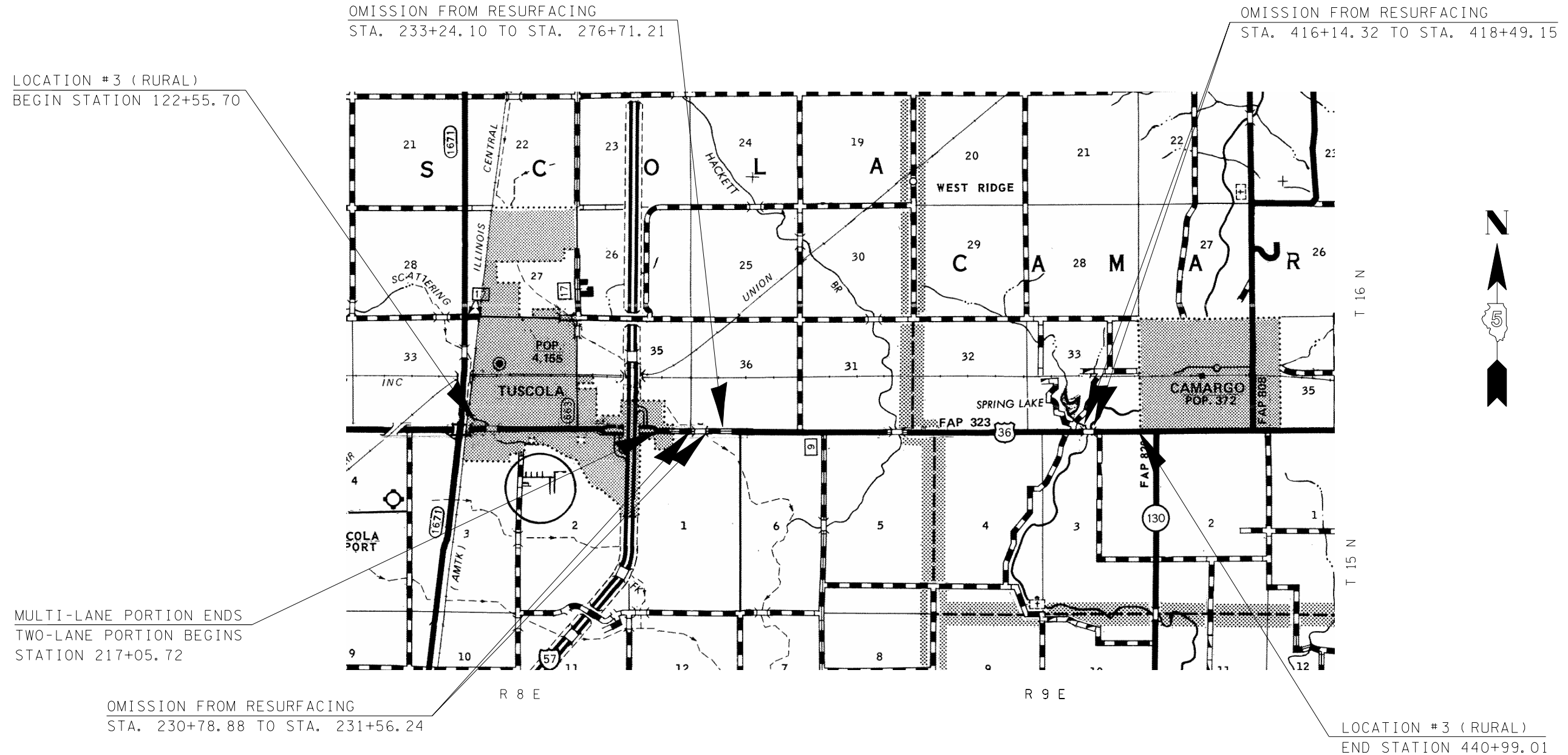

TOTAL LENGTH OF LOCATION #3 = 31,843.3 FEET = 6.03 MILES
NET LENGTH OF LOCATION #3 = 27,184.0 FEET = 5.15 MILES

FILE NAME =	USER NAME = phillipsjr	DESIGNED - RLA	REVISED -
ci:\projects\d570737\cad\sheet5\d570737-sh1-plan.dgn		DRAWN - RLA	REVISED -
	PLOT SCALE = 40.0000 ' / IN.	CHECKED - JMS	REVISED -
	PLOT DATE = 10/22/2008	DATE - 10/07/08	REVISED -

**STATE OF ILLINOIS
DEPARTMENT OF TRANSPORTATION**

LOCATION MAPS			
SCALE:	SHEET NO.	OF SHEETS	STA. TO STA.

F.A. RTE.	SECTION	COUNTY	TOTAL SHEETS	SHEET NO.
VAR.	*	**	42	5
CONTRACT NO. 70737				
FED. ROAD DIST. NO. ILLINOIS FED. AID PROJECT				

*D5 CRACK & JOINT SEAL 2009-2
**CHAMPAIGN, DOUGLAS AND VERMILION