

LOCATION #5 – F.A.P. ROUTE 804 (US 150) SPRINGFIELD AVE. FROM PROSPECT AVE. TO PRAIRIE ST. IN CHAMPAIGN

URBAN 3-LANE CHAMPAIGN COUNTY

LOCATION #5 (URBAN)
BEGIN STATION 366+38.17

LOCATION #5 (URBAN)
END STATION 27+30.00

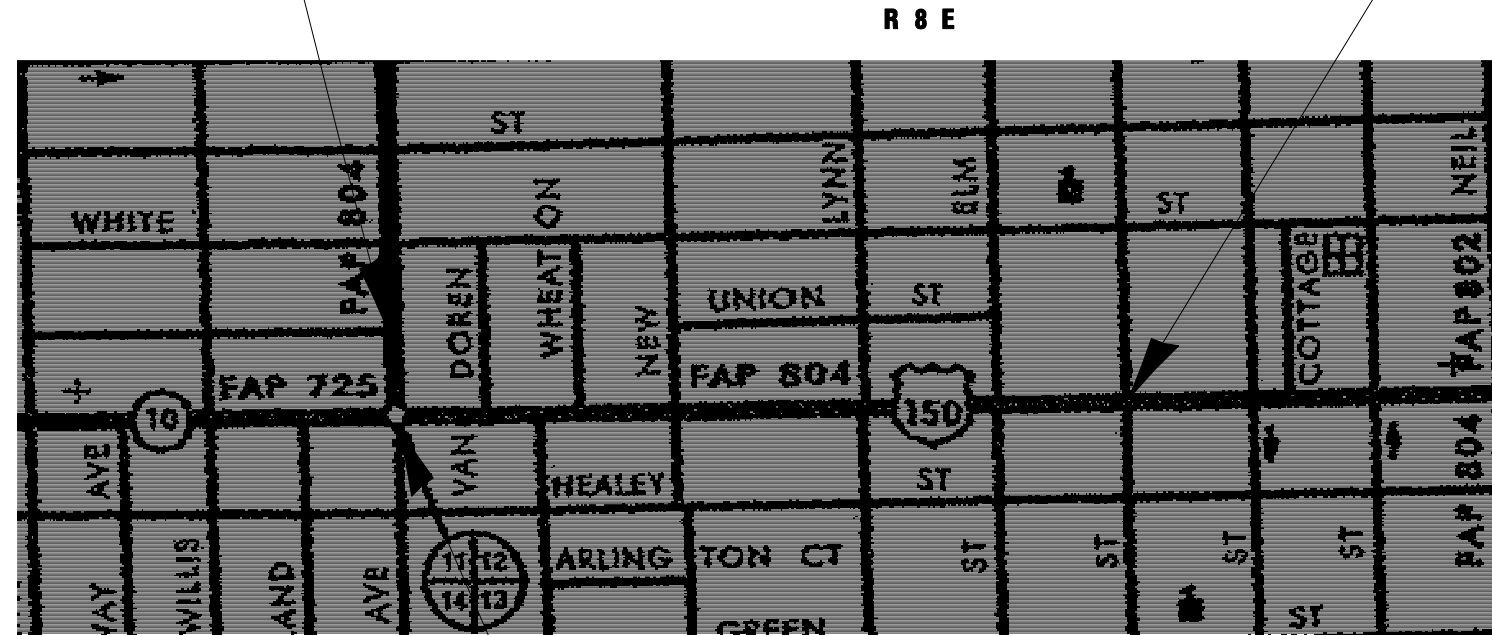

STATION EQUATION
 STA. 369+42.18 (SPRINGFIELD AVE.) BK =
 STA. 32+00.00 (SPRINGFIELD AVE.) AH =
 STA. 100+00.00 (PROSPECT AVE.)

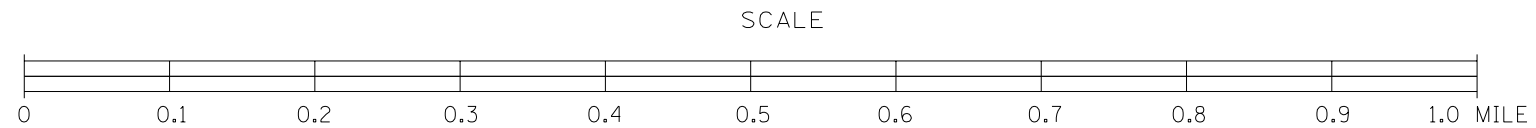

TOTAL LENGTH OF LOCATION #5 = 3,033.0 FEET = 0.574 MILES
NET LENGTH OF LOCATION #5 = 3,033.0 FEET = 0.574 MILES

*D5 CRACK & JOINT SEAL 2009-2
 ** CHAMPAIGN, DOUGLAS AND VERMILION

FILE NAME =	USER NAME = phillipsjr	DESIGNED - RLA	REVISED -
ci:\projects\d570737\cad\sheet\5\d570737-sh1-plan.dgn		DRAWN - RLA	REVISED -
	PLOT SCALE = 40.0000 ' / IN.	CHECKED - JMS	REVISED -
	PLOT DATE = 10/22/2008	DATE - 10/07/08	REVISED -

**STATE OF ILLINOIS
DEPARTMENT OF TRANSPORTATION**

LOCATION MAPS

SCALE: SHEET NO. OF SHEETS STA. TO STA.

F.A. RTE.	SECTION	COUNTY	TOTAL SHEETS	SHEET NO.
VAR.	*	**	42	7
FED. ROAD DIST. NO. ILLINOIS FED. AID PROJECT			CONTRACT NO. 70737	