

FAP RTE	SECTION	COUNTY	TOTAL SHEETS	SHEET NO.
328		CLAY	109	1

*(6BR-1, 6BR-3, 8BR-3, 8BR-4)B-1

P-97-027-05
D-97-031-06

SEE SHEET 2 FOR INDEX OF SHEETS

STATE OF ILLINOIS
DEPARTMENT OF TRANSPORTATION
DIVISION OF HIGHWAYS
**PROPOSED
HIGHWAY PLANS**

FAP RTE 328 (US 45)
SECTIONS (6BR-1, 6BR-3, 8BR-3, 8BR-4)B-1
PROJECT: **ACF-ACBRF-0328(024)**
CLAY COUNTY

C - 97 - 071 - 05

STRUCTURE REPLACEMENTS
OVER GROVE CREEK, BRANCH OF ELM CREEK,
SEMINARY CREEK OVERFLOW, & SEMINARY CREEK

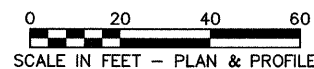
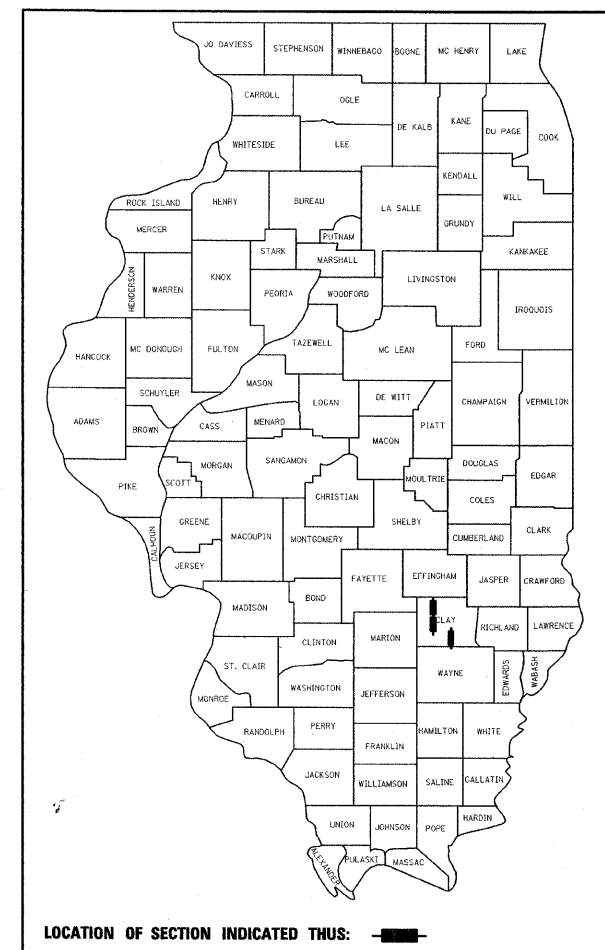

FULL SIZE PLANS HAVE BEEN PREPARED USING STANDARD ENGINEERING SCALES. REDUCED SIZED PLANS WILL NOT CONFORM TO STANDARD SCALES. IN MAKING MEASUREMENTS ON REDUCED PLANS, THE ABOVE SCALES MAY BE USED.

MICROFILMED _____
REEL NUMBER _____
AWARDED _____
RESIDENT ENGINEER _____
AS BUILT CHANGES WERE MADE ON THE FOLLOWING SHEETS _____



J.U.L.I.E.
JOINT UTILITY LOCATION INFORMATION FOR EXCAVATION
1-800-892-0123

DISTRICT 7 NO. (217) 342-3951
PROJECT ENGINEER: MARK DAUGHERTY
UNIT CHIEF:
TOWNSHIP: STANFORD, HARTER, & LOUISVILLE
CONTRACT NO.: 74107

(6BR-1)B-1 (6BR-3)B-1 (8BR-3, 8BR-4)B-1
GROSS LENGTH = 400 FT. = 0.076 MI.; = 400 FT. = 0.076 MI.; = 1070 FT. = 0.203 MI.;
NET LENGTH = 400 FT. = 0.076 MI.; = 400 FT. = 0.076 MI.; = 1070 FT. = 0.203 MI.;

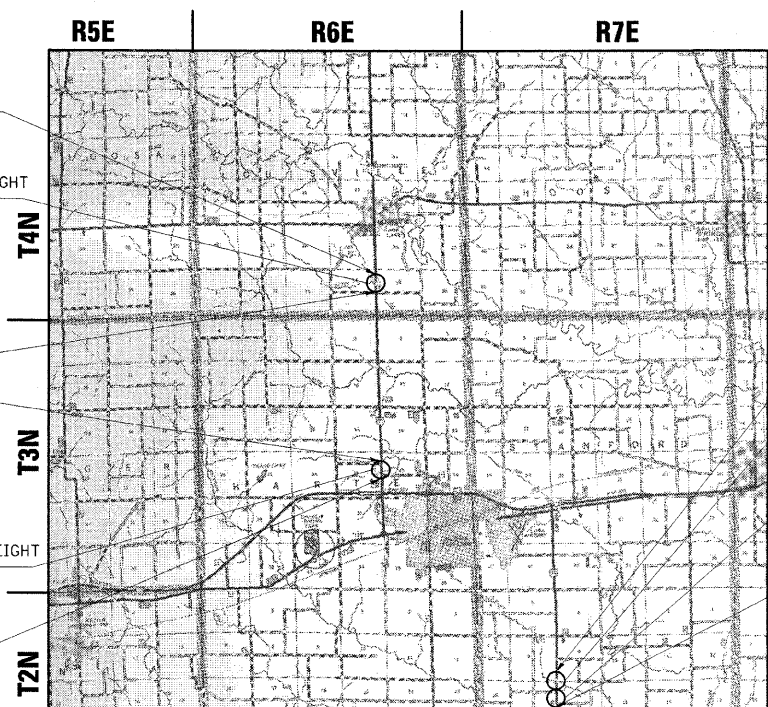

LOCATION MAP

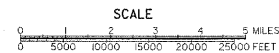

FUNCTIONAL CLASSIFICATION:
DESIGN SPEED:
POSTED SPEED:
ADT: (6BR-1; 6BR-3; 8BR-3, & 8BR-4)B-1 5001; 4294; 2366(2008)
PV: (6BR-1; 6BR-3; 8BR-3, & 8BR-4)B-1 88%; 88%; 85%
SU: (6BR-1; 6BR-3; 8BR-3, & 8BR-4)B-1 7%; 6%; 7%
MU: (6BR-1; 6BR-3; 8BR-3, & 8BR-4)B-1 5%; 6%; 8%

DESIGN DESIGNATION
N.A.

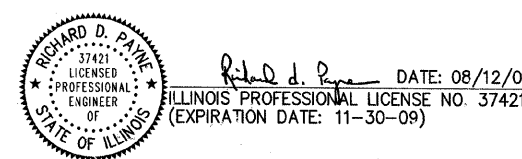

STATE OF ILLINOIS
DEPARTMENT OF TRANSPORTATION
DIVISION OF HIGHWAYS
SUBMITTED August 14, 2008
Roger L. Dickel
DEPUTY DIRECTOR OF HIGHWAYS, REGION ENGINEER
December 5, 2008
Eric E. Harms
Interim ENGINEER OF DESIGN AND ENVIRONMENT
December 5, 2008
Christine M. Reed
DIRECTOR OF HIGHWAYS, CHIEF ENGINEER

PRINTED BY THE AUTHORITY
OF THE STATE OF ILLINOIS