

STATE OF ILLINOIS  
DEPARTMENT OF TRANSPORTATION

ROUTE NO. FAP 328	SECTION *	COUNTY CLAY	SHEET NO. 109	SHEET 14	SHEET NO. 2 6 SHEETS
FED. ROAD DIST. NO.		ILLINOIS	FED. AID PROJECT		Contract #74107 *6BR-1B-1

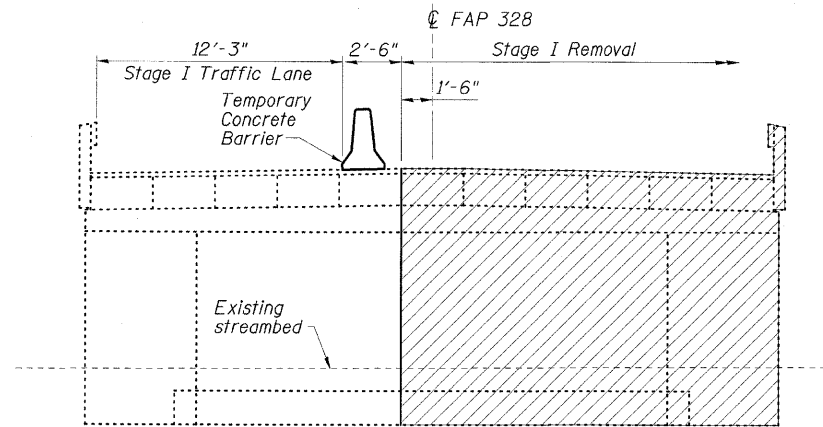

STAGE I REMOVAL

STAGE CONSTRUCTION NOTES

1. Hatched areas indicate Removal of Existing Structures.
2. For details of Temporary Concrete Barrier, see Sht. No. 6 of 6.
3. Removal of existing bridge rail is included with Removal of Existing Structures.
4. All sections are looking South.
5. Horizontal dimensions are at right angles to  $\text{CL}$  FAP 328.

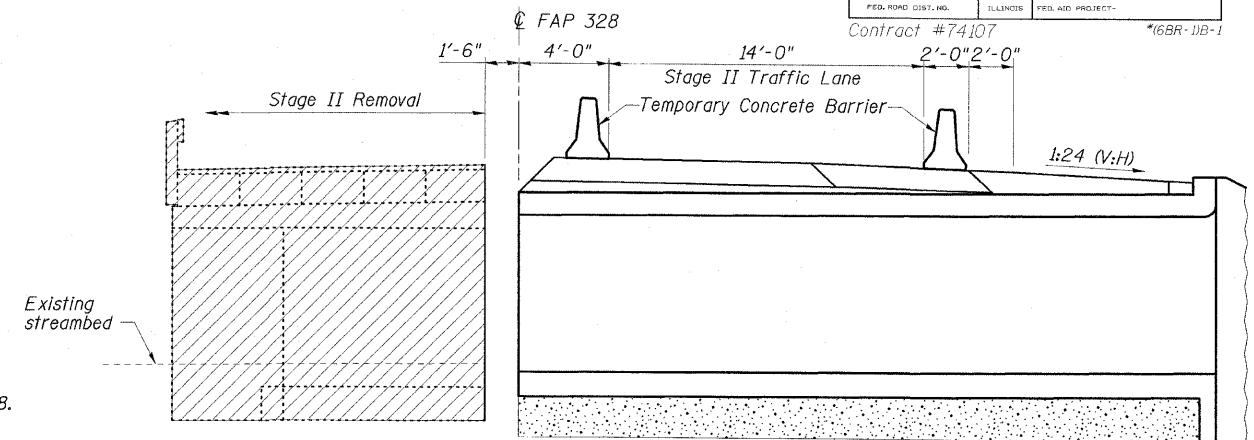

STAGE II REMOVAL

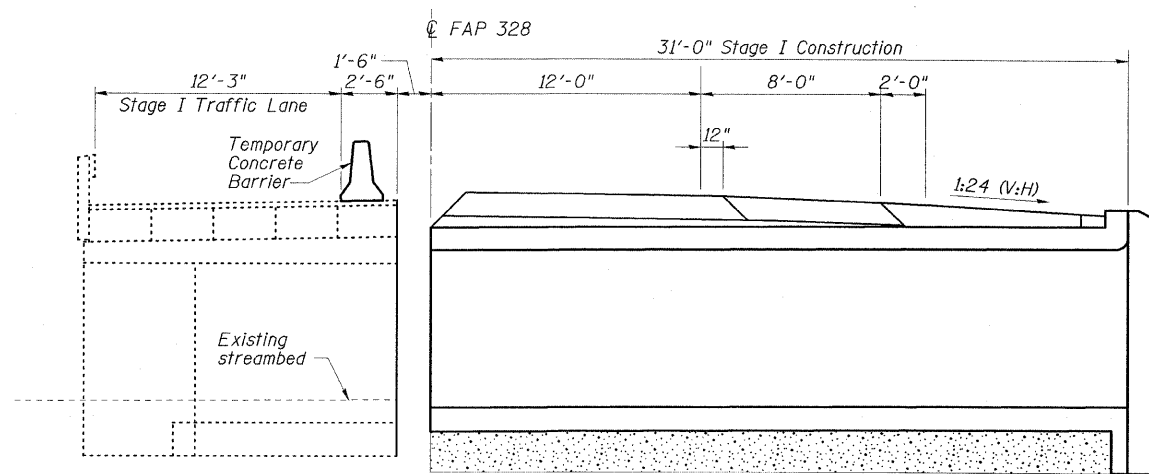

STAGE I CONSTRUCTION

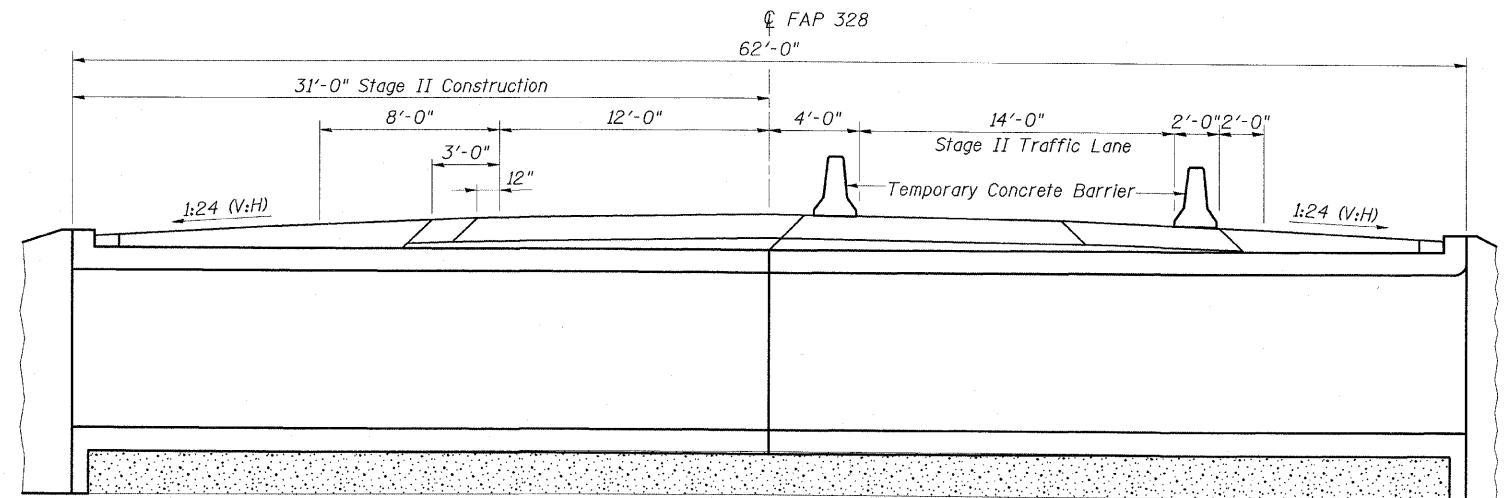

STAGE II CONSTRUCTION

TEMPORARY SOIL RETENTION SYSTEM NOTES

1. Existing structure details are based on the best available information from existing bridge plans.
2. A cantilevered sheet piling design does not appear feasible and additional members or other retention systems may be necessary. The Contractor shall submit a temporary soil retention system design including plan details and calculations for review and acceptance by the Engineer.

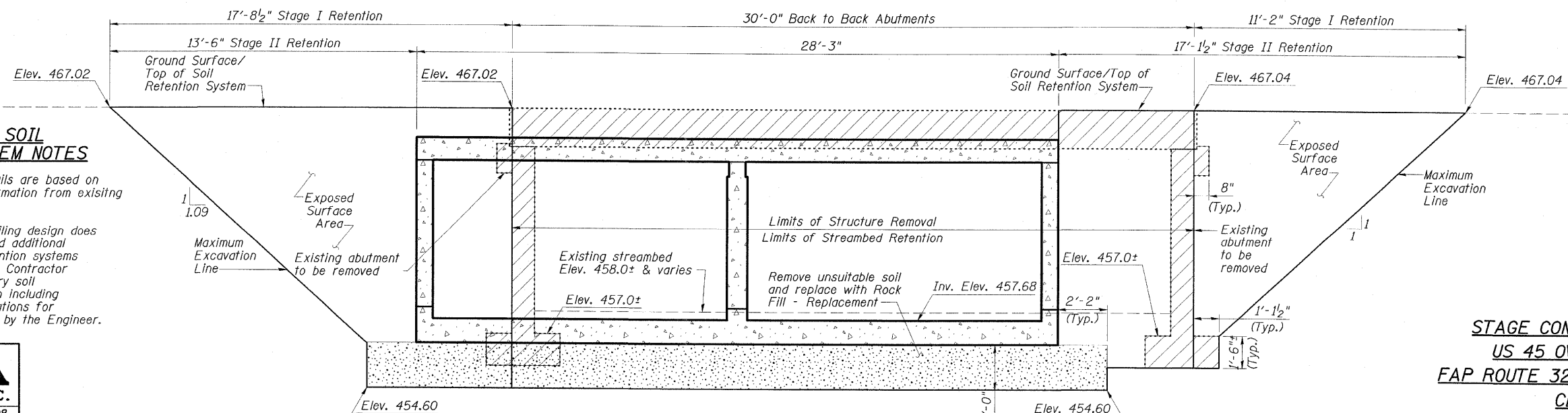

TEMPORARY SOIL RETENTION SYSTEM LIMITS

(Looking East)

Note: Dimensions along  $\text{CL}$  of FAP 328

STAGE CONSTRUCTION DETAILS  
US 45 OVER GROVE CREEK  
FAP ROUTE 328 - SECTION (6BR-1)B-1  
CLAY COUNTY  
STATION 1413+68.00  
STRUCTURE NO. 013-2009

**ESCA**  
CONSULTANTS, INC.

DESIGNED BY: FMA 02/08  
DRAWN BY: CJ 02/08  
CHECKED BY: ELH 05/08  
APPROVED BY: RDP 08/08